

# FOR LEASE

3010 E. CORONADO ST | UNIT E  
ANAHEIM CA



**±1,680 SF UNIT**

±438 SF OF OFFICE & ±1,242 SF OF WAREHOUSE IN PRIME EAST ANAHEIM LOCATION

**Luke Hudson** C: 714.614.2522

Principal | Lee & Associates | [ludson@lee-associates.com](mailto:ludson@lee-associates.com) DRE# 01870037

**LEE & ASSOCIATES**  
COMMERCIAL REAL ESTATE SERVICES

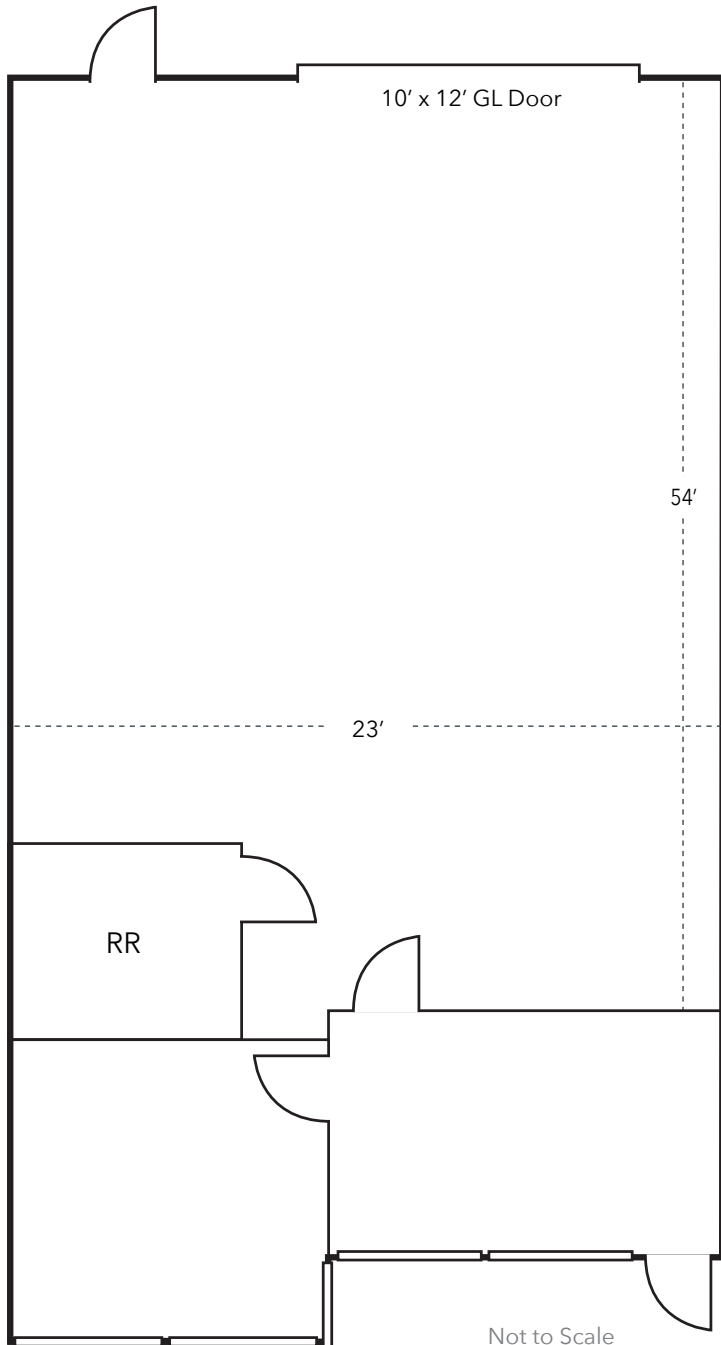

**WAREHOUSE**  
 200 AMPS, 120/208 Volt (verify)  
 15 Clear Height  
 One (1) Ground Level Door  
 1,242 SF of Warehouse

- ±1,680 SF Unit part of a Larger 15,600 SF Building
- ±438 SF of Office
- ±1,242 SF of Warehouse
- 15' Clear Height
- New Landscape
- New Ownership
- One Ground Level Loading Door - 10' wide x 12' tall
- Prime East Anaheim Location with Excellent Access to the 91,57,55,5 and 22 freeways

ALL INFORMATION CONTAINED HEREIN HAS BEEN PROVIDED BY SELLER, LANDLORD, AND/OR THIRD PARTIES, BUT HAS NOT BEEN INDEPENDENTLY VERIFIED BY LEE & ASSOCIATES OR ITS AGENT(S). BUYER, TENANT AND/OR INTERESTED PARTIES SHOULD INDEPENDENTLY VERIFY ALL INFORMATION COMMUNICATED BY THESE SOURCES.

# PROPERTY LOCATION

3010 E. CORONADO STREET | UNIT E

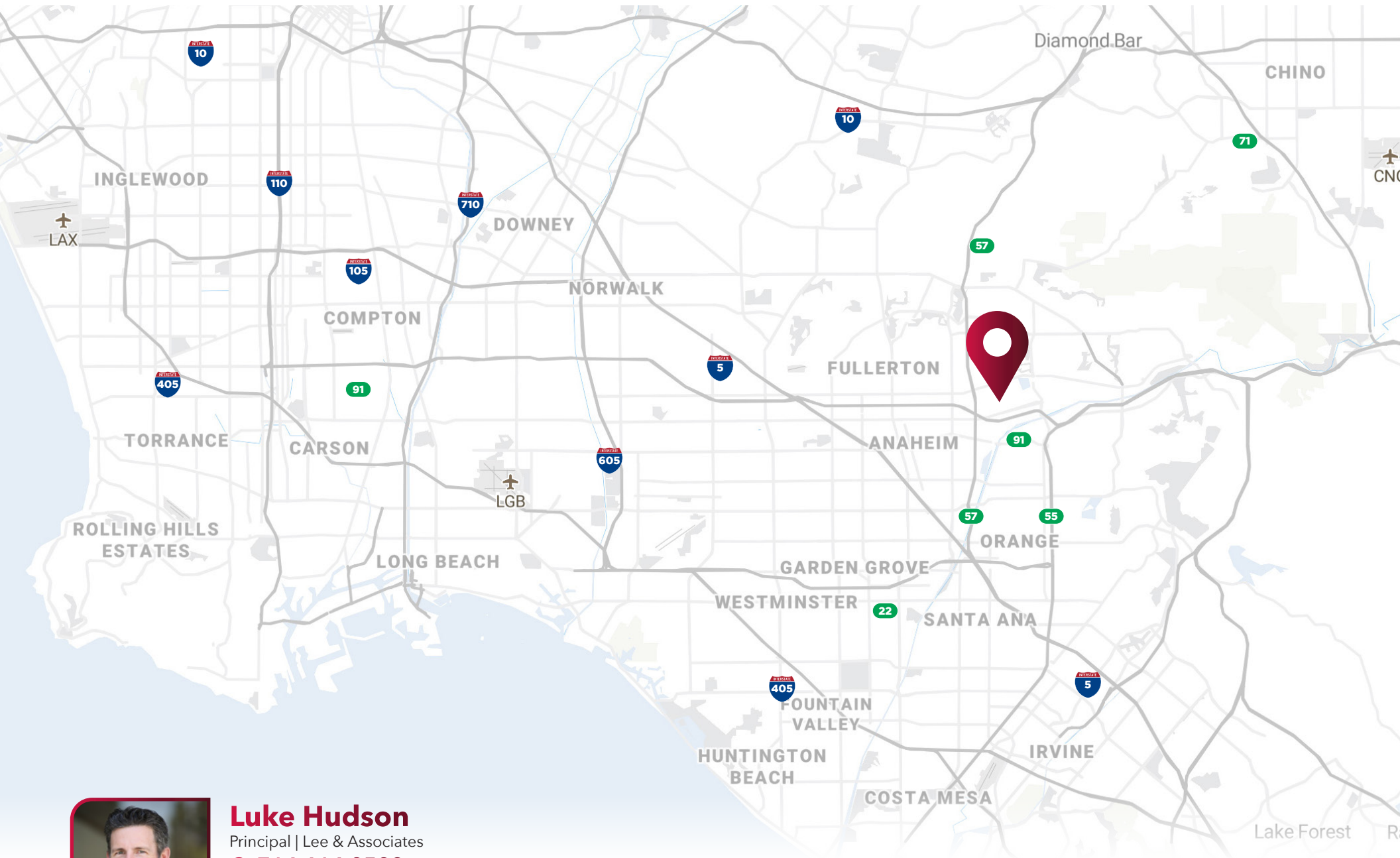

## Luke Hudson

Principal | Lee & Associates

C: 714.614.2522

lhudson@lee-associates.com

DRE# 01870037