

FOR LEASE

Freeway Frontage Industrial/Retail Unit E, 8,286 SF

110 N. WASHBURN CIRCLE | CORONA | CA | 92882



PROPERTY FEATURES

- Rare Freeway Frontage Industrial Unit
- Divisible into Two (2) Units
- Five Ground Level Roll-Up Doors, Four (4) on One Side and One (1) on the Interior Unit
- Fenced Yard
- 15'-17' Interior Warehouse Clear Height
- 200 Amps Power (verify)
- Ample Parking
- Great Access to the 91 and 15 Freeways
- Offices with Restrooms
- Vacant
- Call to Tour

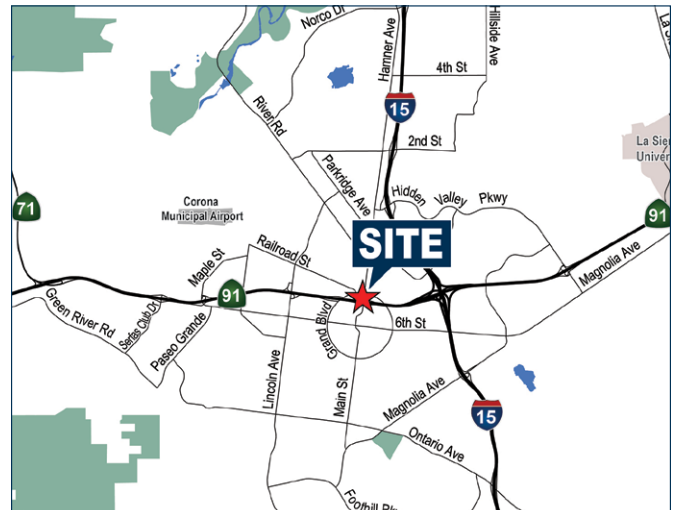

JACK FARIS

Senior Vice President | Partner

License #00912766

(949) 400-0957

jfaris@voitco.com

DREW ZAVALA

Associate

License #02173846

(949) 263-5314

dzavala@voitco.com

Voit

REAL ESTATE SERVICES

2400 E. Katella Ave., Suite 750
Anaheim, CA 92806
714.978.7880 • 714.978.9431 Fax
www.VoitCo.com

FOR LEASE

Freeway Frontage Industrial/Retail Unit E, 8,286 SF

110 N. WASHBURN CIRCLE | CORONA | CA | 92882

SITE PLAN

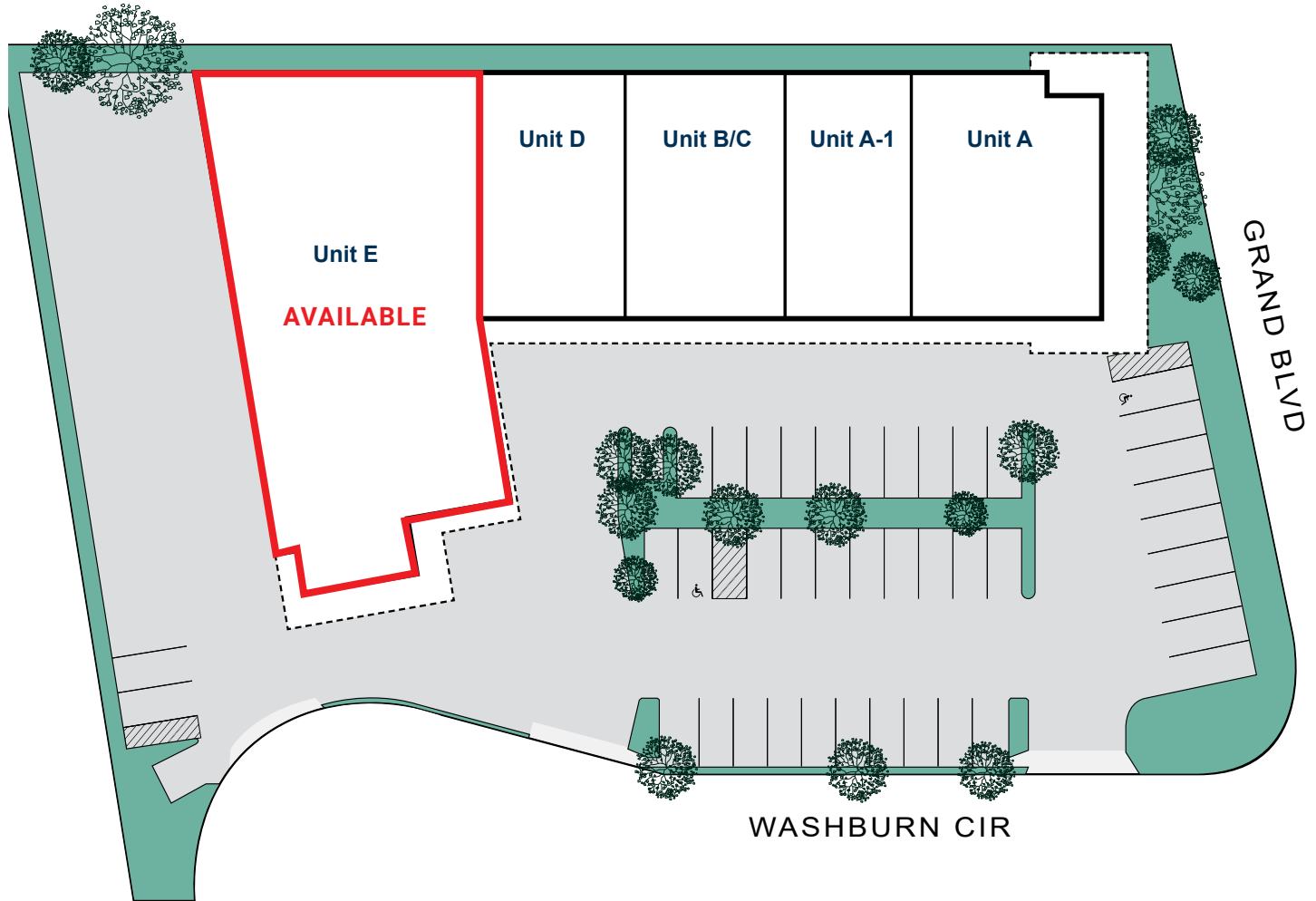

Please Note: Site Plan may not be to scale.

JACK FARIS

Senior Vice President | Partner

License #00912766

(949) 400-0957

jfaris@voitco.com

DREW ZAVALA

Associate

License #02173846

(949) 263-5314

dzavala@voitco.com

Voit

REAL ESTATE SERVICES

2400 E. Katella Ave., Suite 750
Anaheim, CA 92806
714.978.7880 • 714.978.9431 Fax
www.VoitCo.com

FOR LEASE

Freeway Frontage
Industrial/Retail Unit E, 8,286 SF

110 N. WASHBURN CIRCLE | CORONA | CA | 92882



JACK FARIS
Senior Vice President | Partner
License #00912766
(949) 400-0957
jfaris@voitco.com

DREW ZAVALA
Associate
License #02173846
(949) 263-5314
dzavala@voitco.com

Voit
REAL ESTATE SERVICES

2400 E. Katella Ave., Suite 750
Anaheim, CA 92806
714.978.7880 • 714.978.9431 Fax
www.VoitCo.com

FOR LEASE

Freeway Frontage Industrial/Retail Unit E, 8,286 SF

110 N. WASHBURN CIRCLE | CORONA | CA | 92882

AERIAL



JACK FARIS

Senior Vice President | Partner
License #00912766
(949) 400-0957
jfaris@voitco.com

DREW ZAVALA

Associate
License #02173846
(949) 263-5314
dzavala@voitco.com

Voit

REAL ESTATE SERVICES

2400 E. Katella Ave., Suite 750
Anaheim, CA 92806
714.978.7880 • 714.978.9431 Fax
www.VoitCo.com