



WEST PALM BEACH, FL

# 1515 N DIXIE HWY

964 - 3,754 SF OF RETAIL / FLEX SPACE AVAILABLE



# PROJECT DETAILS

1515 N DIXIE HWY • 964 - 3,754 SF OF RETAIL / FLEX SPACE AVAILABLE

- GLA** 9,150 SF
- TRAFFIC COUNTS** Highly visible site on US 1 (15,300 ADT)
- PROPERTY HIGHLIGHTS**
  - Spaces available from 964 - 3,754 SF
  - Excellent visibility to US-1
  - Situated less than a mile from the heart of Downtown West Palm Beach
  - 58 surface parking spaces
  - New construction spaces delivered in Vanilla Shell condition
  - Ceiling heights of 15' 8"
- DELIVERY** Q1 2027
- COUNTY** Palm Beach County
- MARKET** West Palm Beach



DEMOGRAPHICS	1 MILE	3 MILE	5 MILE
--------------	--------	--------	--------

POPULATION	15,830	87,083	200,155
------------	--------	--------	---------



DAYTIME POPULATION	20,344	87,710	145,804
--------------------	--------	--------	---------



AVERAGE HH INCOME	\$116,245	\$137,234	\$115,506
-------------------	-----------	-----------	-----------

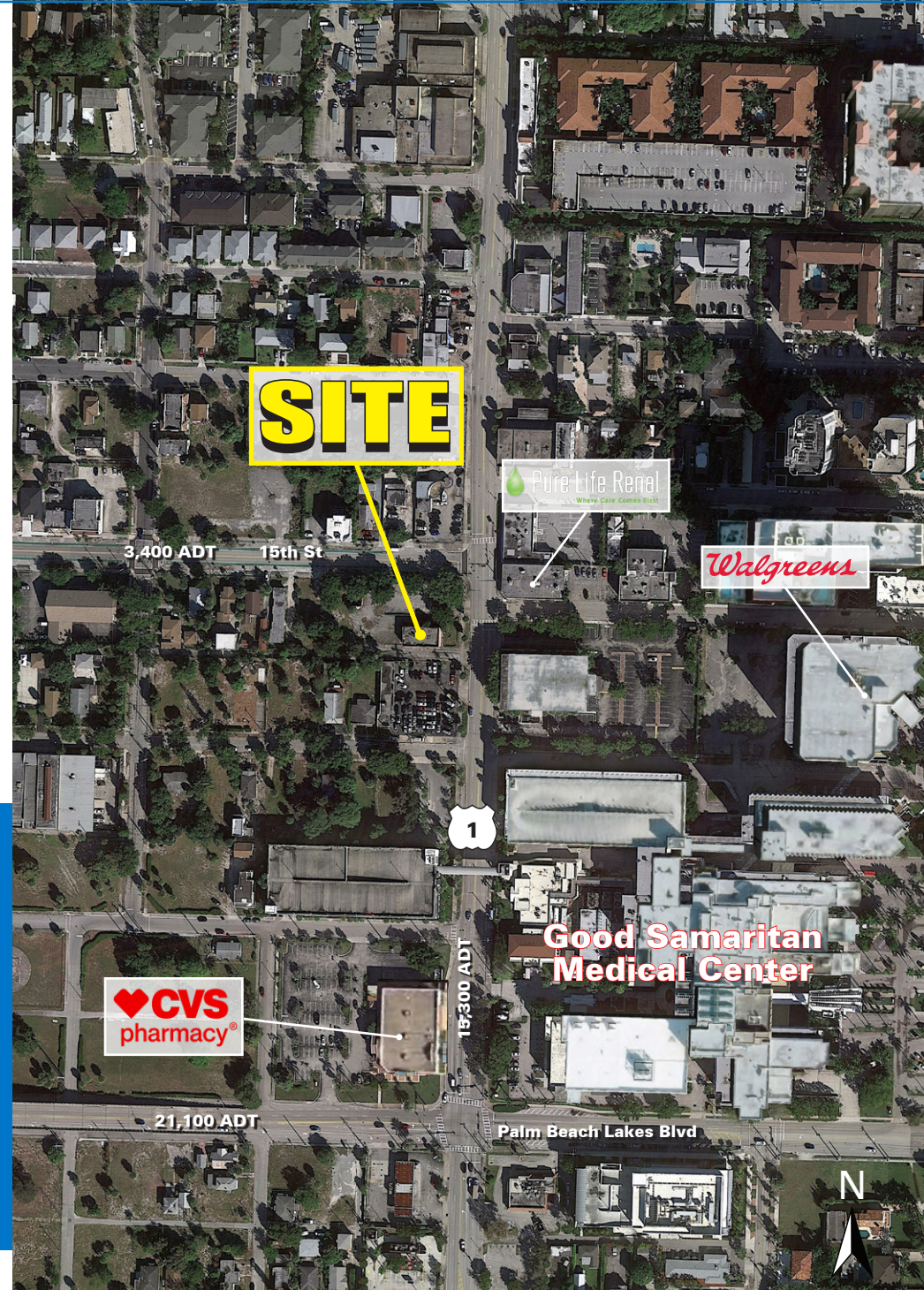



SITE ZOOM

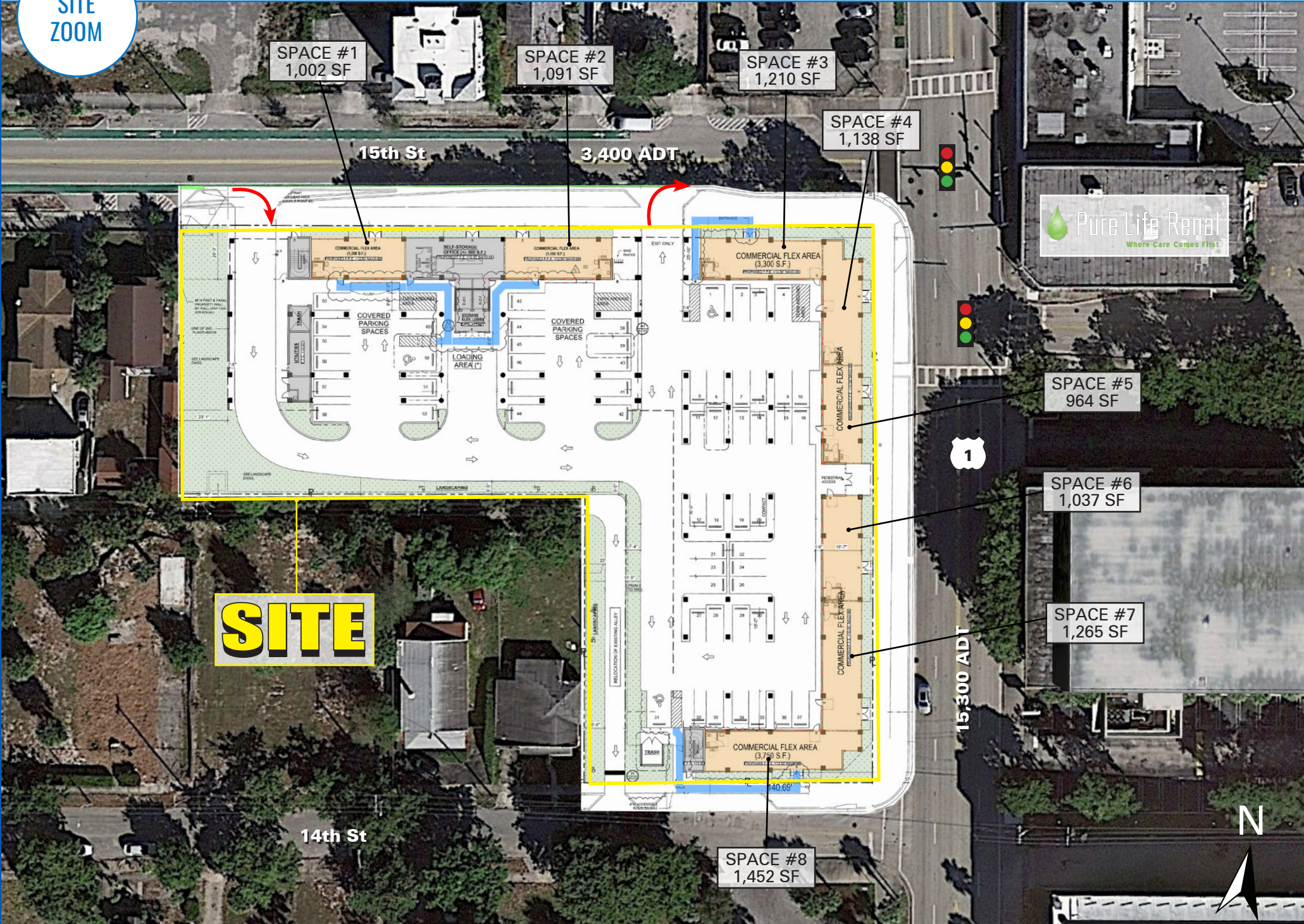

**SITE**



WEST PALM BEACH, FL

# 1515 N DIXIE HWY

**964 - 3,754 SF OF RETAIL / FLEX SPACE AVAILABLE**

## TRAVIS LANGHORST

561.424.3026

TLANGHORST@ATLANTICRETAIL.COM



**ALBANY  
ATLANTA  
BOSTON  
CHARLOTTE  
LOS ANGELES  
NEW YORK CITY  
ORLANDO  
PITTSBURGH  
WEST PALM BEACH**

HOLTEC BUILDING  
1001 N US HWY ONE, SUITE 600  
JUPITER, FL 33477  
561.427.6699

**WWW.ATLANTICRETAIL.COM**

 [LINKEDIN.COM/COMPANY/ATLANTIC-RETAIL-PROPERTIES](https://www.linkedin.com/company/atlantic-retail-properties)

 [INSTAGRAM.COM/ATLANTIC\\_RETAIL/](https://www.instagram.com/atlantic_retail/)

