

# HIGHLANDS BUSINESS CENTER

40935 - 40945 COUNTY CENTER DRIVE  
TEMECULA



 **LEE &  
ASSOCIATES**  
COMMERCIAL REAL ESTATE SERVICES

**FOR LEASE**  
FLEX / INDUSTRIAL SPACE

# PROPERTY HIGHLIGHTS

- 40935 & 40945 County Center Drive are conveniently located within Highlands Business Center in Temecula, California and offers highly improved Flex / R&D / Industrial space.
- Flexible floor plans with build-outs include: reception, multiple offices, conference room, open work area, coffee bar, restroom and warehouse.
- The project offers 14' clear height, 10' rear loading rollup doors, prominent building signage and covered parking.
- Zoned Business Park (BP), City of Temecula, allows for many office and industrial uses.
- High speed data transfer available via fiber optics communication network.
- Abundant parking at a ratio of 4 per 1,000 RSF.

**HIGHLANDS BUSINESS CENTER**  
40935 - 40945 COUNTY CENTER DRIVE  
TEMECULA



**HIGHLANDS BUSINESS CENTER**  
40935 - 40945 COUNTY CENTER DRIVE  
TEMECULA

**SUITE C / 1,764 RSF / \$1.75 MG\***

Large Reception, three private offices, bullpen, interior restroom.  
Contact broker for touring instructions.

\* MG Rate does not include janitorial or electricity

**SUITE C**  
1,764 SF  
AVAILABLE

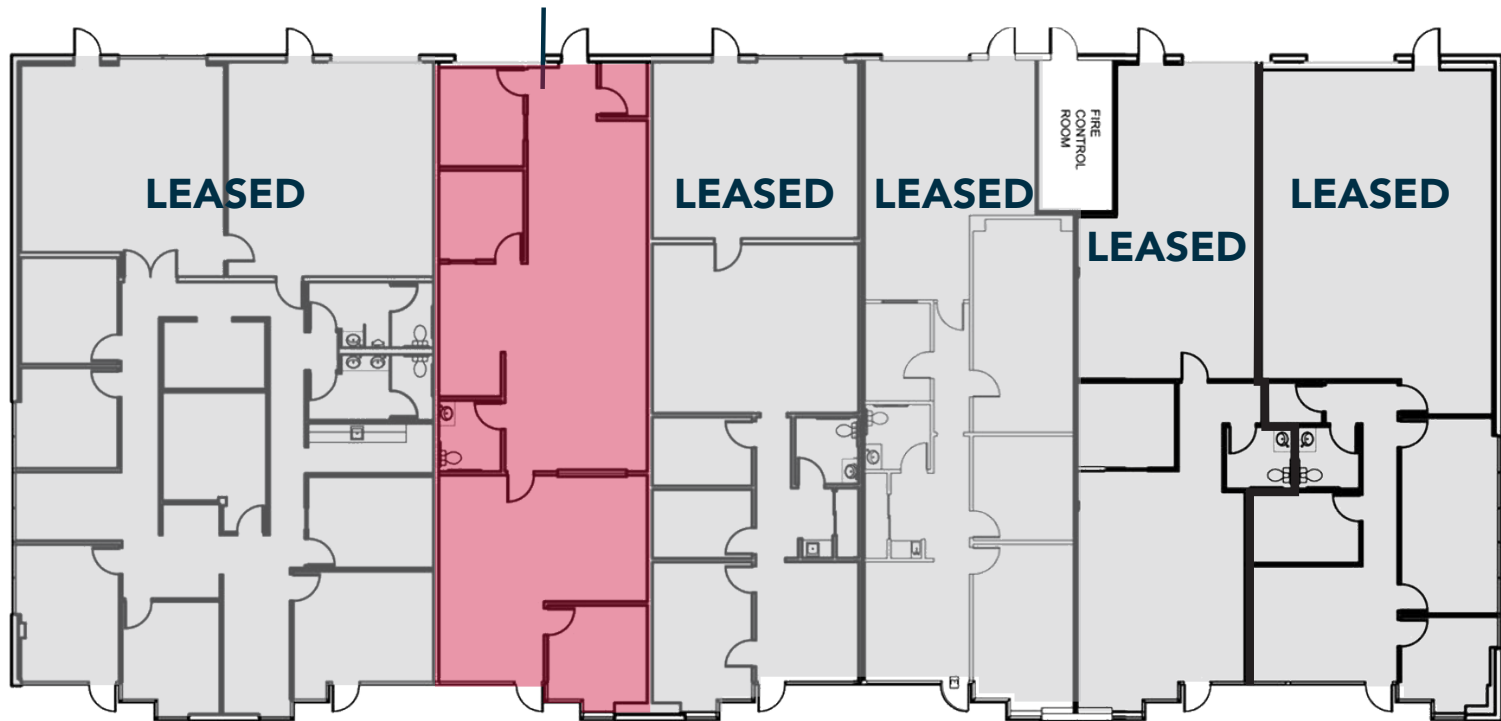

# CENTRAL LOCATION

- Premier location within 1/2 mile of I-15 access at Winchester Road and closest on/off ramp to I-15 / I-215 interchange.
- The Old Town Temecula is two miles away and offers number of dining, shopping, entertainment and retail options.
- The City of Temecula is one of the fastest growing and centrally located business districts on the West Coast.
- Cost-effective and business friendly environment provides access to a highly skilled labor force and high-quality of living.





# HIGHLANDS BUSINESS CENTER

40935 - 4095 COUNTY CENTER DRIVE  
TEMECULA

Temecula Vet Center Riverside County Treasurer

## MATT SHAW, CCIM

Vice President

951.445.4502

mshaw@leetemecula.com

DRE# 01917622

## BLAKE VALDEZ

Vice President

951.445.4509

bvaldez@leetemecula.com

DRE# 02107941



COMMERCIAL REAL ESTATE SERVICES

No warranty or representation has been made to the accuracy of the foregoing information. Terms of sale or lease and availability are subject to change or withdrawal without notice. Lee & Associates Commercial Real Estate Services, Inc. - Riverside. 25240 Hancock Avenue, Suite 100 - Murrieta, CA 92562 | Corporate ID# 01048055