



JAPAN CENTER EAST MALL

2,629 SF RESTAURANT SPACE AVAILABLE

HALEY KLEIN haley@mavenproperties.com

KRYSTAL CHANNICK krystal@mavenproperties.com

maven
RETAIL

F E A T U R E S

Japantown, one of three remaining in the United States, consists of about six square city blocks in San Francisco. The main thoroughfare is Post Street, between Fillmore Street and Laguna Street. Japan Center East & West are located in the heart of Japantown and include over 100,000 square feet of shops and restaurants. Japan Center represents Japanese culture with one-of-a-kind retailers and restaurants. The property is easily accessible by public transportation, and also contains ample underground and street parking.

- Approximately 2,629 SF
- Second generation restaurant
- Situated inside Japan Center East Mall
- Near the entrance to Kabuki Hotel





JAPAN CENTER EAST FLOOR PLAN | 22 PEACE PLAZA

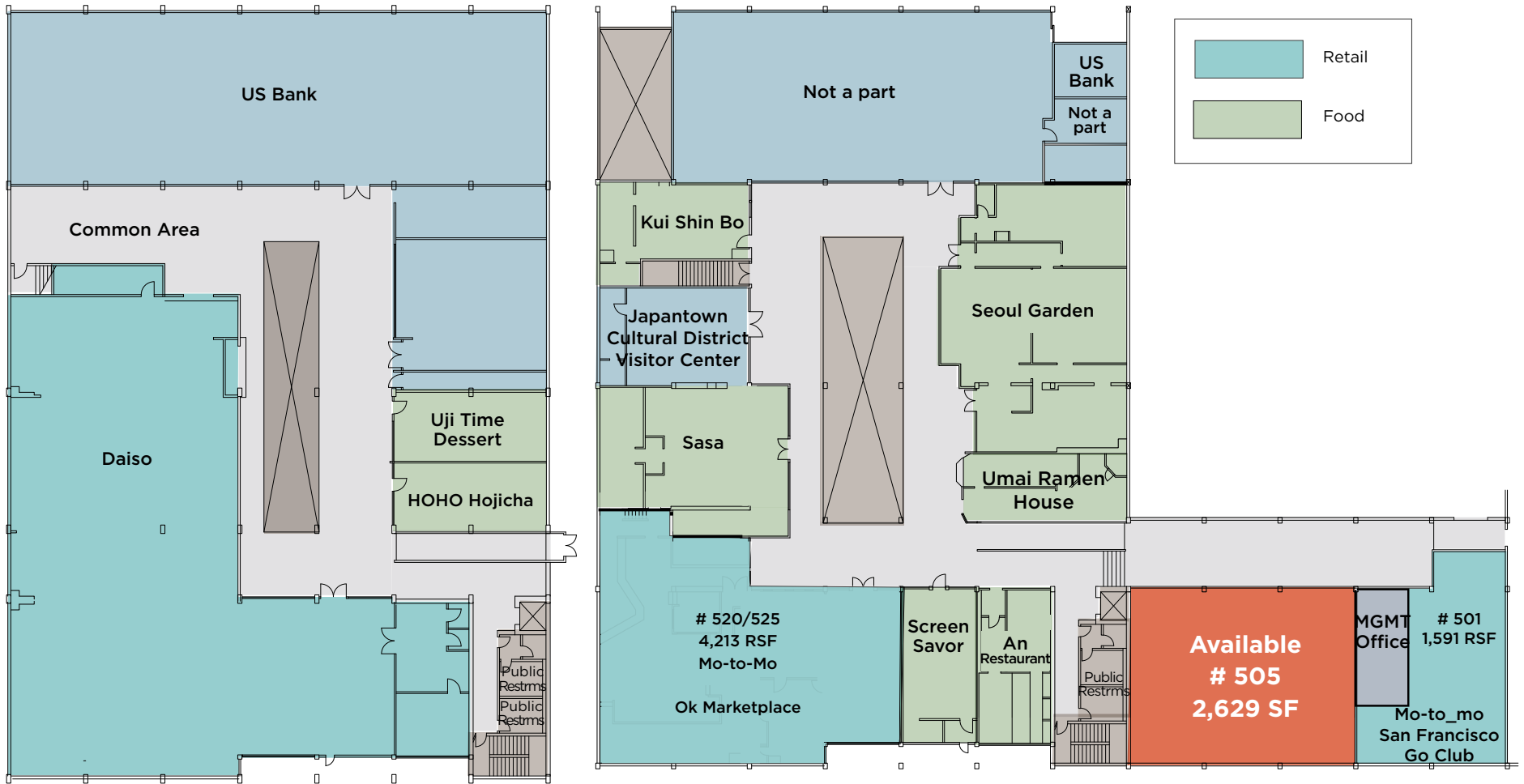

SAN FRANCISCO BAY



MARINA

NORTH BEACH

GARDENIAS

PACIFIC HEIGHTS

JAPANTOWN NEIGHBORHOOD

GARDENIAS

OSAKA WAY

HOTEL KABUKI

AMC KABUKI

KINOKUNIYA BUILDING & WEBSTER BRIDGE

JAPAN CENTER WEST

POST STREET

GEARY BOULEVARD

KABUKI SPRINGS & SPA

THE PROGRESS

GEARY BOULEVARD

PEACE PLAZA

JAPAN CENTER EAST

LAGUNA STREET

JANE THE BAKERY

THE FILLMORE

WISE SONS DELI

WELLS FARGO

FILLMORE STREET

WEBSTER STREET

WALK SCORE

100

WALK SCORE

95

BIKE SCORE

79

TRANSIT SCORE

MUNI BUSES: N, S, J, M

THE NEIGHBORHOOD

JAPANTOWN



HED11



JANE ON FILLMORE



AMC KABUKI 8



SHEBA JAZZ LOUNGE



MATTINA



7 ADAMS



COPRA



JANE THE BAKERY



STATE BIRD PROVISIONS



BOOM BOOM ROOM



KABUKI HOTEL



THE FILLMORE

JAPANTOWN PEACE PLAZA RENOVATION PROJECT

Japantown Peace Plaza is a major cultural landmark celebrating iconic structures like the historic Peace Pagoda monument. The outdoor plaza is over 30,000 square feet in area and built over a parking garage. Named the Peace Plaza Vision Plan, the renovation project will bring to life the vision proposed for

the central public space in San Francisco's Japantown. The plaza will be completed with new pavers, landscape planters and irrigation, decorative walls, curbs and railings, lighting and electrical systems. The Peace Plaza is expected to fully reopen by early 2026.



“The Plaza is the beating heart of Japantown: attracting visitors, supporting businesses and sharing Japanese heritage, history and culture.”

Speaker Emerita Nancy Pelosi



SAN FRANCISCO | CALIFORNIA

JAPAN CENTER EAST & WEST

maven
RETAIL

CONTACT

HALEY KLEIN

office 415.404.7330
haley@mavenproperties.com
DRE #1907308

KRYSTAL CHANNICK

office 858.231.2219
krystal@mavenproperties.com
DRE #01969079

NOTICE: This information has been secured from sources we believe to be reliable but we make no representations, warranties, express or implied, as to the accuracy of the information. Listing broker has been given enough information to provide only a preliminary interest in the property. The materials are not to be considered fact. The information contained herein is not a substitute for thorough due diligence investigation. References to square footage, zoning, use, or age are approximate. Please contact the San Francisco Planning Department to verify zoning at (415) 558-6378, as neither broker or landlord represent that this space is suitable for your use. Tenant or Buyer must verify the information at their own expense and bears all the risk for any inaccuracies. By receiving these materials you are agreeing to the disclaimers set forth herein. DRE#01878802

466 Green Street Suite #203 | San Francisco, CA 94133 | 415.781.7700 | DRE #01878802