

WELL DEVELOPED OFFICE



**6,800 SF Freestanding Building
on 0.56 Acres**

Property Highlights

- Excellent access to Highway 43 and all nearby services
- Well developed office/showroom space
- Ability to convert to small bay multi-tenant income producing property
- Secure fenced yard

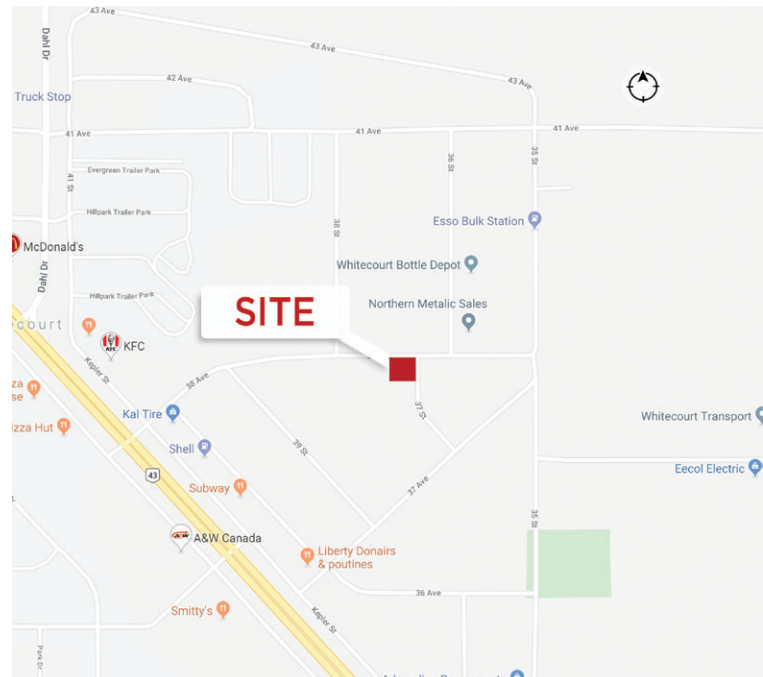

Chris Sieben
Partner
780 720 0227
chris.sieben@cwedm.com

Kennedy Munro
Associate
780 670 3042
kennedy.munro@cwedm.com

CUSHMAN & WAKEFIELD
Edmonton
Suite 2700, TD Tower
10088 - 102 Avenue
Edmonton, AB T5J 2Z1
www.cwedm.com

Cushman & Wakefield Edmonton is independently owned and operated / A Member of the Cushman & Wakefield Alliance. No warranty or representation, express or implied, is made to the accuracy or completeness of the information contained herein, and same is submitted subject to errors, omissions, change of price, rental or other conditions, withdrawal without notice, and to any special listing conditions imposed by the property owner(s). As applicable, we make no representation as to the condition of the property (or properties) in question. March 9, 2020

Property Details

Municipal Address:	3703 38 Avenue, Whitecourt, AB	Year Built:	1978
Legal Description:	Plan 7521663, Block 8, Lot 11	Loading:	(2) 12' x 12' Drive-Thru Grade
Zoning:	Industrial District (M-1)	Ceiling Height:	14' Clear
Available Size:	2,000 SF (Office/Showroom) 2,000 SF (Shop) 2,800 SF (Second Floor Office) 6,800 SF (Total)	Sale Price:	\$ 900,000.00
Site Size:	±0.56 Acres	Taxes:	\$5,924 (2019)
Site Coverage Ratio:	16.4%	Lease Rate:	Market
		Operating Costs:	TBC

Aerial



Chris Sieben
Partner
780 720 0227
chris.sieben@cwedm.com

Kennedy Munro
Associate
780 670 3042
kennedy.munro@cwedm.com

CUSHMAN & WAKEFIELD
Edmonton
Suite 2700, TD Tower
10088 - 102 Avenue
Edmonton, AB T5J 2Z1
www.cwedm.com

Property Photos



Chris Sieben
Partner
780 720 0227
chris.sieben@cwedm.com

Kennedy Munro
Associate
780 670 3042
kennedy.munro@cwedm.com

CUSHMAN & WAKEFIELD
Edmonton
Suite 2700, TD Tower
10088 - 102 Avenue
Edmonton, AB T5J 2Z1
www.cwedm.com