



3900

29TH STREET NE  
CALGARY, AB

PREPARED FOR:



wendy.browning@hartbrowningmanagement.com  
shanicep@hartbrowningmanagement.com

MEASUREMENT STANDARD:  
BOMA/SIOR 2004

LAND USE:  
I-G  
RENTABLE AREA:  
15,697 SQ. FT.

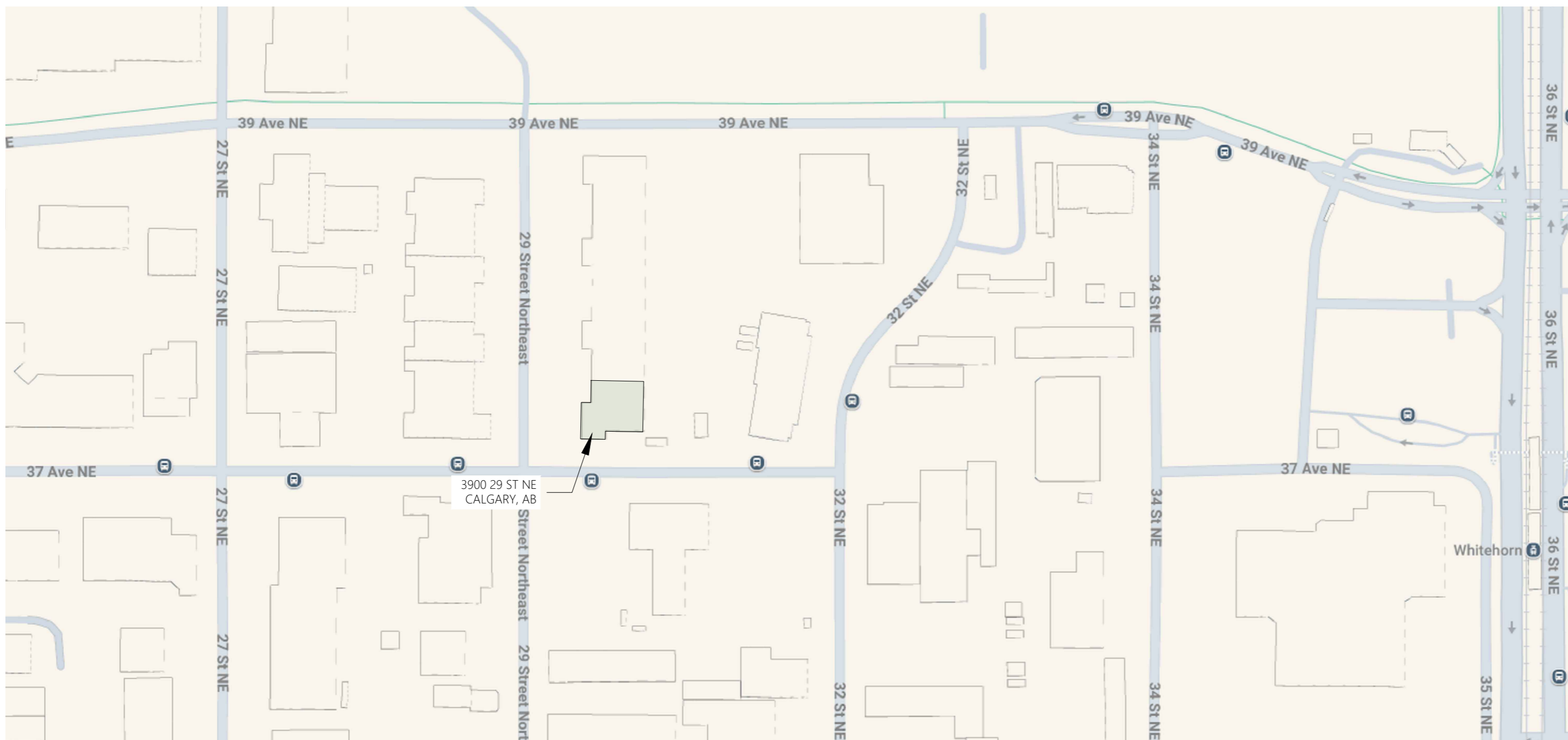

SHEET LIST

AB-00 - TITLE PAGE  
AB-A01 - SURVEYED FLOOR PLAN

NO.	DESCRIPTION	DATE
1	DRAWING PACKAGE DELIVERY	2024-09-04
2		
3		
4		
5		

SURVEYED BY: JS  
PREPARED BY: AP

DRAWING TITLE:  
TITLE PAGE

SURVEY DATE: 17/01/14  
SHEET: AB-00

PROJECT NUMBER: 4663



+1 (403) 830-5591 | asbuilt.ca

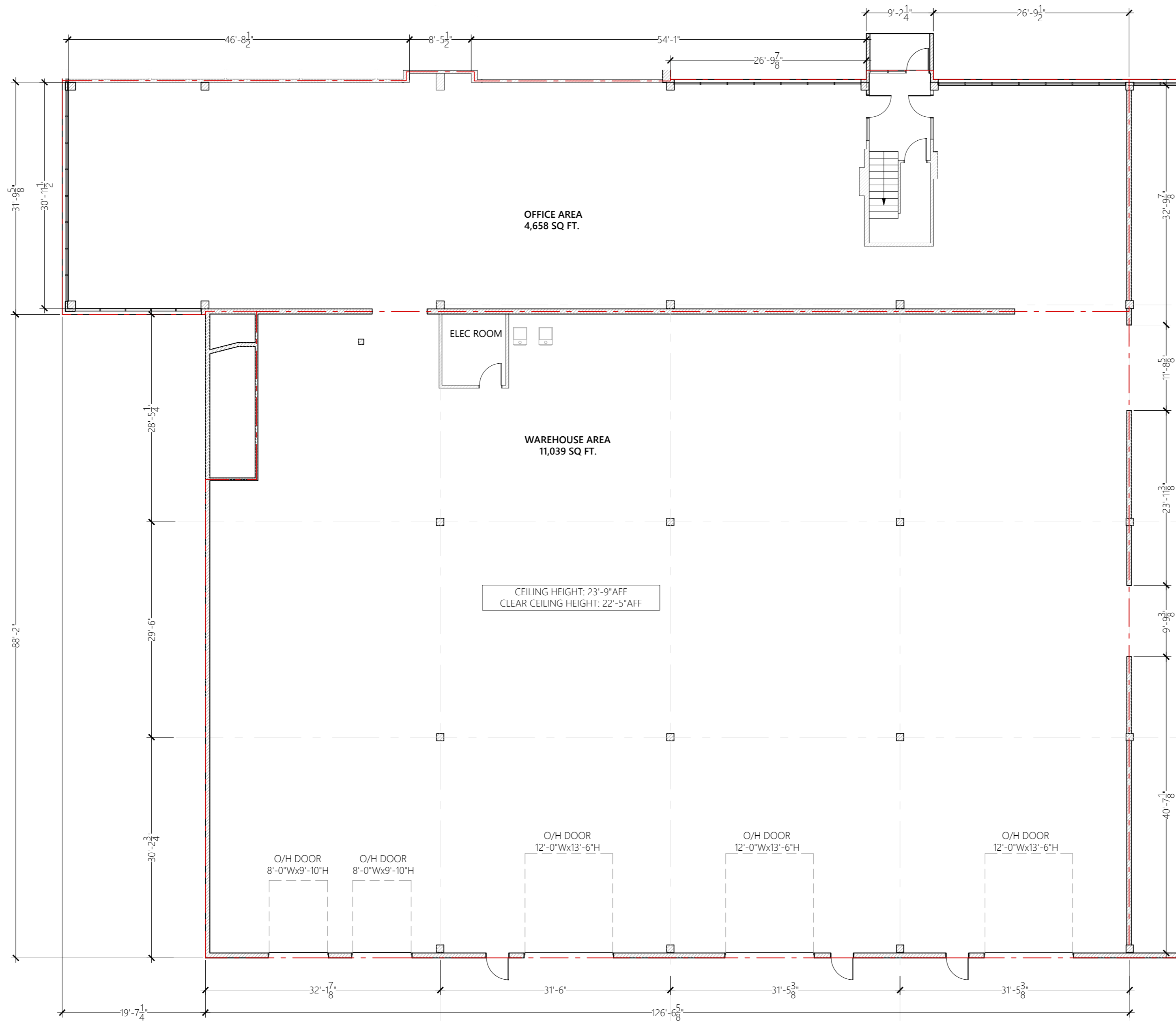
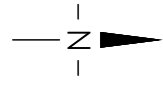

3900

29TH STREET NE  
CALGARY, AB

PREPARED FOR:



wendy.browning@hartbrowningmanagement.com  
shanicpe@hartbrowningmanagement.com

MEASUREMENT STANDARD:  
BOMA/SIOR 2004

LAND USE:

I-G

RENTABLE AREA:

15,697 SQ. FT.

CERTIFICATE:

WE VISITED 3900 29 ST NE CALGARY, ON 17/01/14 TO CONFIRM THE CONSTRUCTED AREA. MEASURED IN ACCORDANCE WITH THE ABOVE CITED STANDARD (MEASURED FROM THE OUTERMOST ARCHITECTURAL FINISH AT EXTERIOR WALLS EXCLUSIVE OF DECORATIVE PROJECTIONS, THE TENANT SIDE OF WALLS SEPARATING TENANTS FROM COMMON AREA OR "MAJOR VERTICAL PENETRATIONS", AND THE CENTRE OF ANY DEMISING WALLS), WE VERIFY THE "RENTABLE AREA" OF THE PREMISES TO BE 15,697 SQUARE FEET.

*Jordan Sasges* 04/09/24  
 JORDAN SASGES DATE  
 PRINCIPAL-OPERATIONS

SURVEYED BY: JS	PREPARED BY: AP
--------------------	--------------------

DRAWING TITLE:  
SURVEYED FLOOR  
PLAN

SURVEY DATE: 17/01/14	SHEET: AB-A01
--------------------------	------------------

PROJECT NUMBER: 4663



+1 (403) 830-5591 | asbuilt.ca