

4125 South Broad Street

Yardville, New Jersey

Availabilities

- +/- 9,744 SF with Drive-Thru

Neighboring Tenants



Site Description

- Former freestanding Walgreens at a traffic light-controlled intersection in Yardville (sub-market for Hamilton)
- Located in a dense residential market with over 187,000 people within 5-miles and strong incomes just shy of \$100,000 in the immediate surrounding area.
- Access to both South Broad Street (nearly 20,000 VPD) and Kim Valley Road which provides direct access to the residential population
- Approximately 1/2 mile from the Route 195 thoroughfare entrance and 3/4 mile from the I-95 entrance

Demographics

Radius	Population	Total Daytime Population	Median HH Income
1 Mile	9,597	6,323	\$97,825
3 Mile	60,070	48,731	\$92,525
5 Mile	187,413	166,226	\$86,289

Retail for Lease - Contact

Ryan Starkman
 Ph. 732-724-4501
 ryan@piersonre.com



4125 South Broad Street

Yardville, New Jersey

Market Aerial

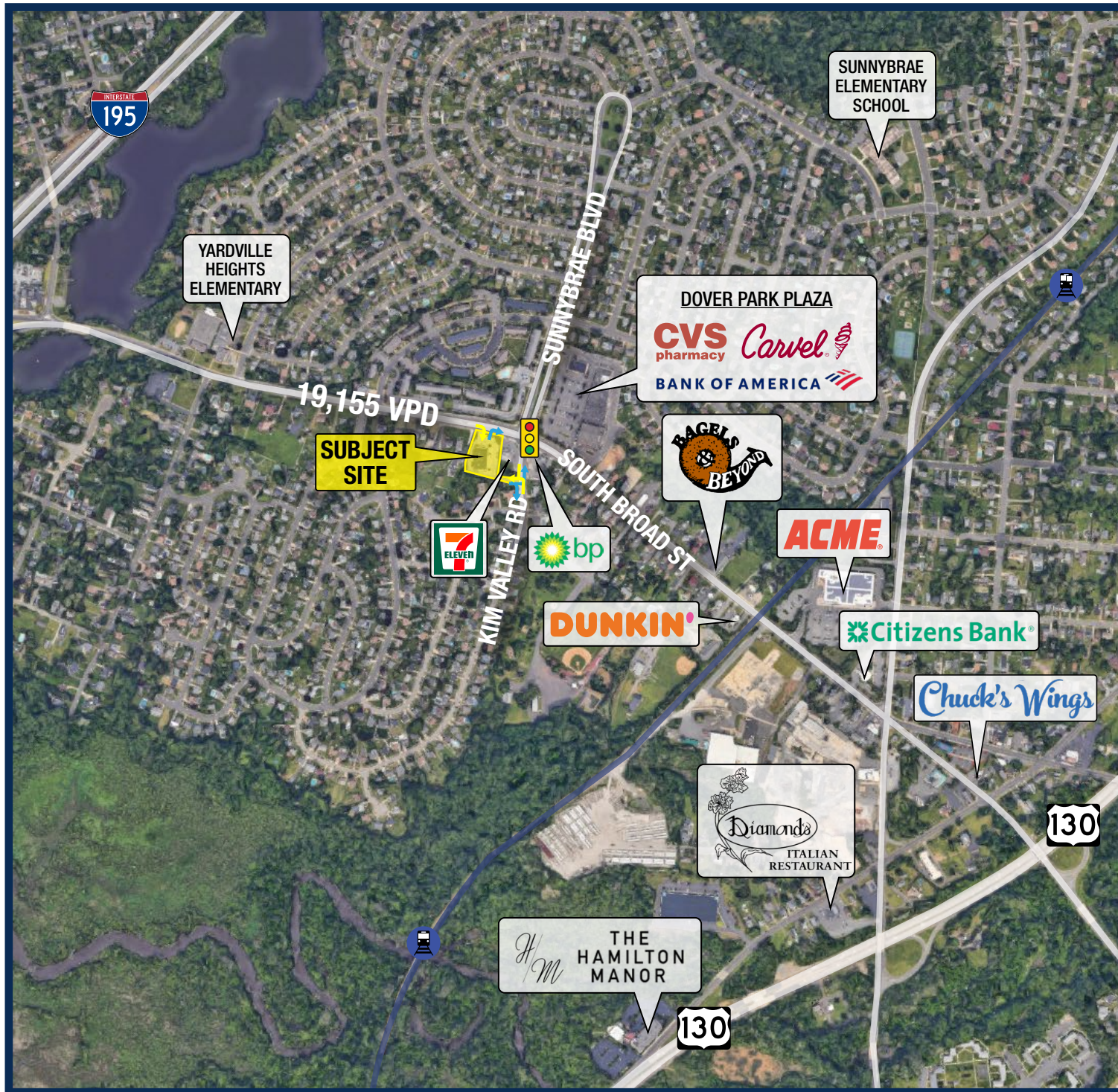

Retail for Lease - Contact

Ryan Starkman

Ph. 732-724-4501

ryan@piersonre.com

PIERSON
COMMERCIAL REAL ESTATE®

© Pierson Commercial Real Estate LLC. This information has been obtained from sources believed reliable. We have not verified it and make no guarantee, warranty or representation about it. Any renderings, projections, opinions, assumptions or estimates used are for example only and do not represent the current or future performance of the property. You and your advisors should conduct a careful, independent investigation of the property to determine to your satisfaction the suitability of the property for your needs.

4125 South Broad Street

Yardville, New Jersey

Site Plan

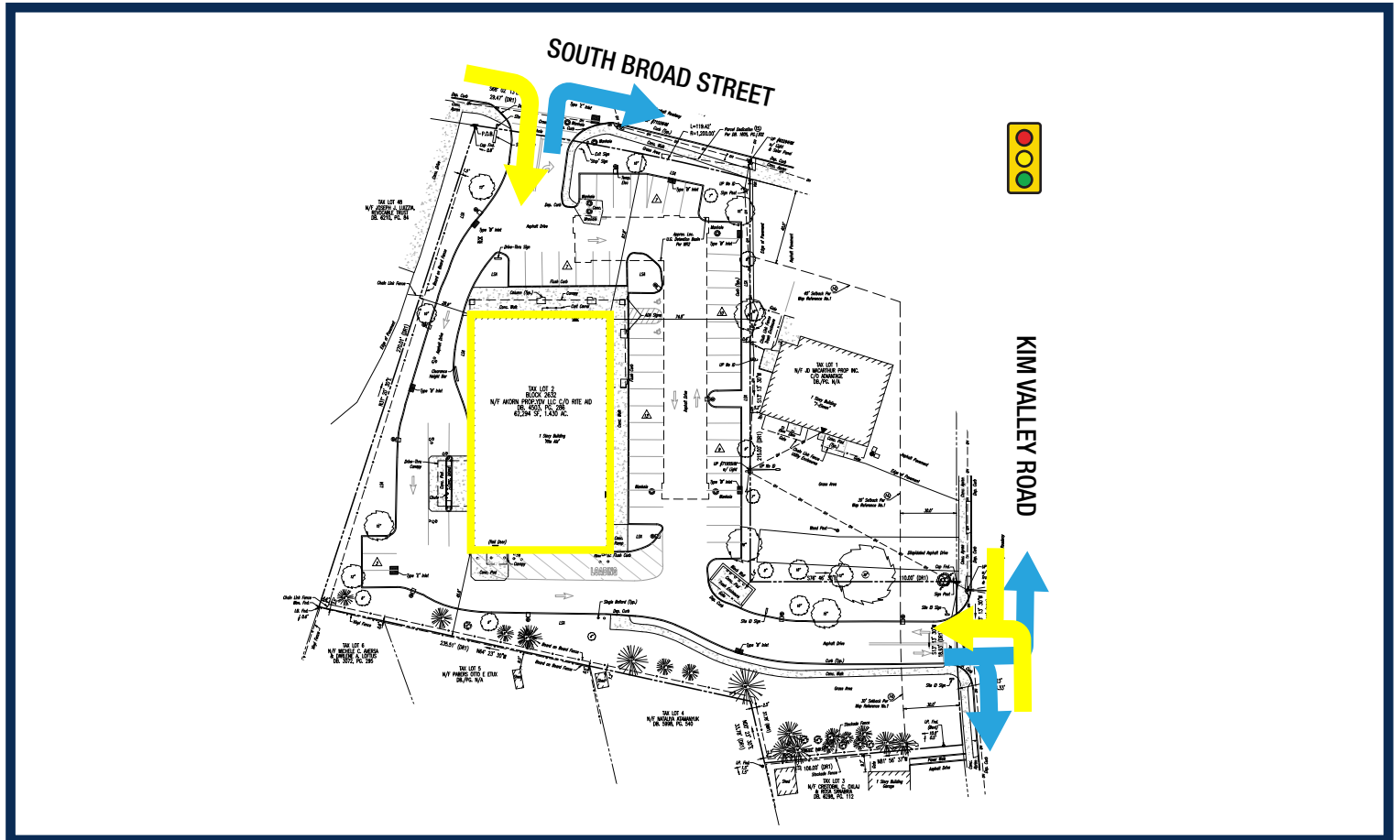

State Map

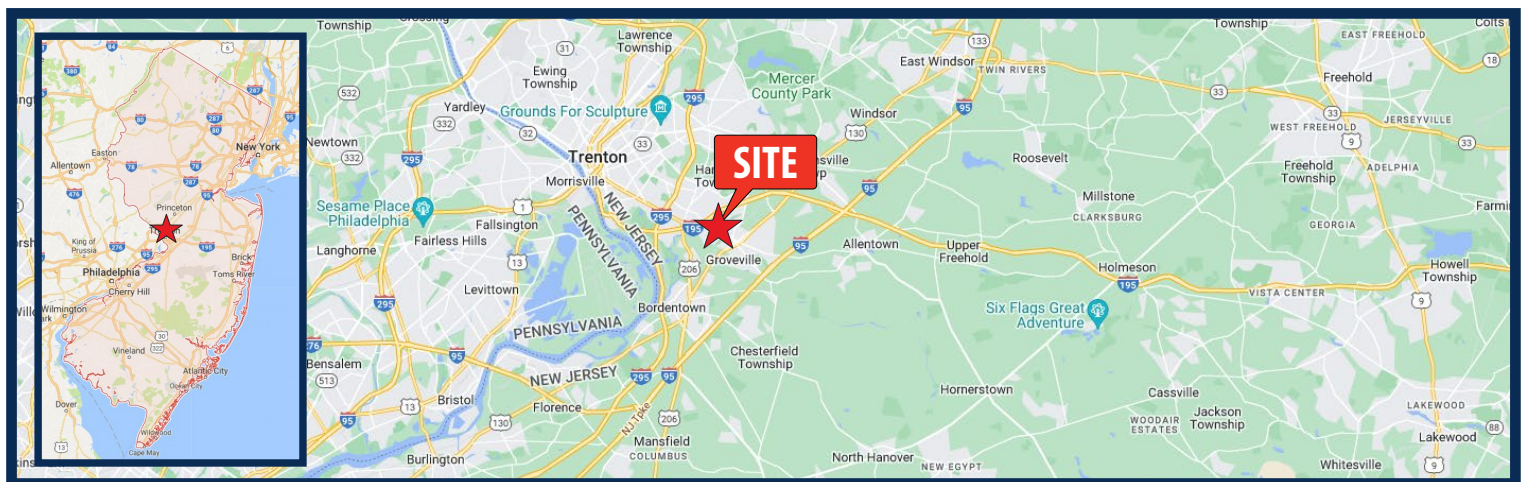

Retail for Lease - Contact

Ryan Starkman
Ph. 732-724-4501
ryan@piersonre.com

PIERSON
COMMERCIAL REAL ESTATE®