

**THE PREMIER  
DISTRIBUTION FACILITY IN THE  
WEST SAN FERNANDO VALLEY**

**NORDHOFF ST**

**FOR LEASE**

**20525 NORDHOFF STREET  
CHATSWORTH, CA 91311**

**105,984 SF AVAILABLE**

**BENNETT ROBINSON**

Vice Chairman  
Lic. 00984312  
+1 818 9074608  
bennett.robinson@cbre.com

**CBRE, INC.**

Broker Lic. 00409987  
5921 Owensmouth Ave.  
Woodland Hills, CA 91367

**CBRE, INC.**

Broker Lic. 00409987  
234 South Brand Boulevard  
Suite 800  
Glendale, CA 91204

**CBRE**



## PROPERTY HIGHLIGHT

- The Primary Distribution Facility in the West San Fernando Valley
- Eight Dock High Loading Positions with Electric Pit Load Levelers
- Energy Efficient T-8 Lighting with Motion Sensors
- Ideal for Storage/Distribution
- 24' Clearance
- Fully Sprinklered
- Previously Occupied by Movie Production and Studio Use

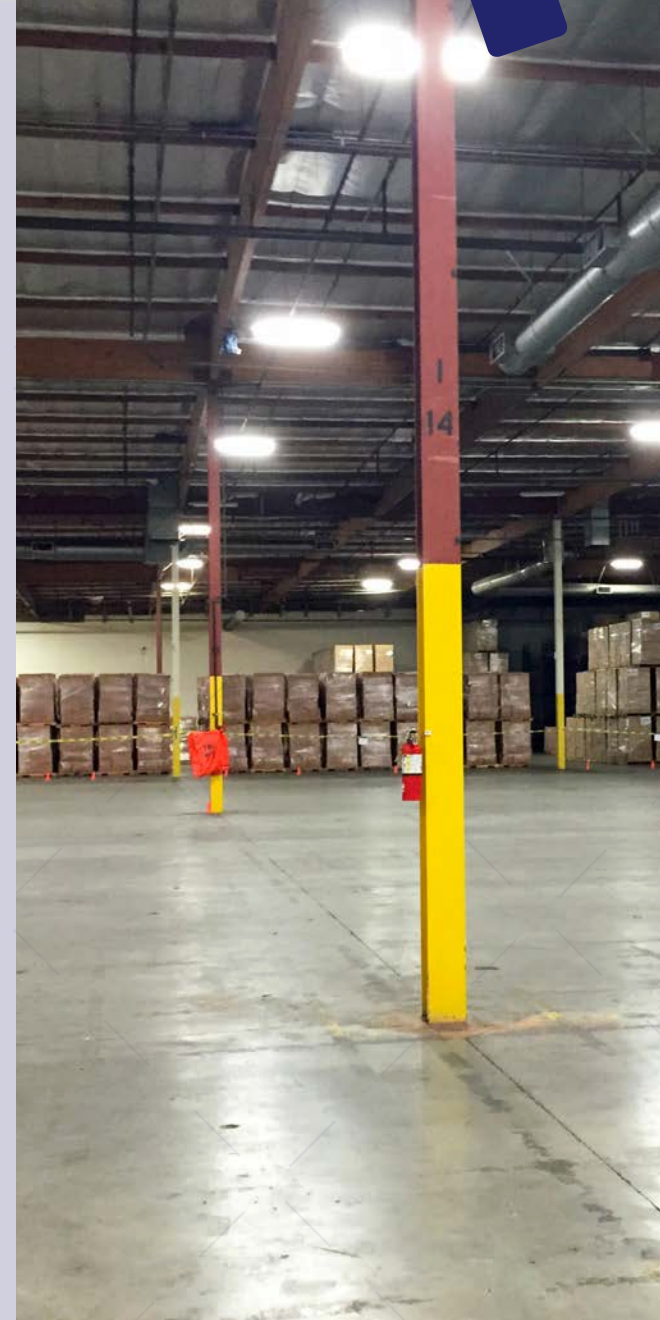

\*Photos are of the 105,984 SF portion of the building.





# SITE PLAN

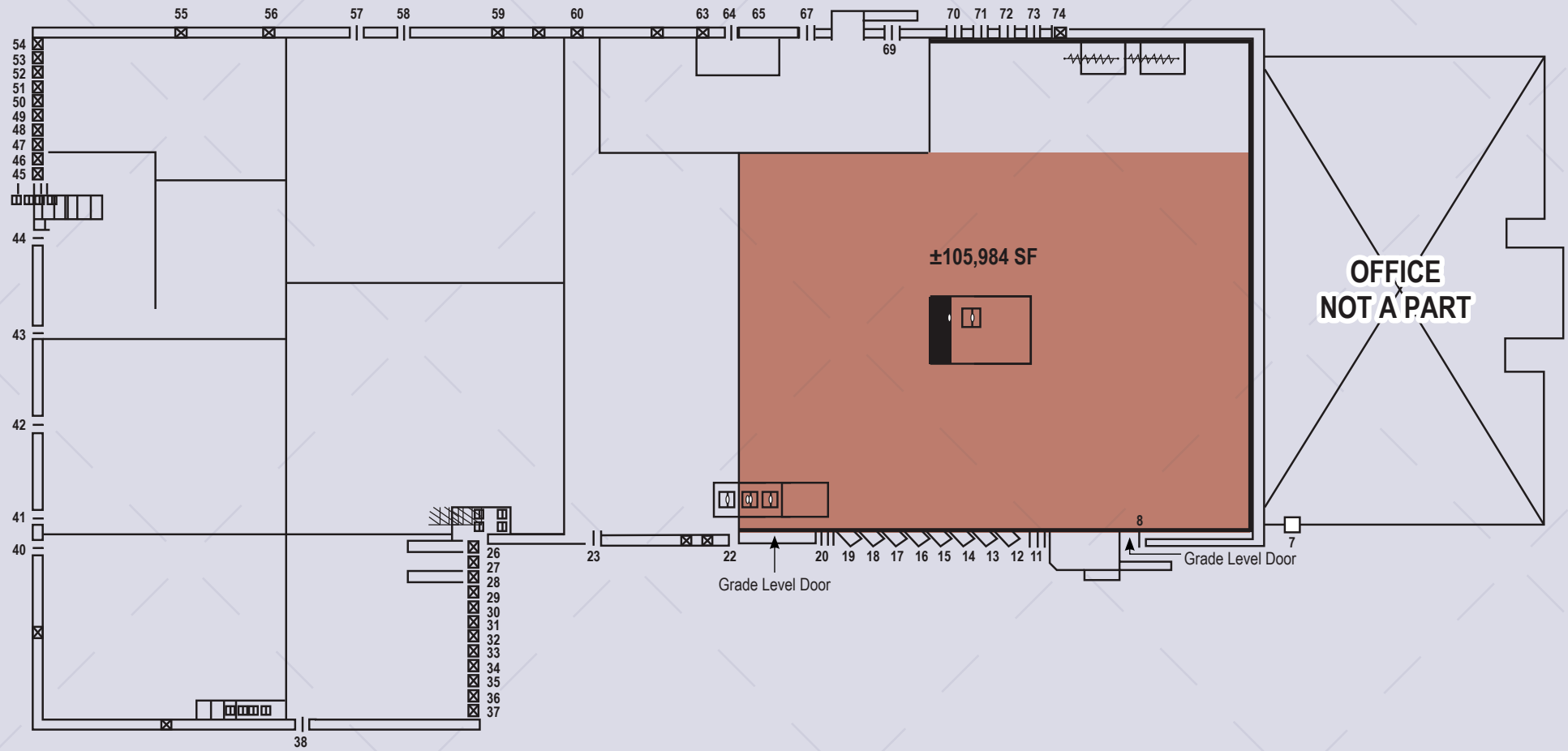



## FLOOR PLAN - ±105,984 SF

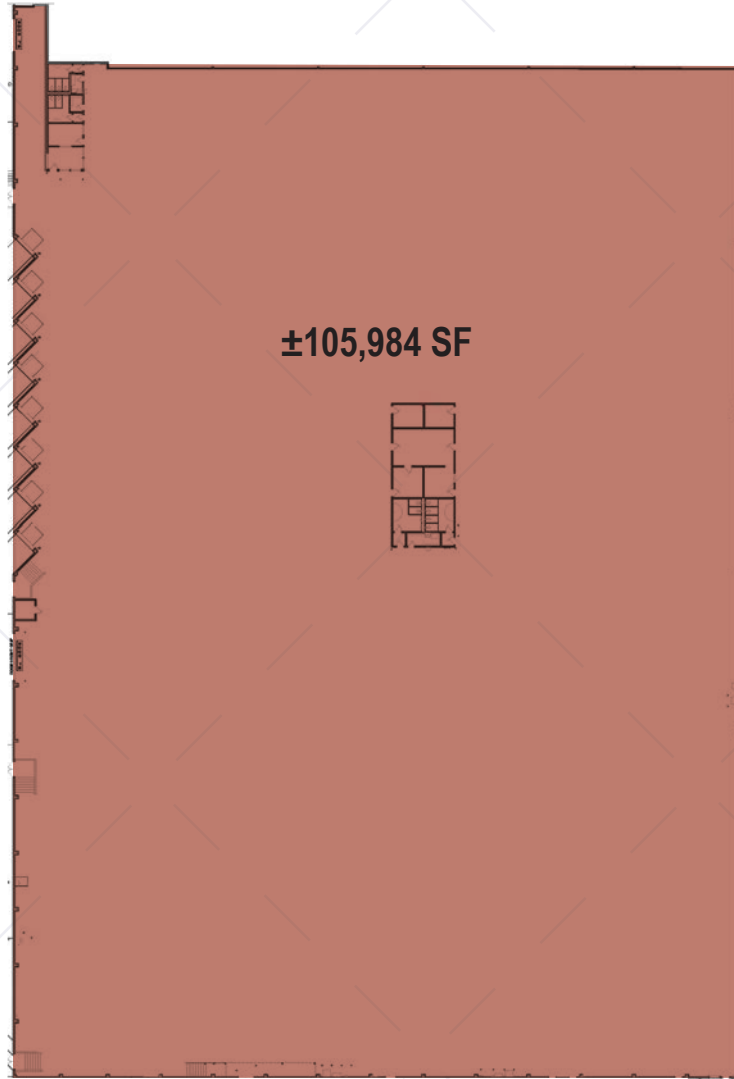

### HIGHLIGHTS:

**Available SF:** 105,984 SF

**Office SF:** 1,896 SF (7) Offices  
(4) Restrooms

**Lease Rate:** \$1.59 Industrial Gross

**Trk Hi Pos:** Eight (8) 10' X 10' Electric Loading Doors

**Grd Lev Drs:** Two Doors (1)12' X 13'-11" / (1) 18' X 16'  
(via ramp)

**Min Clr Hgt:** 24'

**Power:** 1,000 Amps, 277-480 Volt (More power available)

**Parking:** 45

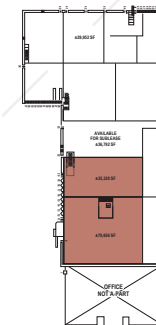



\*Photos are of the 105,984 SF portion of the building.





\*Photos are of the 105,984 SF portion of the building.



**20525 NORDHOFF STREET**  
**CHATSWORTH, CA 91311**

**LEGEND**

- |                    |                        |                    |                                |                           |                         |                    |
|--------------------|------------------------|--------------------|--------------------------------|---------------------------|-------------------------|--------------------|
| 1. WELLS FARGO     | 7. COLD STONE CREAMERY | 13. SUBWAY         | 19. CROSSFIT                   | 25. LOWE'S                | 31. MIMI'S CAFE         | 37. UPS STORE      |
| 2. CAPITAL ONE     | 8. YOGURLAND           | 14. MCDONALD'S     | 20. ORANGE THEORY FITNESS      | 26. ADT SECURITY SERVICES | 32. BREWERS ASSOCIATION | 38. US POST OFFICE |
| 3. BANK OF AMERICA | 9. BURGER KING         | 15. SUBWAY         | 21. LOCAL GROCERY              | 27. FERGUSON              | 33. APPLEBEE'S          |                    |
| 4. STARBUCKS       | 10. EL POLLO LOCO      | 16. SUBWAY         | 22. TRUE VALUE HARDWARE        | 28. ABC SUPPLY            | 34. BLACK ANGUS         |                    |
| 5. STARBUCKS       | 11. DEL TACO           | 17. CRUNCH FITNESS | 23. ALLIED BUILDING PRODUCTS   | 29. OLIVE GARDEN          | 35. FRESHII             |                    |
| 6. MENCHI'S YOGURT | 12. FARMER BOYS        | 18. LA FITNESS     | 24. GRAINGER INDUSTRIAL SUPPLY | 30. BIG BOY               | 36. LOCAL RESTAURANTS   |                    |



# 20525 NORDHOFF STREET | CHATSWORTH, CA 91311

## DRIVE TIMES FROM 20525 NORDHOFF ST.

To Los Angeles International 45 Min.  
To Burbank Airport 30 Min.

## AREA MAPS

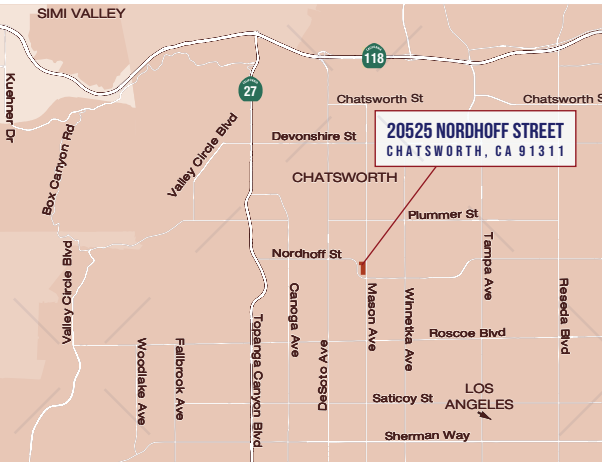

### BENNETT ROBINSON

Vice Chairman  
Lic. 00984312  
+1 818 9074608  
bennett.robinson@cbre.com

### CBRE, INC.

Broker Lic. 00409987  
5921 Owensmouth Ave.  
Woodland Hills, CA 91367

### CBRE, INC.

Broker Lic. 00409987  
234 South Brand Boulevard  
Suite 800  
Glendale, CA 91204

© 2024 CBRE, Inc. All rights reserved. This information has been obtained from sources believed reliable, but has not been verified for accuracy or completeness. You should conduct a careful, independent investigation of the property and verify all information. Any reliance on this information is solely at your own risk. CBRE and the CBRE logo are service marks of CBRE, Inc. All other marks displayed on this document are the property of their respective owners. Photos herein are the property of their respective owners and use of these images without the express written consent of the owner is prohibited.

