

LOD Submittal Review

Approved Approved As Corrected
 Rejected Revise And Resubmit

THE BASE BUILDING INFORMATION DEPICTED ON THIS DRAWING IS PRELIMINARY AND SUBJECT TO CHANGE. ALL FINAL INFORMATION, DIMENSIONS, UTILITY LOCATIONS, ACTUAL FIELD CONDITIONS, ETC., MUST BE FIELD VERIFIED BY TENANT PRIOR TO THE DEVELOPMENT AND COMPLETION OF THE TENANT FIT-OUT DRAWINGS.

By: _____
Date: _____

REV	DATE	COMMENTS

**PRELIMINARY DRAWING
SUBJECT TO FIELD VERIFICATION**

• ALL DIMENSIONS ARE SUBJECT TO FIELD VERIFICATION.

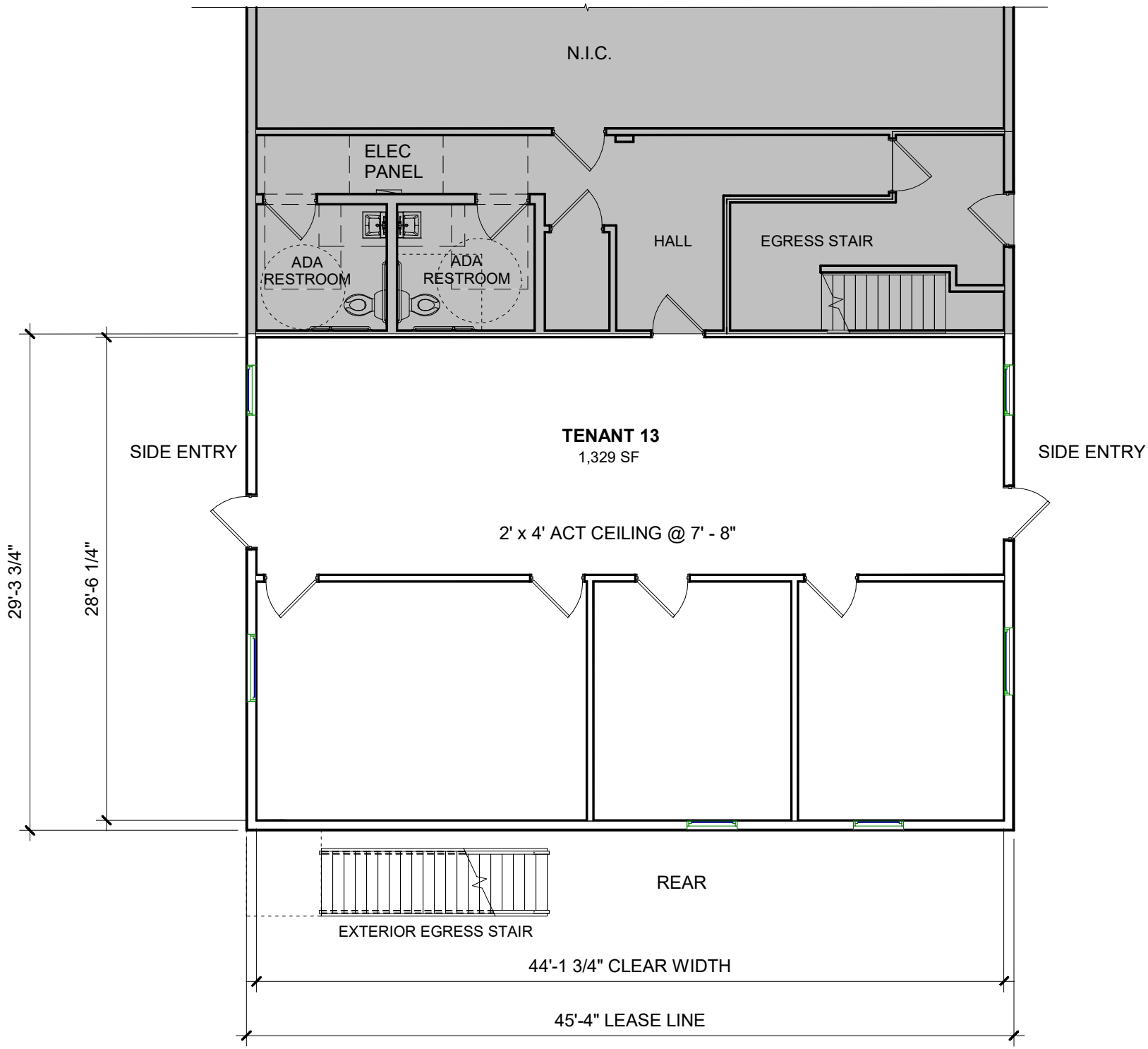

NOTE: SPACE IS NOT SPRINKLERED

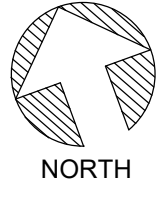

1 UNIT 13 LOD PLAN (FIRST FLOOR)
1/8" = 1'-0"

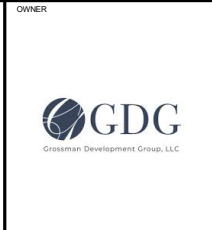
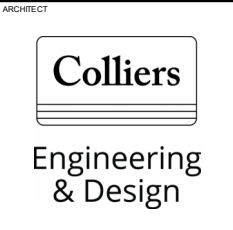

GROSSMAN DEVELOPMENT

OLD LYME MARKETPLACE
90 HALLS ROAD, OLD LYME, CT 06371

DISCLAIMER:
THIS DRAWING IS THE PROPERTY OF COLLIERS ENGINEERING & DESIGN AND IS NOT TO BE REPRODUCED OR COPIED IN WHOLE OR IN PART. THIS DRAWING IS TO BE USED FOR THIS SPECIFIC PROJECT ONLY AND NOT TO BE USED ON ANY OTHER PROJECT. THIS DRAWING SHALL BE RETURNED TO COLLIERS ENGINEERING & DESIGN UPON WRITTEN REQUEST.

Colliers Engineering & Design,
Architecture, Landscape Architecture,
Surveying, CT P.C.

DATE: 1/20/2026 6:35:54 PM
PROJECT NO: 23365

DRAWING NO.
LOD 13
UNIT 13

DRAWN BY: JC
CHECKED BY: RK