

CLASS A MEDICAL OFFICE/RETAIL OPPORTUNITY

7990 SUMMERLIN LAKES DRIVE, FORT MYERS, FL 33907

NEW CONSTRUCTION FOR LEASE



RICK IKELER

Senior Advisor

239.334.3040

Rick.Ikeler@TrinityCRE.com

DAN O'BERSKI

Partner

SCOTT MERSINGER

Senior Advisor

ANTHONY GAMBINO

ASSOCIATE

CLASS A MEDICAL OFFICE/RETAIL OPPORTUNITY

7990 SUMMERLIN LAKES DR • FORT MYERS, FL 33907

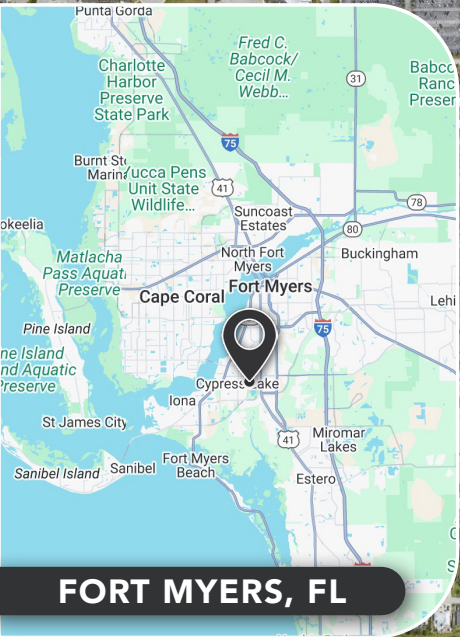

2025 DEMOGRAPHICS

7990 SUMMERLIN LAKES DR

- AVERAGE H.H INCOME
- POPULATION
- EMPLOYMENT DENSITY

	1 MILE	3 MILE	5 MILE
AVERAGE H.H INCOME	\$80,020	\$101,970	\$113,012
POPULATION	10,166	63,373	143,387
EMPLOYMENT DENSITY	6,520	45,822	93,972

PROPERTY FEATURES

- PRICE** \$26.50 PSF/YR & Est. NNN at \$7.50 PSF/YR
- AVAILABLE** Unit A - 1,400± SF
Unit B - 1,400± SF
Contiguous - 2,800± SF
- ZONING** CC (Community Commercial)
- LOCATION** Located on Summerlin Lakes Drive, near key medical and financial centers, with quick access to major roads.



TrinityCRE.com
9450 Corkscrew Palms Cir • Suite 101 • Estero, FL 33928
© 2025 Trinity Commercial Group
This information is considered accurate, but not guaranteed.



CLASS A MEDICAL OFFICE/RETAIL OPPORTUNITY

7990 SUMMERLIN LAKES DRIVE, FORT MYERS, FL 33907

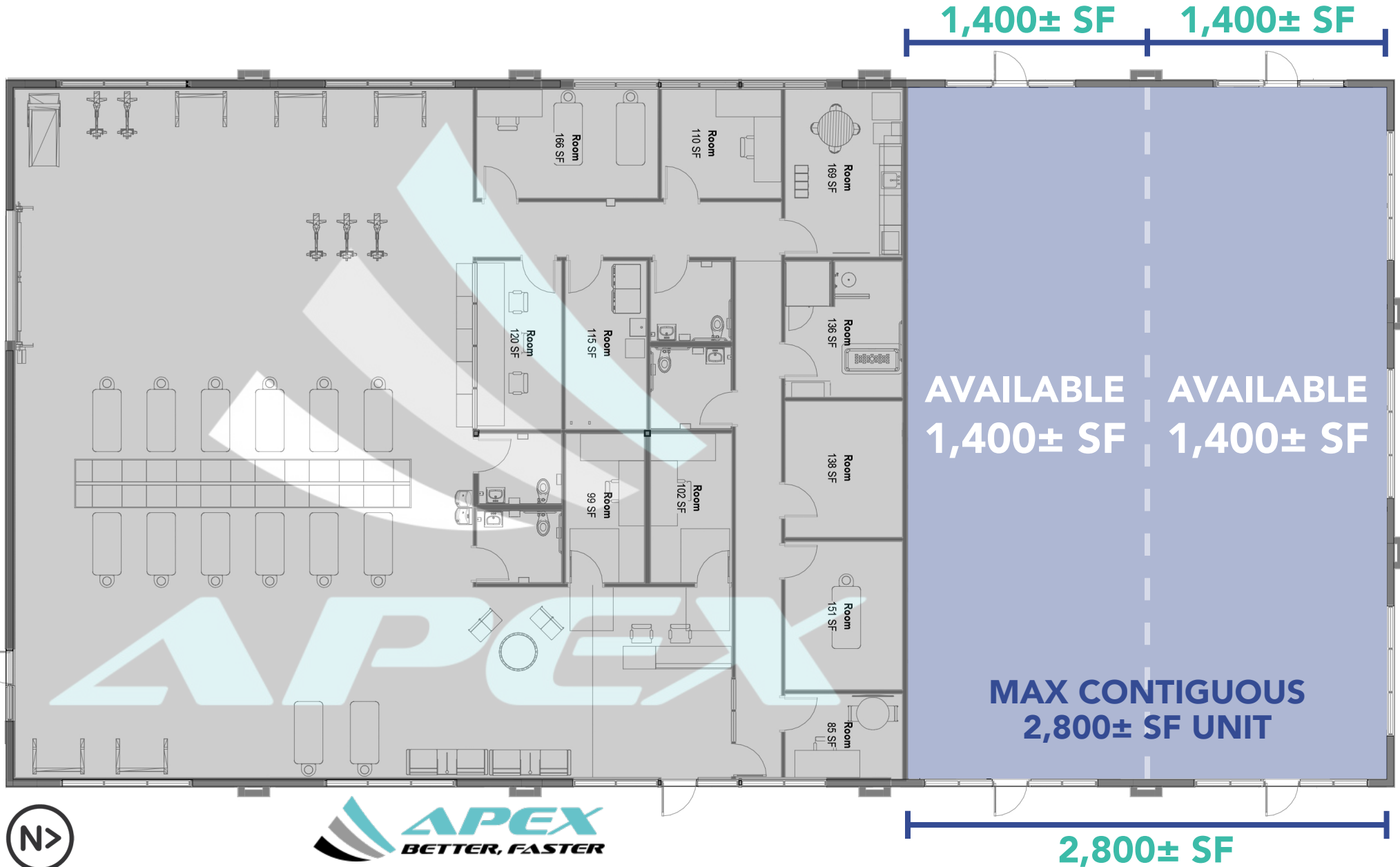

TrinityCRE.com

9450 Corkscrew Palms Cir • Ste 101 • Estero, FL 33928

© 2025 Trinity Commercial Group

This information is considered accurate, but not guaranteed.



CLASS A MEDICAL OFFICE/RETAIL OPPORTUNITY

7990 SUMMERLIN LAKES DRIVE, FORT MYERS, FL 33907



TrinityCRE.com

9450 Corkscrew Palms Cir • Ste 101 • Estero, FL 33928

© 2025 Trinity Commercial Group

This information is considered accurate, but not guaranteed.

