

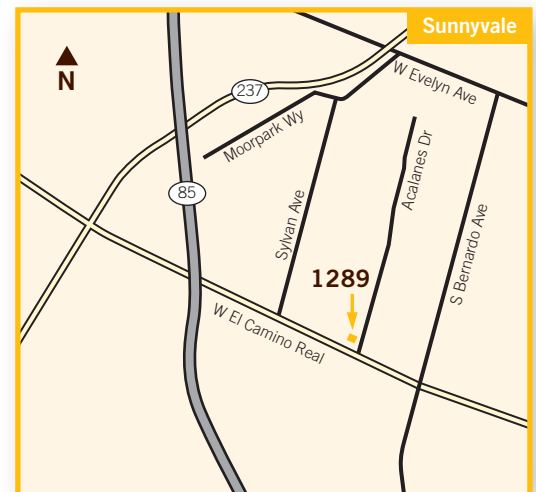

±9,000 sq ft retail space for lease

1289 W. El Camino Real, Sunnyvale

- 121' frontage on W. El Camino Real
- 100% HVAC high-bay showroom improvements
- Grade level loading
- Minimum clear height 13' 8"
- 4/1000 parking
- Building and pole signage available
- Prominent visibility and easy access on W. El Camino Real near Highways 85 and 237
- Non-signalized Southbound left turn lane into property
- ECR-C zoning
- Available September 1, 2026



Geordie McKee · Dave Conklin 650.321.3040
Lic. 01257296 Lic. 01036562

±9,000 sq ft retail space for lease
1289 W. El Camino Real, Sunnyvale

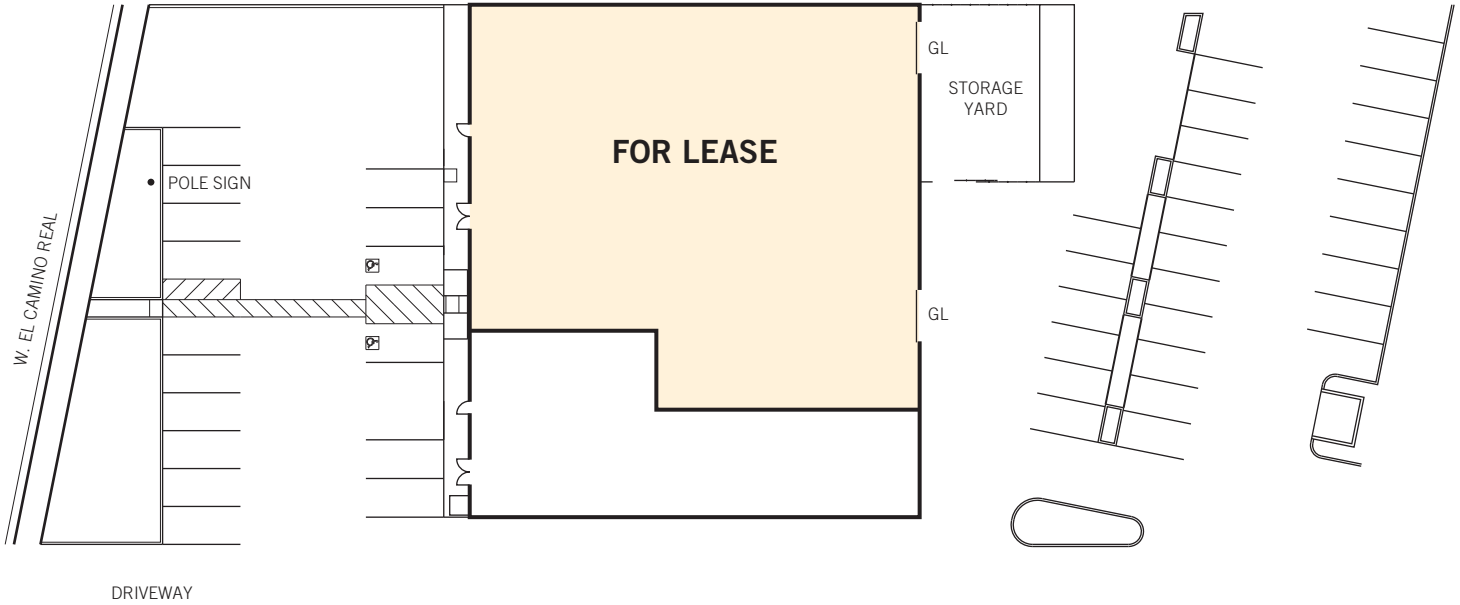

Floor plans may not be to scale.
The information contained herein has been obtained from sources we deem reliable. We have no reason to doubt its accuracy, but we do not guarantee it. All information should be verified prior to lease.

Geordie McKee · Dave Conklin 650.321.3040
Lic. 01257296 Lic. 01036562

±9,000 sq ft retail space for lease

1289 W. El Camino Real, Sunnyvale



Floor plans may not be to scale.
The information contained herein has been obtained from sources we deem reliable. We have no reason to doubt its accuracy, but we do not guarantee it. All information should be verified prior to lease.

Geordie McKee · Dave Conklin 650.321.3040
Lic. 01257296 Lic. 01036562