

2465

DOGWOOD WAY

Vista, CA 92081

FLEXIBLE INDUSTRIAL
OPPORTUNITY WITH
EXPANSION POTENTIAL

12,865 SQUARE
FEET AVAILABLE



CBRE

BUILDING SPECIFICATIONS



SIZE

12,865 SF
AVAILABLE



PROPERTY MIX

±1,588 SF
OFFICE

±11,277 SF
WAREHOUSE



YEAR BUILT

1989



CLEAR HEIGHT

18'



POWER

**800A/
120-208V**



LOADING

2 DOCK
HIGH DOORS

1 GRADE LEVEL
DOORS

2 BOX TRUCK
LOADING DOCKS



LEASE RATE

\$1.25/SF NNN



NNNs

\$0.19



AVAILABLE

**30 DAYS
NOTICE**



FLOOR PLAN

SUITE 102

13,225 SF



LEASE RATE

\$1.25 NNN

Suite 102



LOADING DOORS

2 DOCK HIGH DOORS

1 GRADE LEVEL DOOR

2 GRADE LEVEL DOOR

▲ DOCK HIGH LOADING

● GRADE LEVEL LOADING

■ BOX LOADING

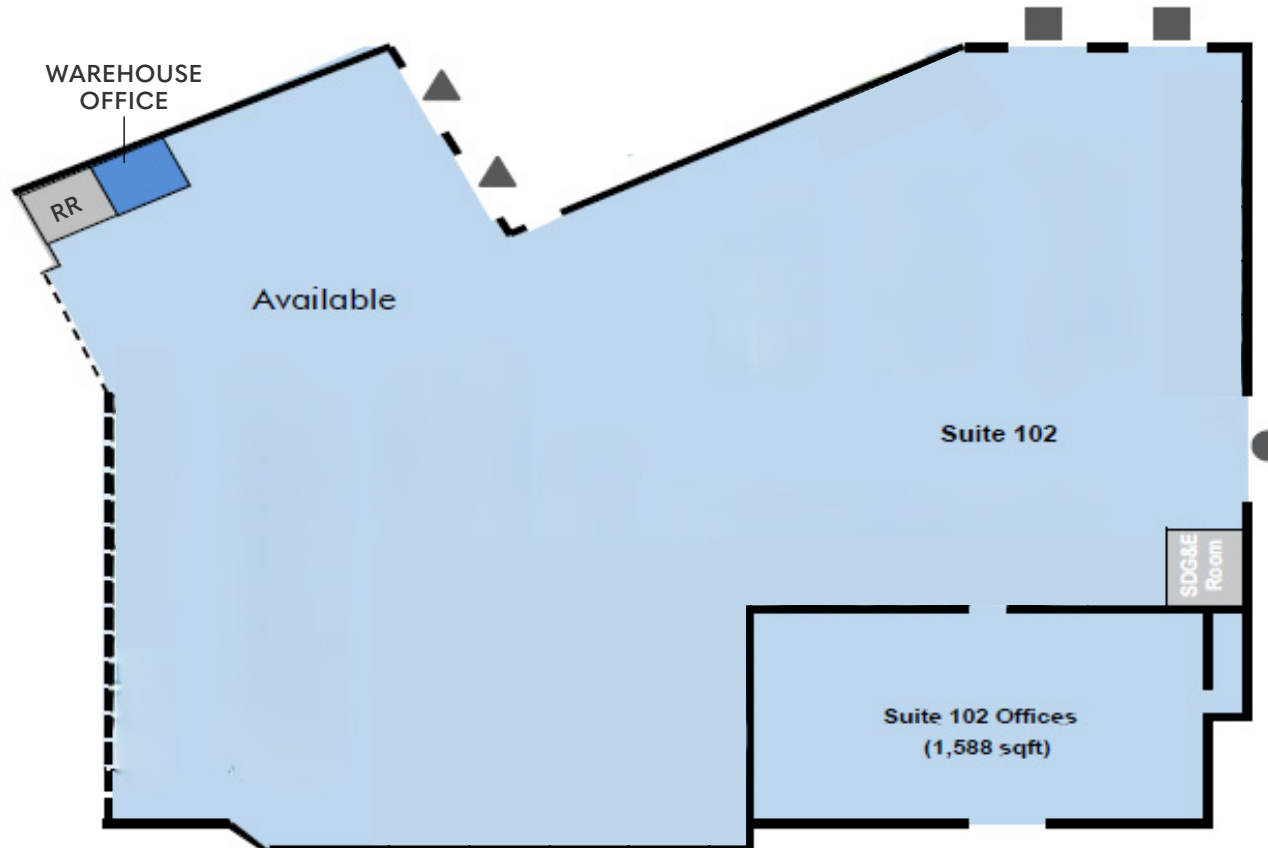

POTENTIAL EXPANSION

2459 DOGWOOD WAY & 2465 DOGWOOD WAY

Suites can be leased separately or combined via grade-level doors located directly across from one another for a total of 38,860 SF.



TOTAL SIZE

38,680 SF

AVAILABLE

**2459 DOGWOOD WAY
SUITE 100:
25,815 SF AVAILABLE**

**2465 DOGWOOD WAY
SUITE 102:
12,865 SF AVAILABLE**

[CLICK HERE TO VIEW
2459 DOGWOOD WAY
BROCHURE](#)





2465

DOGWOOD WAY

Vista, CA 92081

CONTACT US

ROGER CARLSON

SENIOR VICE PRESIDENT
+1 760 438 8533
roger.carlson@cbre.com
LIC. 01236185

BLAKE WILSON

SENIOR VICE PRESIDENT
+1 760 438 8587
blake.wilson@cbre.com
LIC. 02001878

DON TRAPANI

VICE PRESIDENT
+1 760 438 8539
don.trapani@cbre.com
LIC. 01208252

© 2026 CBRE, Inc. All rights reserved. This information has been obtained from sources believed reliable, but has not been verified for accuracy or completeness. You should conduct a careful, independent investigation of the property and verify all information. Any reliance on this information is solely at your own risk. CBRE and the CBRE logo are service marks of CBRE, Inc. All other marks displayed on this document are the property of their respective owners, and the use of such logos does not imply any affiliation with or endorsement of CBRE. Photos herein are the property of their respective owners. Use of these images without the express written consent of the owner is prohibited.



CBRE