

19500 VENTURA



TARZANA'S PREMIER MEDICAL OFFICE BUILDING



COMING SOON

Dental & Medical Office Spec Suites

HIGH END MEDICAL SUITES

SURGERY CENTER

URGENT CARE

AVAILABLE FOR LEASE



THE 19500 VISION

A transformative project in Tarzana to bring inspiration to the health industry.

Create a better patient experience with an open air atrium designed with stylish and creative finishes.

- Rate: \$4.20 NNN

AVAILABILITIES

- 2nd Floor: 1,852 RSF – 10,364 RSF

Schedule a tour now.

Leasing information:

Scott Romick, Principal

Lee & Associates® - LA North/Ventura, Inc.
818-933-0305
sromick@lee-re.com
DRE #01323527

Eugene Kim, Principal

Lee & Associates® - LA North/Ventura, Inc.
818-444-4919
ekim@lee-re.com
DRE #01521416



19500 VENTURA: FIRST FLOOR PLAN

VENTURA BLVD

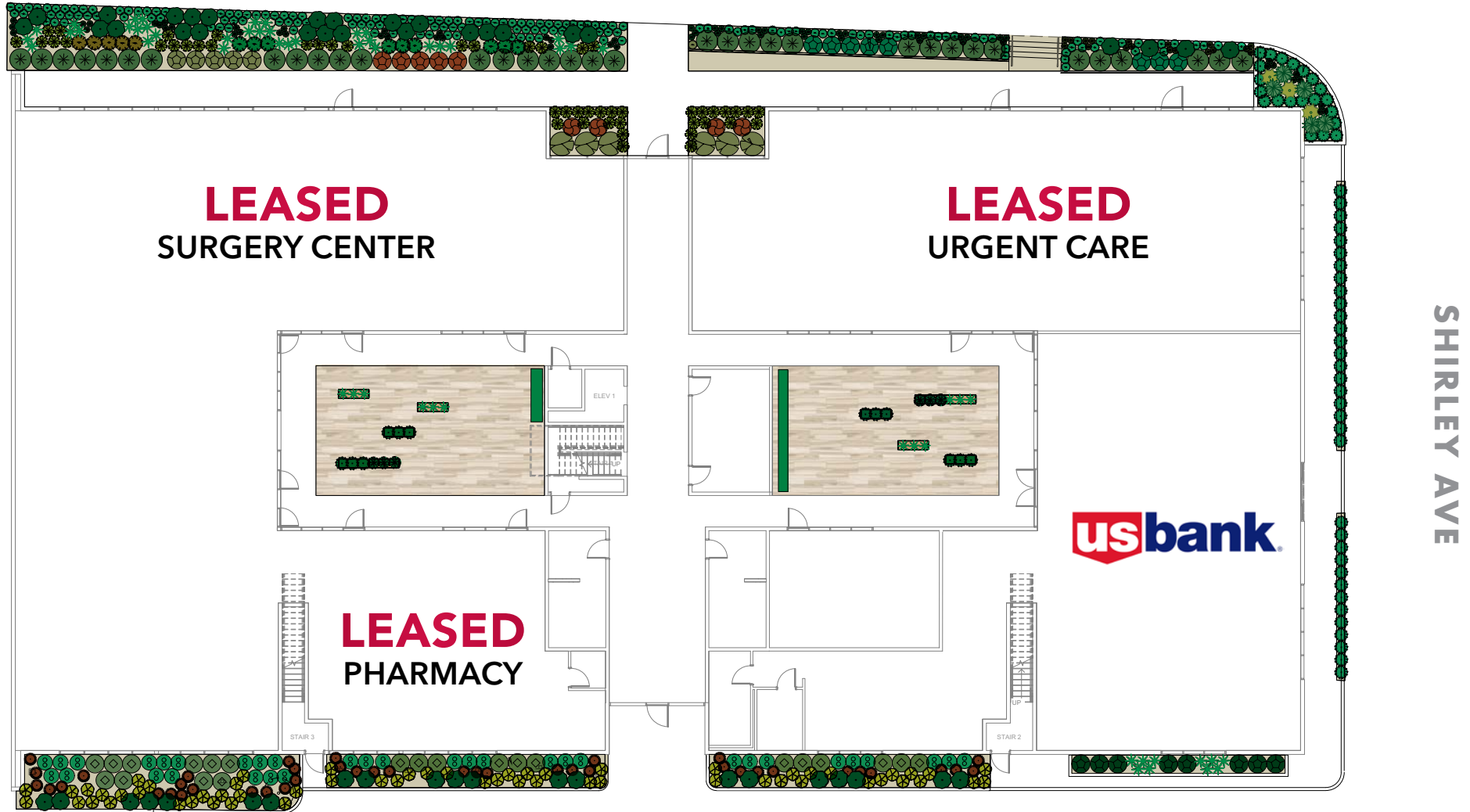

19500 VENTURA: SECOND FLOOR PLAN

VENTURA BLVD

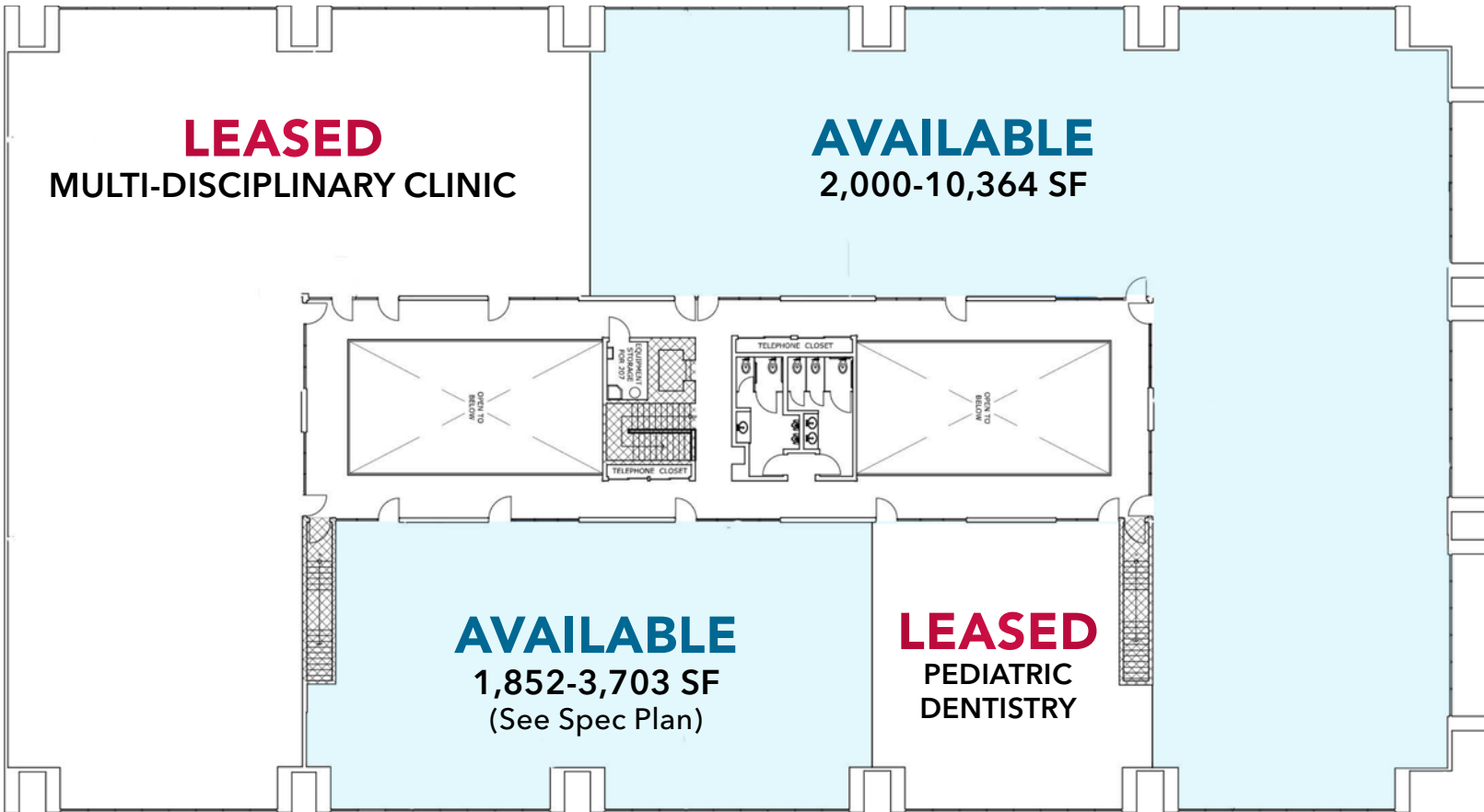

SHIRLEY AVE



19500 VENTURA: SPEC DENTAL OFFICE | MEDICAL OFFICE

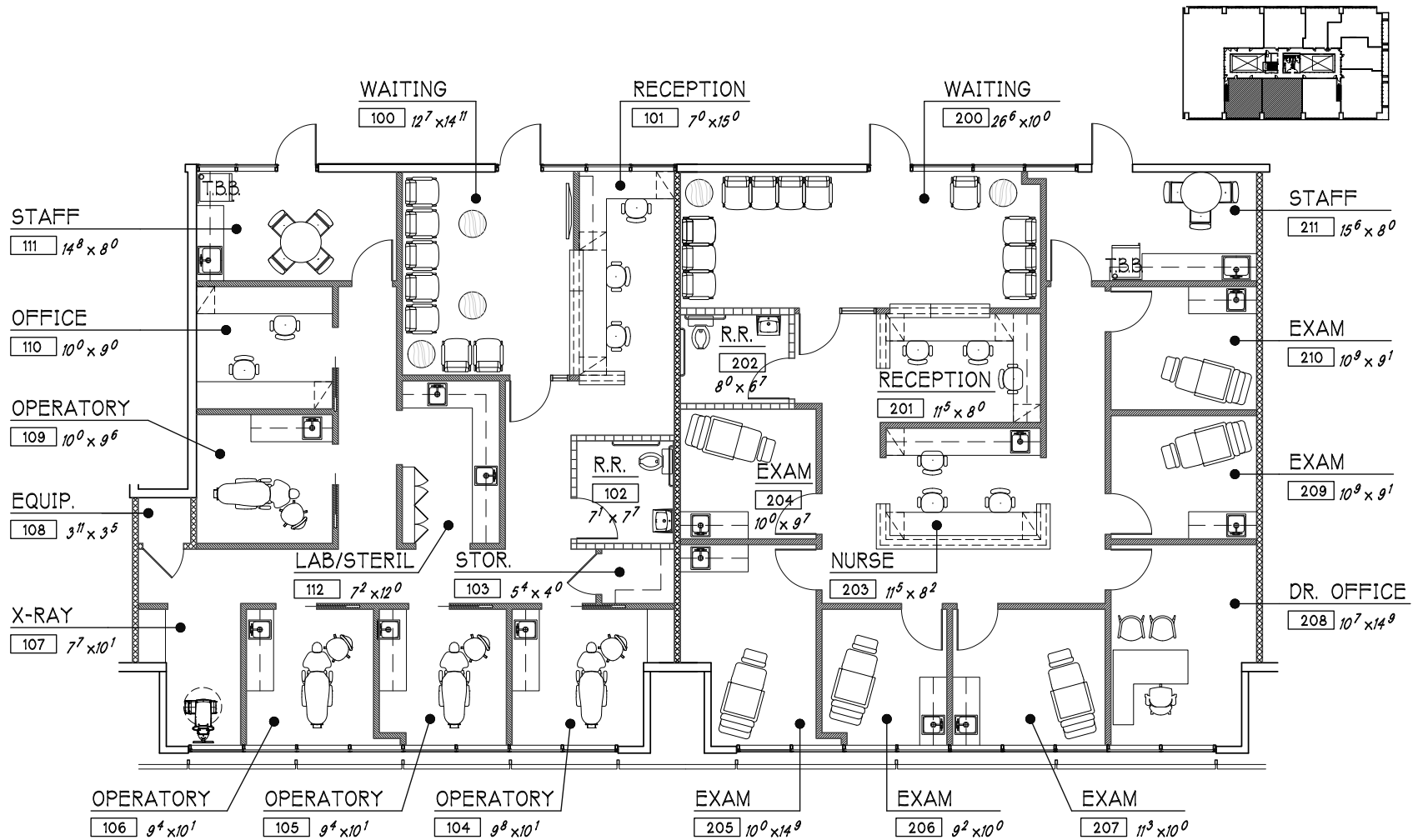



19500 VENTURA: NEIGHBORHOOD AMENITIES

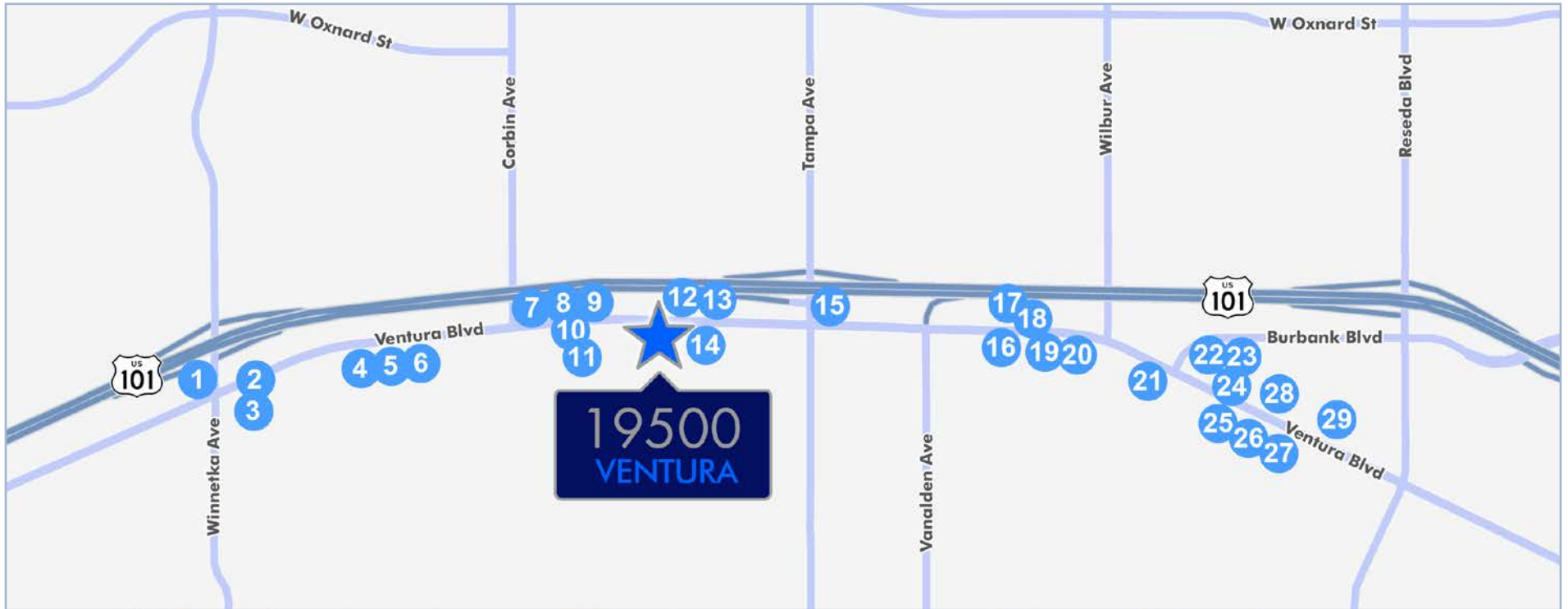

- | | | |
|--------------------------|----------------------------|-----------------------------|
| 1 Starbucks | 11 So Sushi | 21 California Pizza Kitchen |
| 2 Chase Bank | 12 Mon Japanese Restaurant | 22 Hummus Bar & Grill |
| 3 Chick-fil-A | 13 Starbucks | 23 Waba Grill |
| 4 In-N-Out Burger | 14 Jersey Mike's Subs | 24 Kushiyu |
| 5 Wells Fargo Bank | 15 Citibank | 25 Whole Foods Market |
| 6 Bank of the West | 16 Tel Aviv Fish Grill | 26 Chipotle Mexican Grill |
| 7 Ancora Cucina Italiana | 17 Magpies Soft Serve | 27 Blu Jam Cafe |
| 8 Sol Y Luna | 18 Peet's Coffee | 28 Kravings |
| 9 Green Cottage | 19 Marco's Pizza | 29 The Carving Board |
| 10 Zankou Chicken | 20 Cici's Cafe | |

THERE ARE OVER
100 RESTAURANTS
WITHIN A
2-MILE RADIUS OF
19500 VENTURA

19500 VENTURA: AREA HOSPITALS

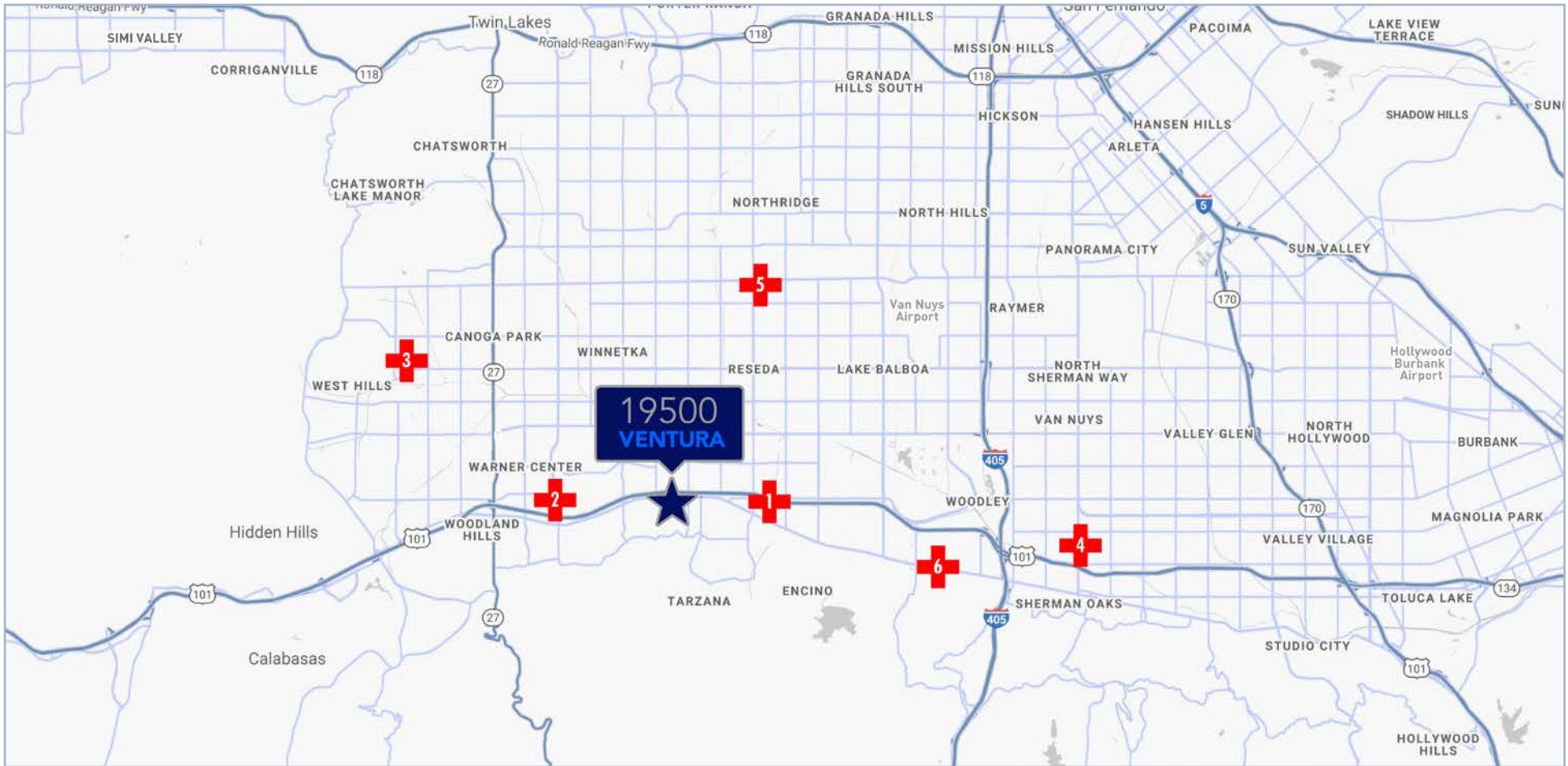

AREA HOSPITALS

	HOSPITAL NAME	DISTANCE
1	Cedars-Sinai Tarzana Medical Center Providence	1.7 Miles
2	Kaiser Permanente Medical Center - Woodland Hills	2.3 Miles
3	UCLA West Valley Medical Center	6 Miles
4	Sherman Oaks Hospital	7 Miles
5	Dignity Health Northridge Hospital Medical Center	5 Miles
6	Encino Hospital Medical Center	4.9 Miles

DEMOGRAPHICS

	2-Miles	3-Miles	5-Miles
POPULATION			
2023 Population	75,131	203,808	423,044
HOUSEHOLDS			
2023 Households	27,414	75,029	148,053



19500 VENTURA: MAJOR HOTELS



For details on leasing at 19500 VENTURA:

Scott Romick, Principal

Lee & Associates® - LA North/Ventura, Inc.

818-933-0305

sromick@lee-re.com

DRE #01323527

Eugene Kim, Principal

Lee & Associates® - LA North/Ventura, Inc.

818-444-4919

ekim@lee-re.com

DRE #01521416



COMMERCIAL REAL ESTATE SERVICES

Lee & Associates® - LA North/Ventura, Inc. Corp. #01191898

A Member of the Lee & Associates® Group of Companies

15060 Ventura Blvd., Suite 100 • Sherman Oaks, CA 91403

P:818.986.9800 F:818.933.0405

www.leelanorth.com

No warranty or representation is made as to the accuracy of the foregoing information. Terms of sale or lease and availability are subject to change or withdrawal without notice.