

# ELM BUSINESS PARK

COVENTRY ROAD, BROUGHTON ASTLEY  
LEICESTERSHIRE LE9 6QF

New High Quality Industrial and Warehouse space  
UNIT 4 **8,400 sq.ft.**

FOR SALE / TO LET



[www.brackley-propdev.co.uk](http://www.brackley-propdev.co.uk)



**BRACKLEY**  
PROPERTY DEVELOPMENTS

# ELM BUSINESS PARK

COVENTRY ROAD, BROUGHTON ASTLEY  
LEICESTERSHIRE LE9 6QF

## DESCRIPTION

A comprehensive design and build mixed use development on a strategically located and prominent site located in Broughton Astley. Phase One of the scheme will comprise industrial and warehouse units and the planning has been implemented with consent in place.

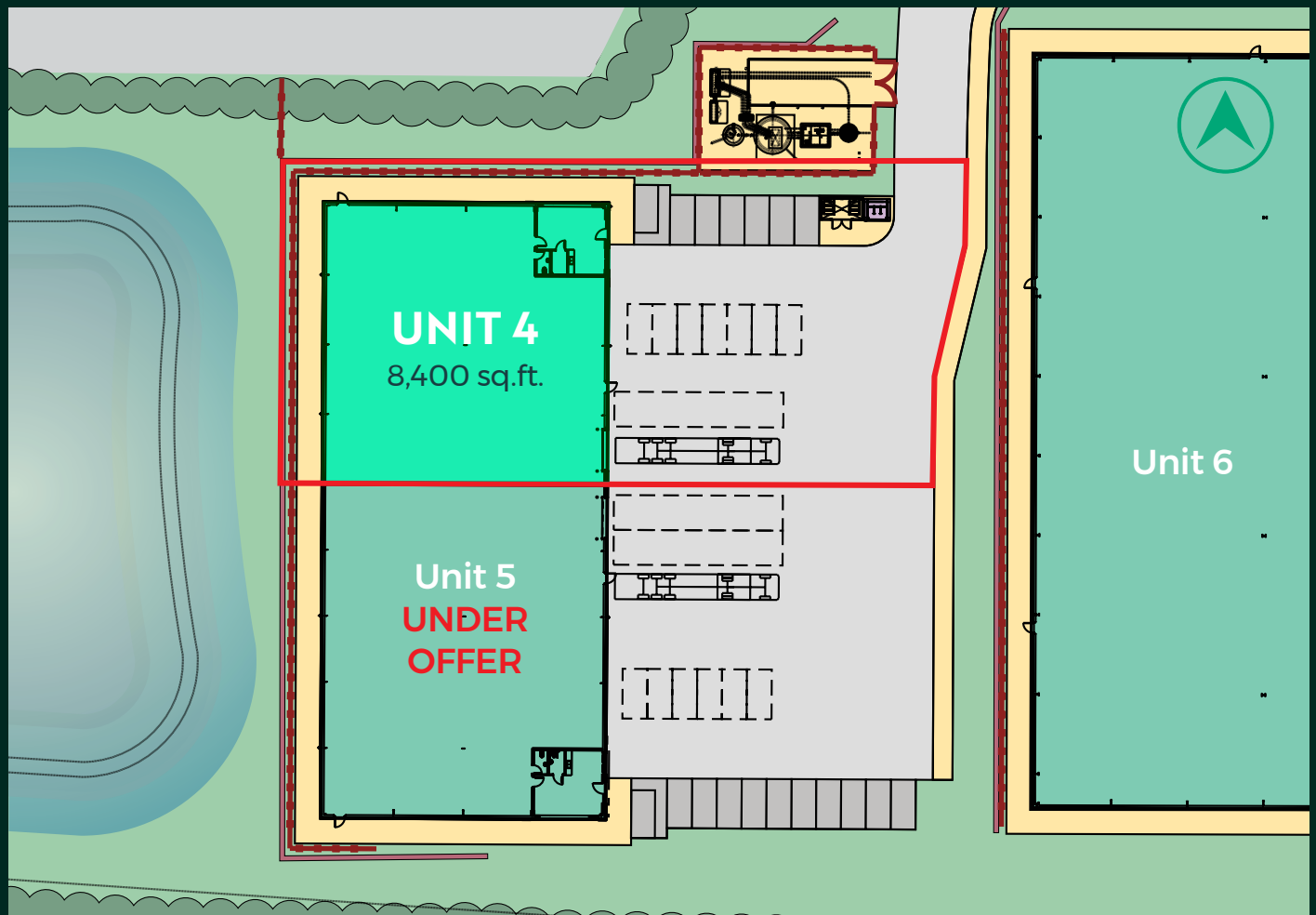
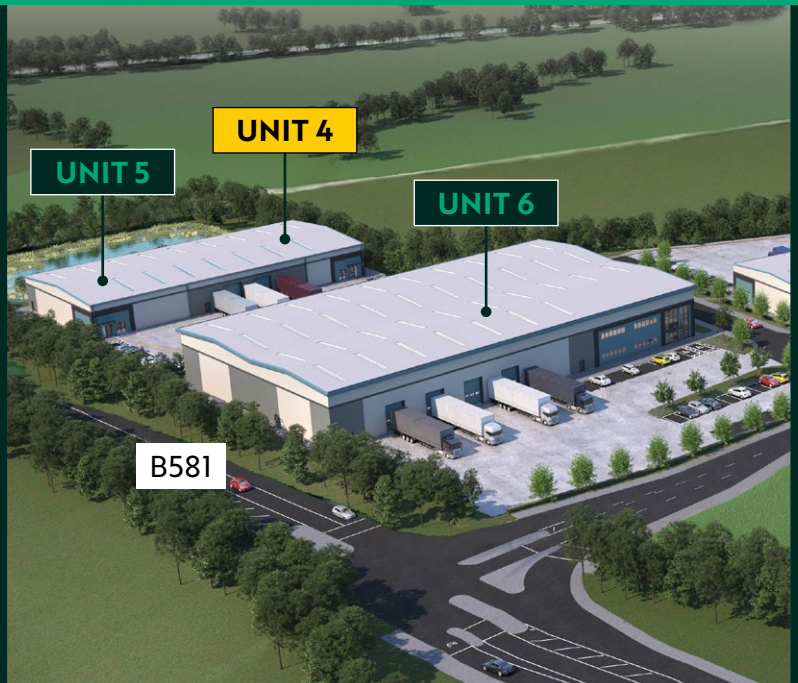

## SPECIFICATION



7m eaves height

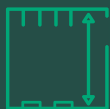

34m minimum yard depth



Good parking allocation



Easy access to M6 / M69 / M1



Delivery within 12 months



Expansion land available

# ELM BUSINESS PARK

COVENTRY ROAD, BROUGHTON ASTLEY  
LEICESTERSHIRE LE9 6QF

## LOCATION

Broughton Astley is located approximately 10 miles south of the Leicester city centre and circa 7 miles east of Hinckley.

The development is strategically located on the north side of Broughton Way within close proximity of major road networks and local facilities and amenities in the Broughton Astley centre.

Destination	Miles	Minutes
M1/M69 Junction 21	6	14
M69 Junction 1	6.5	11
M69 Junction 2	3.5	7
M1 Junction 20	8	15
A5	5	9
M6 Junction 2	13	17
East Midlands Airport	25	33
Birmingham Airport	30.5	37

## TERMS

More detailed information is available upon request.

A DEVELOPMENT BY



**BRACKLEY**  
PROPERTY DEVELOPMENTS

[www.brackley-propdev.co.uk](http://www.brackley-propdev.co.uk)

**Stephen Pedrick-Moyle**

0116 326 2030 · 07831 553787

[stephen.pedrick-moyle@brackley-propdev.co.uk](mailto:stephen.pedrick-moyle@brackley-propdev.co.uk)

[Click here for Google map link](#)

**what3words link:**  
[dignify.bulge.paint](https://www.what3words.com/dignify.bulge.paint)

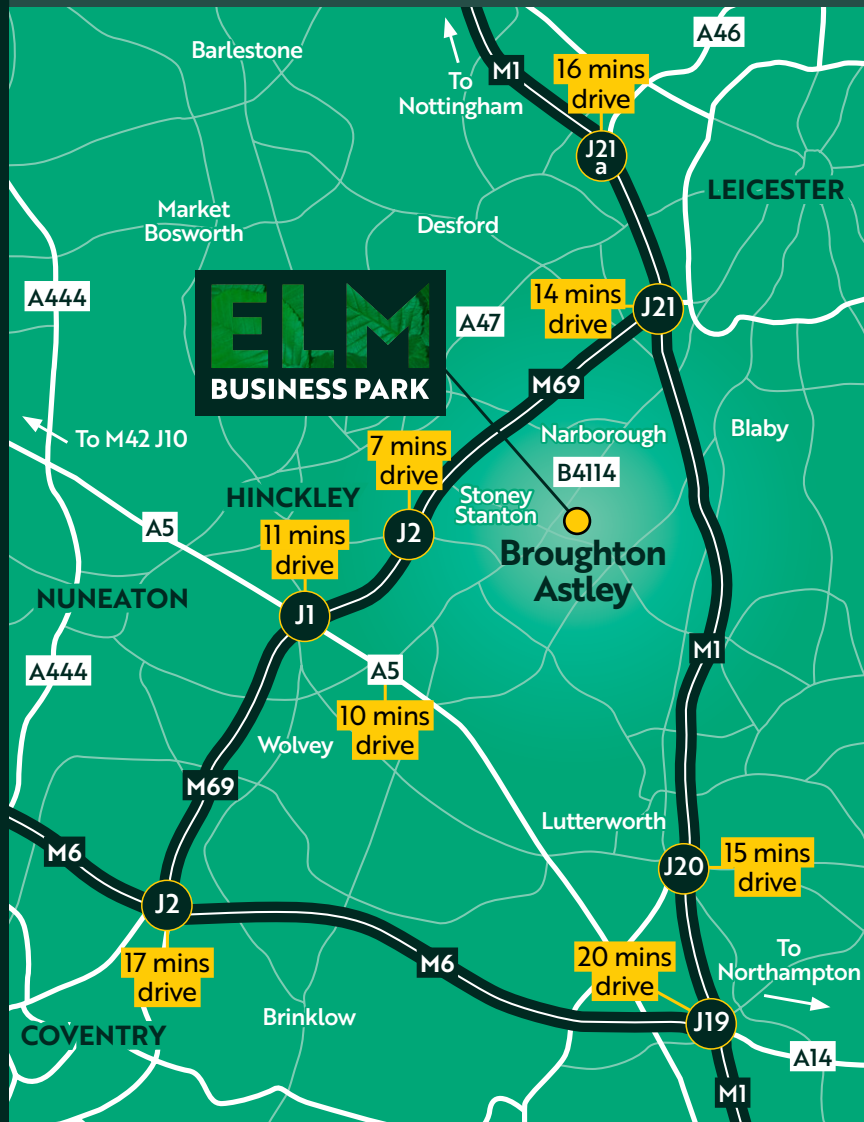

## VIEWING & FURTHER INFORMATION

Viewing strictly by prior appointment with the joint agents.

**ANDREW+  
ASHWELL**

0116 254 1220  
[andash.co.uk](http://andash.co.uk)

**Mike Allwood**  
07969 149 386  
[mra@andash.co.uk](mailto:mra@andash.co.uk)

**Joe Reilly**  
07802 436 636  
[jtr@andash.co.uk](mailto:jtr@andash.co.uk)

**bray fox smith** [brayfoxsmith.com](http://brayfoxsmith.com)

**01908 061260  
020 7629 5456**

**Ian Leather**  
07860 612 242  
[ianleather@brayfoxsmith.com](mailto:ianleather@brayfoxsmith.com)

**Joss Burrows**  
07342 341 727  
[jossburrows@brayfoxsmith.com](mailto:jossburrows@brayfoxsmith.com)

Andrew Ashwell for themselves and for the vendors or lessors of this property for whom they act, give notice that (i) these particulars are a general outline only, for the guidance of prospective purchasers or tenants, and do not constitute the whole or any part of an offer or contract. (ii) Andrew Ashwell cannot guarantee the accuracy of any description, dimensions, references to condition, necessary permissions for use and occupation and other details contained herein and prospective purchasers or tenants must not rely on them as statements of fact of representations and must satisfy themselves as to their accuracy. (iii) No employee of Andrew Ashwell has any authority to make or give any representations or warranty or enter into any contract whatever in relation to this property. (iv) Rents quoted in these particulars may be subject to VAT in addition; and (v) Andrew Ashwell will not be liable, in negligence or otherwise, for any loss arising from the use of these particulars. September 2025

Created by CARVE [carve-design.co.uk](http://carve-design.co.uk) 17213/U4/6