

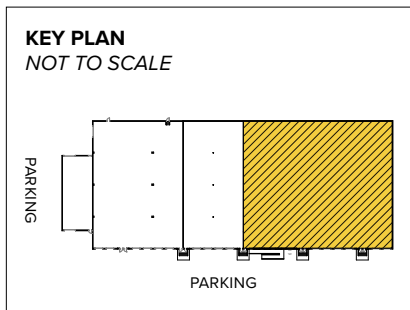

Total SF Available:
22,750 SF

*Bulk warehouse space with
22' clear height, restroom,
with 8x10' dock doors (6)*



Note: This space plan is subject to existing field conditions. This drawing is proprietary and the exclusive property of St. John Properties, Inc. Any duplications, distribution, or other unauthorized use is strictly prohibited.

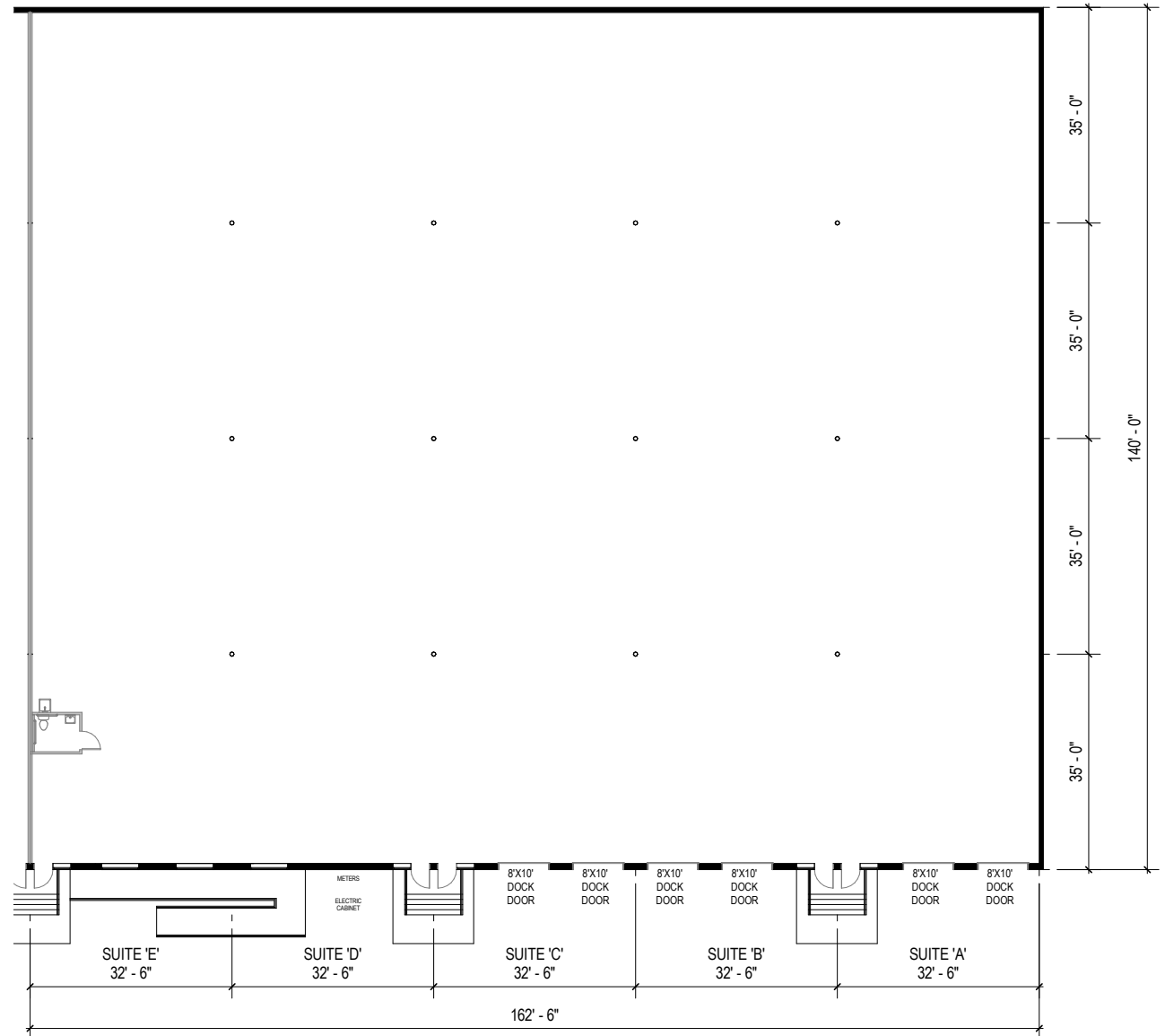



2009–2013 Beaver Road

Hyattsville, MD 20785

About the Property

2009–2013 Beaver Road is located in Hyattsville, MD and benefits from convenient access to the area's major roadways, with close proximity to Washington D.C. Abundant surface parking and dock loading is available.

Bulk/Warehouse Buildings

2009 Beaver Road	31,850 SF
------------------	-----------

2013 Beaver Road	16,554 SF
------------------	-----------

Bulk/Warehouse Specifications

Suite Sizes	4,550 up to 31,850 SF
-------------	-----------------------

Ceiling Height	22 ft. clear minimum
----------------	----------------------

Offices	Built to suit
---------	---------------

Zoning	I-2
--------	-----



For more information on Beaver Road, visit: sjpi.com/beaverroad

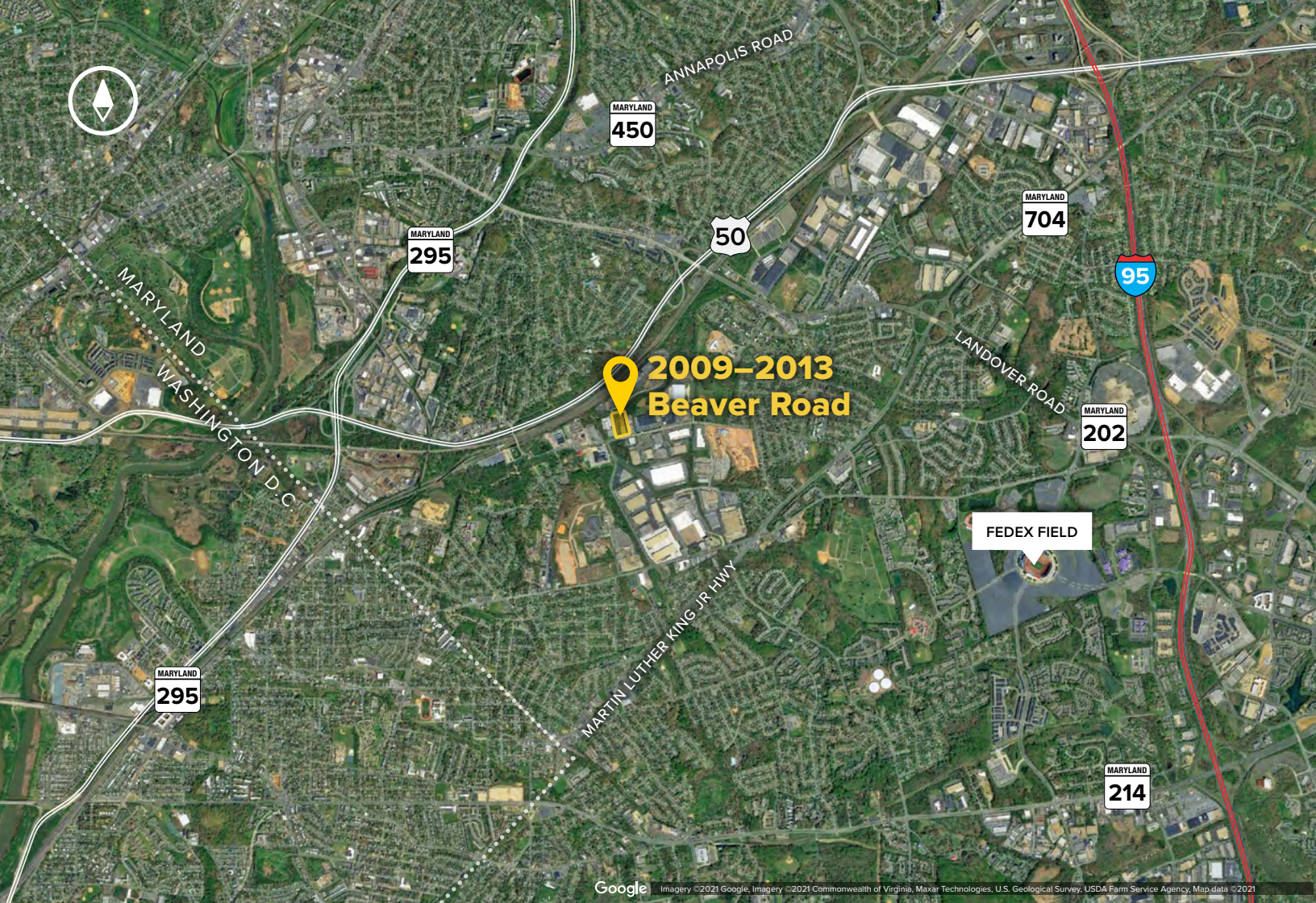

Contact Us

For additional leasing information or to schedule a tour, contact:

Claire Cobert

Leasing Representative

ccobert@sjpi.com

410.369.1274

Corporate Headquarters:

2560 Lord Baltimore Drive

Baltimore, MD 21244

410.788.0100 | SJPI.COM



About St. John Properties

St. John Properties, Inc. is one of the nation's largest and most successful privately held commercial real estate firms. Founded in 1971, the vertically-integrated company develops, owns and manages office, flex/ research and development, warehouse, retail and residential space nationwide.

Connect with us **@stjohnprop**



This information contained in this publication has been obtained from sources believed to be reliable. St. John Properties makes no guarantee, warranty or representation about this information. Any projections, opinions, assumptions or estimates used here are for example only and do not represent the current or future performance of the property. Interested parties should conduct an independent investigation to determine whether the property suits their needs. REV 08/25