

**NEWLY REDUCED ASKING  
RATE \$0.49,NNN**



**CLICK TO TAKE A  
VIRTUAL TOUR**



**RARE, OFFICE/R&D SUBLEASE,  
AVAILABLE NOW  
LEASE EXPIRES 5/31/2026**

**4550**  
NORRIS  
CANYON  
ROAD



**+/-48,931 SF AVAILABLE**

**CBRE**

# PROPERTY HIGHLIGHTS



18 FOOT CLEAR HEIGHT



277/480V, 3 PHASE  
ELECTRICAL



BACKUP GENERATOR:  
SINGLE PHASE, 120/240V  
OUTPUT, 60HZ, 5.1/3.0A



COMPUTER ROOM WITH  
SEPARATE HVAC



3 DOCK HIGH DOORS



70% OFFICE/LAB  
30% WAREHOUSE



ENERGY EFFICIENT  
COOLING SYSTEM



PERIMETER PRIVATE  
OFFICES, CONFERENCE  
ROOMS



CONDITIONED  
WAREHOUSE



OUTDOOR RECREATION/  
COLLABORATIVE AREA



24 HOUR FITNESS  
AND UPS LOCATED  
NEXT DOOR



AMPLE PARKING

## ADAM EBNER

First Vice President  
+1 925 251 4606  
adam.ebner@cbre.com  
Lic. 01213890

## MARK CHRISTIERSON

Executive Vice President  
+1 408 453 7452  
mark.christierson@cbre.com  
Lic 01296954

## MARK KOL

Executive Vice President  
+1 510 874 1992  
mark.kol@cbre.com  
Lic 01251158



# FLOOR PLAN



CLICK TO TAKE A VIRTUAL TOUR

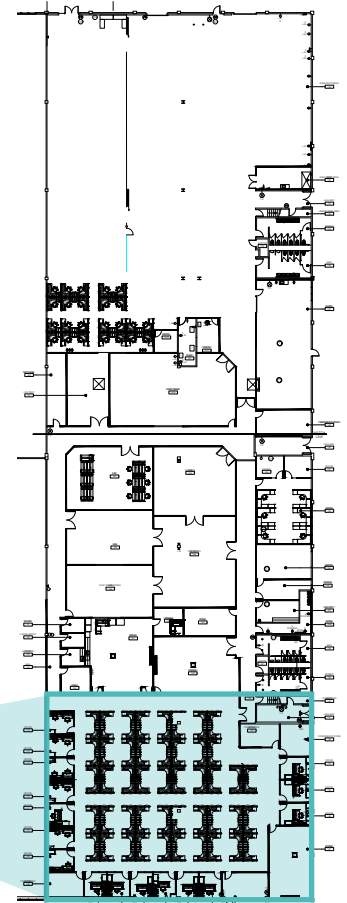
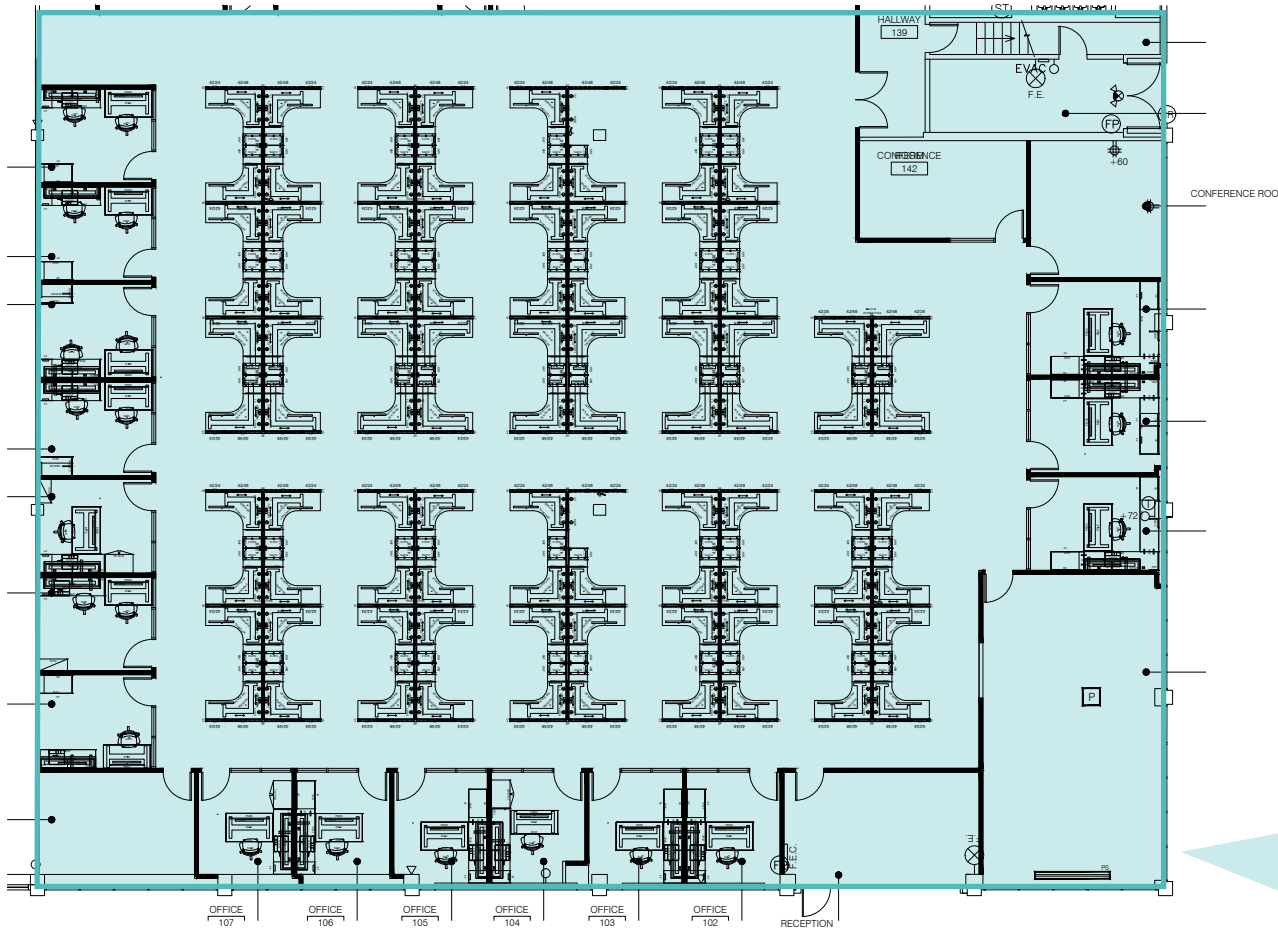

\*Can all be converted to warehouse

## ADAM EBNER

Senior Vice President  
+1 925 251 4606  
adam.ebner@cbre.com  
Lic. 01213890

## MARK CHRISTIERSON

Executive Vice President  
+1 408 453 7452  
mark.christierson@cbre.com  
Lic 01296954

## MARK KOL

Executive Vice President  
+1 510 874 1992  
mark.kol@cbre.com  
Lic 01251158



# SITE PLAN

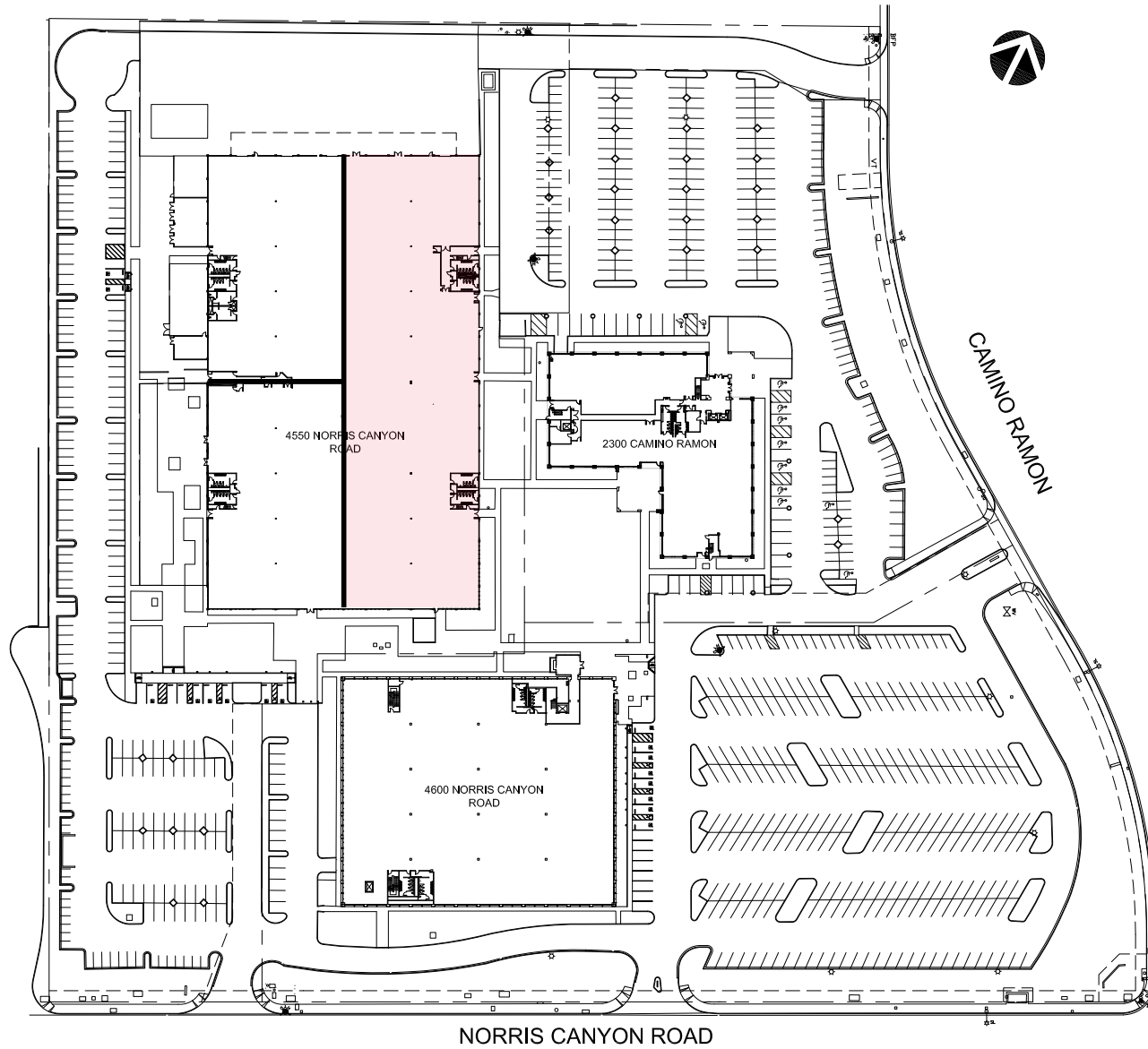

**ADAM EBNER**  
Senior Vice President  
+1 925 251 4606  
adam.ebner@cbre.com  
Lic. 01213890

**MARK CHRISTIERSON**  
Executive Vice President  
+1 408 453 7452  
mark.christierson@cbre.com  
Lic 01296954

**MARK KOL**  
Executive Vice President  
+1 510 874 1992  
mark.kol@cbre.com  
Lic 01251158



# LOCATION MAP



**ADAM EBNER**

Senior Vice President  
+1 925 251 4606  
adam.ebner@cbre.com  
Lic. 01213890

**MARK CHRISTIERSON**

Executive Vice President  
+1 408 453 7452  
mark.christierson@cbre.com  
Lic 01296954

**MARK KOL**

Executive Vice President  
+1 510 874 1992  
mark.kol@cbre.com  
Lic 01251158







CLICK TO TAKE A  
VIRTUAL TOUR

COMPANY NAME HERE



**MARK CHRISTIERSON**

Executive Vice President

+1 408 453 7452

mark.christierson@cbre.com

Lic 01296954

**ADAM EBNER**

Senior Vice President

+1 925 251 4606

adam.ebner@cbre.com

Lic. 01213890

**MARK KOL**

Executive Vice President

+1 510 874 1992

mark.kol@cbre.com

Lic. 01251158

© 2023 CBRE, Inc. This information has been obtained from sources believed reliable. We have not verified it and make no guarantee, warranty or representation about it. Any projections, opinions, assumptions or estimates used are for example only and do not represent the current or future performance of the property. You and your advisors should conduct a careful, independent investigation of the property to determine to your satisfaction the suitability of the property for your needs. Photos herein are the property of their respective owners and use of these images without the express written consent of the owner is prohibited. PMStudio\_MARCH2021.

**CBRE**