



3822

W JEFFERSON BLVD | LOS ANGELES, CA

OPPORTUNITY

3822 West Jefferson Boulevard is located in the heart of the coveted West Adams District, this single-story property offers a prime location in one of Los Angeles' most dynamic and rapidly evolving neighborhoods.

PROPERTY HIGHLIGHTS

3,930 SF

- » Flexible option: lease as separate suites or entire building
- » Immediate access to the 10 Freeway via Crenshaw Blvd
- » Ceiling height: 16 ft. clear height
- » Roll-up doors
- » Restrooms
- » Onsite parking available
- » Backyard patio area

AREA DEMOGRAPHICS

3 Mile Radius

- » Total Employees: 112,350
- » Total Business: 16,125
- » Population: 374,883
- » Households: 138,234
- » Jefferson & Wellington: 36,985 VPD

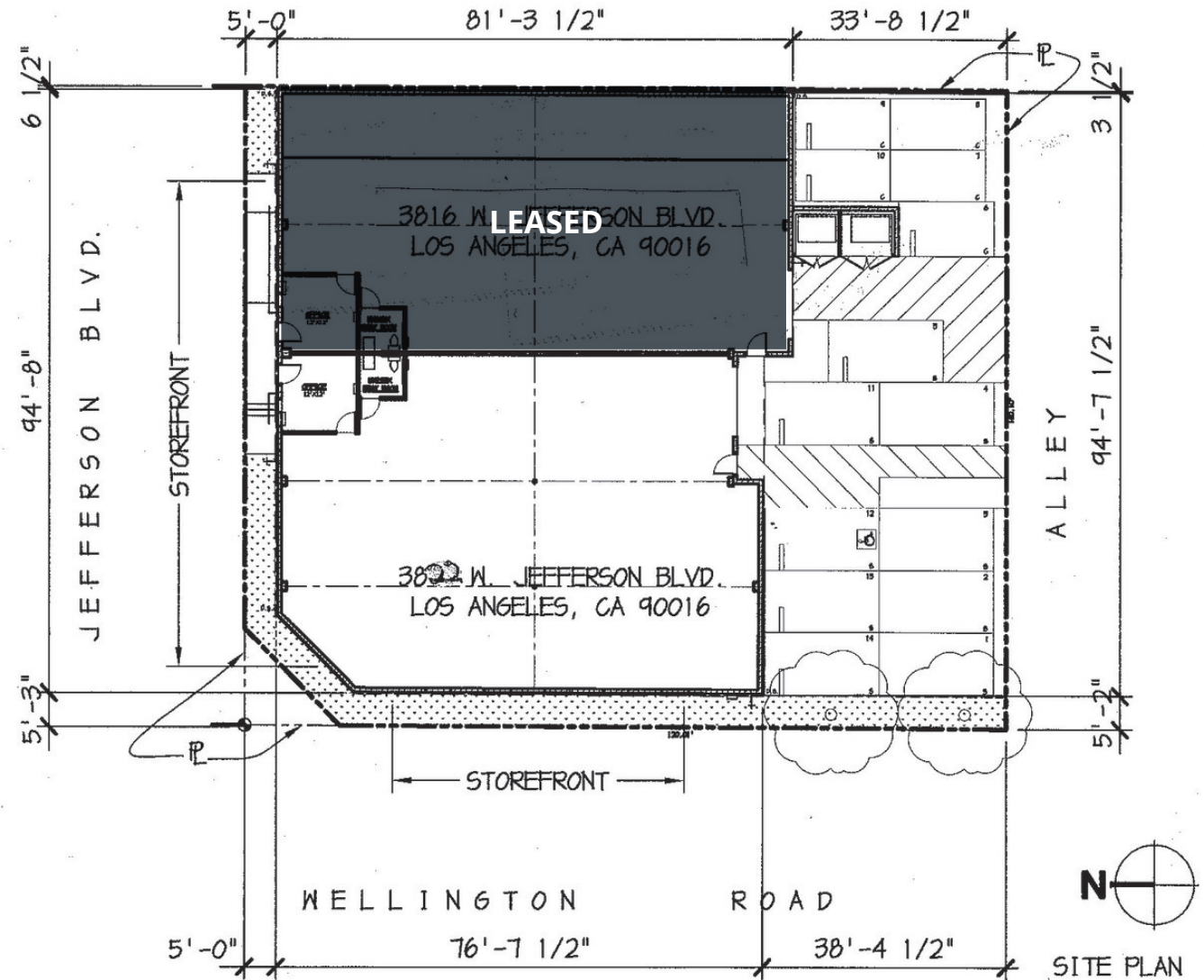

WEST ADAMS AMENITIES

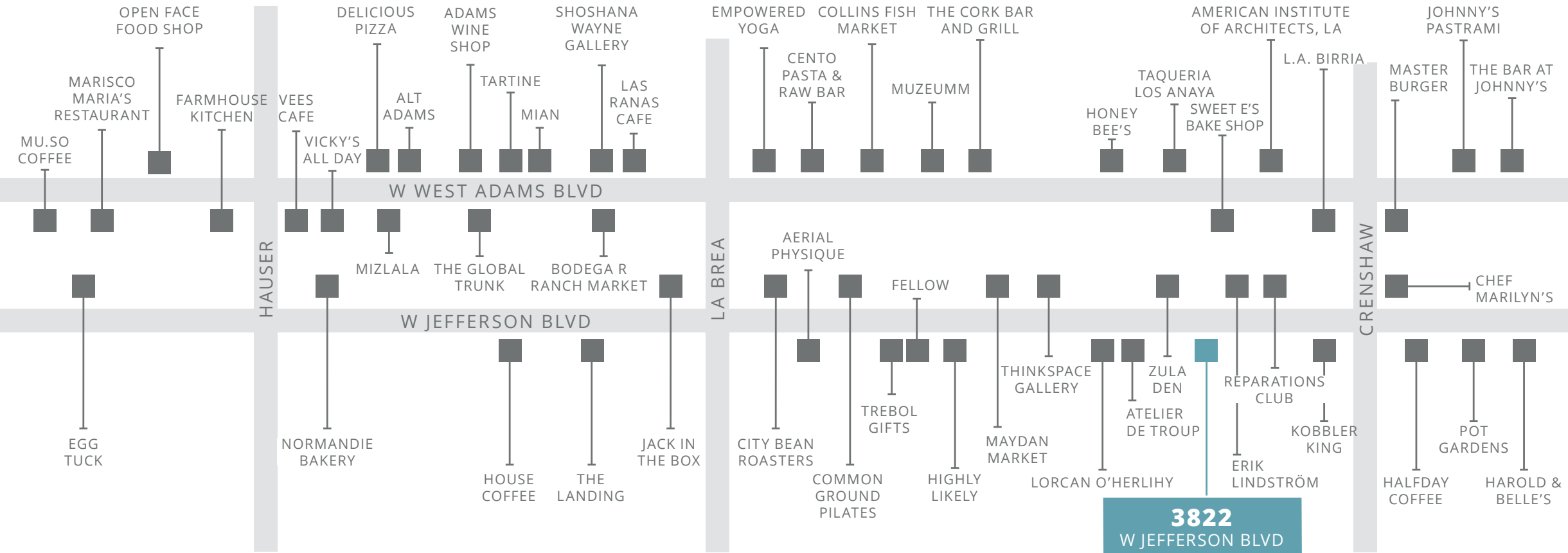

Tucked between Culver City and Downtown LA, West Adams is where creativity meets community. This neighborhood is home to local artists, up-and-coming restaurants, and unique shops. Whether you're grabbing coffee at a cozy café, checking out a gallery, or trying a new restaurant, West Adams offers a laid-back vibe with plenty to explore.

Trendy Local Businesses

- » Aerial Physique
- » MuzeuMM
- » Fellow
- » Reparations Club

Nearby Eateries

- » Maydan Market
- » Highly Likely
- » Johnny's Pastrami
- » CENTO Pasta & Raw Bar

PHOTOS

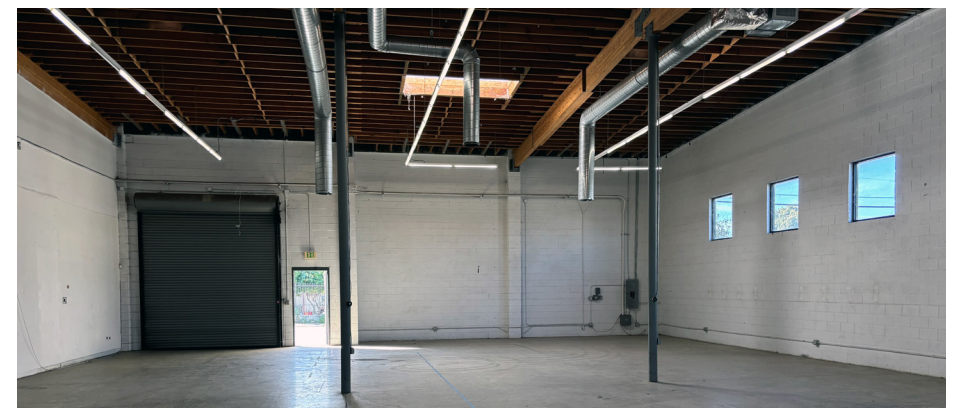

3822

W JEFFERSON BLVD | LOS ANGELES, CA

For Leasing Opportunities Contact:

BLAKE ECKERT

1st Vice President

323.860.4908

beckert@cimgroup.com

Lic #01916057

GENO ST. JOHN III

Vice President

323.556.9658

gstjohn@cimgroup.com

Lic #01805139

LEONEL GARCIA

Director

323.860.4863

lgarcia@cimgroup.com

Lic #02048765



CIM is a community-focused real estate and infrastructure owner, operator, lender and developer. www.cimgroup.com

This information has been obtained from sources believed reliable, but has not been verified for accuracy or completeness. You should conduct a careful, independent investigation of the property and verify all information. Any reliance on this information is solely at your own risk.