

# MAJESTIC FREEWAY BUSINESS CENTER RIVERSIDE COUNTY, CA

INDUSTRIAL WAREHOUSE SPACE AVAILABLE FOR BUILD-TO-SUIT



PERMIT READY

Building 15 - 83,449 SF

- ▶ Offices to Suit
- ▶ ESFR Fire Sprinkler System
- ▶ Warehouse Lighting to Suit
- ▶ Ample Auto & Trailer Parking
- ▶ Immediate Access to I-215 via Cajalco Road & Harley Knox Boulevard



For more information, contact:

Taylor Talt  
D-(562) 654-2734 C-(626) 660-8829  
R.E. License #01901707 (CA)  
Ttalt@MajesticRealty.com

John Semcken  
D-(562) 948-4306 C-(562) 556-1887  
R.E. License #00979758 (CA)  
JSemcken@MajesticRealty.com

Jack Semcken  
D-(562) 576-1643 C-(626) 379-6138  
R.E. License #02290390 (CA)  
jacksemcken@MajesticRealty.com



# MAJESTIC FREEWAY BUSINESS CENTER

## RIVERSIDE COUNTY, CA

BUILDING 15: 83,449 SF  
18519 Harvill Avenue, Perris, CA

30'  
Clear Height

20  
Dock High Doors

67  
Auto Parking Stalls

### BUILDING 15 SPECS

Total Size	83,449 SF
Loading	Single Loading
Column Spacing	60' x 52' Typical Bay
Speed Bay:	65'
Ramps	2 Grade Level Ramps
Building Depth	185'
Sprinklers	ESFR

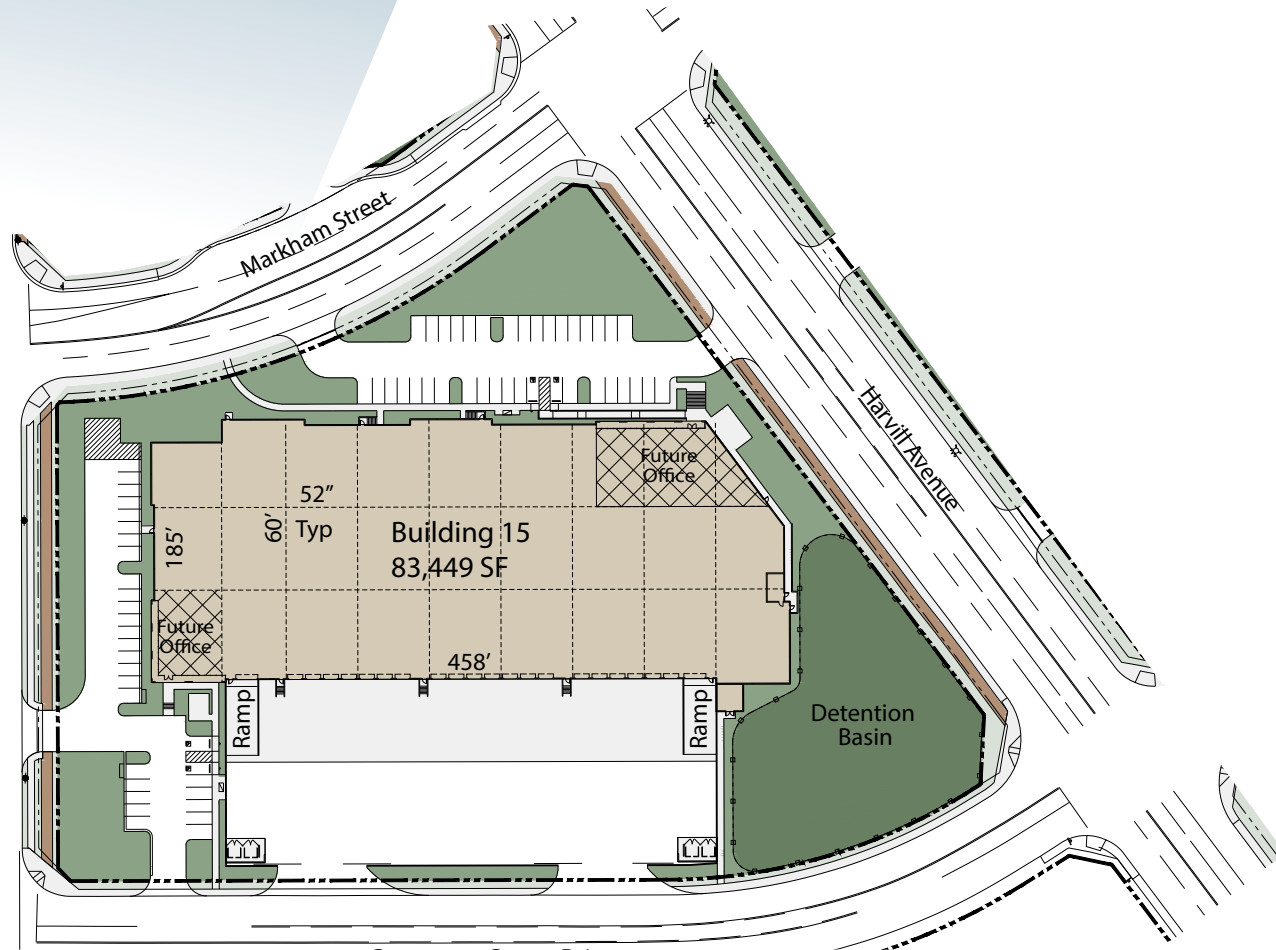

# MAJESTIC FREEWAY BUSINESS CENTER

## RIVERSIDE COUNTY, CA

### LOCATION

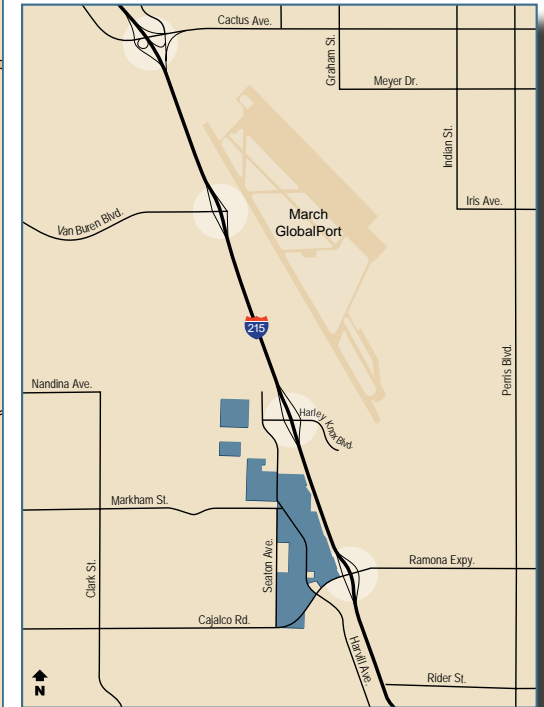

The Majestic Freeway Business Center is located between Harley Knox Boulevard and Cajalco Road on the I-215 Freeway in Riverside County, California.

# MAJESTIC FREEWAY BUSINESS CENTER RIVERSIDE COUNTY, CA

CORPORATE  
NEIGHBORS



This statement is based upon information which we believe to be correct and is obtained from sources we regard as reliable but we assume no liability for errors or omissions therein.