

# FOR LEASE

MONTANA AVENUE  
OFFICE SPACES

1124 MONTANA AVE STE D  
SANTA MONICA, CA 90403



**RAFAEL PADILLA**

310.395.2663 X101

RAFAEL@PARCOMMERCIAL.COM

LIC# 009960188

**ARTUR PETER**

310.395.2663 X101

ARTHUR@PARCOMMERCIAL.COM

LIC# 01068613



# PROPERTY OVERVIEW

1124 MONTANA AVE STE D  
SANTA MONICA, CA 90403

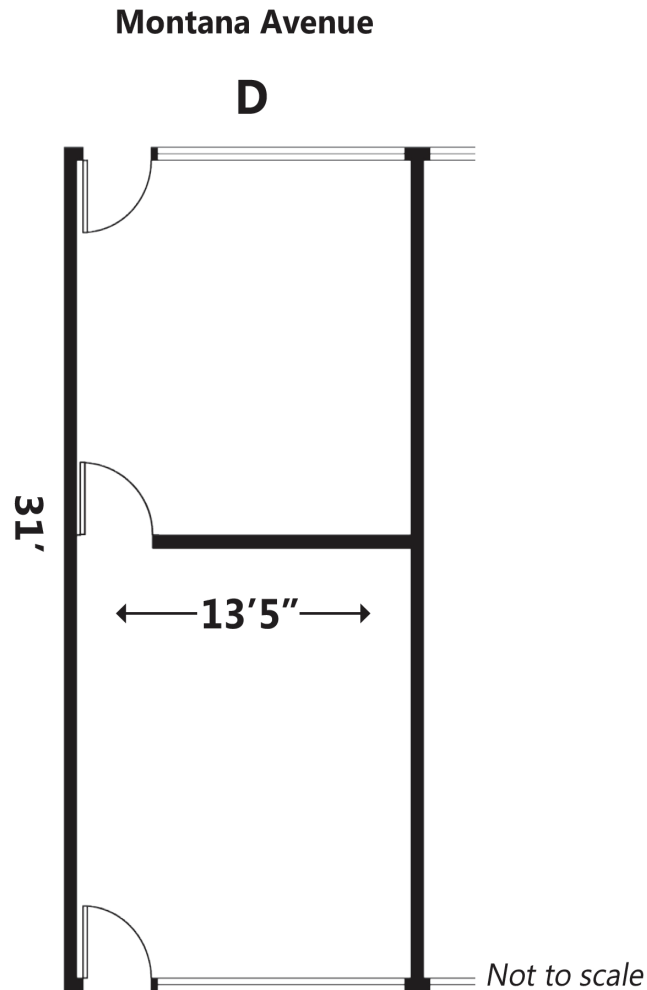

**SIZE:** Approximately 450 square feet

**RATE:** \$2,400 per suite per month, MG

**TERM:** Negotiable

**PARKING:** Street parking

**AVAILABLE:** Immediately

- Attractive, inviting 2nd floor office space with abundant natural light
- Premier location at the epicenter of Montana Avenue commercial corridor
- Sizable outdoor patios
- Office suites feature operable windows

**RAFAEL PADILLA**

310.395.2663 X101

RAFAEL@PARCOMMERCIAL.COM

LIC# 009960188

**ARTUR PETER**

310.395.2663 X101

ARTHUR@PARCOMMERCIAL.COM

LIC# 01068613



# PROPERTY PHOTOS

1124 MONTANA AVE STE D  
SANTA MONICA, CA 90403



**RAFAEL PADILLA**

310.395.2663 X101

RAFAEL@PARCOMMERCIAL.COM

LIC# 009960188

**ARTUR PETER**

310.395.2663 X101

ARTHUR@PARCOMMERCIAL.COM

LIC# 01068613



All information furnished is from sources deemed reliable and which we believe to be correct, but no representation or guarantee is given as to its accuracy and is subject to errors and omissions. All measurements are approximate and have not been verified by Broker. You are advised to conduct an independent investigation to verify all information.

[www.parcommercial.com](http://www.parcommercial.com)

# NEIGHBORING TENANTS

1124 MONTANA AVE STE D  
SANTA MONICA, CA 90403

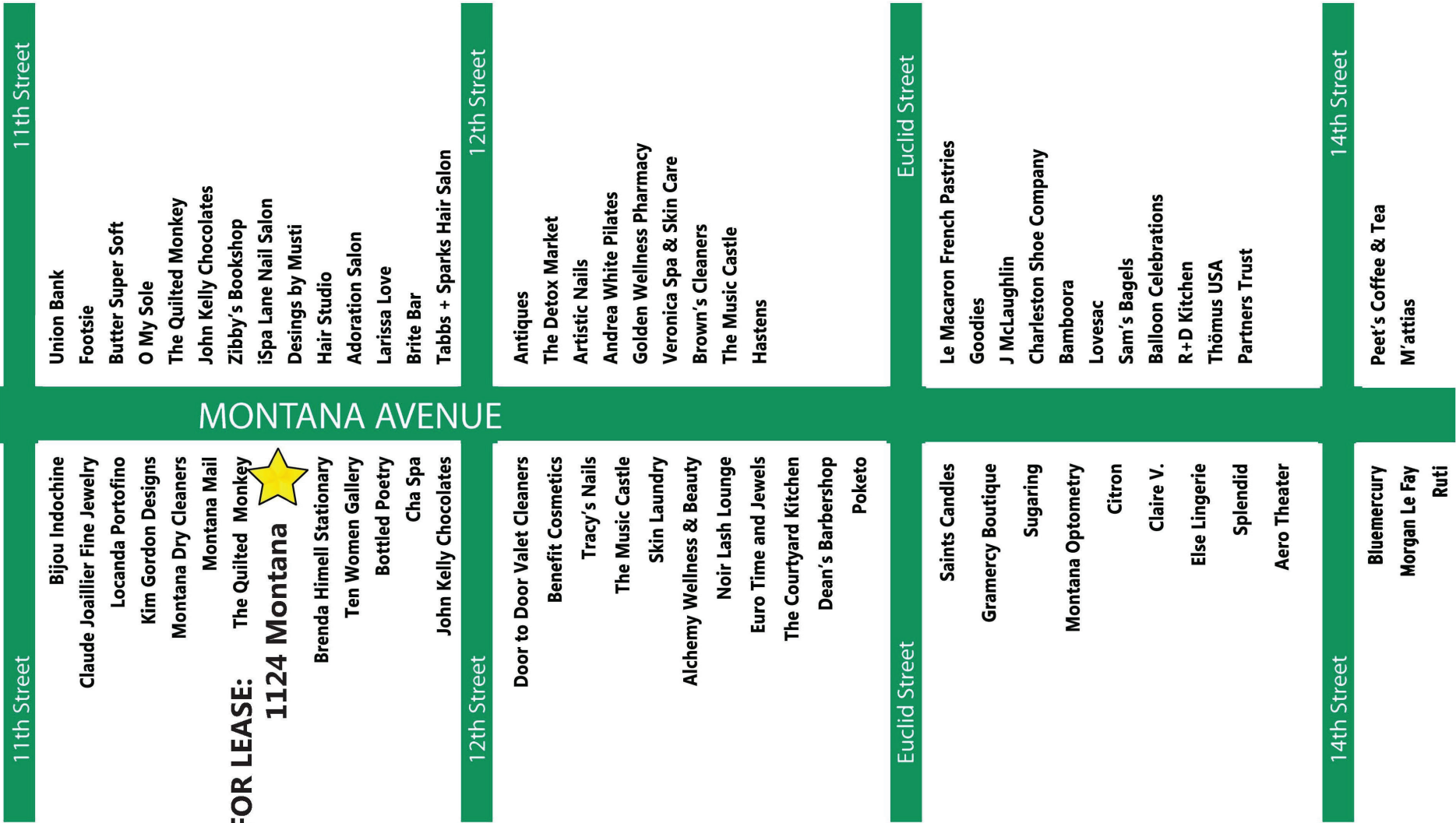

**RAFAEL PADILLA**

310.395.2663 X101

RAFAEL@PARCOMMERCIAL.COM

LIC# 009960188

**ARTUR PETER**

310.395.2663 X101

ARTHUR@PARCOMMERCIAL.COM

LIC# 01068613



www.parcommercial.com

All information furnished is from sources deemed reliable and which we believe to be correct, but no representation or guarantee is given as to its accuracy and is subject to errors and omissions. All measurements are approximate and have not been verified by Broker. You are advised to conduct an independent investigation to verify all information.