

2330

2330

EAST BIDWELL ST.

Folsom, CA

JERDE
WWW.JERDECRE.COM

JOSIE JERDE

lic. 01344316

(916) 849-1514

josie@jerdecre.com

LOCATION & AMENITIES

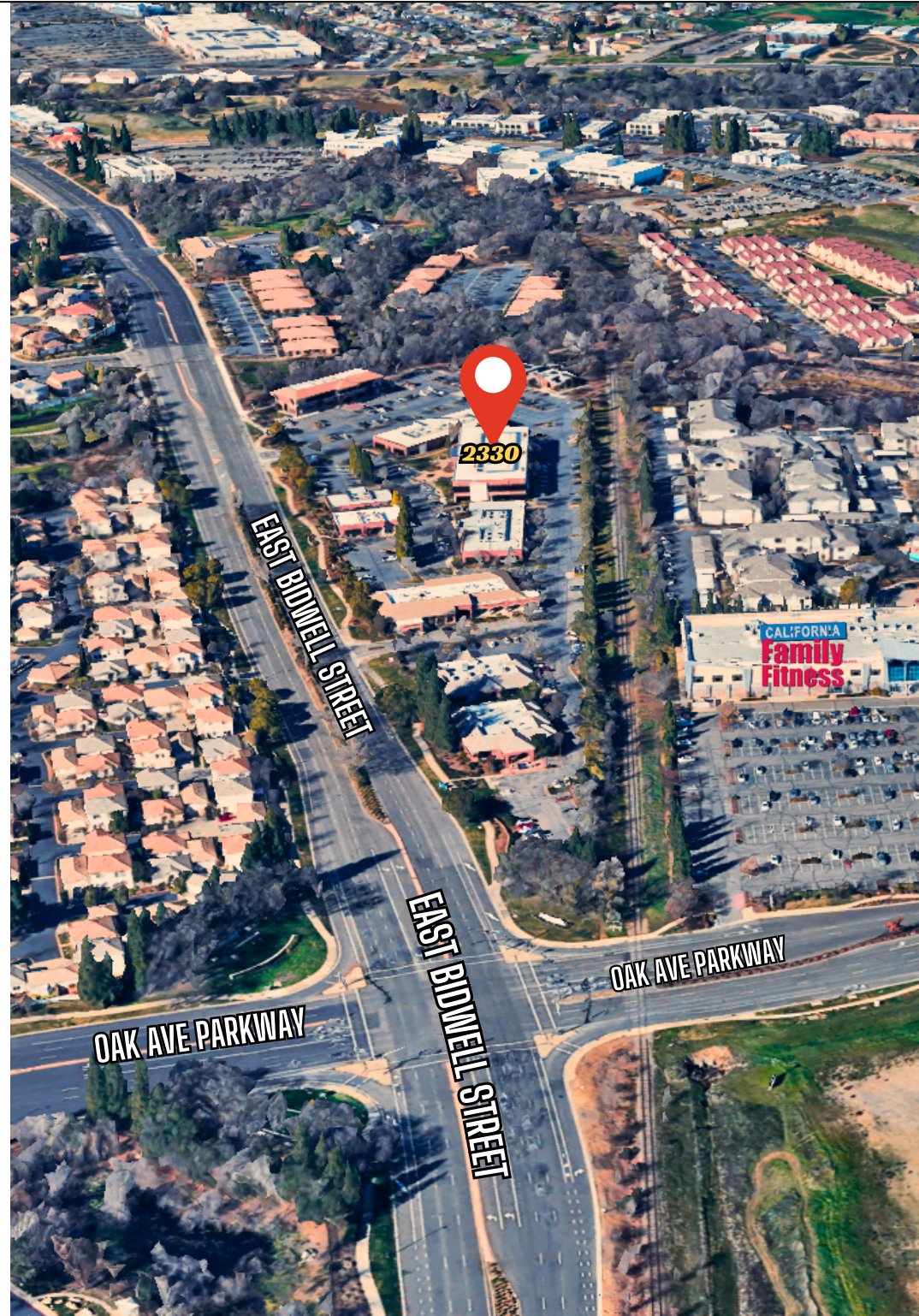

BUILDING HIGHLIGHTS



LUSH LANDSCAPING AND
OUTDOOR PATIO AREA



CLOSE TO THE AMERICAN
RIVER BIKE TRAIL



MODERN FINISHES,
EXPANSIVE WINDOWLINES



BUILDING SIGNAGE
AVAILABLE



PARKING RATIO:
5/1,000 SF (MED. USE OK!)



IMMEDIATE PROXIMITY
TO MERCY HOSPITAL



CLOSE TO A VARIETY OF
AMENITIES INCLUDING THE
PALLADIO MALL AND
HISTORIC FOLSOM

2330 EAST BIDWELL ST.

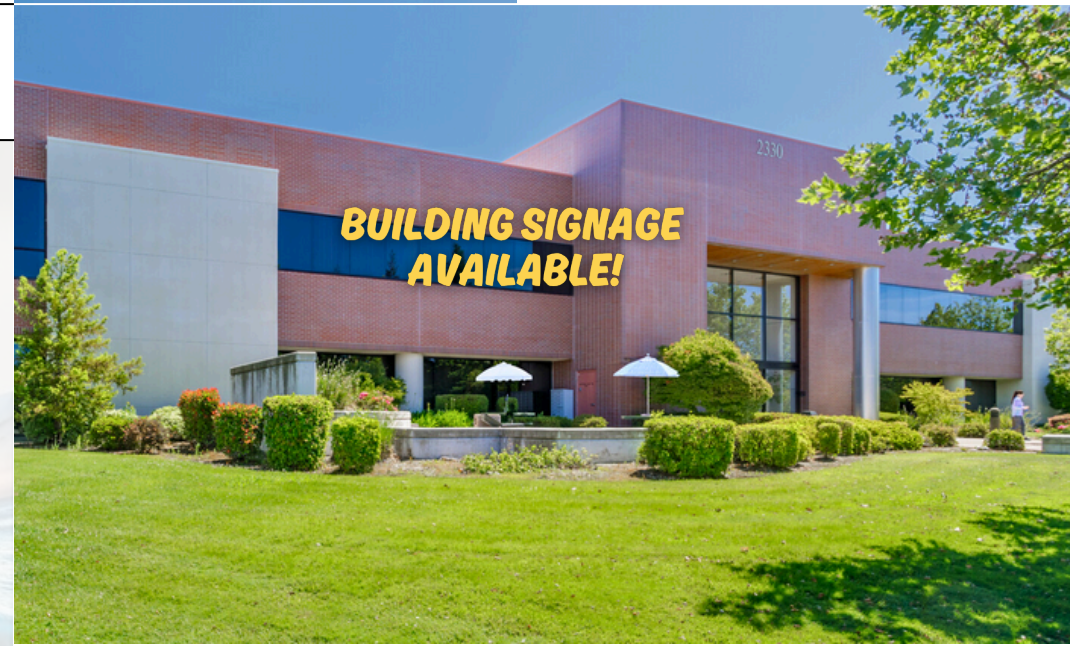

JERDE

SUITE 140



+/- 2,354 SF

CURRENT PLAN

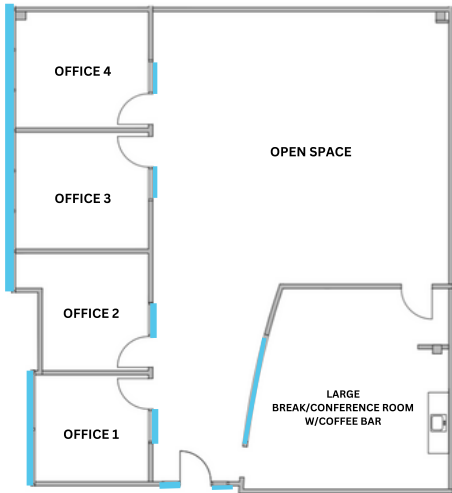

CONCEPTUAL PLAN

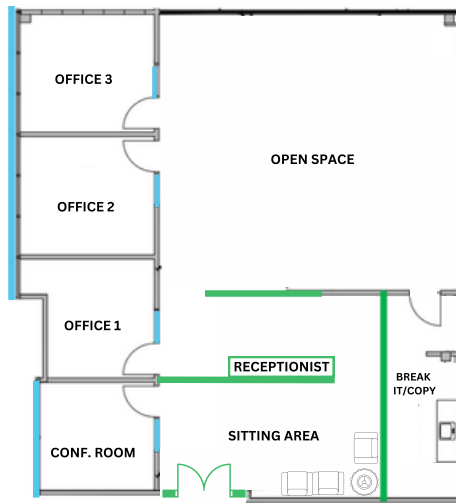

DOUBLE DOOR ENTRY

 FLOOR-TO-CEILING GLASS

JOSIE JERDE
lic. 01344316
(916) 849-1514
josie@jerdecre.com

