

NEW BUILD FOR LEASE

28610 CENTRE ROAD
STRATHROY, ONTARIO



Len Goudy

Broker of Record
Goudy Real Estate Corp.
Real Estate Brokerage
(416) 830-0880

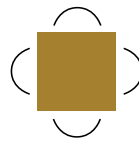

Goudy Real Estate Corp.
Real Estate Brokerage
Commercial Real Estate
Sales & Leasing

505 Hood Rd., Unit 20, Markham, ON L3R 5V6 | (905) 477-3000

The information contained herein has been provided to Goudy Real Estate Corp. by others. We do not warrant its accuracy. You are advised to independently verify the information prior to submitting an Offer and to provide for sufficient due diligence in an offer. The information contained herein may change from time to time without notice. The property may be withdrawn from the market at any time without notice.

SITE PLAN & DETAILS

28610 CENTRE ROAD

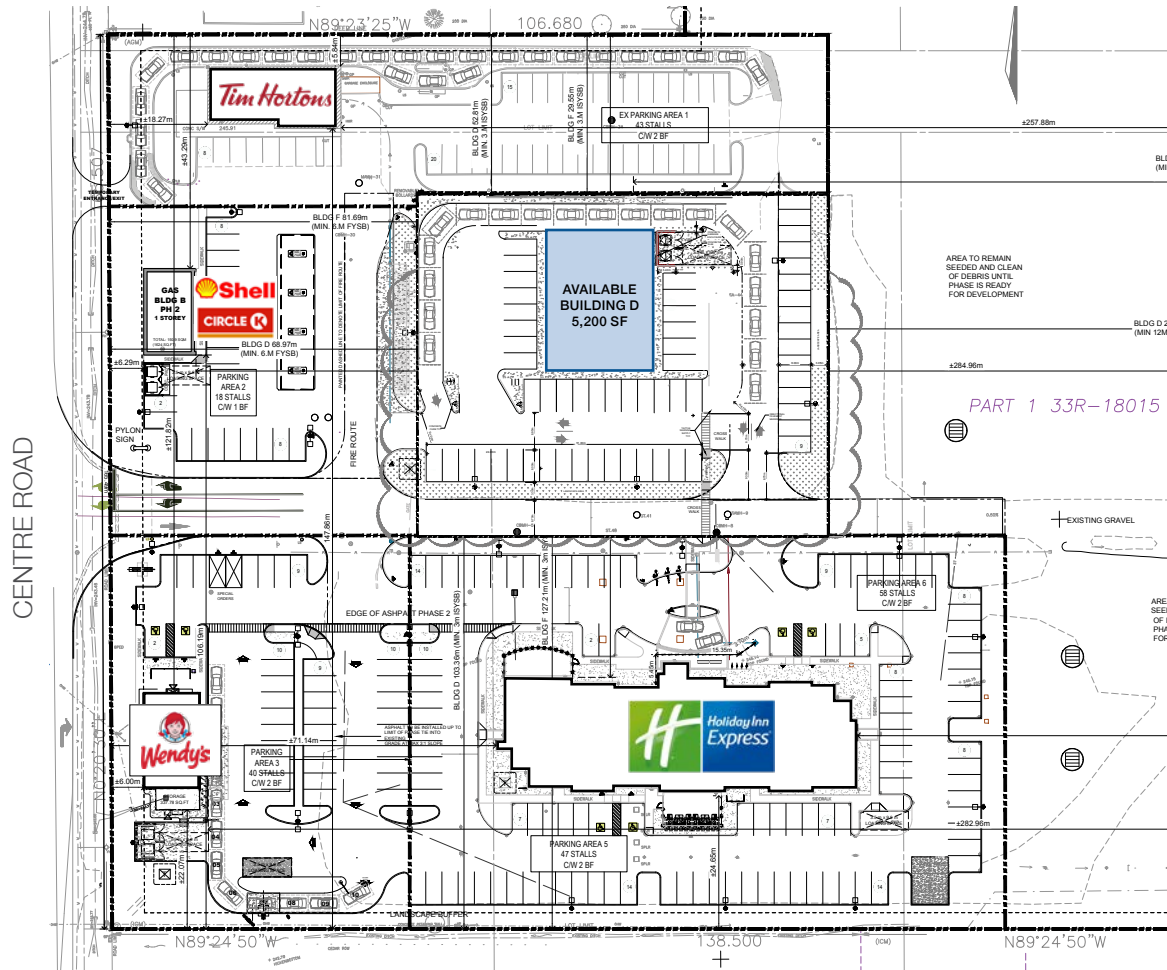

Note: This site plan is provided for illustrative purposes only. This drawing is not to scale.

DETAILS

Seize a premier commercial opportunity at Strathroy's gateway! This new development boasts a highly visible location directly off Highway 402, attracting constant traffic. Benefit from co-tenancy with major brands including Holiday Inn Express (90 rooms), Tim Hortons, Wendy's, Circle K, and Shell Gas Station. Units may be combined to meet your specific requirements.

AVAILABLE UNITS:

BLDG D In-Line Units	1,300 SF
RENT	\$45 PSF

BLDG D End Unit w/ Drive-Thru	1,300 SF
RENT	\$70 PSF

TMI	\$ 12 PSF (estimated)
------------	-----------------------

*Taxes are not yet assessed.

BUILDING D PLAN

28610 CENTRE ROAD

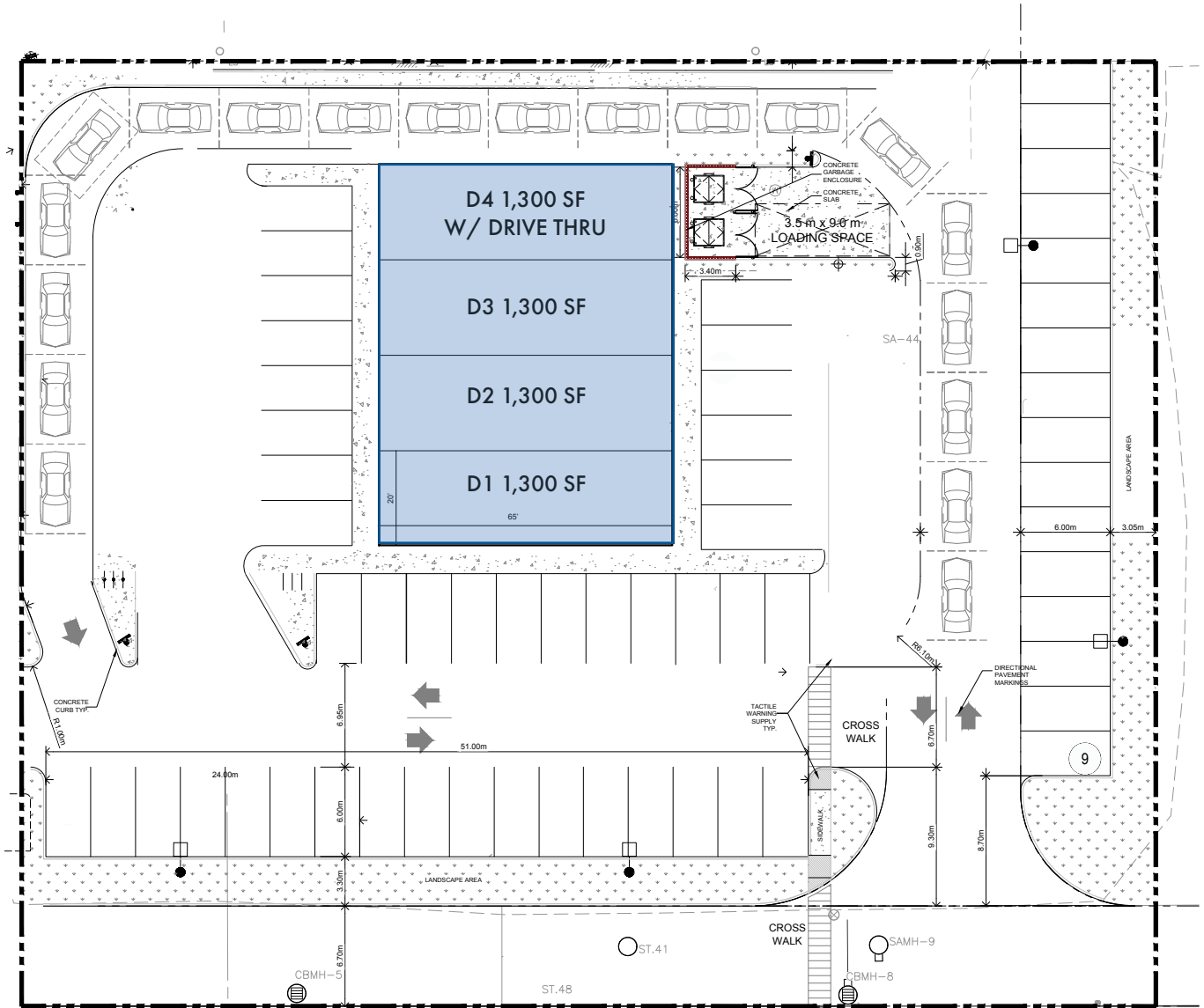

Note: This site plan is provided for illustrative purposes only. This drawing is not to scale.

DEMOGRAPHICS

28610 CENTRE ROAD

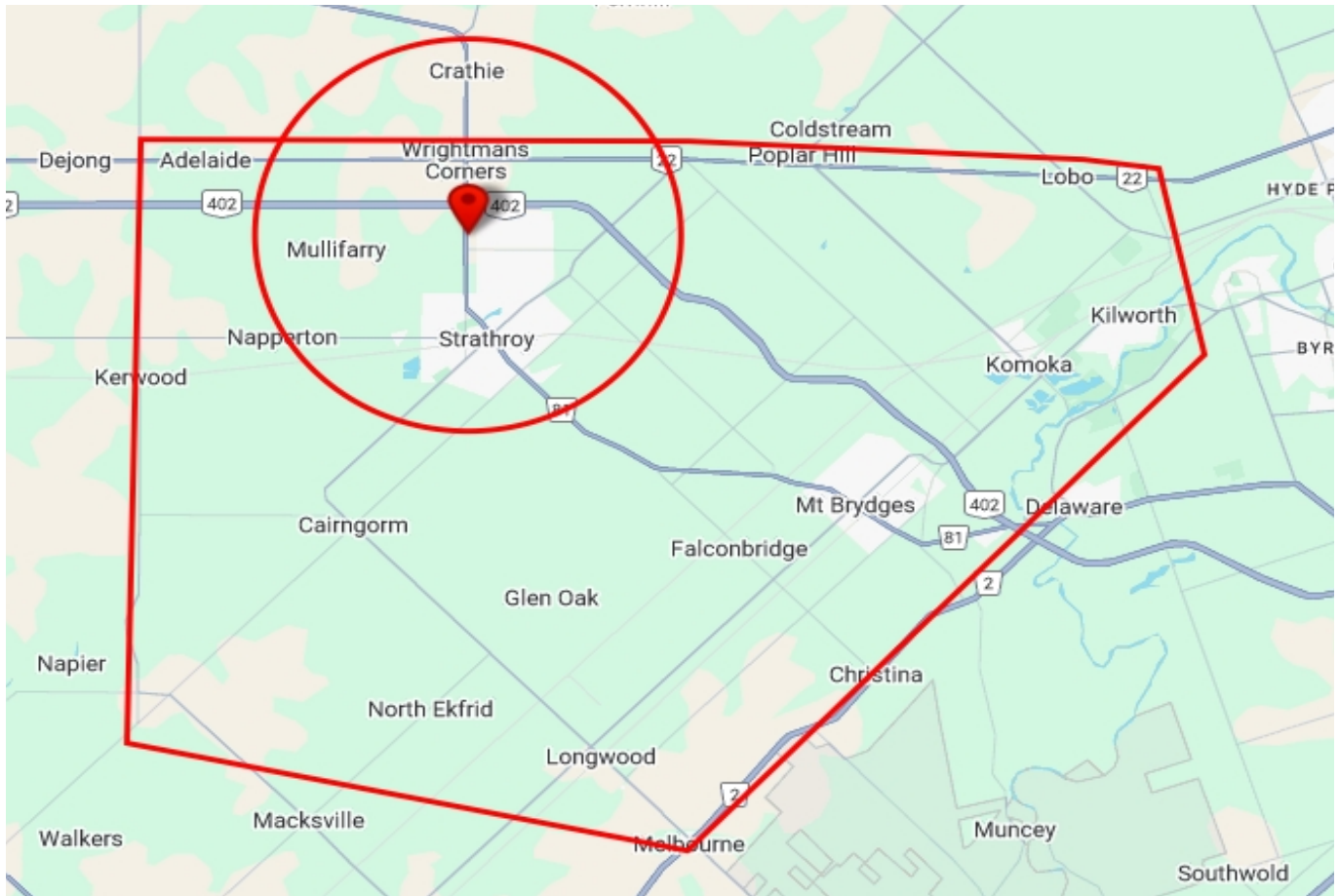

2024 Daytime Population	28610 Centre Rd, Strathroy, ON N7G 3H8 0 - 6 km		Strathroy and Surrounding Area	
		%		%
Total Estimated Population	21,411		38,512	
Total Daytime Population	21,073		34,433	
Daytime Population at Home	10,876	51.6%	19,110	55.5%
0 to 14 years	3,382	16.1%	6,488	18.8%
15 to 64 years	3,566	16.9%	6,037	17.5%
65 years and over	3,927	18.6%	6,585	19.1%
Daytime Population at Work	10,823	51.4%	15,353	44.6%
Work At Usual Place	7,762	36.8%	10,177	29.6%
Work Mobile	1,479	7.0%	1,844	5.4%
Work At Home	1,581	7.5%	3,332	9.7%

DEMOGRAPHICS

28610 CENTRE ROAD

2024 Demographic Snapshot	28610 Centre Rd, Strathroy, ON N7G 3H8 0 - 6 km		Strathroy and Surrounding Area	
		%		%
Total Population				
2019 estimated	18,312		32,460	
2024 estimated	21,411		38,512	
2029 Projected	23,875		42,502	
% Pop. Change (2019-2024)	16.9%		18.6%	
% Pop. Change (2024-2029)	11.5%		10.4%	
2024 Total Population by Age	21,411		38,512	
0 to 4 years	1,065	5.0%	1,989	5.2%
5 to 19 years	3,639	17.0%	6,882	17.9%
20 to 24 years	1,371	6.4%	2,464	6.4%
25 to 34 years	2,889	13.5%	4,830	12.5%
35 to 44 years	2,566	12.0%	4,882	12.7%
45 to 54 years	2,383	11.1%	4,511	11.7%
55 to 64 years	2,743	12.8%	5,031	13.1%
65 to 74 years	2,416	11.3%	4,313	11.2%
75 years & over	2,338	11%	3,610	9%
Median Age	41.7		41.2	
2024 Total Census Families	5,833		10,807	
Average Persons Per Family	3.0		3.0	
Total Couples	4,928	84.5%	9,476	87.7%
Without children at home	2,558	43.9%	4,585	42.4%
With children at home	2,370	40.6%	4,891	45.3%
Lone-parent families	905	15.5%	1,331	12.3%
Children Per Census Family	1.0		1.0	
2024 Educational Attainment (15 years+)	17,649		31,437	
Less than a bachelor degree	15,010	85.0%	25,075	79.8%
Bachelor degree & higher	2,639	15.0%	6,362	20.2%
2024 Households	8,202		14,199	
Persons per household	2.56		2.67	
Average household income	\$ 112,317		\$ 132,133	
2024 Occupied Dwellings	8,202		14,199	
Owned dwellings	6,131	74.7%	11,529	81.2%
Rented dwellings	2,072	25.3%	2,671	18.8%
Dominant building type	Houses		Houses	
Dominant period of construction	1961-1980		1961-1980	