



Units 142-146

 Proposed new walls

Reminders:

NFFT can include custom bathrooms, lighting, electrical, walls, doors, paint, and HVAC in its buildout.

Bathrooms can be demo'd and easily reconfigured.

More overhead doors can be added or existing can be moved. NFFT will add 1 new overhead door to the common area during this project.

Facade is getting redone with new historic replica doors. Transom windows will be restored.

Drain connections must happen near an elevator shaft, which has existing plumbing infrastructure.

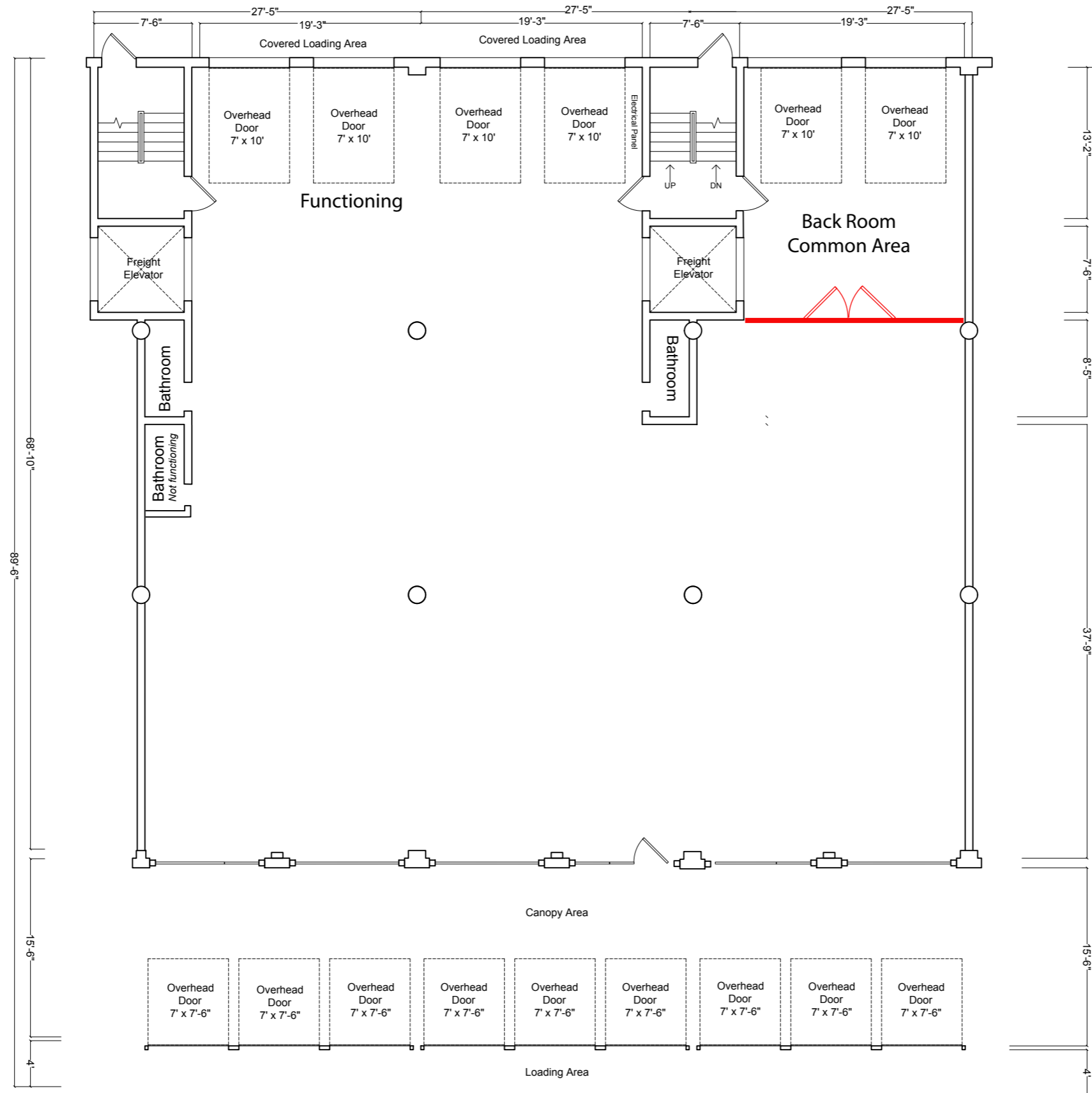

First Floor Plan
 Drawing Scale: 3/32" = 1'-0"
 Ceiling Height: 12'-7"