



Colliers



FOR LEASE



2755 E. Shaw Avenue

Fresno, California

## Office Space Available near California State University, Fresno

### Property Highlights

- Walking distance to Campus Point and Dog House Grill
- Ample on-site parking
- Flexible zoning and uses
- Close to Freeways 41 and 168
- Great location and park-like setting
- Restaurants and entertainment nearby

This document/email has been prepared by Colliers for advertising and general information only. Colliers makes no guarantees, representations or warranties of any kind, expressed or implied, regarding the information including, but not limited to, warranties of content, accuracy and reliability. Any interested party should undertake their own inquiries as to the accuracy of the information. Colliers excludes unequivocally all inferred or implied terms, conditions and warranties arising out of this document and excludes all liability for loss and damages arising there from. This publication is the copyrighted property of Colliers and /or its licensor(s). © 2025 All rights reserved. This communication is not intended to cause or induce breach of an existing listing agreement. Colliers Tingey International, Inc.

### CONTACT US

#### Beau Plumlee

Senior Vice President | Principal  
+1 559 256 2443  
beau.plumlee@colliers.com  
CA Lic. 01269167

#### Colliers

7485 N. Palm Avenue, #110  
Fresno, California 93711  
P: +1 559 221 1271  
F: +1 559 222 8744

FOR LEASE

# Property Summary



<b>Address</b>	2755 E. Shaw Avenue   Fresno, CA
<b>Available</b>	Suite 103: ±1,395 RSF Suite 104: ±1,502 RSF Suites can be combined for a total of ±2,897 RSF
<b>Asking Rate</b>	Suite 103: \$2,160.00 per month* Suite 104: \$2,328.00 per month* *plus utilities and janitorial
<b>Location</b>	SWQ Shaw and Chestnut Avenues
<b>Zoning</b>	CMX
<b>Parking</b>	Ample on-site

## Floor Plans

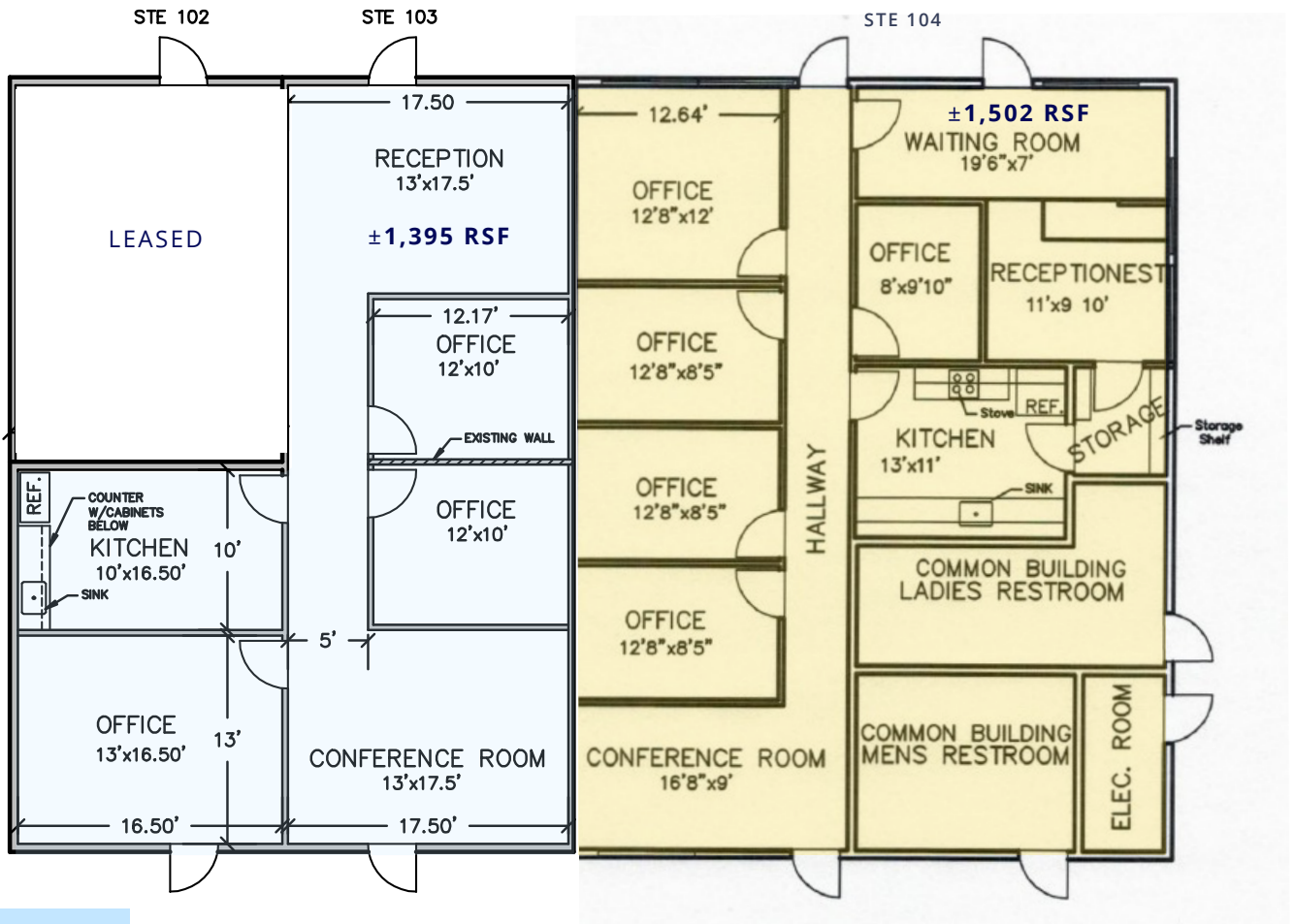

### CONTACT US

#### Beau Plumlee

Senior Vice President | Principal  
 +1 559 256 2443  
 beau.plumlee@colliers.com  
 CA Lic. 01269167

#### Colliers

7485 N. Palm Avenue, #110  
 Fresno, California 93711  
 P: +1 559 221 1271  
 F: +1 559 222 8744

This document/email has been prepared by Colliers for advertising and general information only. Colliers makes no guarantees, representations or warranties of any kind, expressed or implied, regarding the information including, but not limited to, warranties of content, accuracy and reliability. Any interested party should undertake their own inquiries as to the accuracy of the information. Colliers excludes unequivocally all inferred or implied terms, conditions and warranties arising out of this document and excludes all liability for loss and damages arising there from. This publication is the copyrighted property of Colliers and /or its licensor(s). © 2024 All rights reserved. This communication is not intended to cause or induce breach of an existing listing agreement. Colliers Tingey International, Inc.



FOR LEASE



2755 E. Shaw Avenue | Fresno, CA

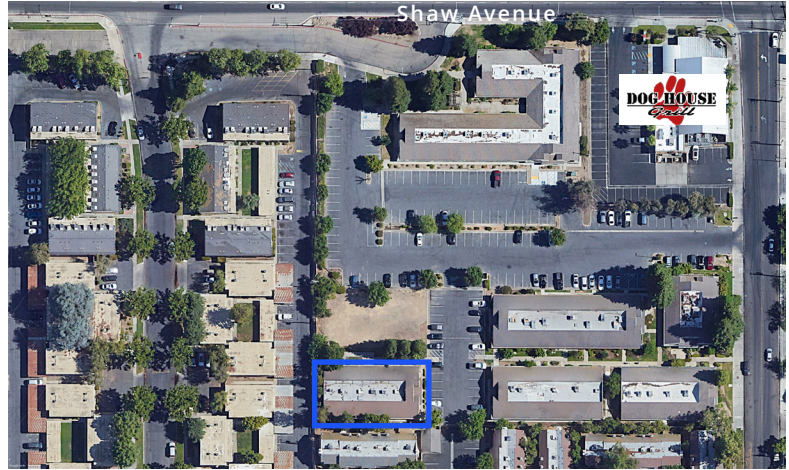

CONTACT US

**Beau Plumlee**

Senior Vice President | Principal  
+1 559 256 2443  
beau.plumlee@colliers.com  
CA Lic. 01269167

**Colliers**

7485 N. Palm Avenue, #110  
Fresno, California 93711  
P: +1 559 221 1271  
F: +1 559 222 8744

This document/email has been prepared by Colliers for advertising and general information only. Colliers makes no guarantees, representations or warranties of any kind, expressed or implied, regarding the information including, but not limited to, warranties of content, accuracy and reliability. Any interested party should undertake their own inquiries as to the accuracy of the information. Colliers excludes unequivocally all inferred or implied terms, conditions and warranties arising out of this document and excludes all liability for loss and damages arising there from. This publication is the copyrighted property of Colliers and /or its licensor(s). © 2024 All rights reserved. This communication is not intended to cause or induce breach of an existing listing agreement. Colliers Tingey International, Inc.

