

FOR LEASE | 2180 Westwood Blvd. Los Angeles, CA 90025



Prime West LA intersection of Westwood Blvd. & Olympic Blvd.



Just north of the Google office campus at Pico and Westwood Blvd.



Excellent visibility and signage from the street



Strong demographics including daytime pop, HH income, and population density



Subterranean parking with vertical transportation

JONATHAN STEIER

310.592.6674

jonathan@jsrealty.com

CA DRE#01224917

 **js realty co.**
COMMERCIAL BROKERAGE AND CONSULTING

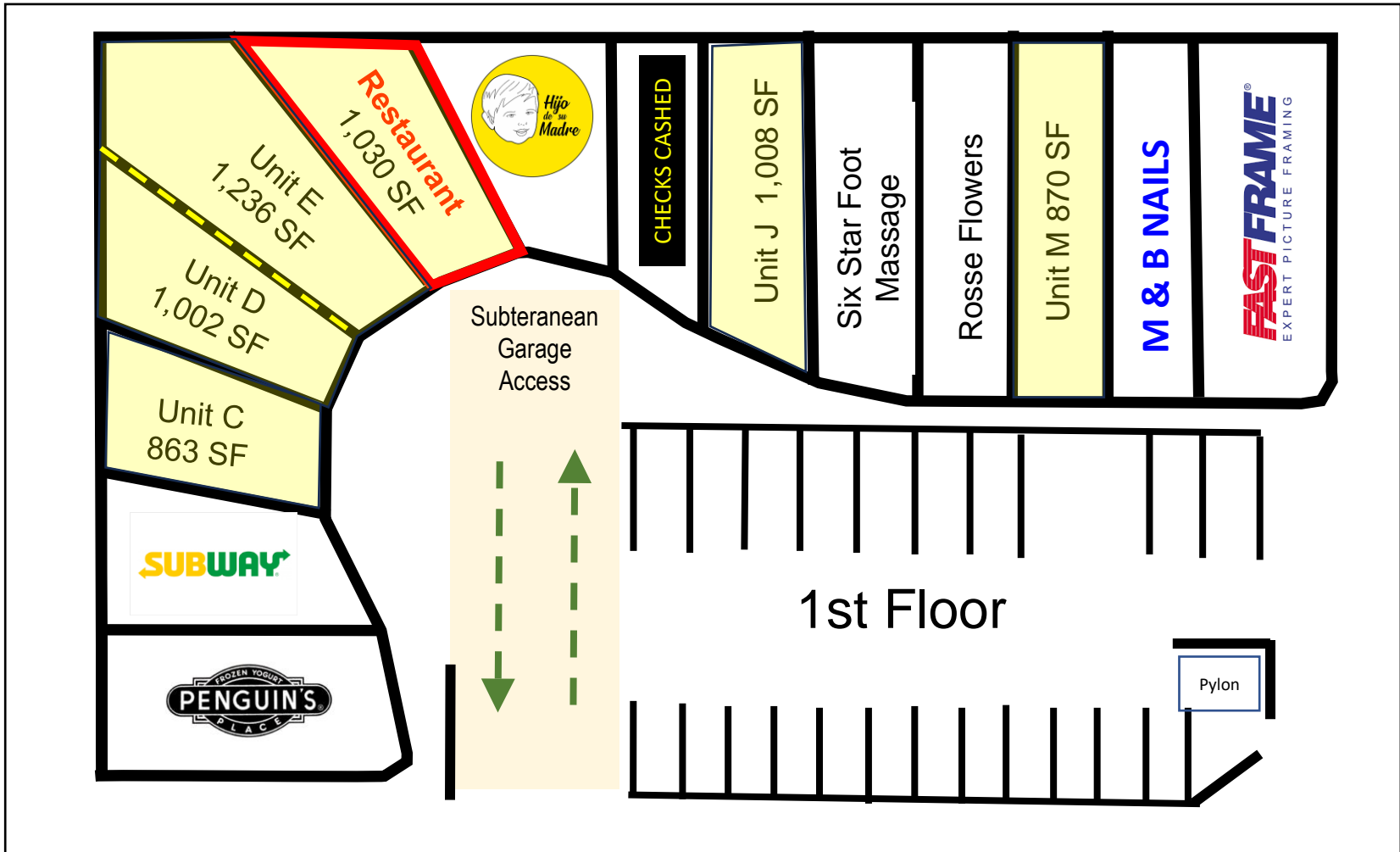

Asking \$3.25 PSF
NNN Approx. \$1.19 PSF

OLYMPIC BLVD

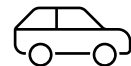

WESTWOOD BLVD

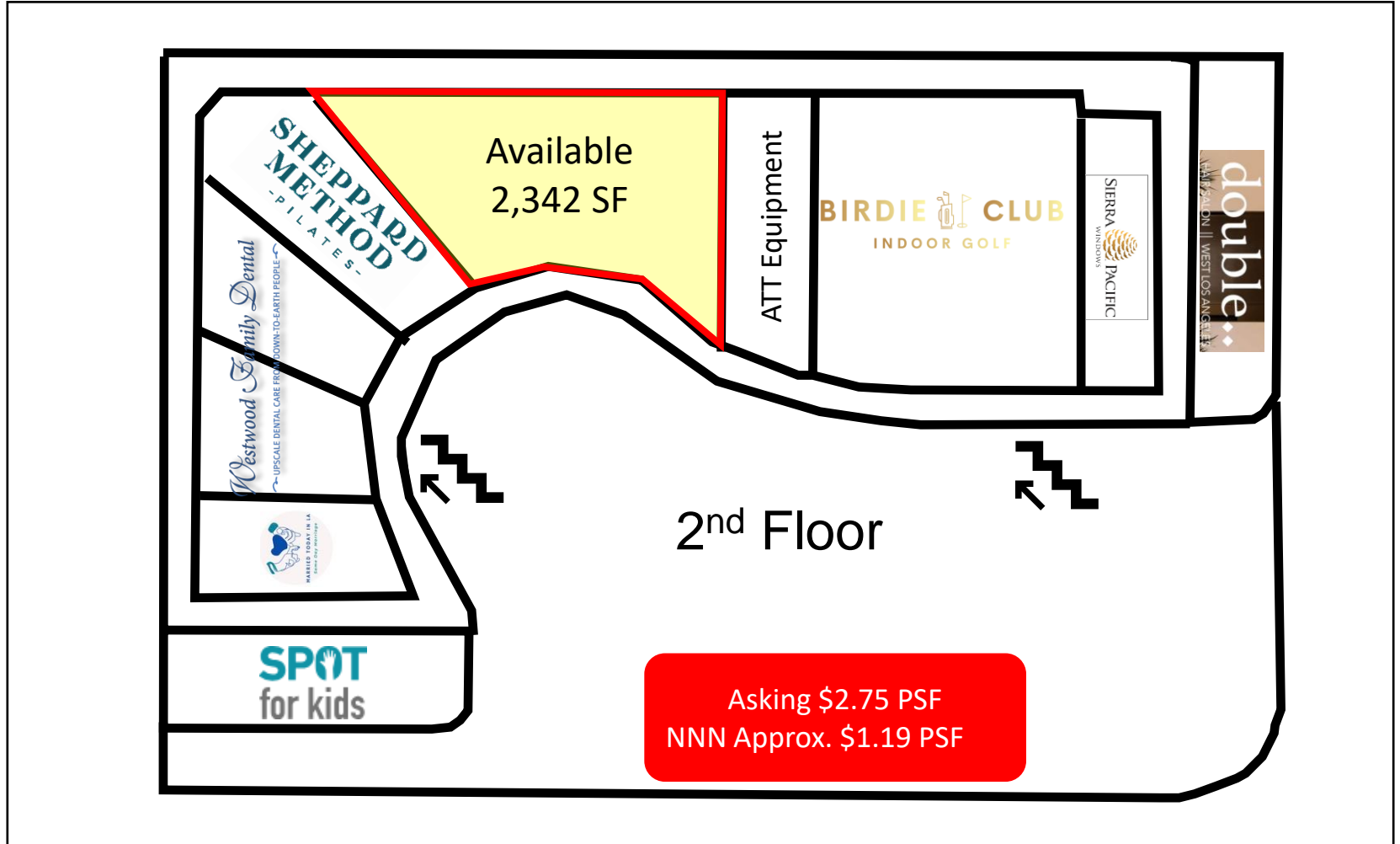



Traffic Counts:

Westwood Blvd	W Olympic Blvd SE	28,294	2022
W Olympic Blvd	Westwood Blvd NE	55,525	2022
Westwood Blvd	W Olympic Blvd NW	26,725	2022

110,544 cars per day

WALK SCORE: Very Walkable (84)

BIKE SCORE: Very Bikeable (74)

Jonathan Steier | 310.592.6674 | jonathan@jsrealtyco.com

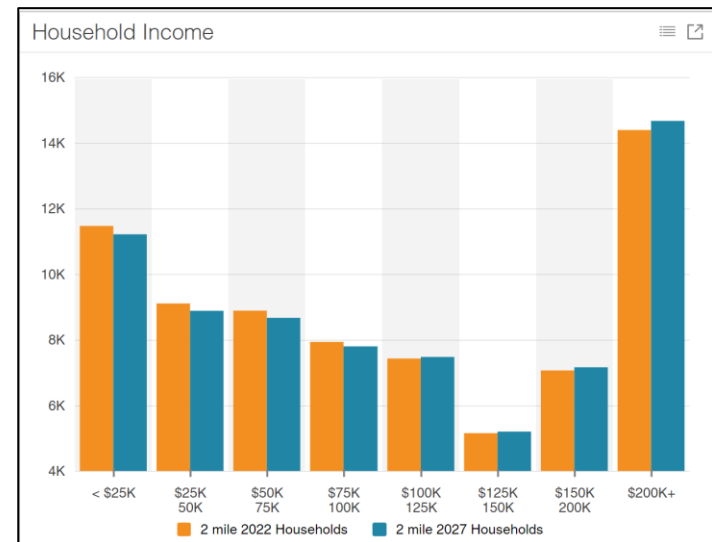
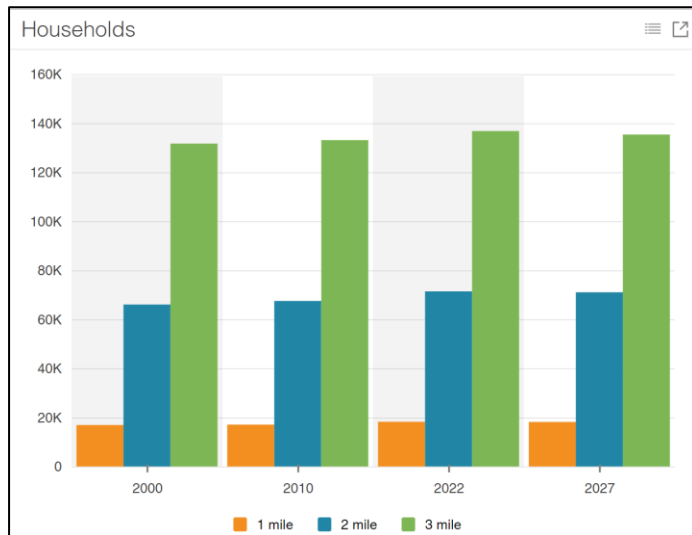
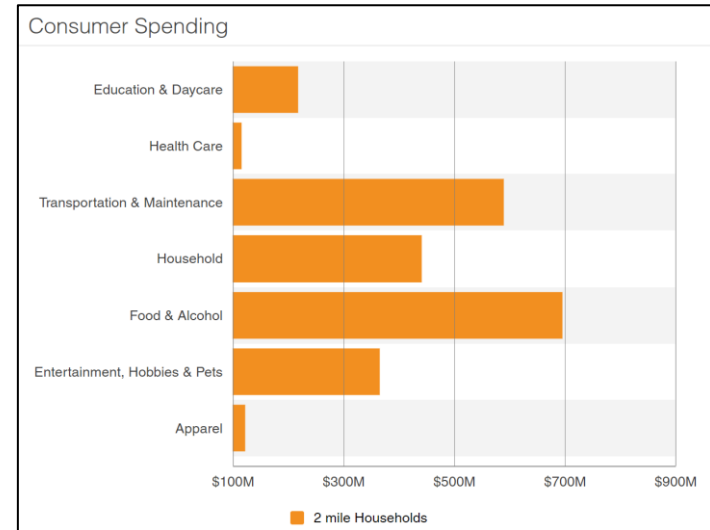
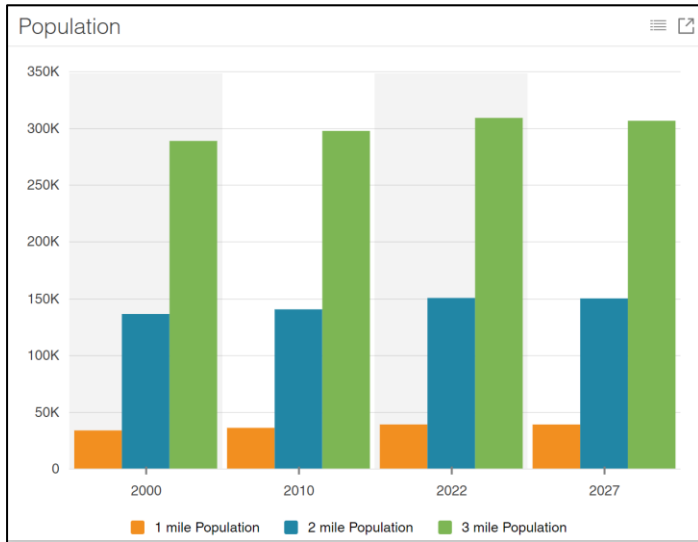

Jonathan Steier | 310.592.6674 | jonathan@jsrealtyco.com

This Marketing Brochure has been prepared to provide summary, information to prospective tenants, and to establish only a preliminary level of interest in the subject property. The information contained herein is not a substitute for a thorough due diligence investigation. js realty co. has not made any investigation, and makes no warranty or representation, regarding the future projected financial performance of the tenants, the size and square footage of the property and improvements, the presence or absence of contaminating substances, PCB's or asbestos, the compliance with State and Federal regulations, the physical condition of the improvements thereon, or the financial condition or business prospects of any tenant, or any tenant's plans or intentions to continue its occupancy of the subject property. The information contained in this Marketing Brochure has been obtained from sources we believe to be reliable; however, js realty co. makes no warranty or representation whatsoever regarding the accuracy or completeness of the information provided. All potential lessees must take appropriate measures to verify all of the information set forth herein.

Exclusive Agent:

JONATHAN STEIER

Principal | CADRE #01224917

310.592.6674

jonathan@jsrealtyco.com

www.jsrealtyco.com