



OFFICE SPACES FOR LEASE



Fairfield's most prominent professional office building, is a three-story Class "A" office building that's located nearby several restaurants and shopping centers. With easy access to I-80 East and West.

Excellent location for professional offices.

1300 OLIVER RD. FAIRFIELD, CA

FROM 711 - 9,714 SF SUITES PRICE **\$2.75/SF** (FULLY SERVICED)

PREMIER COMMERCIAL REAL ESTATE SERVICES
1300 Oliver Rd, Suite 300 Fairfield, CA 94534 | 707-436-7300

RON WASLOHN
Lic # 00832755
ron@pcres.net

707-436-7300

OFFICE SPACES FOR LEASE



BUILDING HIGHLIGHTS

- Excellent, visible location
- Easy access to I-80
- Dual elevator and full ADA access to all areas
- Security features include after hours keyless entry
- Easy access to local businesses, shopping, and restaurants
- Abundant on-site parking

CURRENT AVAILABILITIES

- | | | |
|------------------|----------------------|--------------------------|
| Suite 107 | JUST LEASED | } 9,714 SF
Contiguous |
| Suite 220 | 1,788 SF | |
| Suite 230 | 1,654 SF | |
| Suite 240 | 4,206 SF | |
| Suite 250 | 2,066 SF | |
| Suite 320 | 2,133 SF | |
| Suite 340 | JUST LEASED | |
| Suite 360 | 711 SF | |

LEASING SUMMARY

Class: A
Category: Office Building
Building Size: 60,000 SF

1300 OLIVER RD. FAIRFIELD, CA

FROM **711 - 9,714 SF SUITES** PRICE **\$2.75/SF** (FULLY SERVICED)



1300 OLIVER RD. FAIRFIELD, CA

FROM 711 - 9,714 SF SUITES PRICE **\$2.75/SF** (FULLY SERVICED)

PREMIER COMMERCIAL REAL ESTATE SERVICES
1300 Oliver Rd, Suite 300 Fairfield, CA 94534 | 707-436-7300

RON WASLOHN
Lic # 00832755
ron@pcres.net

707-436-7300

OFFICE SPACES FOR LEASE

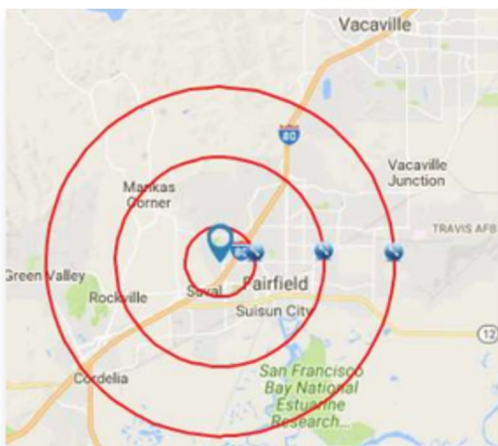

	1mi	3mi	5mi
Total Population	11,271	55,258	92,323
Daytime Population	19,532	76,790	111,900
Average HH Income (LoopNet)	\$75,037	\$70,657	\$81,488

AREA OVERVIEW

1300 OLIVER RD. FAIRFIELD, CA

FROM 711 - 9,714 SF SUITES PRICE **\$2.75/SF** (FULLY SERVICED)

OFFICE SPACES FOR LEASE

AVAILABLE SUITES

SECOND FLOOR PLAN

*9,714 SF Available Contiguous

NOT TO SCALE

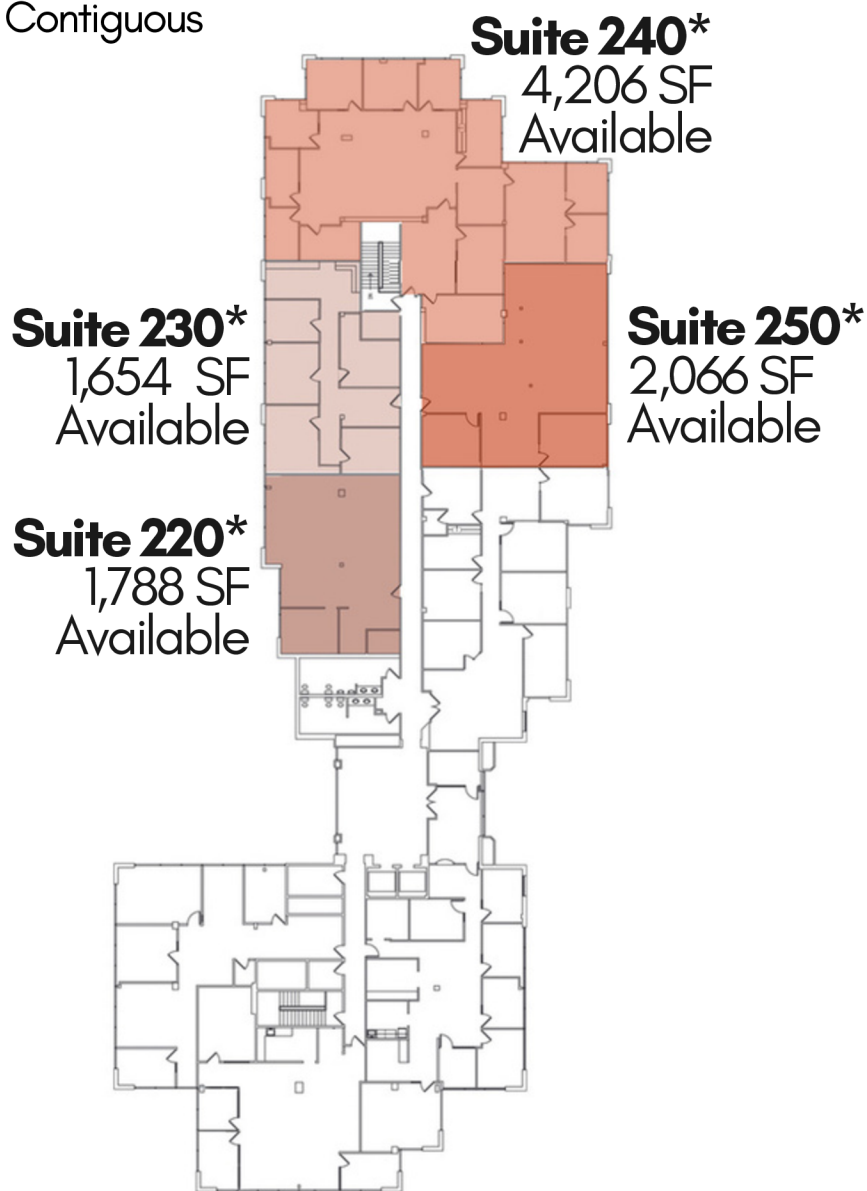

1300 OLIVER RD. FAIRFIELD, CA

FROM 711 - 9,714SF SUITES PRICE **\$2.75/SF** (FULLY SERVICED)

OFFICE SPACES FOR LEASE

AVAILABLE SUITES

THIRD FLOOR PLAN

NOT TO SCALE

Suite 360
711 SF
Available

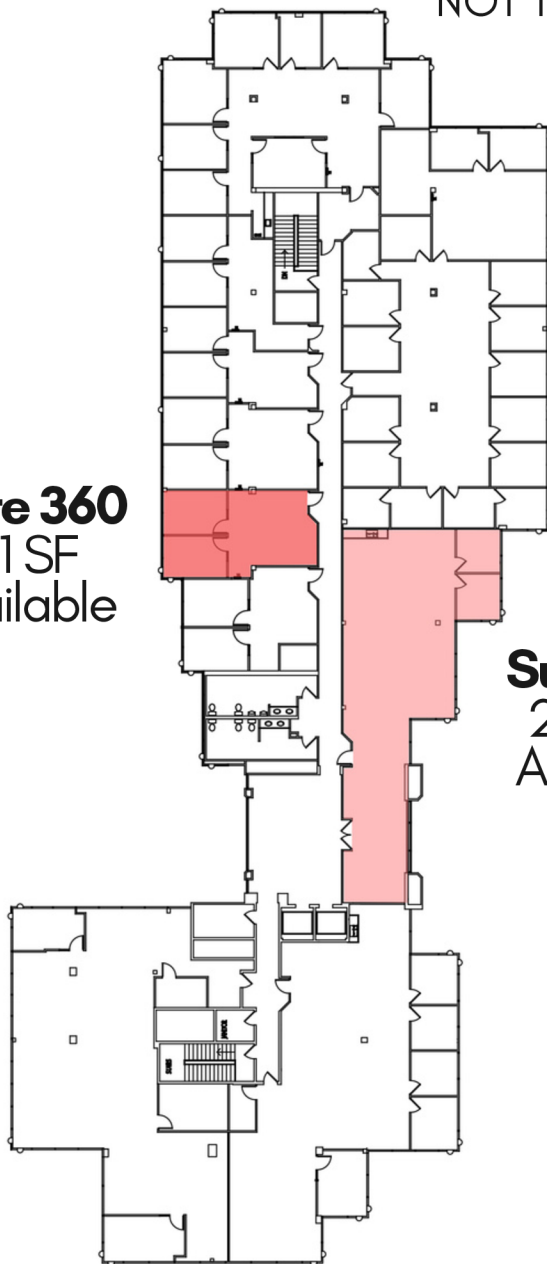

Suite 320
2,133 SF
Available

1300 OLIVER RD. FAIRFIELD, CA

FROM 711 - 9,714 SF SUITES PRICE **\$2.75/SF** (FULLY SERVICED)