



7184-7196 Morgan Road Liverpool, NY 13088

Office/Warehouse Space for Lease



Facts and Features

- **TOTAL SIZE:** 33,377 SF
- **AVAILABLE SPACE:** 14,422 SF (43% PRO-RATA SHARE)
- **LEASE PRICE:** \$7.75/SF NNN
- **NNN EXPENSES:** \$2.00/SF +/-
- **ZONING:** INDUSTRIAL –TOWN OF CLAY
- **PARKING:** 25 CARS PLUS FOR AVAILABE SPACE SECTION
- **UTILITIES:** GAS, SEWER, WATER, ELECTRIC

Exclusive Agent:

Ed Rogers
Real Estate Salesperson

Cell: 315-427-8510
Email: edr@jfrealestate.com



Disclaimer: JF Real Estate has obtained the information above from sources we believe to be reliable. However, we have not verified its accuracy and make no guarantee, warranty, or representation about it. It is submitted subject to the possibility of errors, omissions, change of price, rental or other conditions, prior sale, lease or financing, or withdrawal without notice. We include projections, opinions, assumptions or estimates for example only, and they may not represent current or future performance of the property. You and your tax and legal advisors should conduct your own investigation of the property and transaction.

JF Real Estate
The Atrium
2 Clinton Square, Suite 120
Syracuse, NY 13202



Facts and Features

- POWER: 3 PHASE, 277 VOLT, 200 AMP (ADDITIONAL AMPERAGE AVAILABLE)
- CEILING HGT: 17' +/- CLEAR IN AVAILABLE
- HEAT: OFFICES-HVAC
WAREHOUSE – GAS SPACE HEATERS
- DOORS: FOUR (4) DRIVE-IN
ONE (1) DOCK
- FEATURES: - ACCESSIBILITY TO EXIT 37 & 38 OF NYS THRUWAY AND RT. 81
CROSSROADS OF NY STATE

- ACROSS FROM AMAZON DISTRIBUTION CENTER



Disclaimer: JF Real Estate has obtained the information above from sources we believe to be reliable. However, we have not verified its accuracy and make no guarantee, warranty, or representation about it. It is submitted subject to the possibility of errors, omissions, change of price, rental or other conditions, prior sale, lease or financing, or withdrawal without notice. We include projections, opinions, assumptions or estimates for example only, and they may not represent current or future performance of the property. You and your tax and legal advisors should conduct your own investigation of the property and transaction.

JF Real Estate
The Atrium
2 Clinton Square, Suite 120
Syracuse, NY 13202



For Lease

7184-7196 Morgan Road



Disclaimer: JF Real Estate has obtained the information above from sources we believe to be reliable. However, we have not verified its accuracy and make no guarantee, warranty, or representation about it. It is submitted subject to the possibility of errors, omissions, change of price, rental or other conditions, prior sale, lease or financing, or withdrawal without notice. We include projections, opinions, assumptions or estimates for example only, and they may not represent current or future performance of the property. You and your tax and legal advisors should conduct your own investigation of the property and transaction.

JF Real Estate
The Atrium
2 Clinton Square, Suite 120
Syracuse, NY 13202



For Lease

7184-7196 Morgan Road

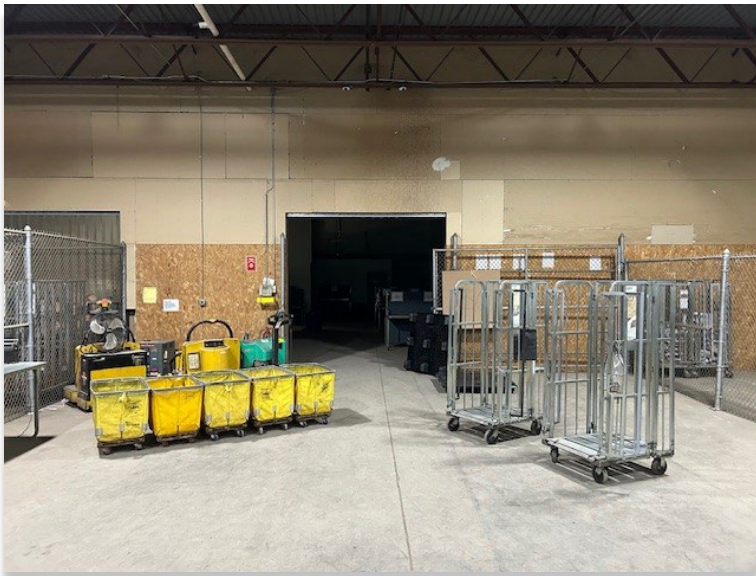

Disclaimer: JF Real Estate has obtained the information above from sources we believe to be reliable. However, we have not verified its accuracy and make no guarantee, warranty, or representation about it. It is submitted subject to the possibility of errors, omissions, change of price, rental or other conditions, prior sale, lease or financing, or withdrawal without notice. We include projections, opinions, assumptions or estimates for example only, and they may not represent current or future performance of the property. You and your tax and legal advisors should conduct your own investigation of the property and transaction.

JF Real Estate
The Atrium
2 Clinton Square, Suite 120
Syracuse, NY 13202



For Lease

7184-7196 Morgan Road

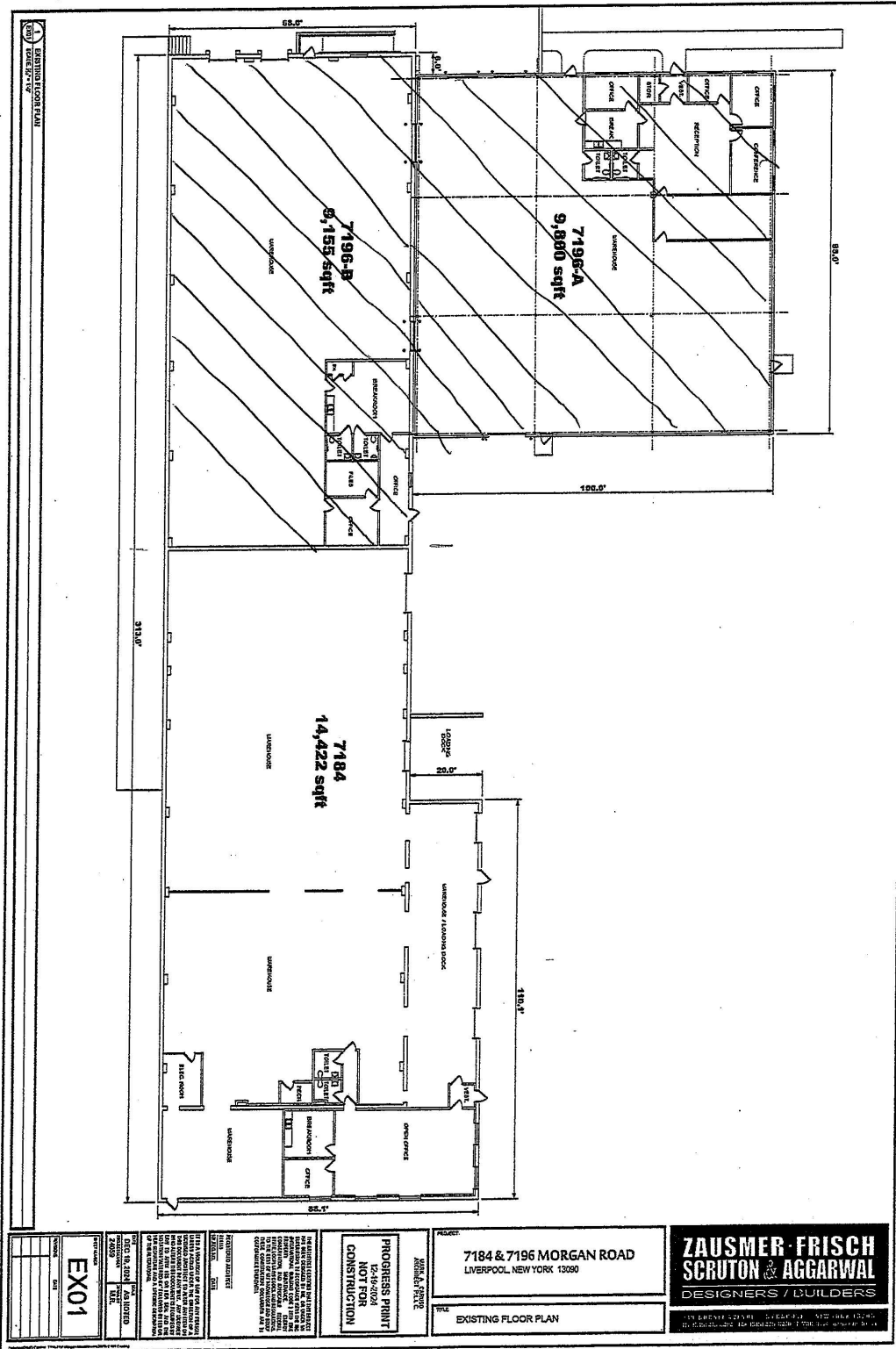

Disclaimer: JF Real Estate has obtained the information above from sources we believe to be reliable. However, we have not verified its accuracy and make no guarantee, warranty, or representation about it. It is submitted subject to the possibility of errors, omissions, change of price, rental or other conditions, prior sale, lease or financing, or withdrawal without notice. We include projections, opinions, assumptions or estimates for example only, and they may not represent current or future performance of the property. You and your tax and legal advisors should conduct your own investigation of the property and transaction.

JF Real Estate
The Atrium
2 Clinton Square, Suite 120
Syracuse, NY 13202



For Lease

7184-7196 Morgan Road

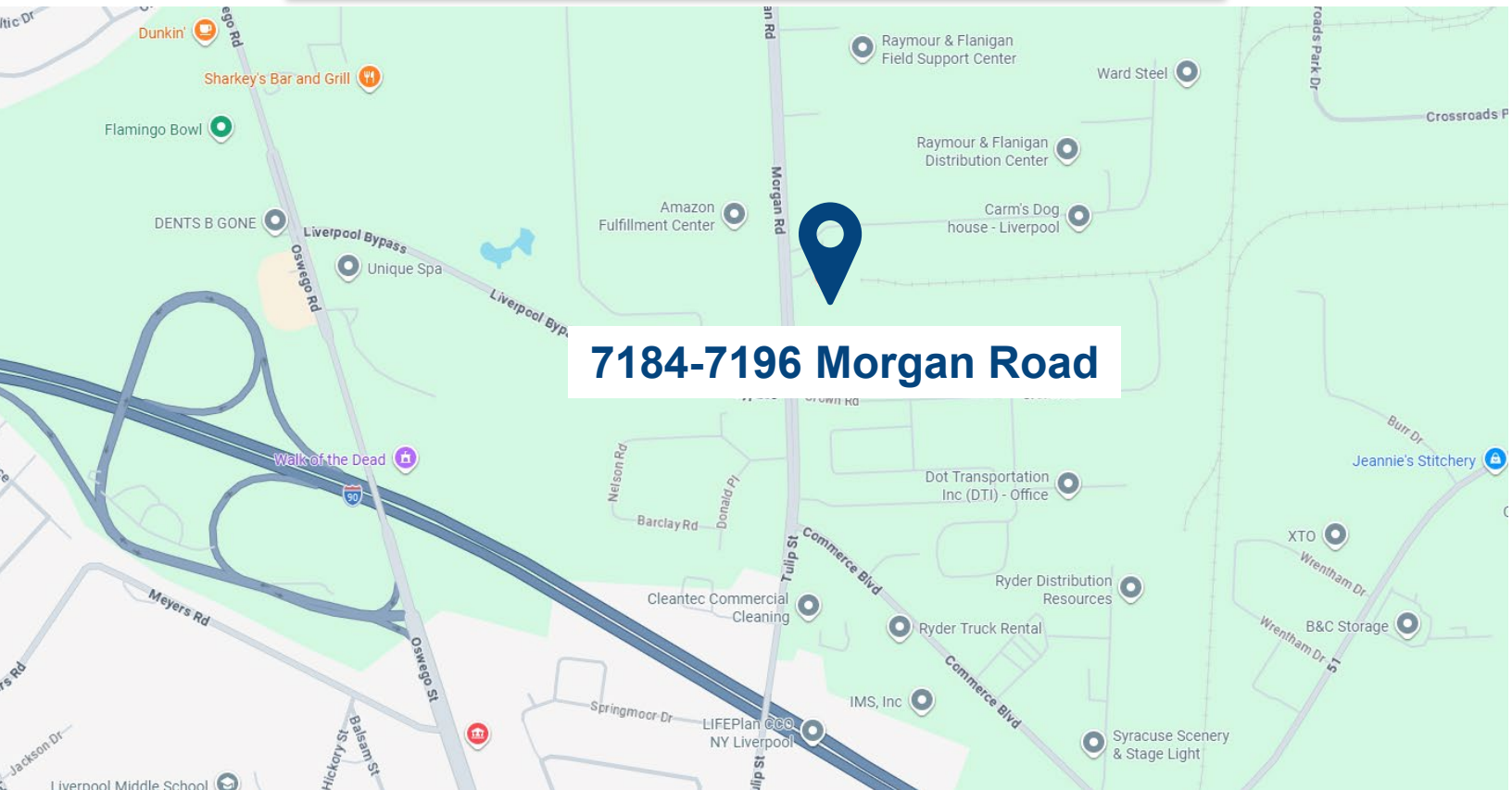

7184-7196 Morgan Road

Disclaimer: JF Real Estate has obtained the information above from sources we believe to be reliable. However, we have not verified its accuracy and make no guarantee, warranty, or representation about it. It is submitted subject to the possibility of errors, omissions, change of price, rental or other conditions, prior sale, lease or financing, or withdrawal without notice. We include projections, opinions, assumptions or estimates for example only, and they may not represent current or future performance of the property. You and your tax and legal advisors should conduct your own investigation of the property and transaction.

JF Real Estate
The Atrium
2 Clinton Square, Suite 120
Syracuse, NY 13202

