

PLOTTED: 6/9/2020 11:08 AM

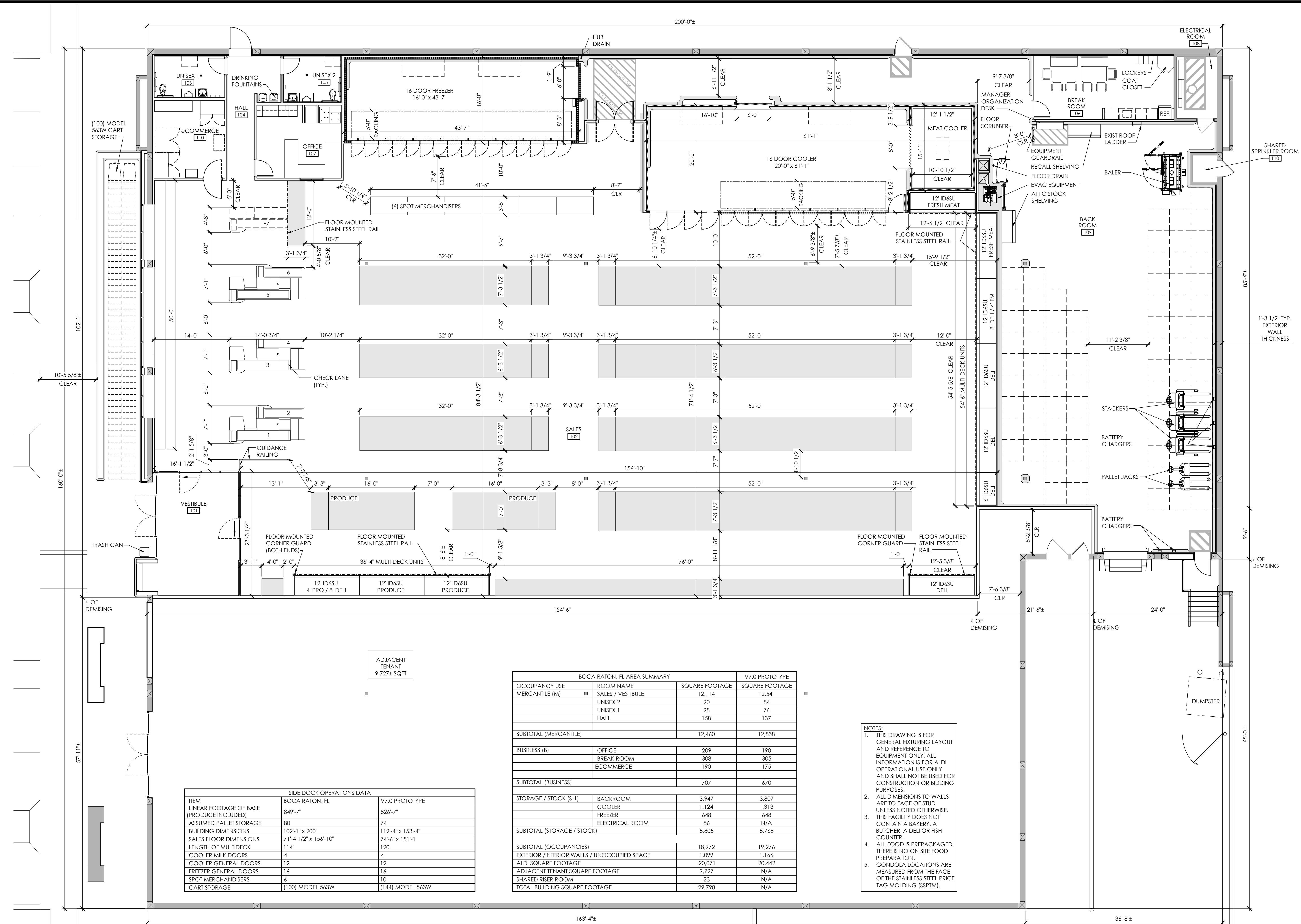

SIDE DOCK OPERATIONS DATA		
ITEM	BOCA RATON, FL	V7.0 PROTOTYPE
LINEAR FOOTAGE OF BASE (PRODUCE INCLUDED)	849'-7"	826'-7"
ASSUMED PALLET STORAGE	80	74
BUILDING DIMENSIONS	102'-1" x 200'	119'-4" x 153'-4"
SALES FLOOR DIMENSIONS	71'-4 1/2" x 156'-10"	74'-6" x 151'-1"
LENGTH OF MULTIDECK	114'	120'
COOLER MILK DOORS	4	4
COOLER GENERAL DOORS	12	12
FREEZER GENERAL DOORS	16	16
SPOT MERCHANDISERS	6	10
CART STORAGE	(100) MODEL 563W	(144) MODEL 563W

BOCA RATON, FL AREA SUMMARY			
OCCUPANCY USE	ROOM NAME	SQUARE FOOTAGE	V7.0 PROTOTYPE
MERCANTILE (M)	SALES / VESTIBULE	12,114	12,541
	UNISEX 2	90	84
	UNISEX 1	98	76
	HALL	158	137
	SUBTOTAL (MERCANTILE)		12,460
BUSINESS (B)	OFFICE	209	190
	BREAK ROOM	308	305
	ECOMMERCE	190	175
SUBTOTAL (BUSINESS)		707	670
STORAGE / STOCK (S-1)	BACKROOM	3,947	3,807
	COOLER	1,124	1,313
	FREEZER	648	648
	ELECTRICAL ROOM	86	N/A
	SUBTOTAL (STORAGE / STOCK)		5,805
SUBTOTAL (OCCUPANCIES)		18,972	19,276
	EXTERIOR / INTERIOR WALLS / UNOCCUPIED SPACE	1,099	1,166
	ALDI SQUARE FOOTAGE	20,071	20,442
	ADJACENT TENANT SQUARE FOOTAGE	9,727	N/A
	SHARED RISER ROOM	23	N/A
	TOTAL BUILDING SQUARE FOOTAGE	29,798	N/A

NOTES:

- THIS DRAWING IS FOR GENERAL FIXTURING LAYOUT AND REFERENCE TO EQUIPMENT ONLY. ALL INFORMATION IS FOR ALDI OPERATIONAL USE ONLY AND SHALL NOT BE USED FOR CONSTRUCTION OR BIDDING PURPOSES.
- ALL DIMENSIONS TO WALLS ARE TO FACE OF STUD UNLESS NOTED OTHERWISE.
- THIS FACILITY DOES NOT CONTAIN A BAKERY, A BUTCHER, A DELI OR FISH COUNTER.
- ALL FOOD IS PREPACKAGED. THERE IS NO ON SITE FOOD PREPARATION.
- GONDOLA LOCATIONS ARE MEASURED FROM THE FACE OF THE STAINLESS STEEL PRICE TAG MOLDING (SSPTM).

1 Operations Plan
SCALE: 1/8" = 1'-0"
NORTH

Issued:	Date:
A CFP-1 Issued for Client Review	06/25/19
B CEE-1 Issued for Client Review	06/09/20
C	
D	
E	
Revisions:	Date:
1 CFP-2 Issued for Client Review	07/10/19
2 CFP-3 Issued for Client Review	06/09/20
3	
4	
5	
6	
7	
8	
9	

Seal	Seal
PROJECT ARCHITECT/ENGINEER	DATE
PROJECT LEAD	DATE
PROJECT DESIGNER	DATE

Copyright © 2019
APD Engineering & Architecture, PLLC
Drawing Alteration
It is a violation of law for any person, unless acting under the direction of licensed Architect, Professional Engineer, Landscape Architect, or Land Surveyor to alter any item on this document in any way. Any licensee who offers this document is required by law to affix his or her seal and to add the notation "Altered By" followed by his or her signature and the specific description of the alteration or revision.
DO NOT SCALE PLANS
Copying, Printing, Software and other processes required to produce these prints can stretch or shrink the actual paper or layout. Therefore, scaling of this drawing may be inaccurate. Contact APD E&A with any need for additional dimensions or clarifications.



ALDI Inc. Store #: XX
East Boca
4901 N Federal Hwy
Boca Raton, FL 33431
Palm Beach County
Project Name & Location:

Concept Floor Plan Drawing Name:	Project No. 19-0263A
Date: 06/25/19	
Type: RETROFIT	
Drawn By: ACN	CFP-3
Scale: As Noted	Drawing No.