

DRAWING INDEX

SHEET	DRAWING TITLE
1 of 15	SITE PLAN
2 of 15	SITE DEMOLITION PLAN
3 of 15	SITE GRADING & DRAINAGE PLAN
4 of 15	SITE UTILITY & SANITARY WASTE PLAN
5 of 15	SANITARY WASTE DETAILS
6 of 15	SITE LIGHTING PLAN
7 of 15	SITE EROSION & SEDIMENT CONTROL PLAN
8 of 15	SITE LANDSCAPE PLAN
9 of 15	SITE CONSTRUCTION DETAILS
10 of 15	SITE CONSTRUCTION DETAILS
11 of 15	WORK ZONE TRAFFIC CONTROL PLAN
12 of 15	DOT CONSTRUCTION DETAILS
13 of 15	GENERAL NOTES
14 of 15	FLOOR PLAN
15 of 15	BUILDING ELEVATIONS

NOTE: PRIOR TO THE ISSUANCE OF ANY BUILDING PERMITS A PRE-CONSTRUCTION MEETING WITH THE DEPARTMENT OF ENGINEERING SERVICES SHALL BE SCHEDULED BY THE APPLICANT/OWNER/BUILDER/DEVELOPER.

NOTE: REPAIR OR REPLACE EXISTING PERIMETER FENCING AS DETERMINED NECESSARY BY THE TOWN ENGINEERING INSPECTOR

NOTE: SIGN POLES, AREA LIGHT FOOTINGS, OR ANY OTHER OBJECTS MUST BE SET A MINIMUM OF TWO (2) FEET FROM ANY CURB LINE TO AVOID INTERFERENCE WITH THE DESIGNATED PARKING AREA

GOVERNMENT AGENCIES

TOWN OF HUNTINGTON
 PLANNING & ENVIRONMENT DIVISION (631) 351-3196
 BUILDING & HOUSING DIVISION (631) 351-2822
 FIRE PREVENTION BUREAU (631) 351-3138
 TRANSPORTATION AND TRAFFIC SAFETY DIVISION (631) 351-3053
 SUFFOLK COUNTY
 DEPARTMENT OF WASTEWATER MANAGEMENT (631) 852-2100

NYS DOT NOTES

- REPAIR EXISTING SHOULDER, SIDEWALK AND CURBING AS ORDERED BY THE STATE ENGINEER.
- CLEAN OUT EXISTING DRAINAGE STRUCTURES AT COMPLETION OF CONSTRUCTION.
- THE CONTRACTOR SHALL BE RESPONSIBLE FOR AND SHALL REPLACE ALL SIGNAL INTERCONNECT CABLE, DETECTOR CABLE, CONDUIT AND ALL UNDERGROUND ACCESSORY EQUIPMENT DURING CONSTRUCTION.
- ALL TRAFFIC SIGNALS SHALL BE MAINTAINED IN A TRAFFIC RESPONSIVE OPERATION AND ALL INTERCONNECT, WHERE EXISTING, SHALL BE MAINTAINED. THE CONTRACTOR SHALL PAY A LIQUIDATED DAMAGES CHARGE OF \$500.00 PER CALENDAR DAY IF ACTIVATION AND COORDINATION IS NOT MAINTAINED.
- ANY CONSTRUCTION AND/OR UTILITY WORK PROPOSED IN STATE HIGHWAY RIGHT OF WAY WILL REQUIRE SEPARATE APPLICATION AND SUBMISSION OF PLANS (INSTALLATION DETAILS, RESTORATION DETAILS AND WORK ZONE TRAFFIC CONTROL PLAN - ALL REFERENCED TO NYS DOT SPECIFICATION ITEMS NUMBERS AND THE NATIONAL MANUAL OF UNIFORM TRAFFIC CONTROL DEVICES WITH NYS SUPPLEMENT) TO NYS DOT MELVILLE MAINTENANCE FACILITY. A UTILITY HWP ISSUANCE IS REQUIRED FOR SITE WORK. PRIOR TO STARTING ANY WORK AT THIS LOCATION, THE CONTRACTOR SHALL NOTIFY THE NEW YORK STATE DEPARTMENT OF TRANSPORTATION THAT A TONE-OUT OF SIGNAL EQUIPMENT IS NEEDED.
- SNOW STAKES SHALL BE LOCATED AND INSTALLED AS DIRECTED BY STATE ENGINEER.

GROUND WATER INFORMATION

SEE SHEETS 4 & 5 OF 15 FOR SOIL BORING LOCATION AND INFORMATION

LINE / SYMBOL LEGEND

PROPERTY LINE	---
SETBACK LINE	- - - - -
TO BE REMOVED
WATER	W
ELECTRICAL	E
GAS	G
TELEPHONE	T
SANITARY SEWER	SS
STORMWATER DRAIN PIPE	SD
OVERHEAD WIRES	///
CHAINLINK FENCE	X X X X X
STEEL BUMPER RAIL	
CLEANOUT	CO
PARKING I.D.	▲
UTILITY POLE	⊙

SITE PLAN NOTES

- ALL IMPROVEMENTS SHALL BE MADE IN ACCORDANCE WITH THE TOWN OF HUNTINGTON SUBDIVISION AND SITE PLAN REGULATIONS.
- ALL COMMERCIAL AND INDUSTRIAL PROPERTIES SHALL BE REQUIRED TO PROVIDE CURBS, SIDEWALKS AND STREET TREES AS PER THE TOWN OF HUNTINGTON SUBDIVISION AND SITE PLAN REGULATIONS.
- ALL SIGNS SHOWN ON THIS PLAN SHALL BE SUBMITTED UNDER SEPARATE APPLICATION TO THE APPROPRIATE AGENCIES.

SCOPE OF WORK

- CONSTRUCT ONE STORY 3,463 SQ.FT. ADDITION TO EXISTING BUILDING.
- INSTALL NEW CURBING, DRAINAGE, PAVING, LANDSCAPING, ETC.
- SEE SITE PLAN AND OTHER DRAWINGS FOR FURTHER DESCRIPTIONS & SPECIFICATIONS.

SITE DATA

LOCATION: MELVILLE
 TOWN OF HUNTINGTON
 COUNTY OF SUFFOLK
 STATE OF NEW YORK
 DISTRICT: 400 SECTION: 267
 BLOCK: 1 LOT: 54.001
 SCHOOL DISTRICT: 5
 FIRE DISTRICT: 18
 USE: PROFESSIONAL OFFICES
 ZONING: (C-6) GENERAL BUSINESS DISTRICT
 OWNER: MVG REALTY LLC
 585 BROADHOLLOW ROAD
 MELVILLE, NEW YORK 11747

LOT AREA: 131,127 SQ.FT. (3.01 ACRE)
 LOT FRONTAGE: 382 FEET
 LOT DEPTH: 380 FEET (AVG.) (VARIES)
 LOT DEPTH: 326 FEET (AVG.) (VARIES)
 SETBACKS:
 FRONT YARD: 59'-7"
 SIDE YARD(S): 98'-0"
 REAR YARD: 159'-6"

LANDSCAPING:
 AREA: 59,586 SQ.FT.
 PERCENTAGE LOT COVERAGE: 45.4%
 AREA TO REMAIN UNDEVELOPED = NONE [NO CHANGE]
 PERCENTAGE LOT COVERAGE: 0%
 PAVING:
 AREA: 56,614 SQ.FT.
 PERCENTAGE LOT COVERAGE: 43.2%
 PARKING CALCULATIONS:
 USE: PROFESSIONAL OFFICE SPACE
 REQUIREMENT = ONE SPACE PER 225 SQ.FT. OF GROSS FLOOR AREA
 BUILDING AREA FOR OFFICE SPACE = 14,927 SQ.FT.
 14,927/225 = 66.34 = 67 SPACES REQUIRED
 TOTAL PARKING PROVIDED = 114 SPACES (INCLUDING 5 ADA SPACES)

ZONING CHART (C-6 GENERAL BUSINESS DISTRICT)

	PERMITTED	PROVIDED
MAXIMUM BUILDING HEIGHT	3 STORIES/45 FEET	1/24'-7"
MINIMUM FRONT YARD SETBACK	N/A	58'-7"
MINIMUM REAR YARD SETBACK	N/A	159'-6"
MINIMUM SIDE YARD SETBACK	N/A	98'-0" & 105'-6"
MINIMUM LOT AREA	N/A	131,127 SQ.FT. (3.01 ACRES)
MINIMUM LOT WIDTH	N/A	287'-0"
MINIMUM LOT FRONTAGE	N/A	382'-0"
MAXIMUM % OF LOT COVERED BY BUILDING	N/A	11.4%

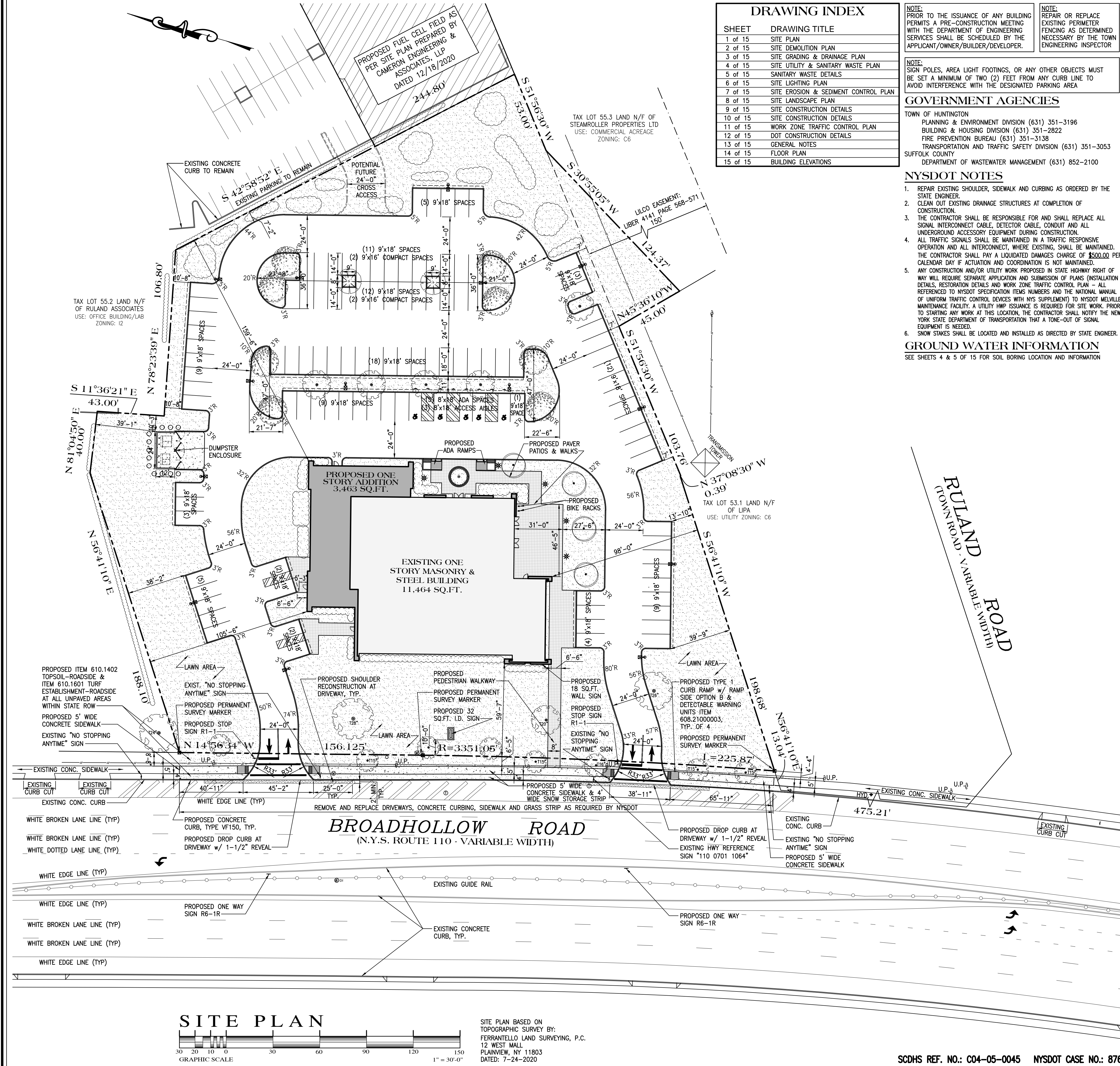
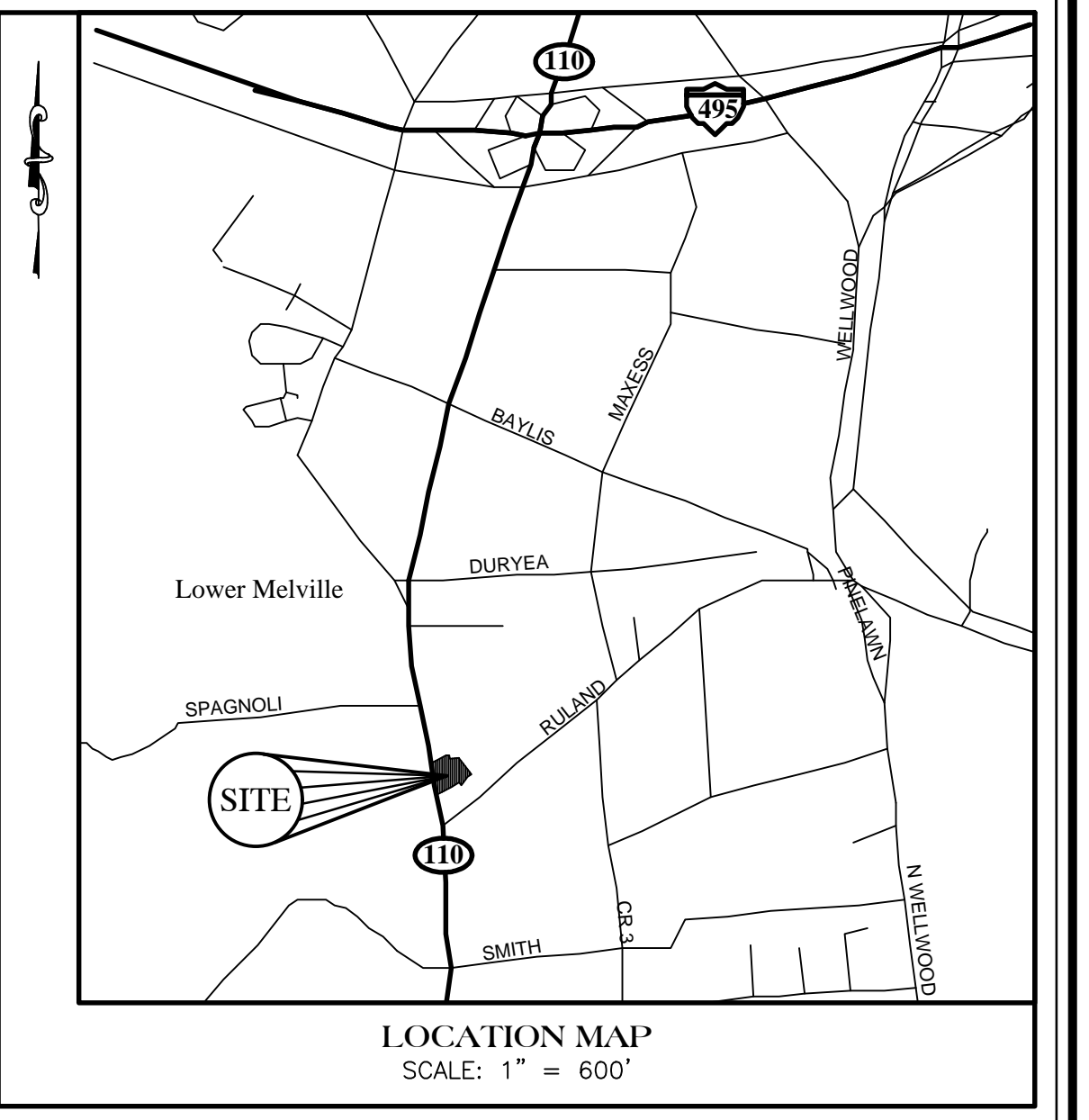

SITE PLAN

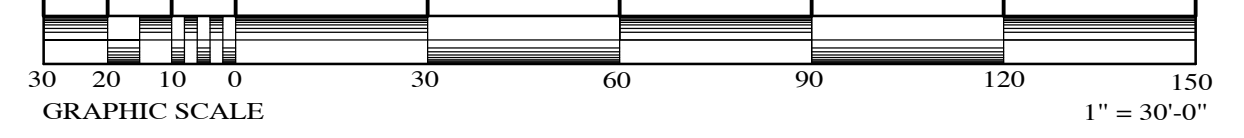

SITE PLAN BASED ON TOPOGRAPHIC SURVEY BY: FERRANTELLI LAND SURVEYING, P.C. 12 WEST MALL PLAINVIEW, NY 11803 DATED: 7-24-2020

FOR TOWN USE

No.	REVISIONS	DATE
1	REVISED AS PER TOWN COMMENTS DATED JUNE 17, 2020	10/8/20
2	REVISED AS PER SCDHS COMMENTS DATED NOVEMBER 23, 2020	5/19/21
3	REVISED AS PER NYS DOT COMMENTS DATED JANUARY 20, 2021	5/19/21
4	REVISED AS PER TOWN PLANNING & ENVIRONMENTAL COMMENTS DATED MARCH 3, 2021	5/19/21
5	REVISED AS PER SCDHS COMMENTS DATED JUNE 16, 2021	7/13/21

OWNER: MVG REALTY LLC
 585 BROADHOLLOW ROAD
 MELVILLE, NY 11747

APPLICANT: CATAPANO ENGINEERING & ARCHITECTURE, P.C.
 585 BROADHOLLOW ROAD
 MELVILLE, NY 11747

JOHN V. CATAPANO

SITE PLAN

*** CATAPANO ENGINEERING & ARCHITECTURE, P.C.

SITUATED AT 585 BROADHOLLOW ROAD MELVILLE

TOWN OF HUNTINGTON, SUFFOLK COUNTY, NEW YORK
 DISTRICT: 0400 SECTION: 267.00 BLOCK: 01.00 LOT: 054.001

CATAPANO ENGINEERING & ARCHITECTURE, P.C.

ENGINEERING SITE PLANNING ARCHITECTURE PERMITTING ENVIRONMENTAL CONSULTING
 585 BROADHOLLOW ROAD, MELVILLE, NY 11747
 TEL: (631) 694-9696 FAX: (631) 694-0394
 www.catapano.com

LICENSE NO. 70884

DRAWING NO.: 2020015C1.0

SCALE: AS SHOWN

DATE: 10/8/2020

SHEET: 1 OF 15