



Brady Sullivan Properties  
670 N. Commercial Street  
Manchester, nh 03101  
603.622.6223

**Notice:**  
This drawing is the property of Brady Sullivan Properties. The use, re-use or reproduction of this drawing for any purpose whatsoever without an expressed written agreement between BSP and the user is prohibited. Rights to use the information on this sheet are not transferred until payment has been received for services rendered. Any rights so granted are non-transferable to other parties without the prior expressed written consent of BSP.

© 2015 Brady Sullivan Properties

Owner

**BRADY SULLIVAN  
PROPERTIES**

MANCHESTER  
NH

Project

**1750 ELM STREET**

MANCHESTER NH

Seals

Issues

Date	Description

Revisions

No.	Date	Description

Drawing Title

**SUITE 803**

Issue Date:

9-2-2021

Project No:

Scale: As Indicated

Project Manager:

Production Leader:

Project Architect:

Peer Reviewer:

Drawing Number

**A.105**

LEGEND	
	NOT IN SCOPE
	PROPOSED ITEMS (HEAVY LINE WEIGHT)
	EXISTING ITEMS
	EXISTING DOOR AND FRAME TO REMAIN
	NEW DOOR AND FRAME
	DEMO ITEMS

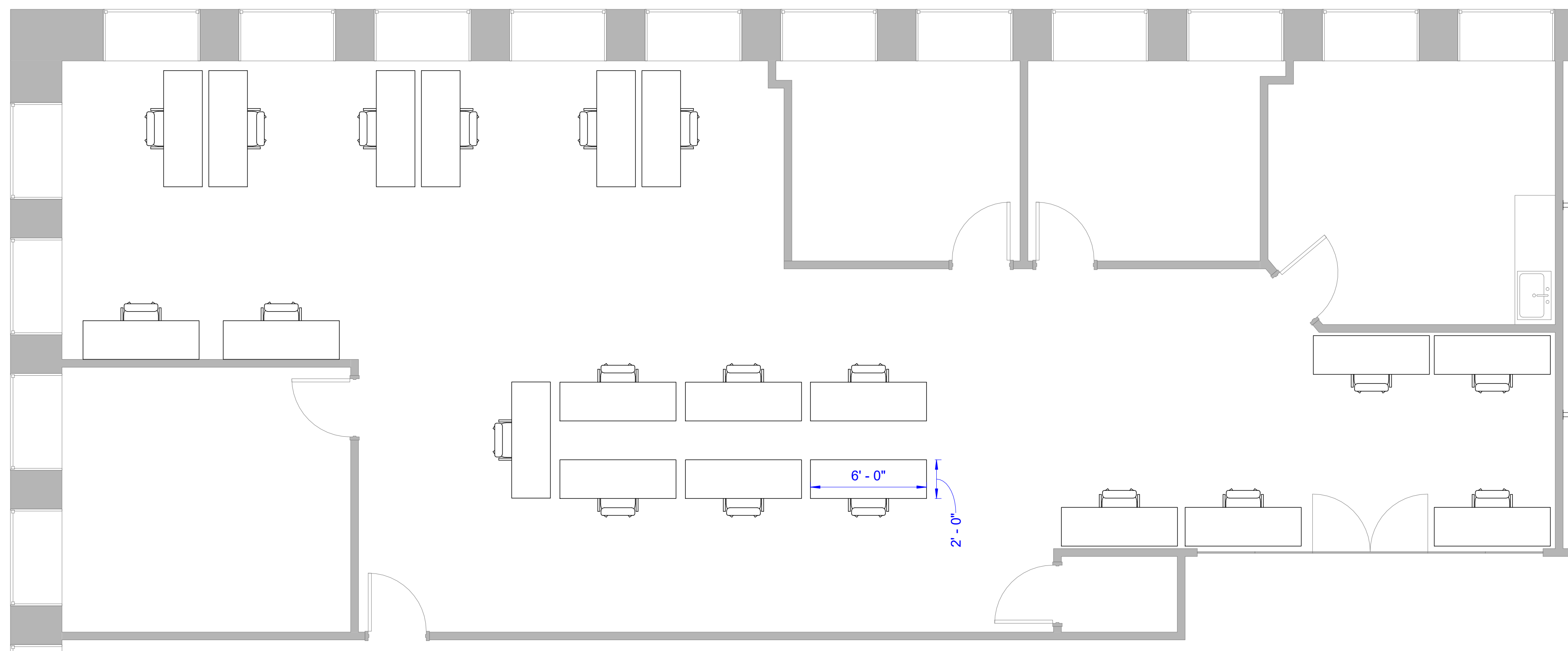

**1 SUITE 803**  
1/4" = 1'-0"

**DISCLAIMER:** ALL BUILDOUT IS BASED ON BRADY SULLIVAN PROPERTIES "CONSTRUCTION STANDARDS". BRADY SULLIVAN PROPERTIES RESERVES THE RIGHT TO ISSUE A CHANGE ORDER FOR ADDITIONAL WORK NOT INCLUDED IN DRAWINGS.

9/2/2021 8:55:38 AM