

Colliers

On Campus at Adventist Health Specialty Hospital

**CCMC**  
Central Cardiology  
A Division of  
GENTRIC HEALTH

For Lease | +/- 3,000 SF - 5,504 SF

## Class A Medical Office Space Central Cardiology Building

2901 Sillect Ave | Bakersfield, CA

**Contact Us:**

**David A. Willilams, SIOR**

Senior Vice President | Principal  
License No. 00855489  
+1 661 631 3816  
david.a.williams@colliers.com

**Jason Alexander**

Senior Vice President | Principal  
License No. 01360995  
+1 661 631 3818  
jason.alexander@colliers.com

**Colliers International**

10000 Stockdale Hwy, Suite 102  
Bakersfield, CA 93311  
+1 661 631 3800  
www.colliers.com/bakersfield

Position your practice for success at 2901 Sillect Avenue - a prime medical office opportunity in a highly accessible, high-visibility location. Located in the Central Cardiology building, this well-maintained property is ideally suited for healthcare professionals seeking a functional and welcoming environment for patients. The space offers a flexible layout configured with exam rooms, private offices, reception, and administrative areas. Ample on-site parking ensures convenience for both staff and patients, while the strategic location near major thoroughfares such as Freeway 99 and Rosedale Hwy, provides easy access from across Bakersfield.

**Available:**

**Lease Rate:**

Suite 202:

\$2.25/SF, Modified. Gross

+/- 3,000 SF - 5,504 SF

*\*Tenant Improvement Package Available*

## Property Highlights:

- Prominent Class A medical office building offering a professional, modern environment ideal for healthcare providers seeking a polished presence.
- Turnkey, lease-ready suite requiring little to no tenant improvements, allowing for a seamless and efficient move-in.
- Convenient elevator access providing easy, ADA-compliant circulation for patients, staff, and visitors.
- Excellent connectivity with quick access to Freeway 99, Golden State Freeway, and Rosedale Highway, ensuring smooth commutes from all parts of Bakersfield.
- Abundant on-site parking surrounding the building, offering hassle-free access for both patients and employees.
- Public transportation convenience with a bus stop located directly in front of the property.
- Centrally located within Bakersfield, providing easy access to surrounding medical, retail, and professional amenities.



# Floor Plan

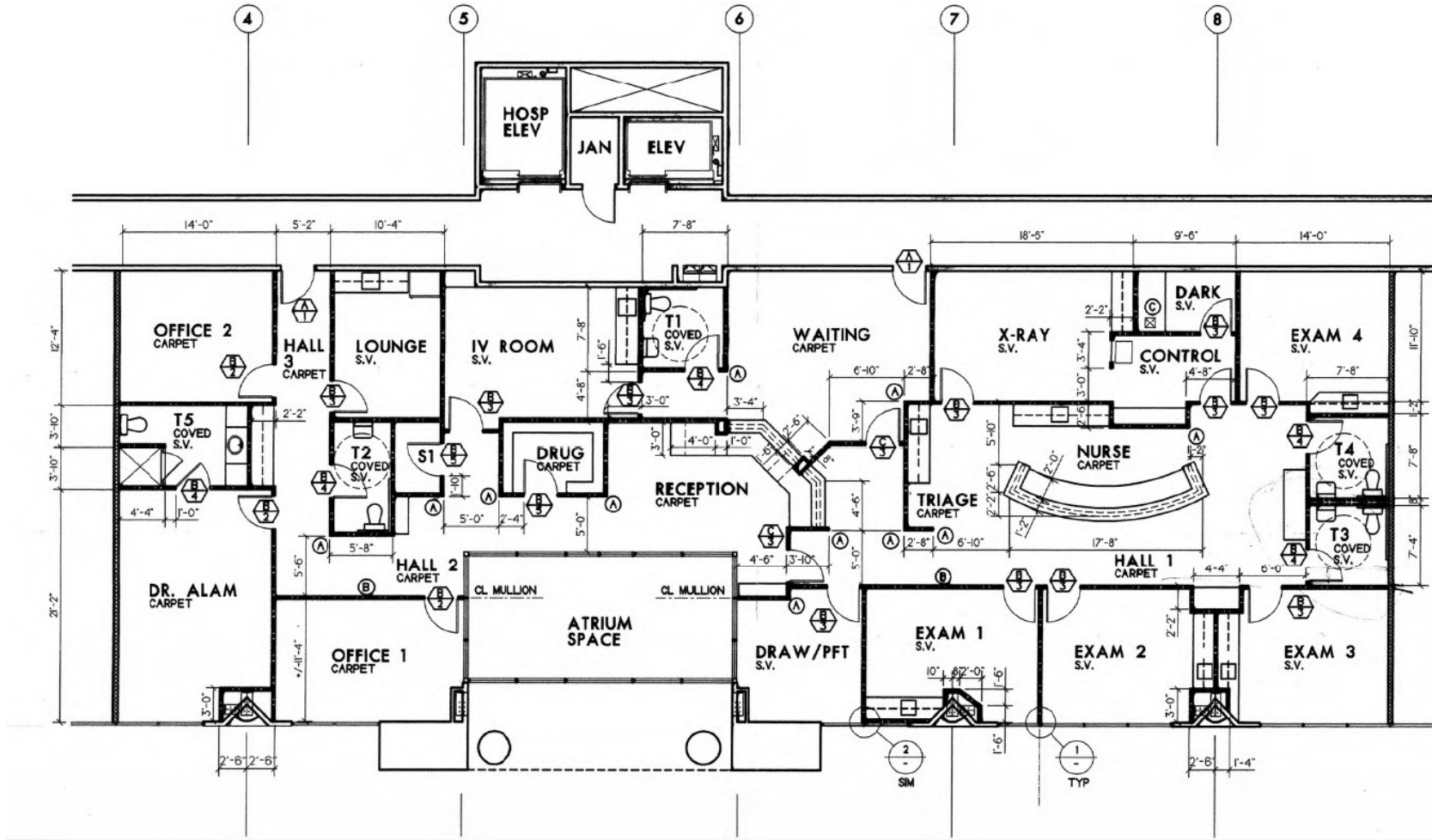

# Interior Photos



This document/email has been prepared by Colliers for advertising and general information only. Colliers makes no guarantees, representations or warranties of any kind, expressed or implied, regarding the information including, but not limited to, warranties of content, accuracy and reliability. Any interested party should undertake their own inquiries as to the accuracy of the information. Colliers excludes unequivocally all inferred or implied terms, conditions and warranties arising out of this document and excludes all liability for loss and damages arising there from. This publication is the copyrighted property of Colliers and /or its licensor(s). © 2026. All rights reserved. This communication is not intended to cause or induce breach of an existing listing agreement

# Aerial

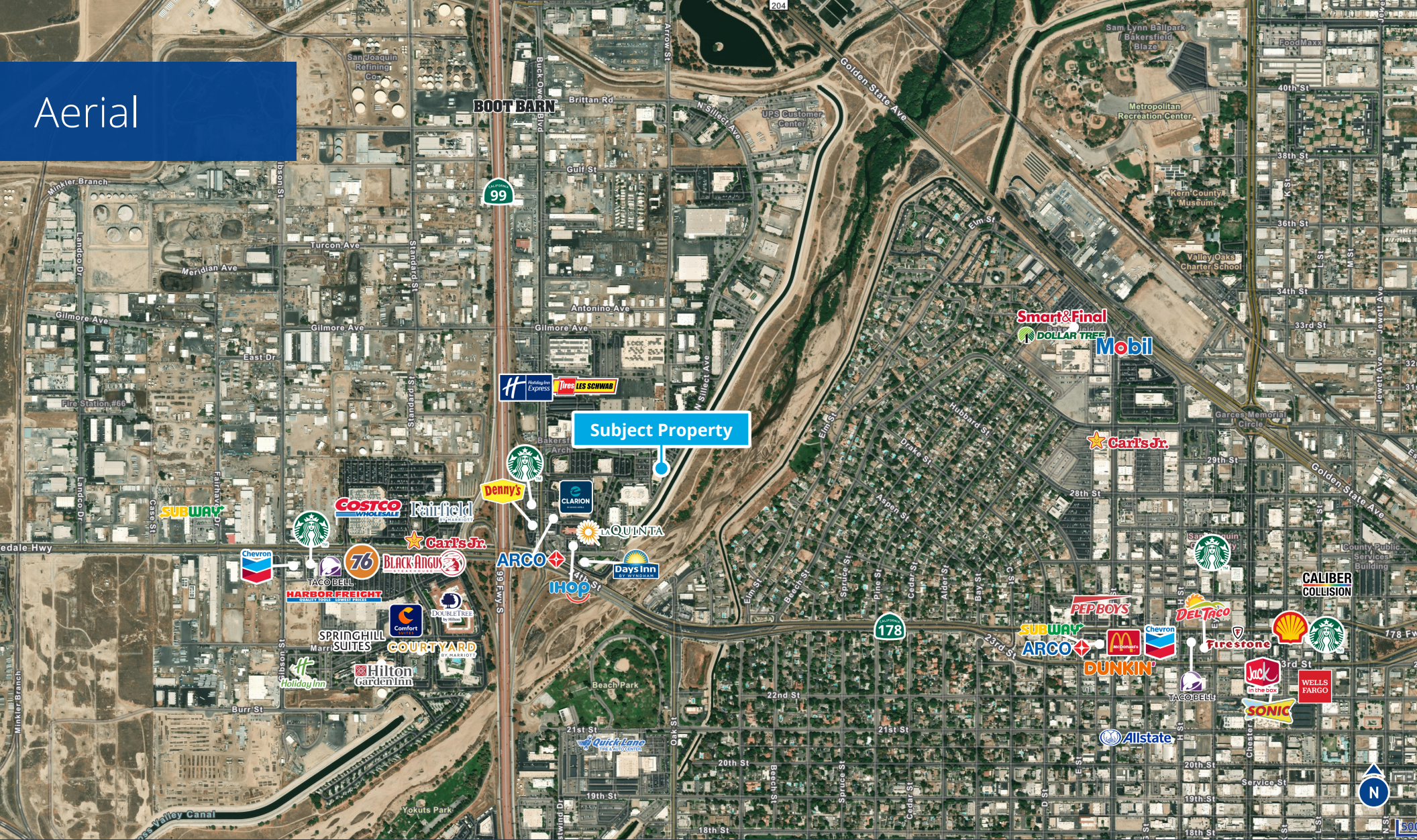

## Contact Us:

**David A. Williams, SIOR**  
Senior Vice President | Principal  
License No. 00855489  
+1 661 631 3816  
david.a.williams@colliers.com

**Jason Alexander**  
Senior Vice President | Principal  
License No. 01360995  
+1 661 631 3818  
jason.alexander@colliers.com

**Colliers International**  
10000 Stockdale Hwy, Suite 102  
Bakersfield, CA 93311  
+1 661 631 3800  
www.colliers.com/bakersfield