

For Lease

Maple Lewis Business Center 1,760 Square Feet

350 Maple Street, Unit D, Corona, CA



Property Details

- ±350 sf Office Space
- Pomona Street Frontage
- High Identity Building Signage
- 2:1 Parking Ratio
- 1 Ground Level Door
- 14' Warehouse Height
- 100 Amps Electrical Service
- Well Maintained Business Park
- Immediate Access to Riverside (91) Freeway

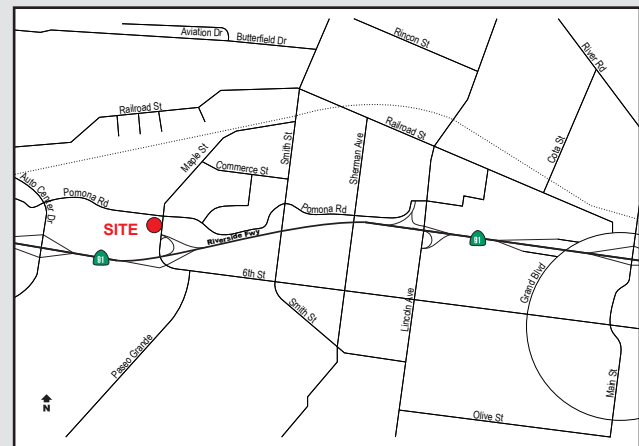

Reed Rutter
ASSOCIATE
949.933.5744
RRutter@voitco.com
Lic. #02153762

Michael Zehner
SENIOR VICE PRESIDENT
714.935.2328
mczehner@voitco.com
Lic. # 01917963

Voit
REAL ESTATE SERVICES

2020 Main Street, Suite 100 | Irvine, California 92614 | 949.851.5100 | 949.261.9092 Fax | Lic #01991785 | www.VoitCo.com

For Lease

Maple Lewis Business Center 1,760 Square Feet

350 Maple Street, Unit D, Corona, CA

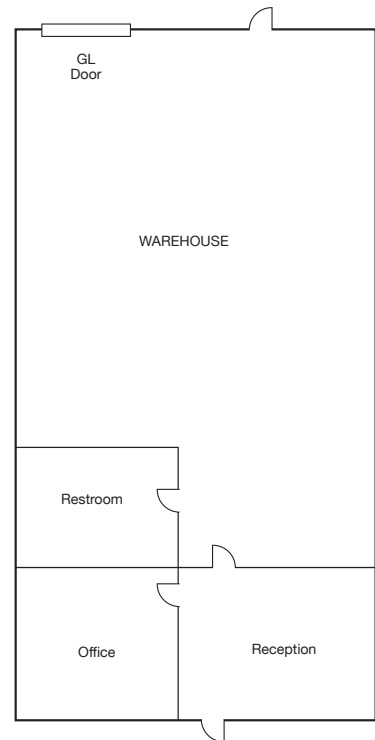
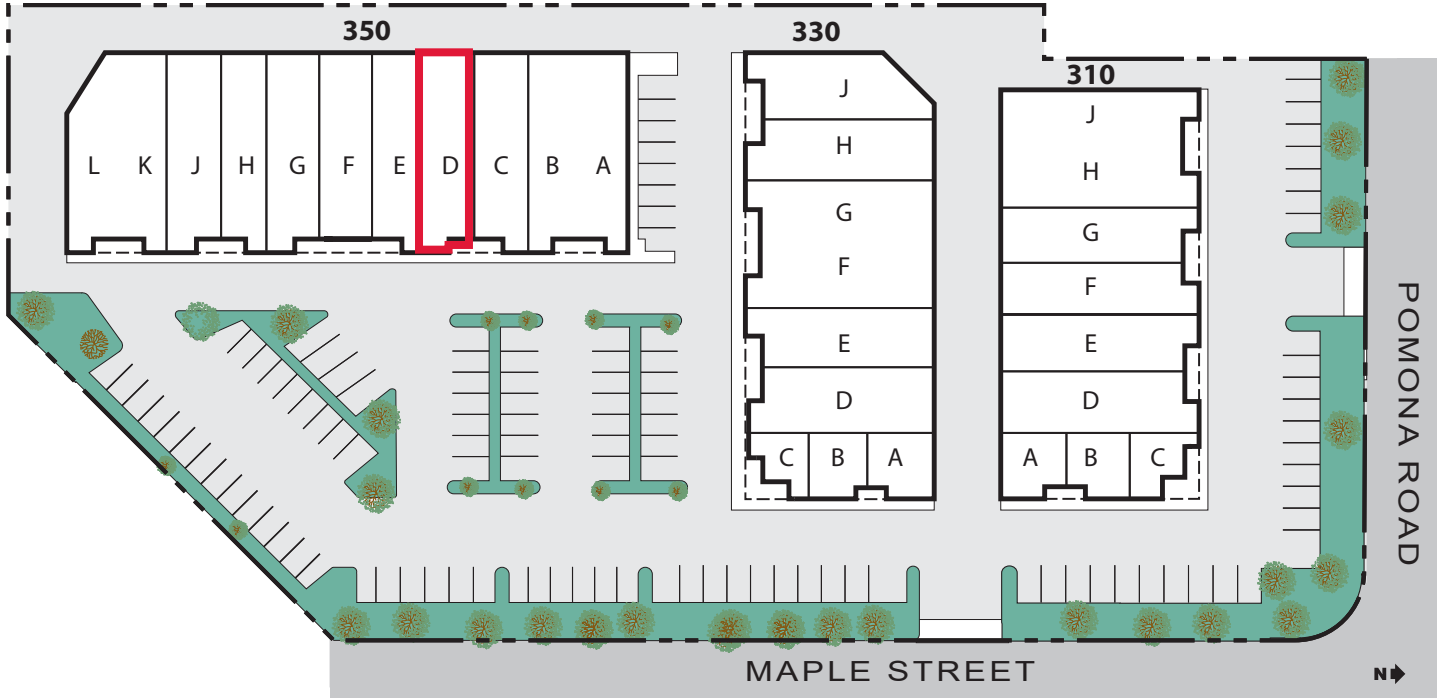

Reed Rutter
ASSOCIATE
949.933.5744
RRutter@voitco.com
Lic. #02153762

Michael Zehner
SENIOR VICE PRESIDENT
714.935.2328
mczehner@voitco.com
Lic. # 01917963

Voit
REAL ESTATE SERVICES

2020 Main Street, Suite 100 | Irvine, California 92614 | 949.851.5100 | 949.261.9092 Fax | Lic #01991785 | www.VoitCo.com