



**FLOOR SQUARE FOOT = 7449**

Square foot shown is based on supplied building shell and includes all columns - subject to site survey

**ACCOMMODATION SCHEDULE**

FACILITY	QTY
Reception	1
Breakout	1
Boardroom (x12)	1
Meeting Room (x8)	2
Office	5
Print Area	2
Comms Room	1
Coat Cupboard	4
Store Room	1
Open Plan	64
Hot Desks	8
Meet Points	4
<b>TOTAL HEAD COUNT</b>	<b>78</b>

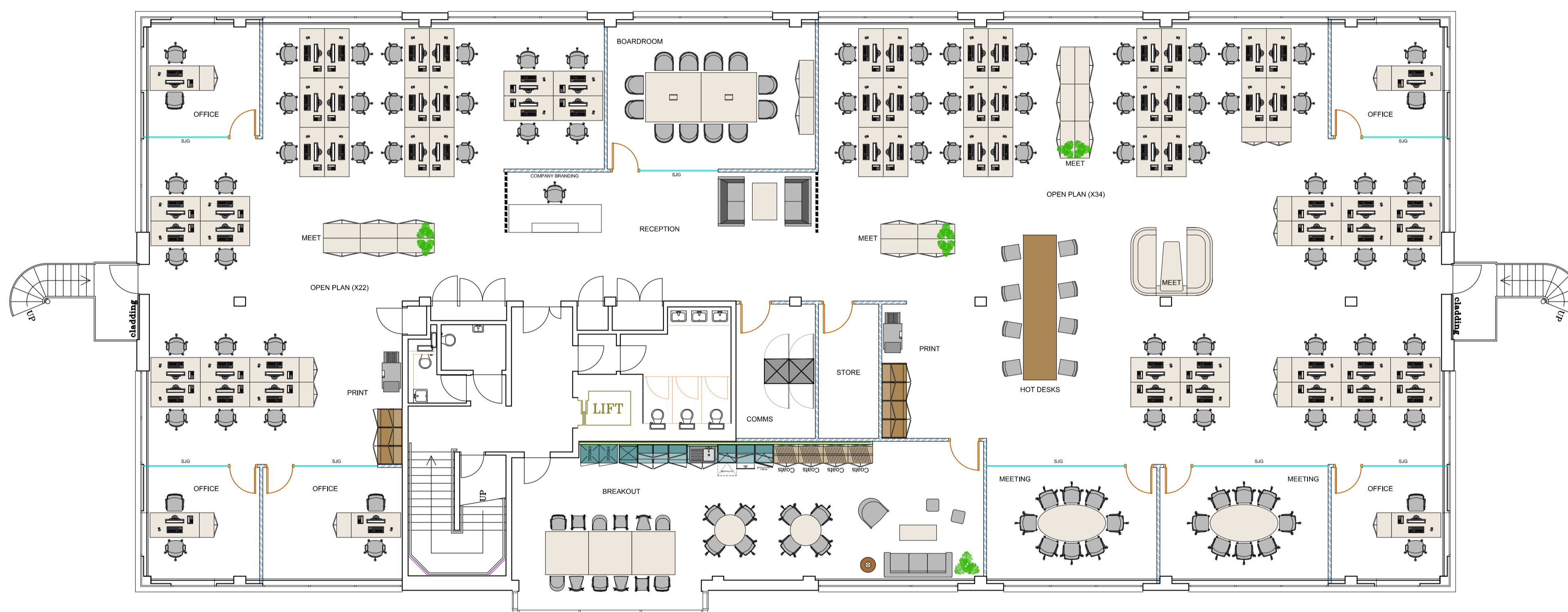

CH: 2691MM  
SH: 830MM  
WH: 1258MM  
CV: 536MM  
FV: 200MM

REV	DESCRIPTION	DATE
A	MULTIPLE LAYOUT ALTERATIONS TO SUIT CLIENT REQUIREMENTS	NW 09.12.19

## SECOND FLOOR – PROPOSED LAYOUT

AUTHORISATION  
PRINT NAME  
SIGNED \_\_\_\_\_ DATE / /

© COPYRIGHT OKTRA LTD  
THIS DRAWING REMAINS THE COPYRIGHT OF OKTRA LTD, TO BE USED SOLELY FOR THE PROJECT AND INFORMATION AS TITLED. THIS DRAWING MUST NOT BE COPIED WITHOUT PRIOR WRITTEN CONSENT. CONTRACTORS ARE RESPONSIBLE FOR ENSURING ALL WORKS COMPLY WITH ALL RELEVANT STATUTORY REQUIREMENTS AND BRITISH STANDARDS.  
DO NOT SCALE FROM DRAWING. CONTRACTORS MUST CHECK ALL DIMENSIONS, LEVELS AND SERVICES PRIOR TO COMMENCEMENT OF ANY WORKS. OKTRA LTD MUST BE NOTIFIED OF ANY DISCREPANCIES.  
V:\PROJECTS\JUNE 2019 TO MAY 2020 PROJECT FILES\BOULTBEE BROOKS - BRISTOL 106311 - DESIGN00 - CAD FILES

### PRELIMINARY

CLIENT  
**BOULTBEE BROOKS**

SITE ADDRESS  
**2530 AZTEC WEST, BRISTOL, BS32 4GQ**

CLIENT CONTACT ~	ACCOUNT MANAGER <b>MIKE MURRAY</b>
PROJECT DESIGNER <b>NATHAN WATSON</b>	TECHNICAL DESIGNER <b>DAVID HOLLIS</b>

DRAWING TITLE  
**SECOND FLOOR SPACE PLAN/TEST FIT**

PROJECT NO.	SCALE	STATUS	REVISION
1063	1:100@A1	PR	A

DRAWING NO.  
**1063 — 2530 — 02 — PRGA — A**

Friary Court  
13-21 High Street  
Guildford, GU1 3DG  
020 7553 9500  
oktra.co.uk