

FOR LEASE • DDG-122N Building

WILLOW AVENUE INDUSTRIAL PARK • 3816 S. Willow Avenue, Suites 102-103, Fresno, CA



Marcus Pignotti

(559) 225-6363
Extension 8

OFFICE:

7519 N. Ingram Avenue, Suite 104
Fresno, California 93711



DDG-72

LEASED
33,600 SF

AVAILABLE
28,000 SF

AVAILABLE
17,300 SF

LEASED
42,900 SF

WILLOW AVE

Landsberg
ORCA

WILLOW AVE INDUSTRIAL PARK

DDG-122S



Marcus Pignotti

(559) 225-6363
Extension 8

OFFICE:

7519 N. Ingram Avenue, Suite 104
Fresno, California 93711

WILLOW AVENUE INDUSTRIAL PARK • 122N

3816 S. Willow Avenue, Suites 102-103, Fresno CA • 121,800 SF

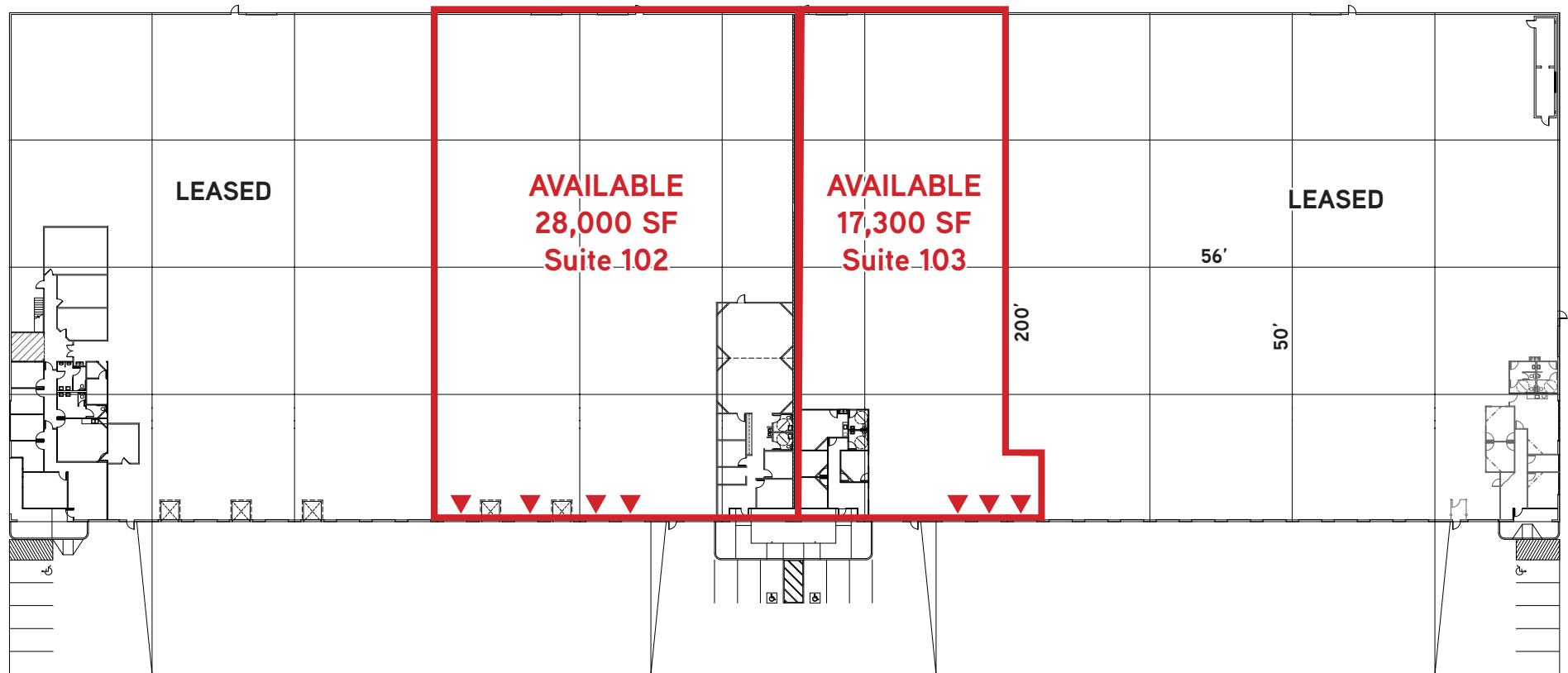

EXISTING OFFICE FLOOR PLANS

3816 S. Willow Avenue, Suites 102-103, Fresno CA • 121,800 SF

SUITE 102

SUITE 103

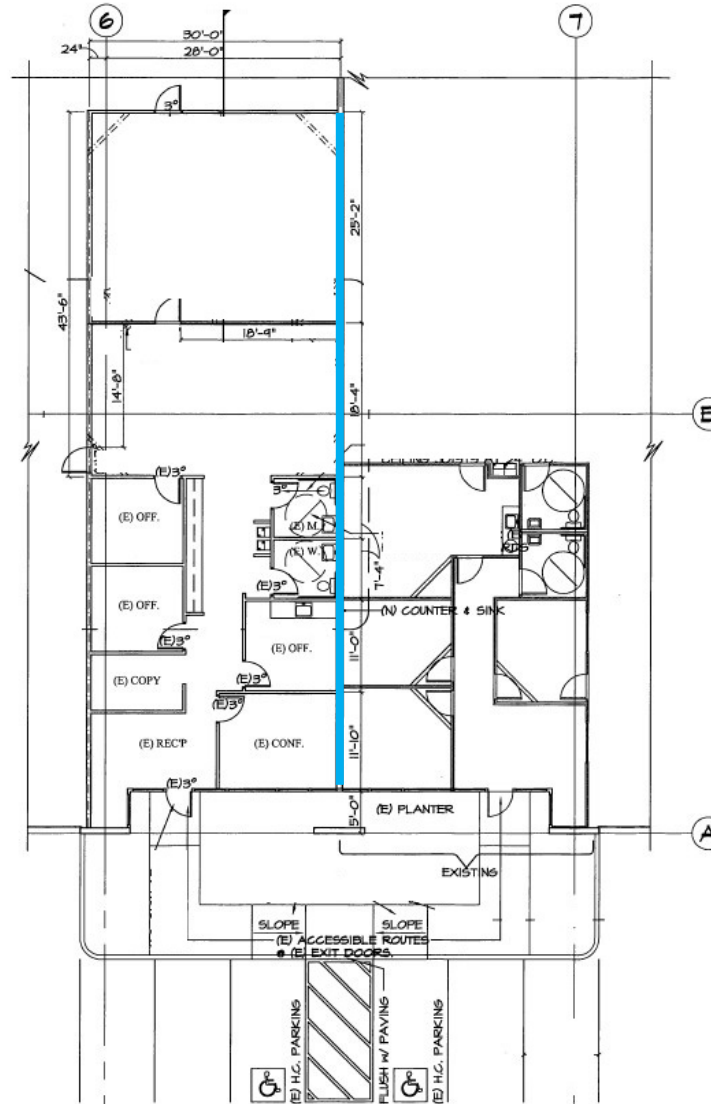

DDG - 122N BUILDING, #102

Specifications

BUILDING SIZE:	±121,800 SF	TRUCK DOORS:	Six (6) 9' x 10' dock high doors and Two (2) 12' x 14' grade level door
AVAILABLE:	±28,000 SF (±45,300 SF combined with Suite 103)	DOCK EQUIPMENT:	Two dock levelers and edge of dock plates
BUILDING DIMENSIONS:	140' x 200'	FIRE SYSTEM:	ESFR Fire Sprinkler System
BAY SIZE:	56' x 200' = 11,200 SF	WAREHOUSE LIGHTING:	T-5 Fixtures
COLUMN SPACING:	56' x 50'	OFFICE:	Approximately 2,430 SF
CONCRETE SLAB:	6" laser screed	ADDRESS:	3816 S. Willow Avenue Suite 102 Fresno, California 93728
CLEAR HEIGHT:	30' Minimum Clear Height		
ROOF CONSTRUCTION:	Panelized Wood System		
ROOFING:	4-ply built up system		
SKYLIGHTS:	4' x 8' -- 4 per bay		
TRUCK COURT:	60' wide, reinforced 6" concrete dock apron, ±1% slope. 216' between buildings		

DDG - 122N BUILDING, #103

Specifications

BUILDING SIZE:	±121,800 SF	TRUCK DOORS:	Three (3) 9' x 10' dock high doors and Two (2) 12' x 14' grade level door
AVAILABLE:	±17,300 SF (±45,300 SF combined with Suite 102)	DOCK EQUIPMENT:	Two dock levelers
BUILDING DIMENSIONS:	84' x 200'	FIRE SYSTEM:	ESFR Fire Sprinkler System
BAY SIZE:	56' x 200' = 11,200 SF	WAREHOUSE LIGHTING:	T-5 Fixtures
COLUMN SPACING:	56' x 50'	OFFICE:	Approximately 1,110 SF
CONCRETE SLAB:	6" laser screed	ADDRESS:	3816 S. Willow Avenue Suite 103 Fresno, California 93728
CLEAR HEIGHT:	30' Minimum Clear Height		
ROOF CONSTRUCTION:	Panelized Wood System		
ROOFING:	4-ply built up system		
SKYLIGHTS:	4' x 8' -- 4 per bay		
TRUCK COURT:	60' wide, reinforced 6" concrete dock apron, ±1% slope. 216' between buildings		

DDG-122N Building



Marcus Pignotti
(559) 225-6363
Extension 8

OFFICE:
7519 N. Ingram Avenue, Suite 104
Fresno, California 93711