

CABRILLO

BUSINESS PARK

5450 - 5490 COMPLEX STREET | SAN DIEGO, CA 92123

AVAILABLE FOR LEASE
MULTI-TENANT INDUSTRIAL / FLEX SUITE

H.G. FENTON COMPANY

CBRE
CUSHMAN &
WAKEFIELD

PROJECT HIGHLIGHTS

- + Approximately 109,661 SF (6) building multi-tenant flex / industrial park
- + High image office / industrial suites with flexible suite options
- + Approximately 14' clear height
- + 2.46/1,000 SF parking ratio
- + Spectrum Fiber available
- + Sprinklers
- + Newly built EV charging stations
- + Immediate access to Clairemont Mesa Blvd, Highways 52 & 163, and Interstates 805 and 15



AVAILABILITY



ADDRESS	SF	AVAILABILITY	RATE	BUILD OUT
5482 Complex St, Suite 107	±2,339 SF	Immediately	\$1.85 NNN	Street frontage suite. Approximately 30% office / 70% warehouse with (1) grade level loading door.

FLOOR PLAN

5482 Complex Street
Suite 107
±2,339 SF

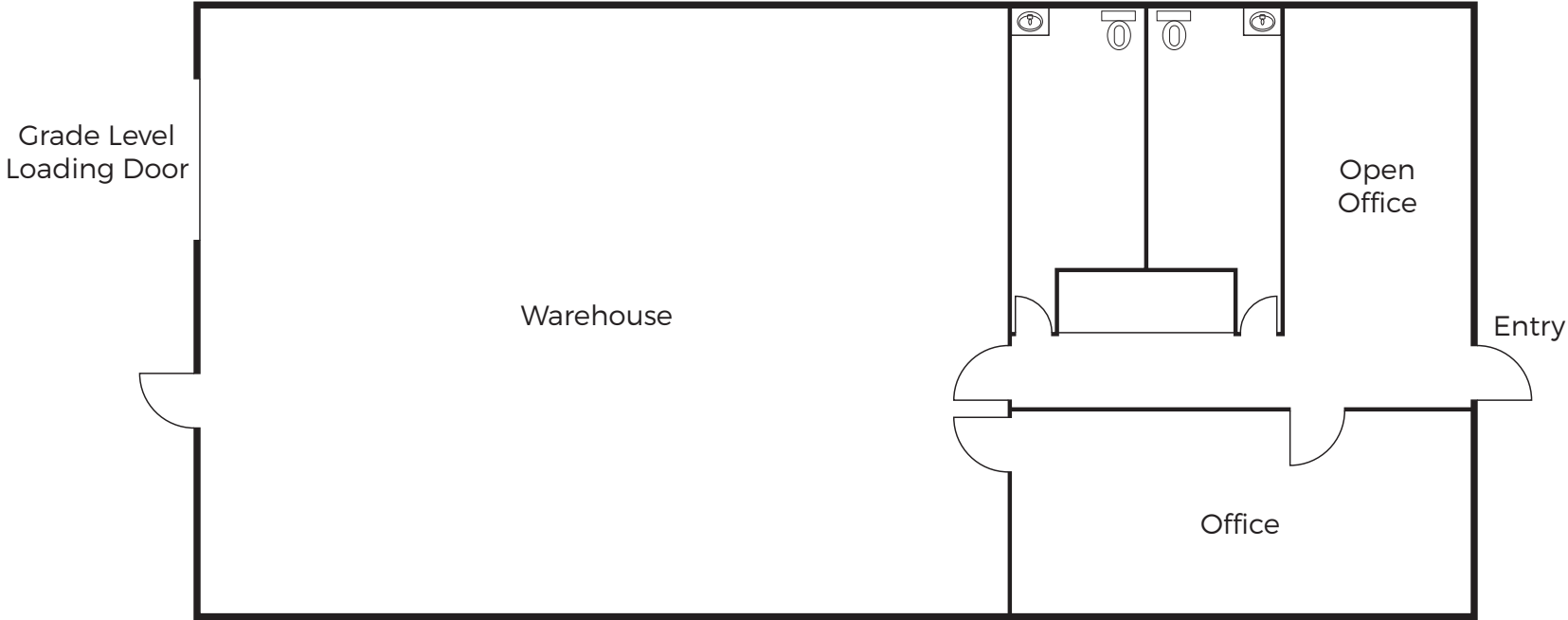

FOR MORE INFORMATION:

KYLE WRIGHT

Senior Associate

Lic. 02083245

+1 858 546 4621

kyle.wright2@cbre.com

RYAN DOWNING, SIOR

Director

Lic. 01955032

+1 858 546 5416

ryan.downing@cushwake.com



© 2025 CBRE, Inc. All rights reserved. This information has been obtained from sources believed reliable, but has not been verified for accuracy or completeness. Any projections, opinions, or estimates are subject to uncertainty. The information may not represent the current or future performance of the property. You and your advisors should conduct a careful, independent investigation of the property and verify all information. Any reliance on this information is solely at your own risk. Photos herein are the property of their respective owners and use of these images without the express written consent of the owner is prohibited.