

MILLS SHOPPING CENTER
10379 FOLSOM BLVD
RANCHO CORDOVA, CA
FOR LEASE
24,967 SF ANCHOR SPACE

ETHAN CONRAD
PROPERTIES, INC.

NOW OPEN!
DOLLAR TREE
KIDS EMPIRE

AMERICAN FREIGHT
APPLIANCE • FURNITURE • MATTRESS

NOW REMODELED

VIEW VIRTUAL TOUR

FOR MORE INFORMATION CONTACT:

Race Merritt
DRE: #01700659
race@ethanconradprop.com

Joey Chiurazzi
DRE: #02123466
joey@ethanconradprop.com

916.779.1000

FEATURES:

- Prime Anchor space - former American Freight
- Prominent exposure on Folsom Blvd with over 1,500 feet of frontage
- Excellent access to Hwy 50 at Mather Field Rd
- Monument signage available
- Abundant parking
- Strong daytime and residential population
- Excellent demographics and traffic counts

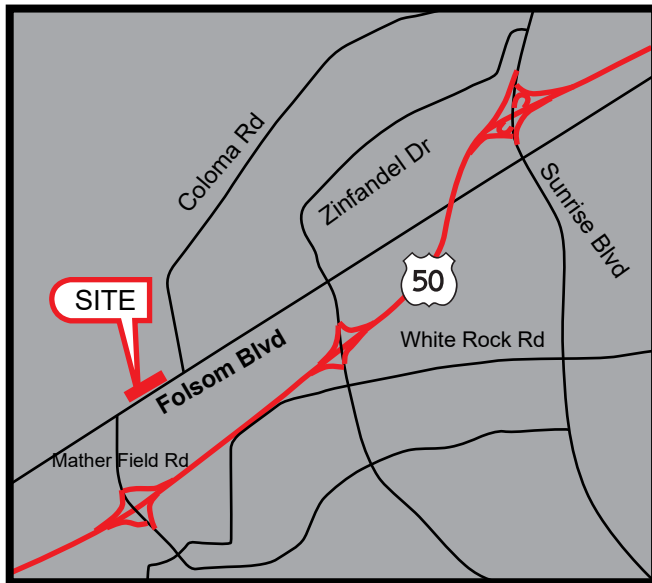

PROPERTY DETAILS:

Mills Shopping Center is a ±239,000 SF neighborhood center in Rancho Cordova directly off Hwy 50 at Mather Field Rd. Located within the well-traveled Folsom Blvd corridor.

The property offers value-oriented shoppers a synergistic destination where grocery shopping is combined with discount soft goods, popular fast food and essential neighborhood services.

Anchored by several national tenants including: Planet Fitness, DollarTree, Kids Empire, and DD’s Discount. Other notable tenants such as: Viva Supermarket, Starbucks, McDonald’s, and Carl’s Jr.

LEASE RATE:

24,967 SF \$24,717.00 (\$0.99 PSF, NNN)

NNN costs are approximately \$0.28 PSF.

DEMOGRAPHICS:

	1 Mile	3 Mile	5 Mile
2025 Total Population (est):	25,326	100,482	244,937
2025 Average HH Income:	\$93,991	\$119,345	\$134,062
Traffic Count @ Folsom Blvd:	7,982		
Coloma Rd:	7,578		

ETHAN CONRAD PROPERTIES, INC.

1300 NATIONAL DRIVE, SUITE 100 | SACRAMENTO CA, 95834 | 916.779.1000

www.ethanconradprop.com

The information contained herein has been obtained from sources we believe to be reliable. However, we cannot guarantee, warrant or represent its accuracy and all information is subject to error, change or withdrawal. An interested party and their advisors should conduct an independent investigation of the property to determine to your satisfaction the suitability of the property for your needs.

FOR LEASE

MILLS SHOPPING CENTER | ANCHOR

10379 FOLSOM BLVD
RANCHO CORDOVA, CA

SITE PLAN

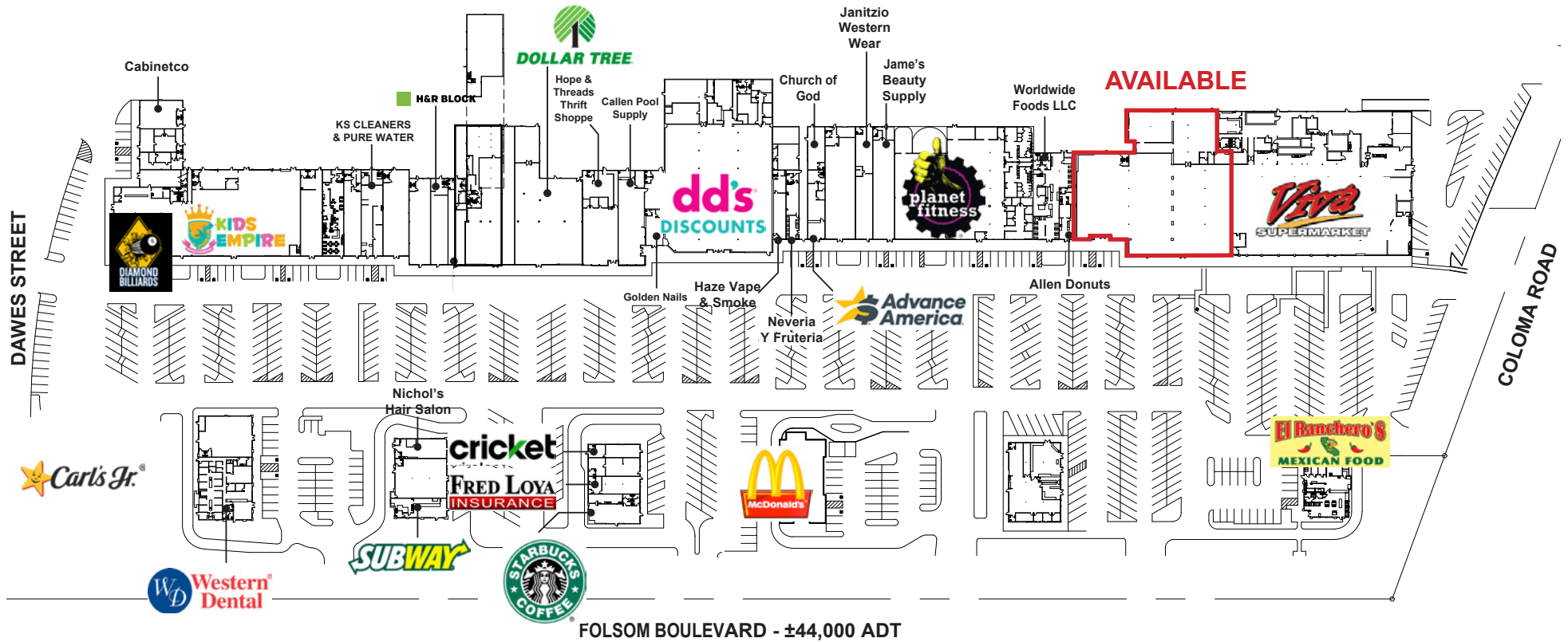

ETHAN CONRAD PROPERTIES, INC.

1300 NATIONAL DRIVE, SUITE 100 | SACRAMENTO CA, 95834 | 916.779.1000

www.ethanconradprop.com

The information contained herein has been obtained from sources we believe to be reliable. However, we cannot guarantee, warrant or represent its accuracy and all information is subject to error, change or withdrawal. An interested party and their advisors should conduct an independent investigation of the property to determine to your satisfaction the suitability of the property for your needs.

FLOOR PLAN

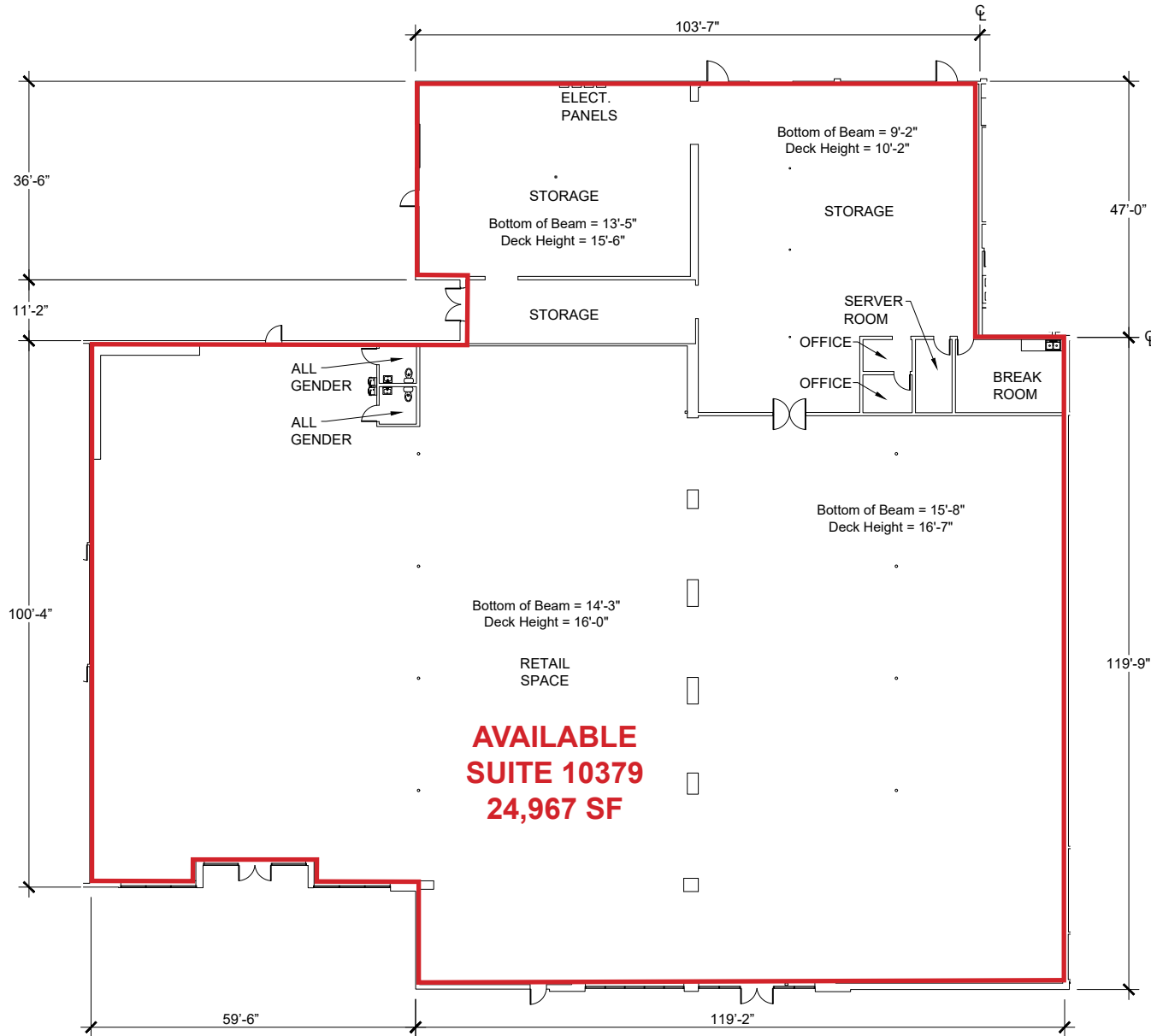

[VIEW VIRTUAL TOUR](#)

FOR LEASE

MILLS SHOPPING CENTER | ANCHOR
10379 FOLSOM BLVD
RANCHO CORDOVA, CA



ETHAN CONRAD PROPERTIES, INC.

1300 NATIONAL DRIVE, SUITE 100 | SACRAMENTO CA, 95834 | 916.779.1000

www.ethanconradprop.com

The information contained herein has been obtained from sources we believe to be reliable. However, we cannot guarantee, warrant or represent its accuracy and all information is subject to error, change or withdrawal. An interested party and their advisors should conduct an independent investigation of the property to determine to your satisfaction the suitability of the property for your needs.



ETHAN CONRAD PROPERTIES, INC.

1300 NATIONAL DRIVE, SUITE 100 | SACRAMENTO CA, 95834 | 916.779.1000

www.ethanconradprop.com

The information contained herein has been obtained from sources we believe to be reliable. However, we cannot guarantee, warrant or represent its accuracy and all information is subject to error, change or withdrawal. An interested party and their advisors should conduct an independent investigation of the property to determine to your satisfaction the suitability of the property for your needs.