

# 1024 FIRST AVENUE

NE CORNER OF EAST 56TH STREET | SUTTON PLACE



AKSR  
RETAIL FOR  
LEASE

RETAIL FOR LEASE

AKSR  
RETAIL  
FOR  
LEASE

400

PARK

# 1024 FIRST AVENUE

NE CORNER OF EAST 56TH STREET | SUTTON PLACE

## PROPERTY DETAILS

SIZE: 750 SF Ground Floor  
200 SF Basement

FRONTAGE: 40' wraparound

POSSESSION: Immediate

ASKING RENT: Upon Request

TRANSPORTATION: 

## HIGHLIGHTS

- Highly visible corner location with strong First Avenue frontage
- Former convenience store with existing infrastructure in place for food (non-vented), retail, or service use
- Located at the base of Stonehenge 57, a luxury rental building with over 260 apartments, plus heavy foot traffic from surrounding high-rises
- First Avenue sees consistent daily traffic from residents, students, professionals

2nd Avenue

Greenport Cafe



Under The Bridge

Suzu

Go Noodle

Fusha Asian Cuisine

urbangreen

E. 58th Street



American First Liquors



M 57 M 15

E. 57th Street

M 57

NY Jumbo Bagels

CHASE



The Shadmoor



bluemercury



Stonehenge 57

Sutton Cafe

aka.  
HOTEL RESIDENCES  
Manhattan Art & Antiques

Cathedral High School

E. 55th Street

LENSCRAFTERS



M&T Bank

A La Mode Shoppe

Solim Flower

Pho Saigon

verizon

CHASE



D'AGOSTINO  
New York's Original Grocer

Flirt Beauty Boutique

The Greats of Craft

Memoria

Eclair Bakery



E. 54th Street

SUBWAY

KUMON

1st Avenue

T.J. maxx

TRADER JOE'S

Sutton Bar Room

Morso

Pink Moose

Bistro Vendome

Sutton Place



Kiss My Slice Pizza

Sutton Wine Shop



bluemercury



Stonehenge 57

Sutton Cafe

aka.  
HOTEL RESIDENCES  
Manhattan Art & Antiques

Cathedral High School

E. 55th Street

LENSCRAFTERS



M&T Bank

A La Mode Shoppe

Solim Flower

Pho Saigon

verizon

CHASE



D'AGOSTINO  
New York's Original Grocer

Flirt Beauty Boutique

The Greats of Craft

Memoria

Eclair Bakery



E. 54th Street

SUBWAY

KUMON

FDR Drive

# 1024 FIRST AVENUE

NE CORNER OF EAST 56TH STREET | SUTTON PLACE

Floor Plans:  
Ground Floor - 750 SF

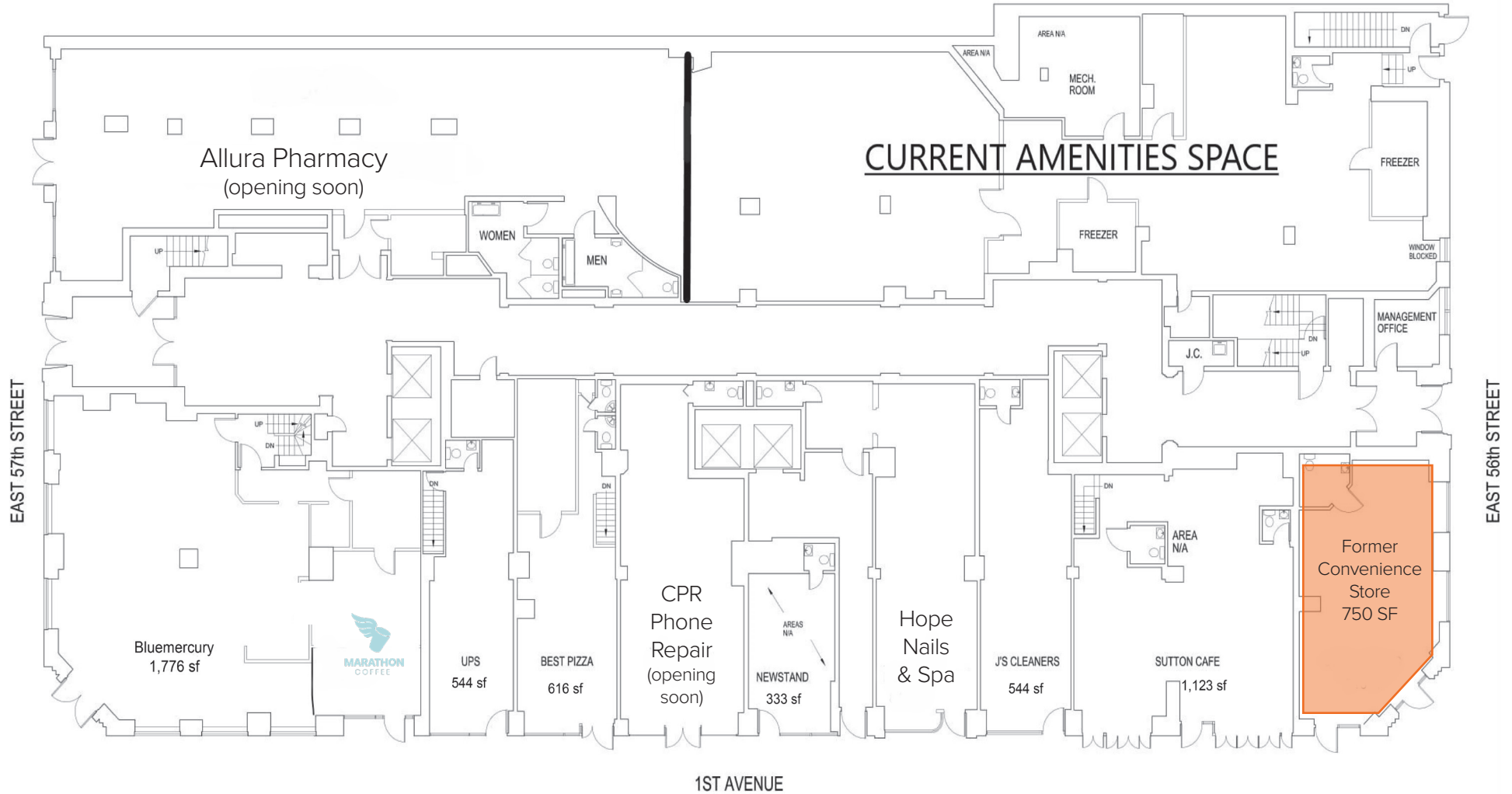

# 1024 FIRST AVENUE

NE CORNER OF EAST 56TH STREET | SUTTON PLACE

FOR MORE INFORMATION,  
PLEASE CONTACT:

**DOREL MELLOUL**

347.922.4563 | [DMelloul@ksrny.com](mailto:DMelloul@ksrny.com)

**MARC SITT**

917.757.8863 | [MSitt@ksrny.com](mailto:MSitt@ksrny.com)

