

NEARING COMPLETION!

115,476 SF | **AVAILABLE**
EXTRA LARGE YARD W/ 34 TRAILER STALLS



ALESSANDRO CORPORATE CENTER

2610 E. Alessandro Boulevard, Riverside | CA

FREEWAY FRONTAGE

Property Features

- +/- 115,427 Square Foot Warehouse on +/- 9 Acres
- I-215 Freeway Frontage with Immediate Access
- +/- 6,773 SF of 2-Story Office
- State-of-the-Art Design and Construction
- 16 Dock High Loading Doors (9'x10')
5 with 40,000 lb. Dock Levelers
- 2 Ground Level Loading Doors (14' x 16')
- ESFR Fire Sprinkler System
- 36' Warehouse Clearance at First Column
- 4,000 UGPS with 4,000 Amp Service
- Secured Truck Court with 34 Trailer Parking Stalls
- 2% Warehouse Skylights
- 70' Speed Bay w/ 60' x 56' Typical Bay Spacing
- Minimum 7" Concrete Floor Slab, MM-80 at Speed Bays
- Reduced Utility Rates via City of Riverside vs. SCE/PG&E (competing providers), Reducing Occupancy Costs

Locator Map



visit: <https://riversideca.gov/utilities>

Broker Information



Ian DeVries
License No. 01019686
949.724.5509
ian.devries@colliers.com

Chris DeVries
License No. 01867314
949.724.5504
chris.devries@colliers.com



Nicholas Chang
License No. 01344844
909.418-2014
nicholas.change@cbre.com

Richard Lee
License No. 01757870
909.418-2010
richard.lee@cbre.com

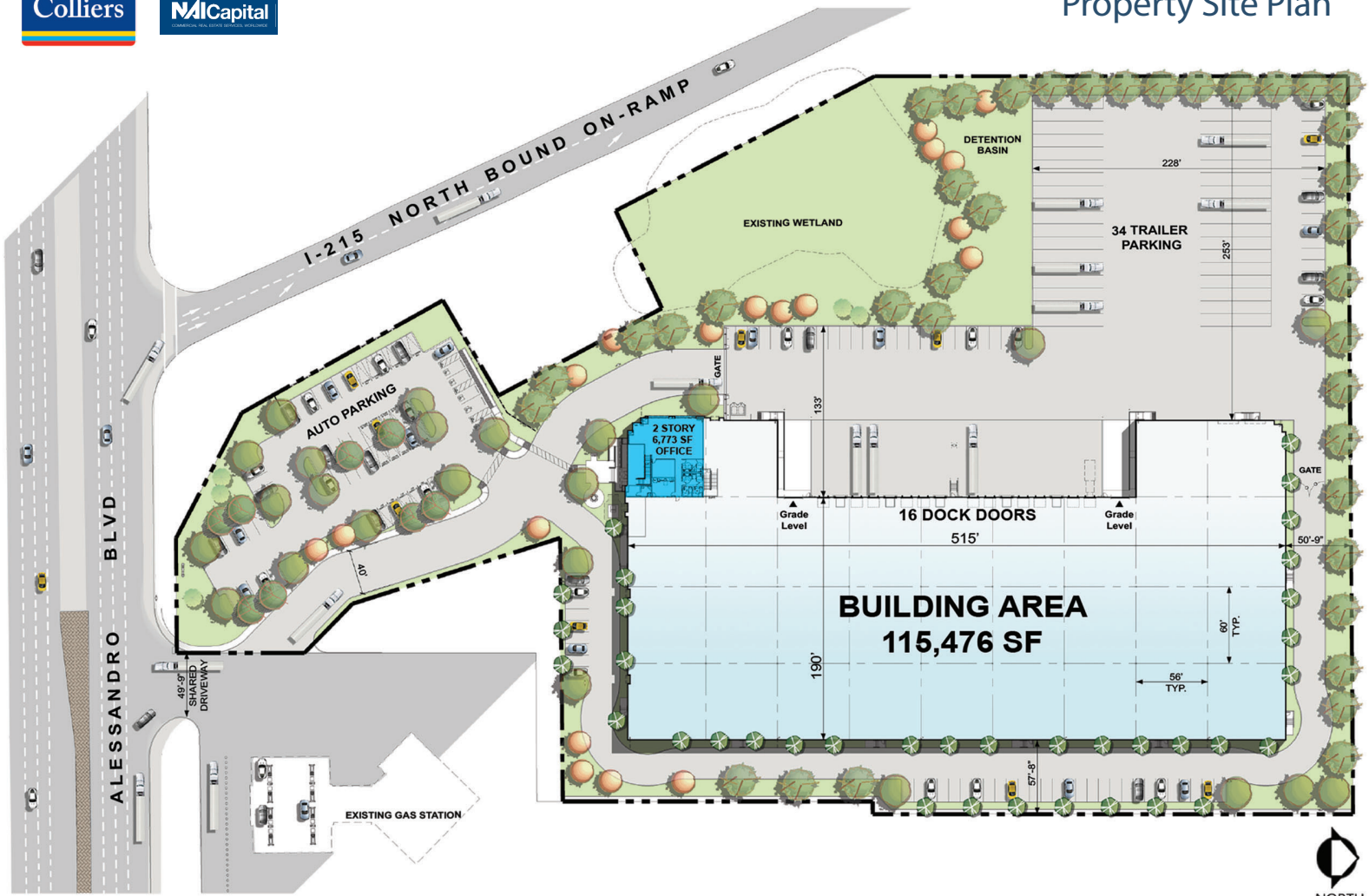

INDUSTRIAL WAREHOUSE

2610 E. Alessandro Blvd., Riverside



Office Layout

Ground Floor
+/- 3,618 SF

Second Floor
+/- 3,155 SF

+/- 6,773 Total SF

INDUSTRIAL WAREHOUSE

+/- 115,476 SF

2610 E. Alessandro Blvd., Riverside



Broker Information



Ian DeVries
License No. 01019686
949.724.5509
ian.devries@colliers.com

Chris DeVries
License No. 01867314
949.724.5504
chris.devries@colliers.com

Nicholas Chang
License No. 01344844
909.418-2014

Richard Lee
License No. 01757870
909.418-2010
richard.lee@cbre.com

nicholas.change@cbre.com

