

CENTRE COURT OFFICE SUITES FOR LEASE

43300 BUSINESS PARK DRIVE - TEMECULA, CALIFORNIA



PROPERTY HIGHLIGHTS:

- ±2,179 SF Office Suite Available For Lease
- Excellent Leasing Value
- All Suites Contain Restroom And Coffee Bar
- Detailed Architectural Treatment
- Plentiful Parking
- Well Designed And Very Functional Floor Plans
- High Quality Interior Office Improvements Rival Any Class A Office
- Lowest Modified Gross Lease Rates in Temecula



JIM NADAL, CCIM • 951.445.4520 • jnadal@leetemecula.com • DRE #01040679

CENTRE COURT OFFICE SUITES FOR LEASE

43300 BUSINESS PARK DRIVE - TEMECULA, CALIFORNIA

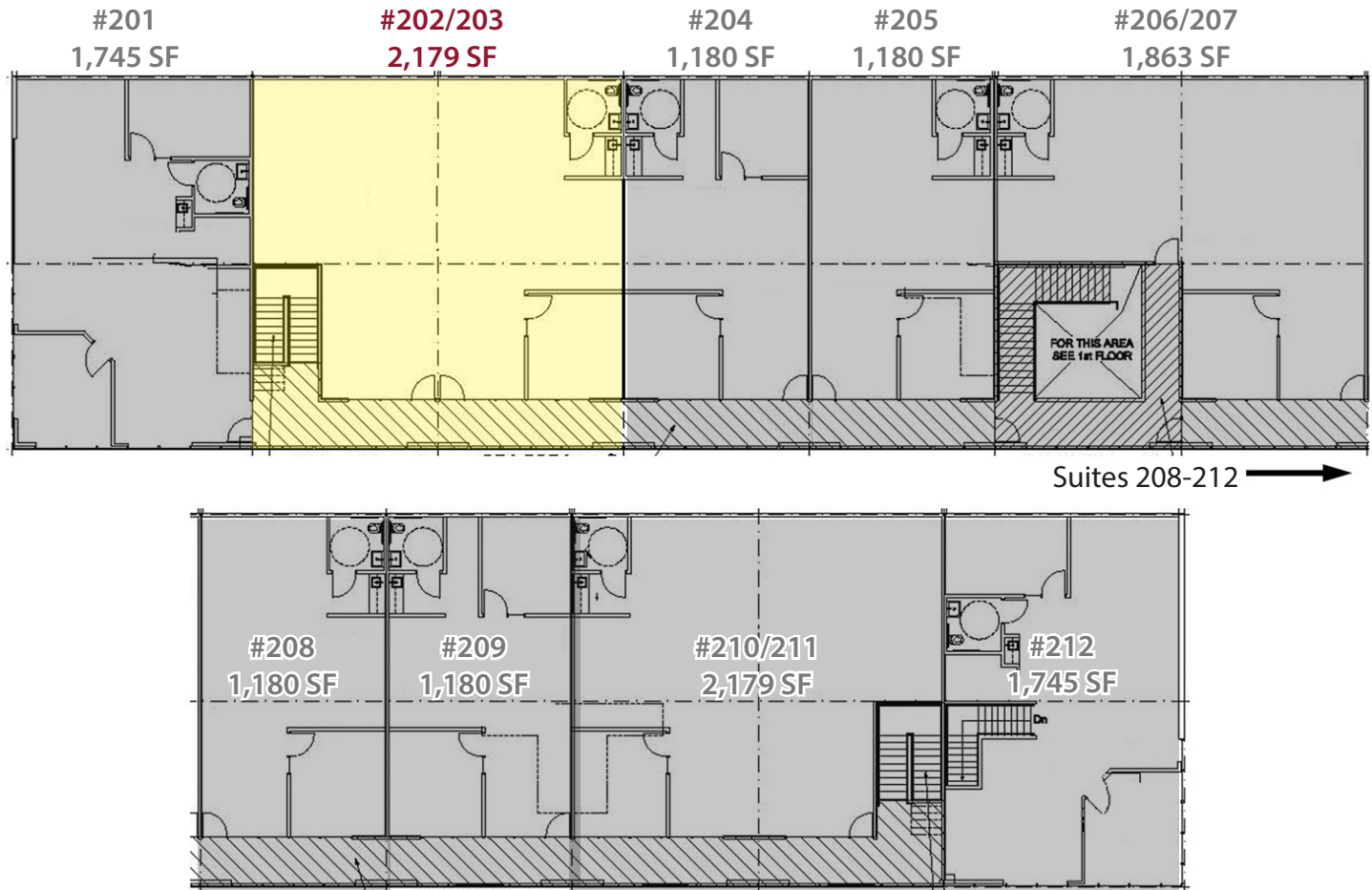

AVAILABLE FOR LEASE			
SUITE	RSF(±)	RATE PSF/MONTH	DESCRIPTION
201	±1,745	LEASED	Corner office, lots of glass. 2 private offices, open area, coffee bar, restroom.
202/203	±2,179	\$0.89 PSF*	Private office, open area, coffee bar, restroom.
204	±1,180	LEASED	2 private offices, open area, coffee bar, restroom.
205	±1,180	LEASED	1 private office, open area, coffee bar, restroom.
206/207	±1,863	LEASED	1 private office, open area, coffee bar, restroom.
208	±1,180	LEASED	1 private office, open area, coffee bar, restroom.
209	±1,180	LEASED	2 private offices, open area, coffee bar, restroom.
210/211	±2,179	LEASED	5 private offices, conference room, open area, coffee bar, restroom.
212	±1,745	LEASED	Corner office, lots of glass. 2 private offices, open area, coffee bar, restroom.
All rental rates are quoted based upon a Modified Gross Lease form. Rental rates are subject to change at the Owner's sole discretion.			Rev. 02/09/2026

*Minimum 2-Year Lease. \$1.15 PSF/Mo Year 2.

JIM NADAL, ccim • 951.445.4520 • jnadal@leetemecula.com • DRE #01040679

No warranty or representation has been made to the accuracy of the foregoing information. Terms of sale or lease and availability are subject to change or withdrawal without notice.

Lee & Associates Commercial Real Estate Services, Inc. - Riverside. 25240 Hancock Avenue, Suite 100 - Murrieta, CA 92562 | Corporate ID# 01048055

CENTRE COURT OFFICE SUITES FOR LEASE

43300 BUSINESS PARK DRIVE - TEMECULA, CALIFORNIA



JIM NADAL, ccim • 951.445.4520 • jnadal@leetemecula.com • DRE #01040679