

FOR LEASE

23,400 SF

MOTIVATED OWNERSHIP

\$0.99 GROSS

**HOT
PROMOTIONAL
RATE**



PROPERTY HIGHLIGHTS



\$0.99 GROSS PROMOTIONAL RATE
CALL BROKER



18' HIGH CLEARANCE WAREHOUSE



2,000 SF BONUS OFFICE MEZZANINE
(NOT INCLUDED IN SF)



3 GROUND LEVEL LOADING DOORS



STRATEGIC CENTRAL SFV LOCATION



SECURED AND FENCED PREMISES
LARGE REAR YARD - GREAT FOR
EXTRA STORAGE/PARKING



TRANSIT-ACCESSIBLE
W/ BUS STOP AT NORDHOFF/OSO



CLOSE PROXIMITY TO AMENITIES



800 AMPS OF 3 PHASE 120/240 POWER

8929
OSO AVENUE
CHATSWORTH, CA

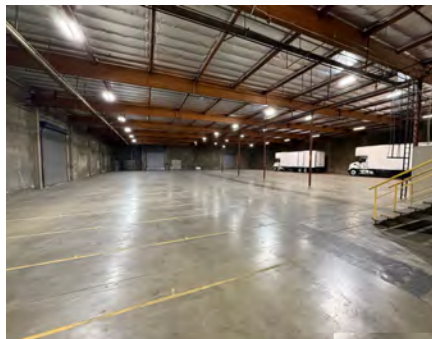

spectrumcre.com | 818.252.9900

SPECTRUM
COMMERCIAL REAL ESTATE, INC.



RON KASSAN



Executive Vice President
818.512.5001
ron@availablewarehouses.com
CA DRE Lic. #01063078

ART MINASSIAN



Senior Vice President
818.634.3722
art@availablewarehouses.com
CA DRE Lic. #02026662

No warranty, express or implied, is made as to the accuracy of the information contained herein. This information is submitted subject to errors, omission, change of price, rental or other conditions, withdrawal without notice, and is subject to any special listing conditions imposed by our principals. Cooperating brokers, buyers, tenants and other parties who receive this document should not rely on it, but should use it as a starting point of analysis, and should independently confirm the accuracy of the information contained herein through a due diligence review of the books, records, files and documents that constitute reliable sources of the information described herein. Spectrum Commercial Real Estate, Inc. CA DRE #02042805

8929

OSO AVENUE

CHATSWORTH, CA

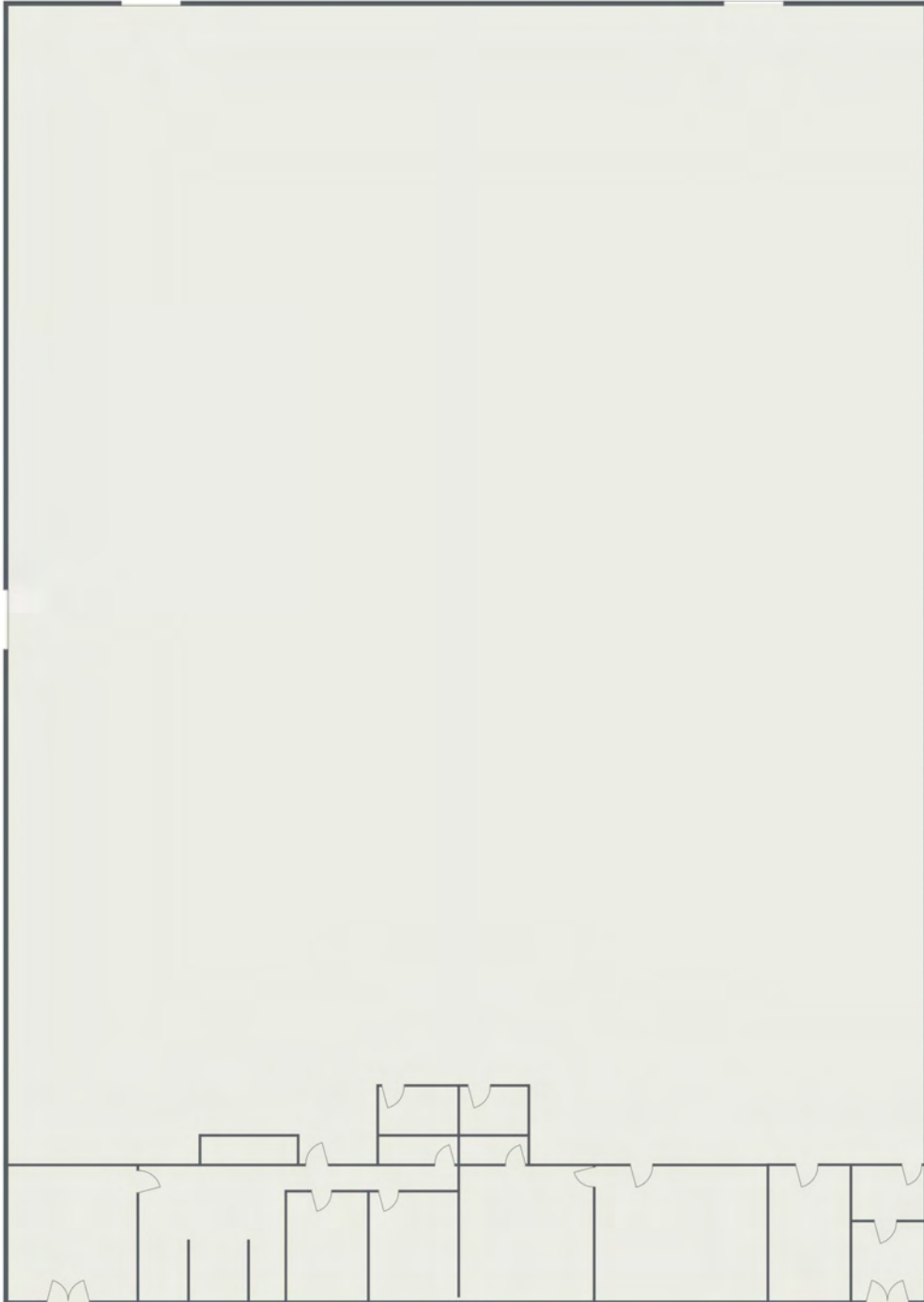

spectrumcre.com | 818.252.9900

SPECTRUM
COMMERCIAL REAL ESTATE, INC.



RON KASSAN

Executive Vice President
818.512.5001
ron@availablewarehouses.com
CA DRE Lic. #01063078



ART MINASSIAN

Senior Vice President
818.634.3722
art@availablewarehouses.com
CA DRE Lic. #02026662



No warranty, express or implied, is made as to the accuracy of the information contained herein. This information is submitted subject to errors, omission, change of price, rental or other conditions, withdrawal without notice, and is subject to any special listing conditions imposed by our principals. Cooperating brokers, buyers, tenants and other parties who receive this document should not rely on it, but should use it as a starting point of analysis, and should independently confirm the accuracy of the information contained herein through a due diligence review of the books, records, files and documents that constitute reliable sources of the information described herein. Spectrum Commercial Real Estate, Inc. CA DRE #02042805