

FOR LEASE

## COUNTRY CLUB VILLAGE

SWC MONTEREY AVENUE AND COUNTRY CLUB | RANCHO MIRAGE, CA



### PROPERTY FEATURES

- 1,480 SF pad suite fronting Country Club
- Join Albertsons, Starbucks, Subway and more in this successful neighborhood center
- Great access from Country Club Drive and Monterey Ave
- Perfectly positioned to serve Palm Desert & Rancho Mirage residents
- ADT over 62,500

### 2025 DEMOGRAPHICS

	1 MILES	3 MILES	5 MILES
Population	9,590	52,712	111,613
Average Households	5,118	26,092	55,954
Avg. HH Income	\$138,031	\$142,261	\$146,507

**Maggie Montez**  
mmontez@leedesert.com  
760.346.2520  
LIC #01070683

**Shawna Strange**  
sstrange@leedesert.com  
760.346.2533  
LIC #01718495

73000 Highway 111, Suite 200 | Palm Desert, CA 92260 | [www.LeePalmDesert.com](http://www.LeePalmDesert.com) | Corp ID # 01911964

FOR LEASE

# COUNTRY CLUB VILLAGE

SWC MONTEREY AVENUE AND COUNTRY CLUB | RANCHO MIRAGE, CA



73000 Highway 111, Suite 200 | Palm Desert, CA 92260 | [www.LeePalmDesert.com](http://www.LeePalmDesert.com) | Corp ID # 01911964

All information furnished regarding property for sale, rental or financing is from sources deemed reliable, but no warranty or representation is made to the accuracy thereof and same is submitted subject to errors, omissions, change of price, rental or other conditions prior to sale, lease or financing or withdrawal without notice. No liability of any kind is to be imposed on the broker herein.

FOR LEASE

# COUNTRY CLUB VILLAGE

SWC MONTEREY AVENUE AND COUNTRY CLUB | RANCHO MIRAGE, CA

**SUITE F2 - 1,480 SF Total, \$3.00 NNN**

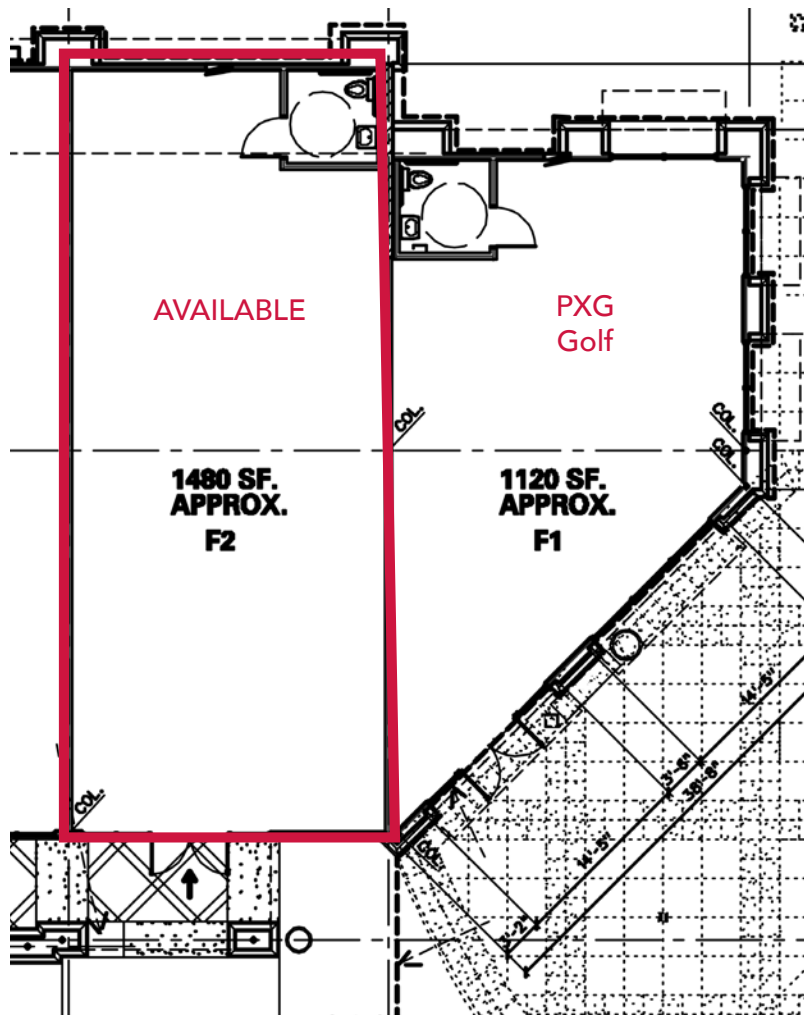

Suite F2 - 1,480 SF Total