



GULF LANDING LOGISTICS CENTER

GULF LOGISTICS DRIVE | FORT MYERS, FL 33913



[Click to View Property Video](#)

[Click to View Property Website](#)

PROPERTY FEATURES:

- Superior Access to I-75 N and S, Perfect for e-Commerce and Bulk Distribution
- Minutes from Restaurants, Shops, Hotels and Other Top Amenities
- Fastest-Growing Industrial Corridor in Southwest Florida
- 2.2+ Million total SF available
- 13 Buildings Ranging from 30,000 SF to 447,000 SF
- Phase 2 Construction to Begin Soon!
- Build to Suit Opportunities Available

DEMOGRAPHICS:	Population	Total Daytime Population	Avg Household \$	Med Household \$
100 Miles	4,470,688	2,174,963	\$121,694	\$85,253

PHASE 1 - SHALLOW-BAY BUILDING (1, 3, & 5) SPECIFICATIONS:

Building Number	Size (SF)	Clear Height	Building Depth	Dock Doors 9' x 10'	Drive-Ins 12' x 14'	Parking	Trailer Parking	Loading	Truck Court Depth
1	91,630	24'	120'	46	2	149	-	Rear Load	120'
3	58,579	24'	140'	25	2	100	-	Rear Load	150' Shared
5	80,713	24'	140'	34	2	123	-	Rear Load	150' Shared

DEVELOPED BY:



LEASING CONTACTS:



Bob Johnston, SIOR
Principal
239.210.7601
bjohnston@lee-associates.com

Jerry Messonnier, SIOR
Principal
239.210.7610
jmessonnier@lee-associates.com



GULF LANDING LOGISTICS CENTER

GULF LOGISTICS DRIVE | FORT MYERS, FL 33913



- Shallow-Bay Buildings
- Grade-Level Buildings
- Big-Box Buildings
- Phase 2



GULF LANDING LOGISTICS CENTER

9978 GULF LOGISTICS DRIVE | FORT MYERS, FL 33913

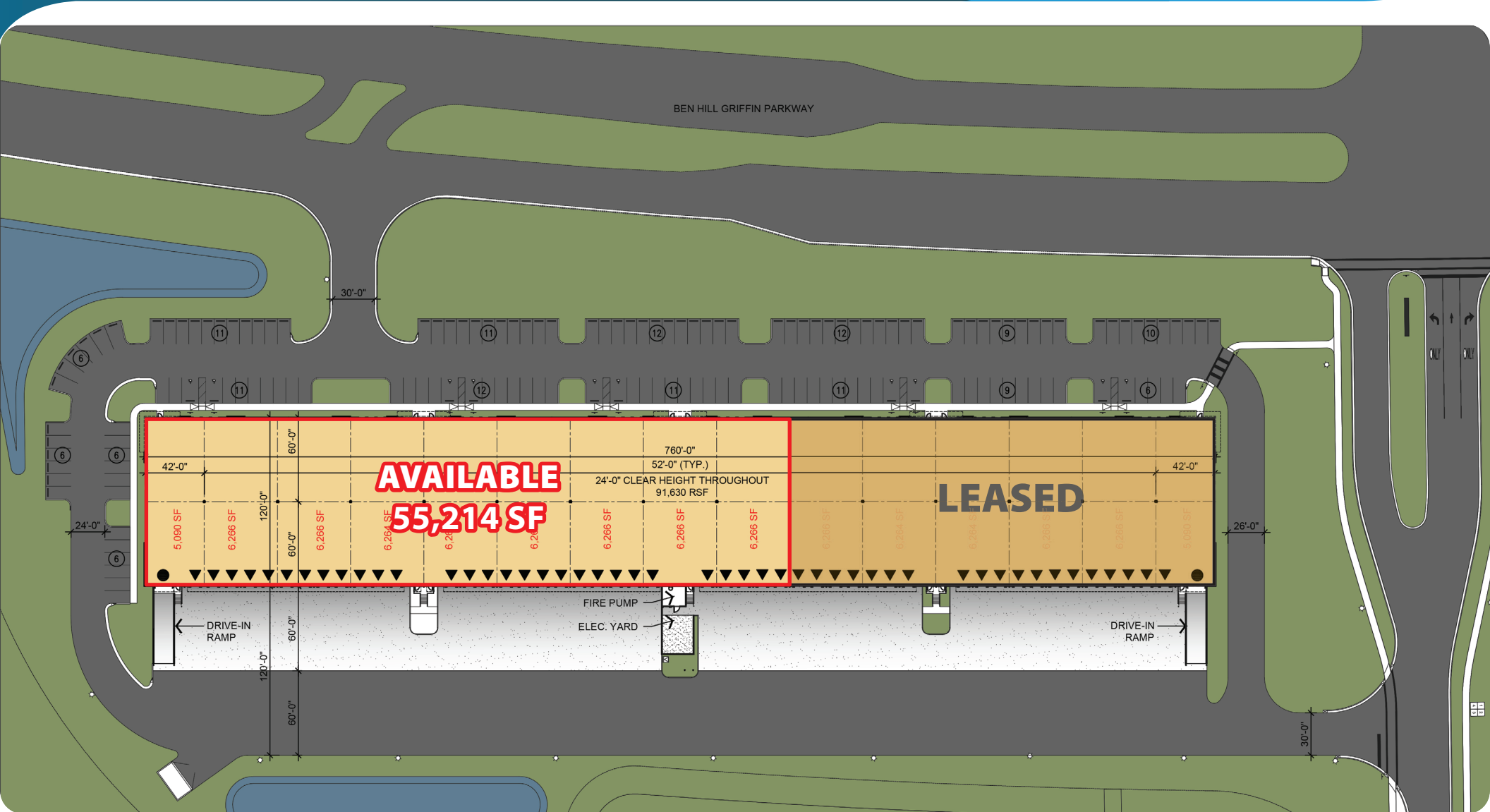

BUILDING 1

- ▲ 9'-0" X 10'-0" OVERHEAD DOCK DOOR (48 TOTAL)
- 12'-0" X 14'-0" OVERHEAD DRIVE-IN DOOR (2 TOTAL)



GULF LANDING LOGISTICS CENTER

9975 GULF LOGISTICS DRIVE | FORT MYERS, FL 33913

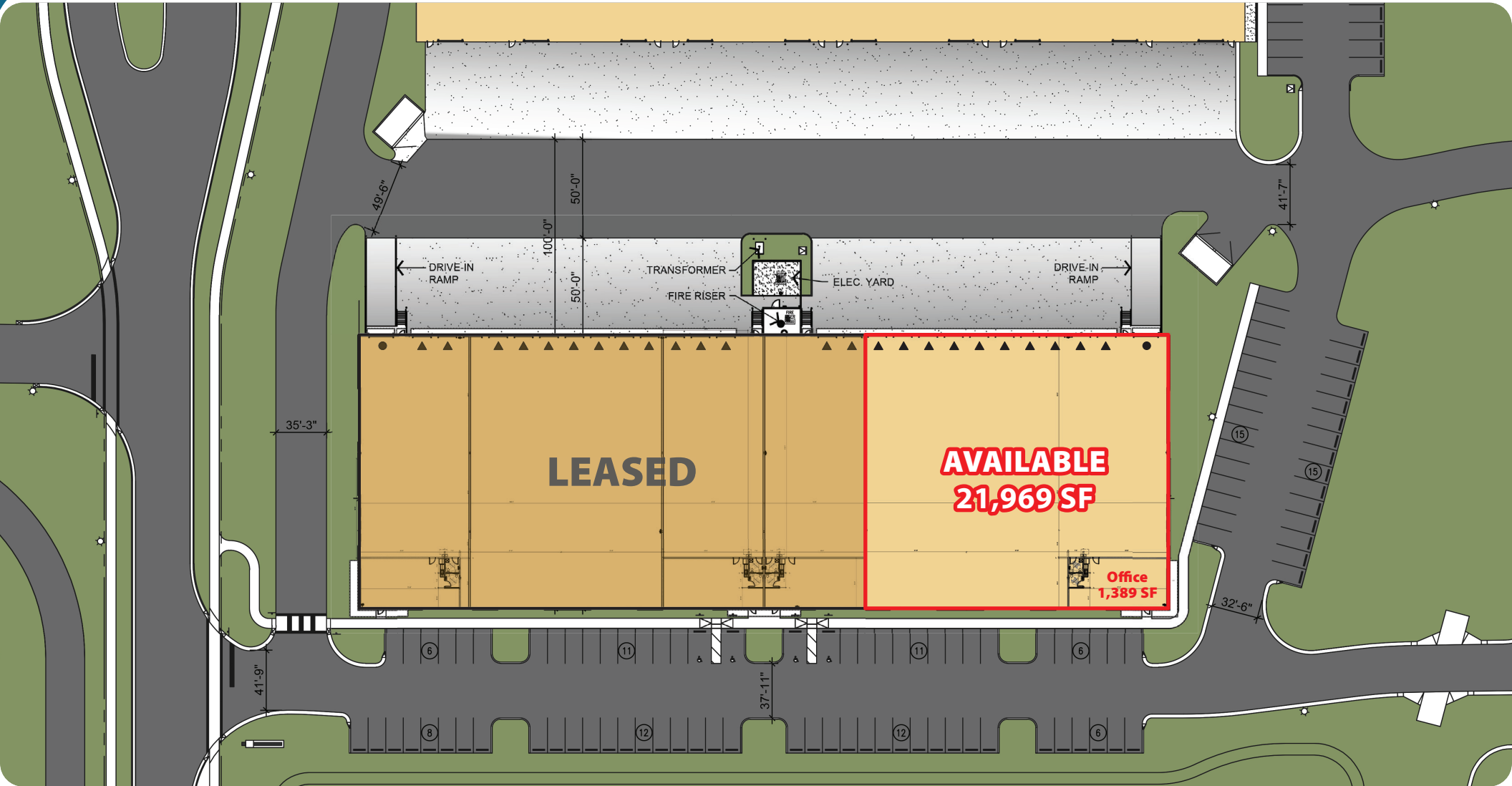

BUILDING 3

- ▲ 9'-0" X 10'-0" OVERHEAD DOCK DOOR (25 TOTAL)
- 12'-0" X 14'-0" OVERHEAD DRIVE-IN DOOR (2 TOTAL)

YOUR LOCAL MARKET **EXPERT**

9979 Gulf Logistics Drive, Suite 210 | Fort Myers, Florida 33913 | Lee-FL.com



GULF LANDING LOGISTICS CENTER

9975 GULF LOGISTICS DRIVE | FORT MYERS, FL 33913

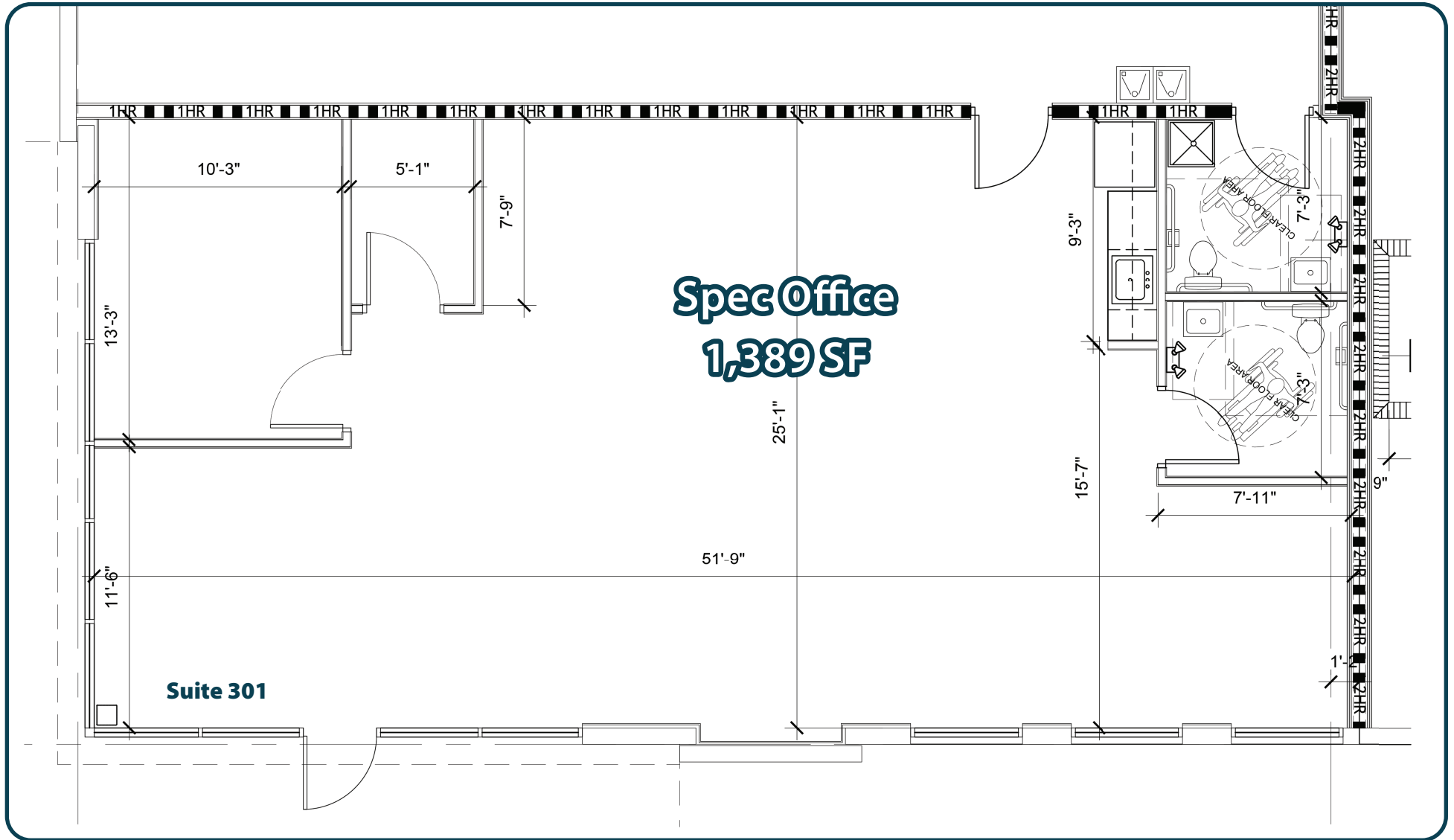



GULF LANDING LOGISTICS CENTER

9983 GULF LOGISTICS DRIVE | FORT MYERS, FL 33913

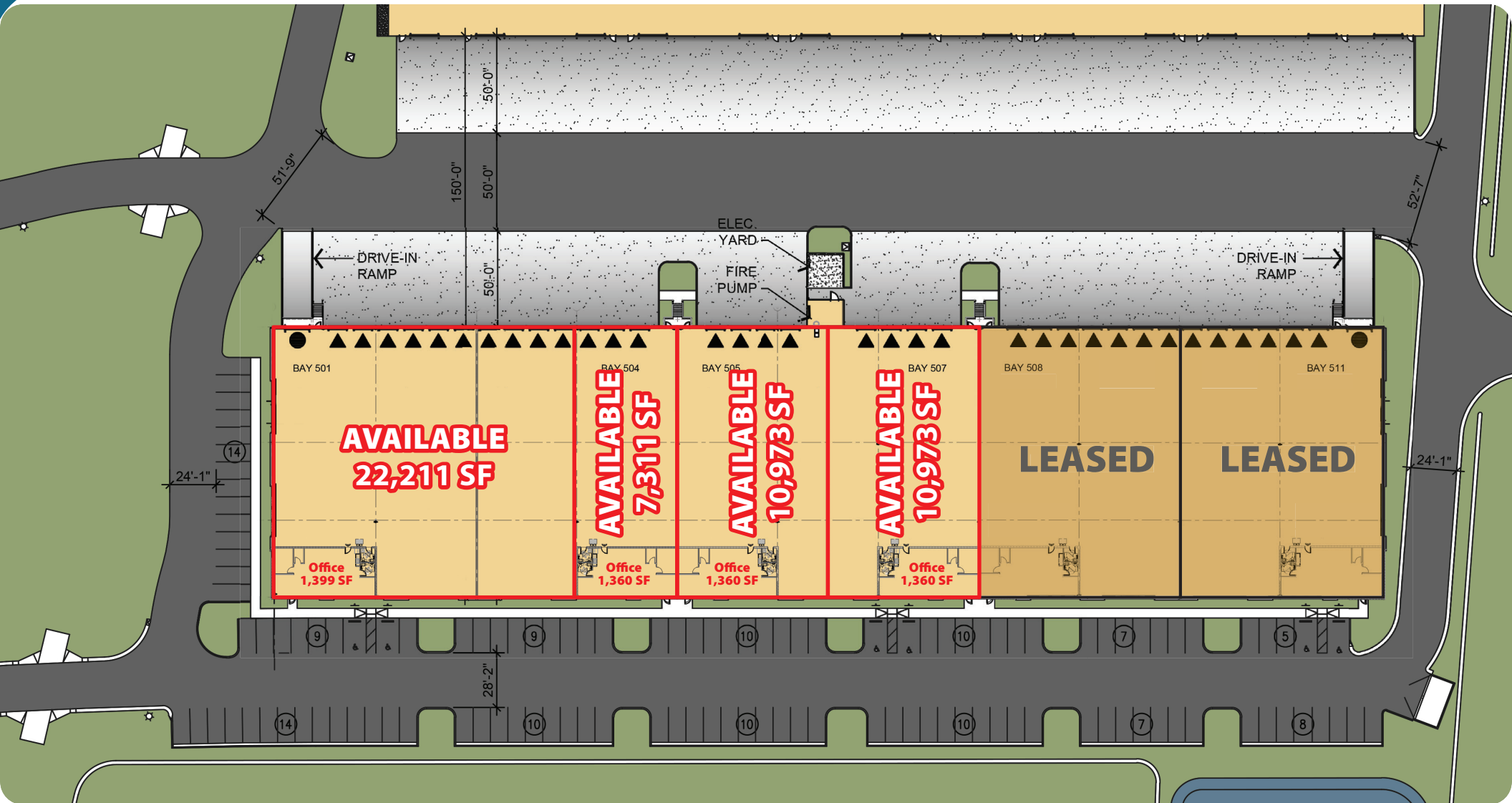

BUILDING 5

- ▲ 9'-0" X 10'-0" OVERHEAD DOCK DOOR (34 TOTAL)
- 12'-0" X 14'-0" OVERHEAD DRIVE-IN DOOR (2 TOTAL)



GULF LANDING LOGISTICS CENTER

9983 GULF LOGISTICS DRIVE | FORT MYERS, FL 33913

**Spec Office
1,360 SF to
1,399 SF**

Building 5



GULF LANDING LOGISTICS CENTER

GULF LOGISTICS DRIVE | FORT MYERS, FL 33913

LEE & ASSOCIATES
COMMERCIAL REAL ESTATE SERVICES

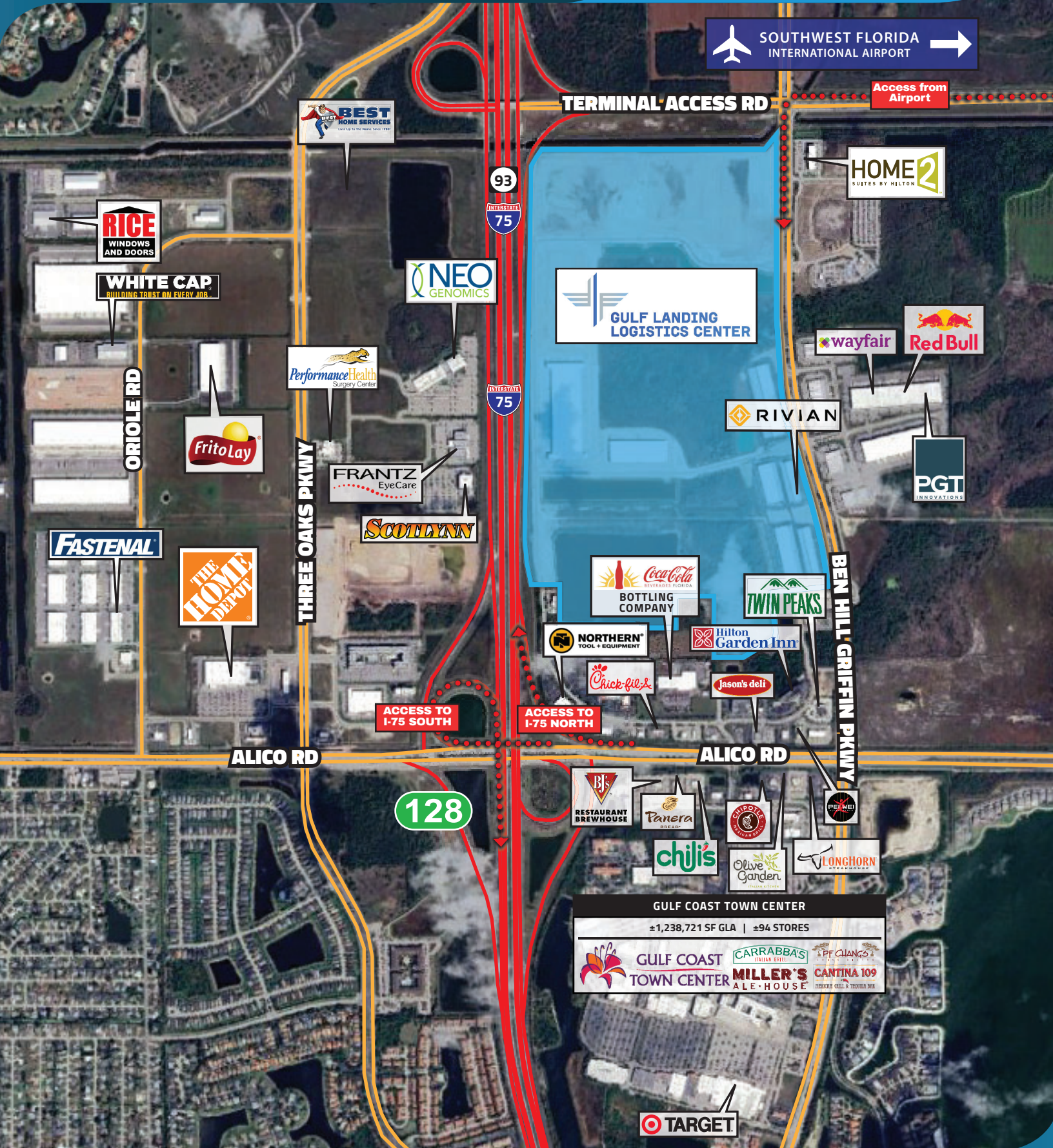

SOUTHWEST FLORIDA INTERNATIONAL AIRPORT →

Access from Airport

TERMINAL ACCESS RD

HOME 2
SUITES BY HILTON

RICE
WINDOWS AND DOORS

WHITE CAP
BUILDING TRUST ON EVERY JOB

NEO GENOMICS

GULF LANDING LOGISTICS CENTER

wayfair

Red Bull

ORIOLE RD

Performance Health
Surgery Center

Frito Lay

FRANTZ
EyeCare

RIVIAN

PGT INNOVATIONS

FASTENAL

THE HOME DEPOT

THREE OAKS PKWY

SCOLLYNN

Coca-Cola
BOTTLING COMPANY

TWIN PEAKS

BEN HILL GRIFFIN PKWY

NORTHERN
TOOL + EQUIPMENT

Hilton Garden Inn

Chick-fil-A

Jason's deli

ACCESS TO I-75 SOUTH

ACCESS TO I-75 NORTH

ALICO RD

ALICO RD

128

BJ'S
RESTAURANT BREWHOUSE

Panera
BREADWORKS

CHIPotle
MEXICAN GRILL

PELMEI

chili's

Olive Garden
ITALIAN GARDEN

LONGHORN
STEAKHOUSE

GULF COAST TOWN CENTER
±1,238,721 SF GLA | ±94 STORES

GULF COAST TOWN CENTER **CARRABBA'S** **PF CHANGS**
MILLER'S ALE-HOUSE **CANTINA 109**

TARGET