

FOR LEASE: ±1,721 SF - ±4,159 SF
1061 TIERRA DEL REY, CHULA VISTA, CA 91910



KIMBERLY CHANELLE CLARK, ESQ.
Senior Vice President | 858.458.3343
kclark@voitco.com | Lic. #01439305

Voit
REAL ESTATE SERVICES

THE CLARK TEAM

DEL REY TERRACE OFFICE CONDOS

1061 TIERRA DEL REY, CHULA VISTA, CA 91910

FOR LEASE

1,721 SF

PROPERTY FEATURES

- » ±1,721 SF - 4,159 available for lease
- » Upscale Rancho Del Rey Area of Chula Vista with easy access to I-805 and Hwy-125
- » Common area conference room
- » Marble flooring in common areas
- » Elevator served
- » Suites with views of Downtown San Diego
- » Restaurants and retail nearby
- » Many amenities and upgrades

PROPERTY AVAILABILITY

SUITE	SIZE (SF)
203	±1,721 SF
300, 301 & 302	±4,159 SF



DEL REY TERRACE OFFICE CONDOS

1061 TIERRA DEL REY, CHULA VISTA, CA 91910

FOR LEASE

±1,721 SF - ±4,159 SF

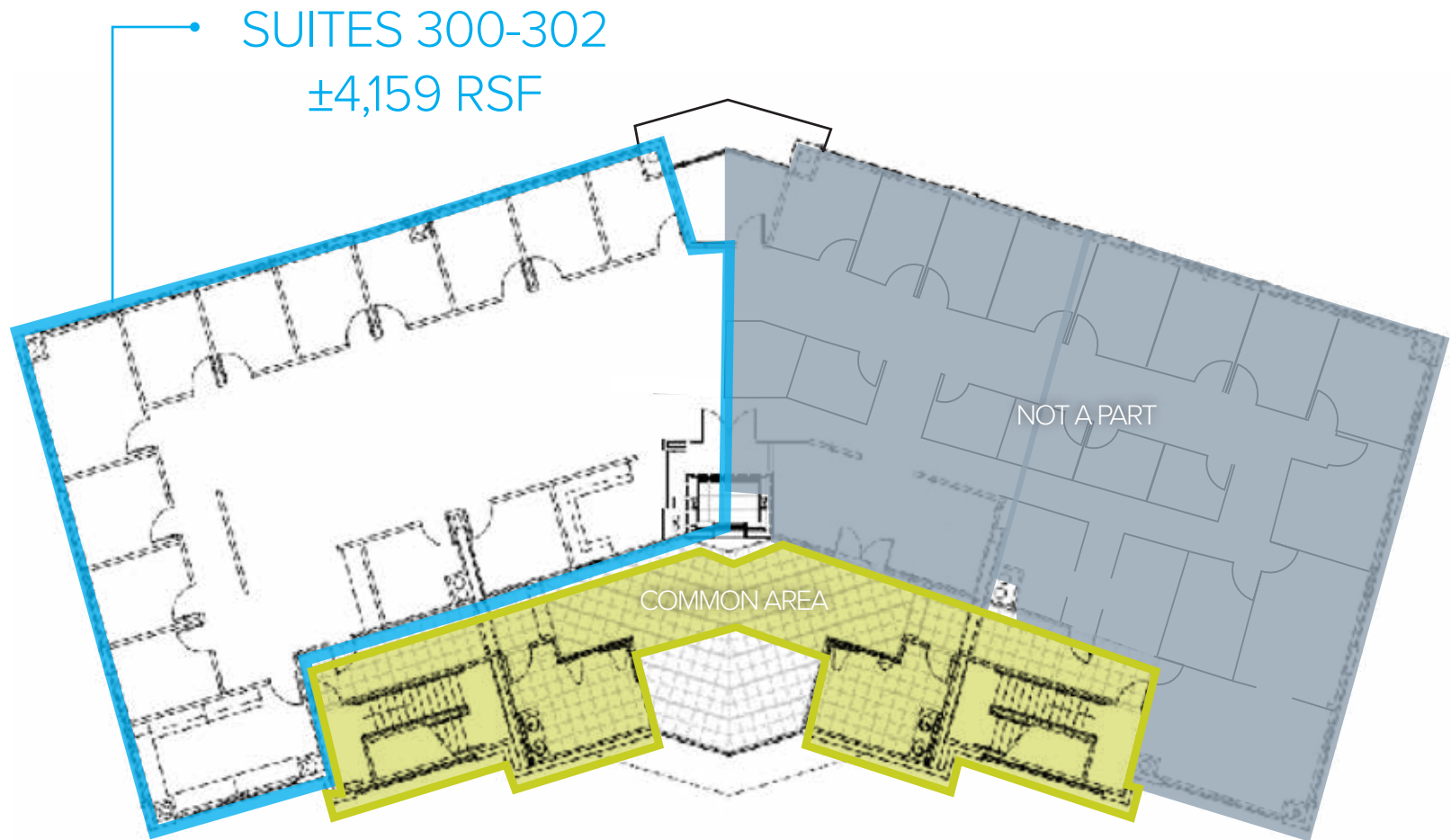

- » Lobby
- » Kitchenetten
- » Open Space
- » Conference Room
- » Several Private Offices

DEL REY TERRACE OFFICE CONDOS

1061 TIERRA DEL REY, CHULA VISTA, CA 91910

FOR LEASE

1,721 SF

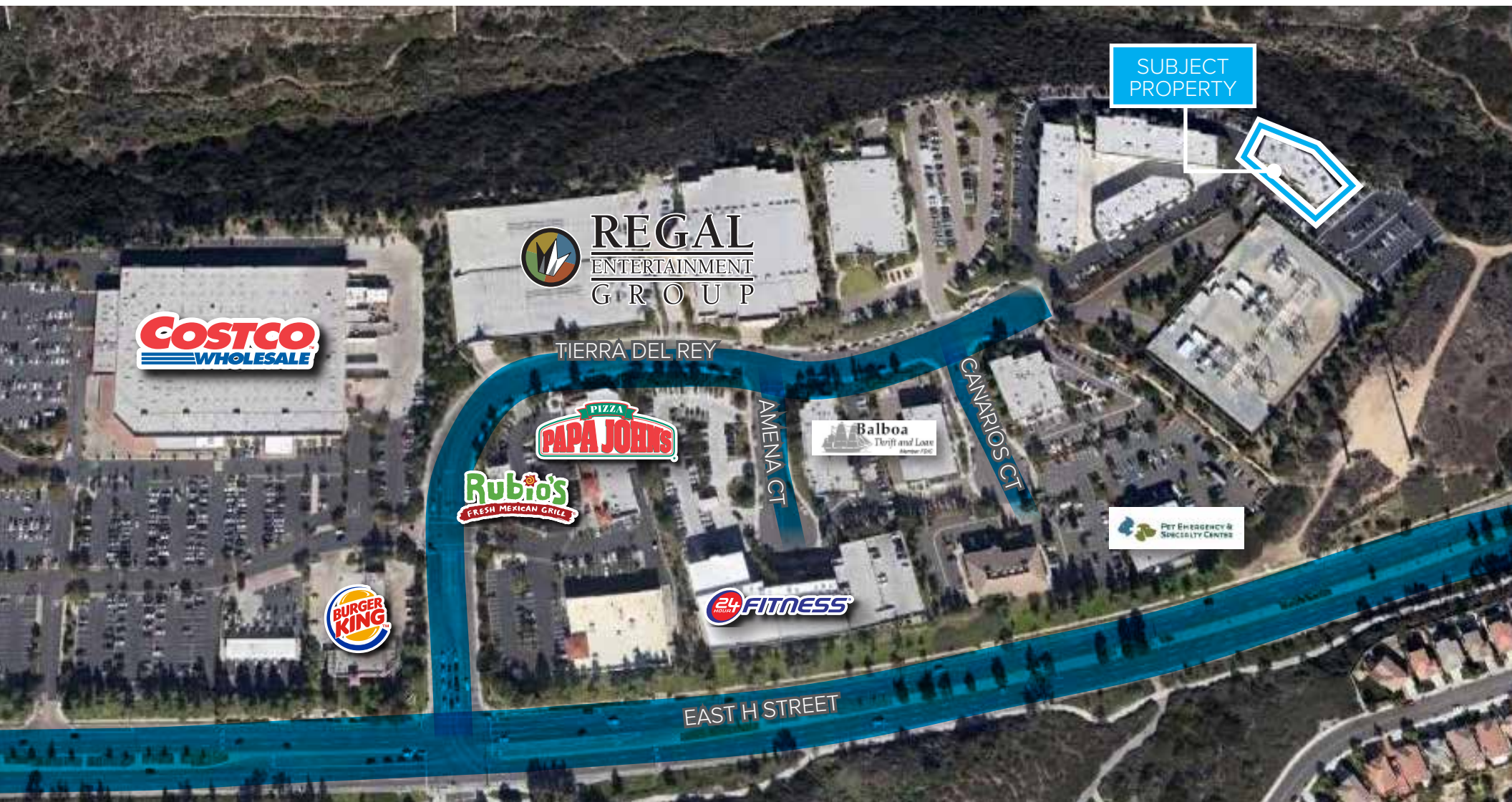

KIMBERLY CHANELLE CLARK, ESQ.
Senior Vice President, Partner | 858.458.3343
kclark@voitco.com | Lic. #01439305

4180 La Jolla Village Drive, Suite 100, La Jolla, CA 92037 • 858.453.0505 • 858.408.3976 Fax • Lic #01991785 | www.voitco.com

Licensed as a Real Estate Broker and a Salesperson by the DRE. The information contained herein has been obtained from sources we deem reliable. While we have no reason to doubt its accuracy, we do not guarantee it. ©2024 Voit Real Estate Services, Inc. All Rights Reserved. Real People. Real Solutions.® is a registered trademark of Voit Real Estate Services.

Voit
REAL ESTATE SERVICES

