

# FLOORPLAN

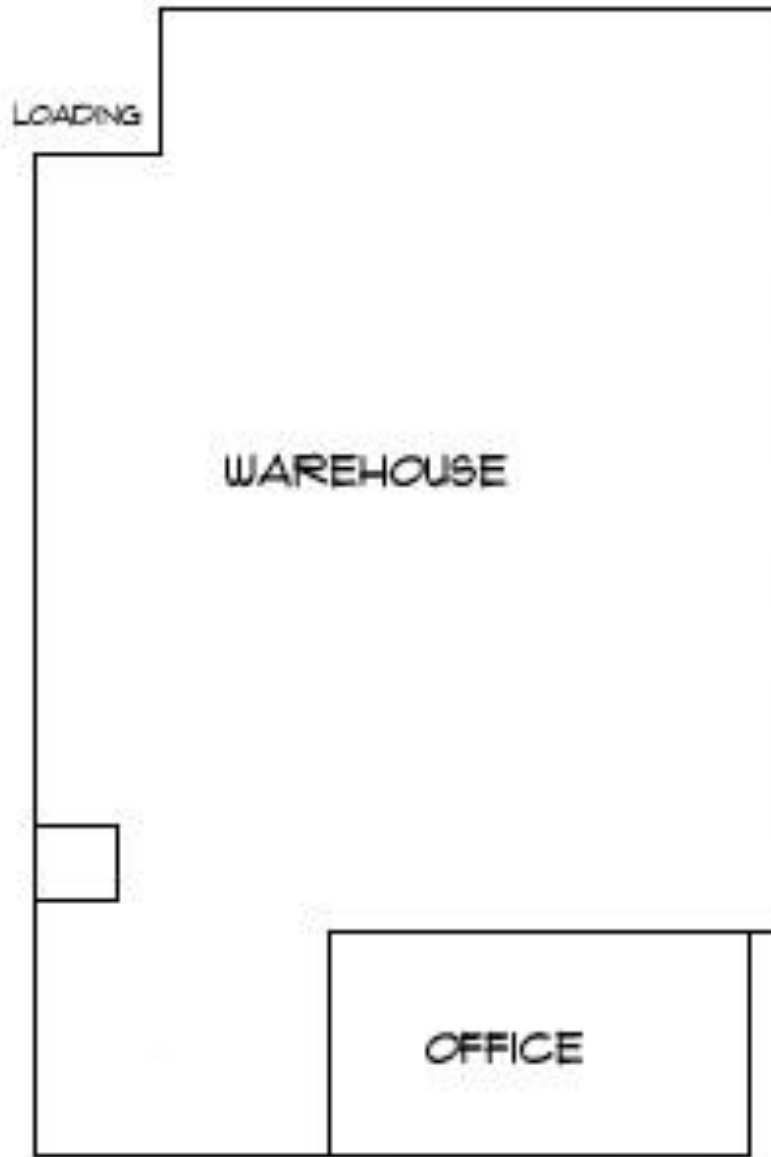

For illustrative purposes only. Not to scale. All measurements provided or implied are approximate.

4057 CALLE TESORO  
CAMARILLO, CALIFORNIA

FOR MORE INFORMATION CONTACT:  
KENT PIERCE  
1203 FLYNN ROAD, SUITE 240, CAMARILLO, CALIFORNIA 93012  
**TELEPHONE: 805/384-9500 x101**  
[WWW.EQUITYCOMMERCIAL.COM](http://WWW.EQUITYCOMMERCIAL.COM)

EQUITY  
COMMERCIAL