

Basement Bar / Restaurant - TO LET

22-24 West Nile Street Basement, G1 2PW

WITH ALCOHOL
LICENCE NOW GRANTED



AVISON YOUNG
To Let
Office Suites from 2,215 sq.ft.
0141 300 8000

INNIS & GUNN
BREWERY TAPROOM
STEAK FRITES
LIVE MUSIC
SHUFFLEBOARD
BIG LUNCH MUNCH

TO LET
BASEMENT BAR/
RESTAURANT
2,643 SQ.FT.

THE BIG
LUNCH MUNCH

INNIS & GUNN
LAGER BEER

INNIS & GUNN
LAGER BEER

INNIS & GUNN
LAGER BEER

INNIS & GUNN
LAGER BEER

savills

las IGUANAS

las IGUANAS



KEY POINTS:

- In the heart of Glasgow's food and beverage circuit, surrounded by the city's busiest bars and restaurants and 50m from Buchanan Street.
- Dedicated entrance to basement level, sitting beneath Innis and Gunn.
- Nearby occupiers include Las Iguanas, Gaucho, All Bar One, Miller & Carter and Mowgli.
- Alcohol licence now granted permitting an occupancy capacity of 195 persons.

ACCOMMODATION:

The property is arranged over basement level only, comprising the following approximate gross internal area:

Basement: 2,643 sq ft 245.5 sq m

RENT:

£50,000 per annum exclusive.

TERMS:

The property is available by way of a sub-lease on new Full Repairing and Insuring terms.

PLANNING:

The property has planning consent for both Class 3 restaurant use and Sui Generis public house use.

BUSINESS RATES:

The premises have to be assessed for rating purposes. Further details are available on request.

LEGAL COSTS:

Each party to be responsible for their own legal costs incurred during the transaction. For the avoidance of doubt the ingoing tenant will be responsible for Land & Buildings Transaction Tax (LBTT), registration dues and any VAT payable thereon.

EPC:

Full Energy Performance Certificate available upon request.

CONTACT DETAILS:

For further information or to arrange a viewing, please contact Savills.

John Menzies

T: 07808 479 265

E: john.menzies@savills.com

Michelle McLaughlin

T: 07977 851 507

E: michelle.mclaughlin@savills.com

Proposed Layout

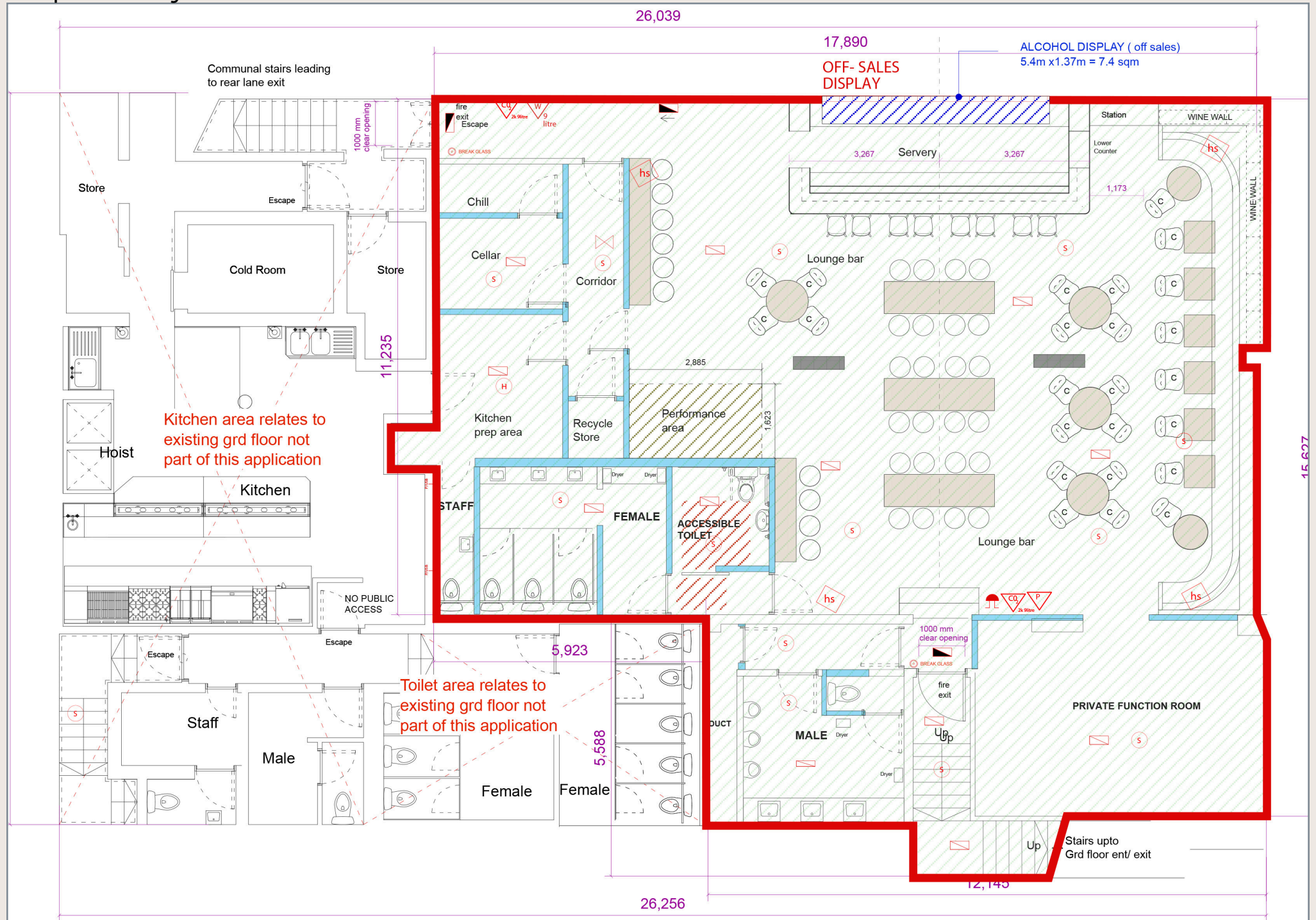

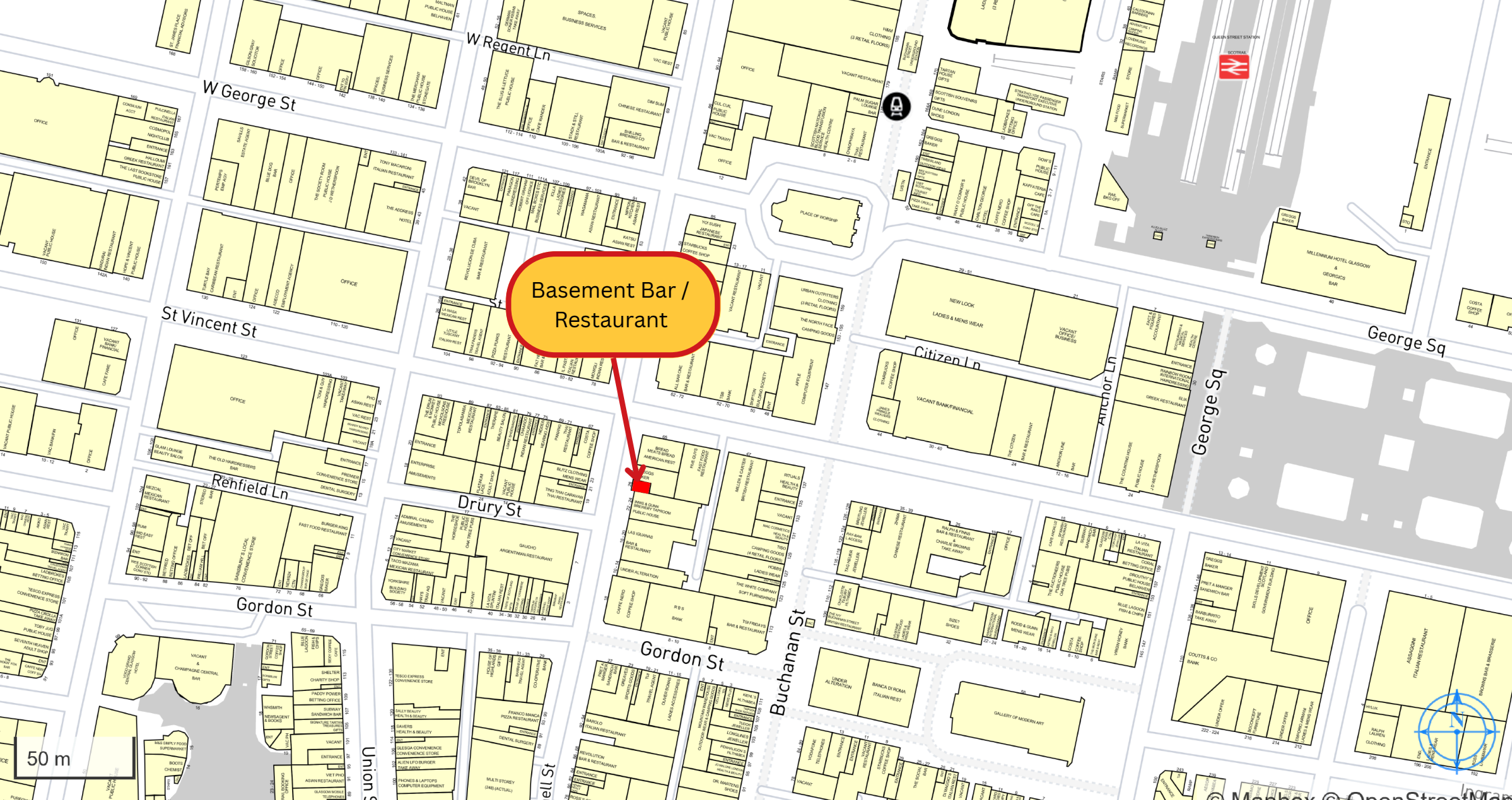

**Basement Bar /
Restaurant**

IMPORTANT NOTICE

Goald Plans are reproduced from the Ordnance Survey Map with the permission of Experian © Crown copyright and database rights 2024. OS AC0000807366 and published for the purposes of identification only and although believed to be correct accuracy is not guaranteed.

Savills, their clients and any joint agents give notice that:

1. They are not authorised to make or give any representations or warranties in relation to the property either here or elsewhere, either on their own behalf or on behalf of their client or otherwise. They assume no responsibility for any statement that may be made in these particulars. These particulars do not form part of any offer or contract and must not be relied upon as statements or representations of fact.
2. Any areas, measurements or distances are approximate. The text, photographs and plans are for guidance only and are not necessarily comprehensive. It should not be assumed that the property has all necessary planning, building regulation or other consents and Savills have not tested any services, equipment or facilities. Purchasers must satisfy themselves by inspection or otherwise.