

Former Sears Premises

32900 South Fraser Way
Abbotsford, BC

A Rare Opportunity for large format retailers

To lease 47,000 – 112,000 SF
in the former Sears Premises in
the Sevenoaks Shopping Centre,
Abbotsford, BC.

Contact Agent

Maureen Mounzer

Personal Real Estate Corporation
Associate Vice President
Commercial Sales & Leasing
+1 604 669 1466
maureen.mounzer@cbre.com



The Former Sears Premises

32900 South Fraser Way, Abbotsford, BC

Retail for Lease

The Opportunity

To lease 42,000 - 112,000 SF retail space as in a Regional Mall in the heart of Abbotsford, a major suburban city with a trade area population of over 350,000 people. With large spaces almost extinct, this offering with finished retail space, and a minimum of 10-year term, is one of a kind.

Salient Details

ADDRESS:	32900 South Fraser Way, Sevenoaks Mall, Abbotsford
PREMISES:	Former Sears premises, main and 2nd floor
MAIN FLOOR:	47,000 SF
SECOND FLOOR:	65,000 SF with 3 entrance points
LEASE:	The floors can be leased together with internal escalator, or leased separately
MALL ACCESS:	None
LOADING	+ 2 shared docks plus large truck loading platform + Large receiving area shared with Ardene's + Freight elevator to 2nd level
TIMING:	Summer 2023 after completion of demise, entrance, loading
CLEAR HEIGHTS:	12' to T-bar, 13' to mechanical
PARKING:	Over 1,000 parking stalls surround the Sears
SIGNAGE:	Large area above the entrances plus exterior wall panels, wayfinding and pylon
GROSS RATE:	Contact Listing Agent

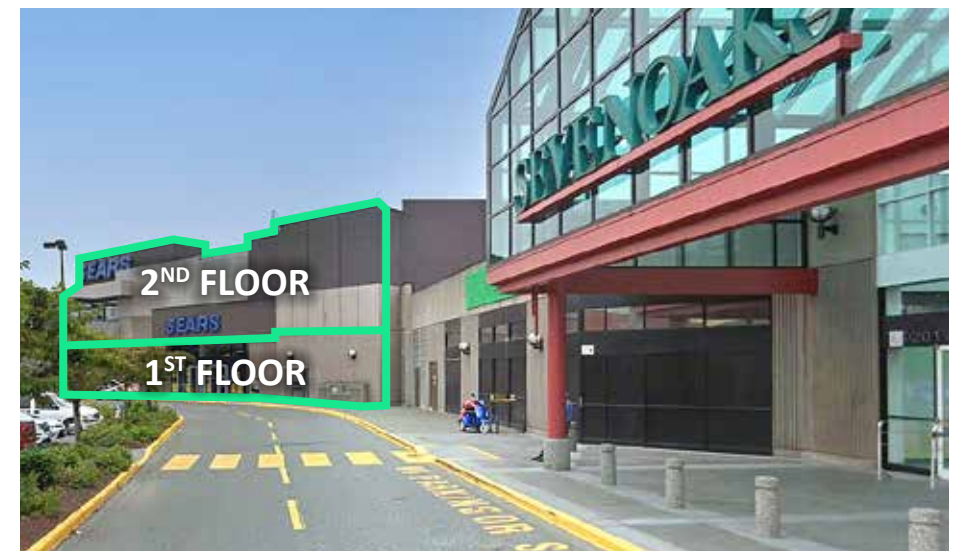

MAIN FLOOR

2ND FLOOR

47,000_{SF} + 65,000_{SF}



2nd FLOOR

MAIN FLOOR

47,000 SF

- + Large entrance vestibule shared with Ardene's
- + Finished space with open floorplan
- + Ceiling-12' clear to T-bar and 13' to mechanical
- + 2 docks plus large truck platform deliveries
- + Large shared receiving area

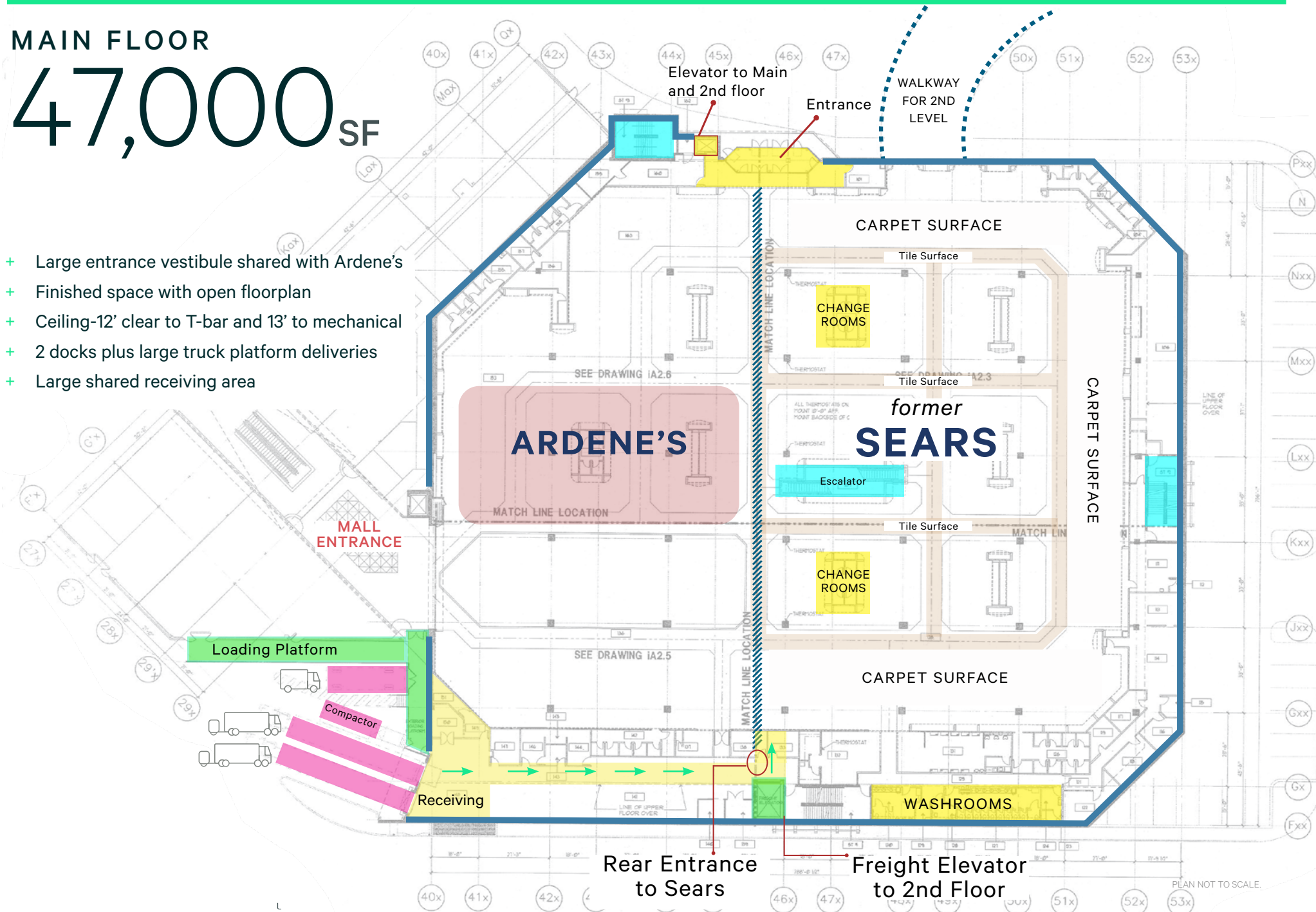

PLAN NOT TO SCALE.

2ND FLOOR 65,000 SF

- + Large east facing entrance
- + Walkway to 3 level parkade
- + Additional elevator access
- + Finished space with open floorplan
- + Ceiling – 12' + 13' clear
- + Deliveries – 2 docks, plus large truck platform
- + Dedicated freight elevator

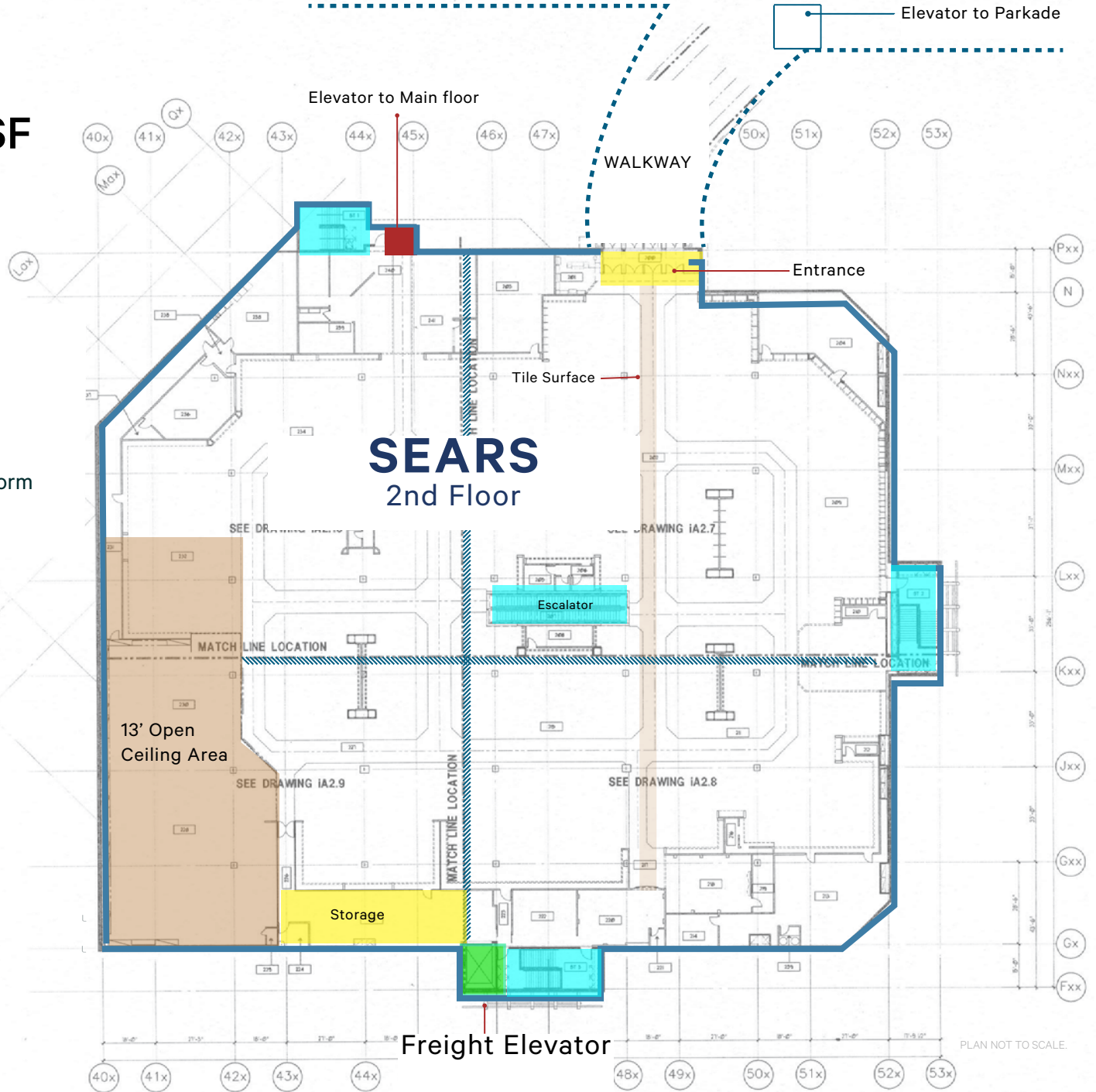

MAIN FLOOR

42,000

SF

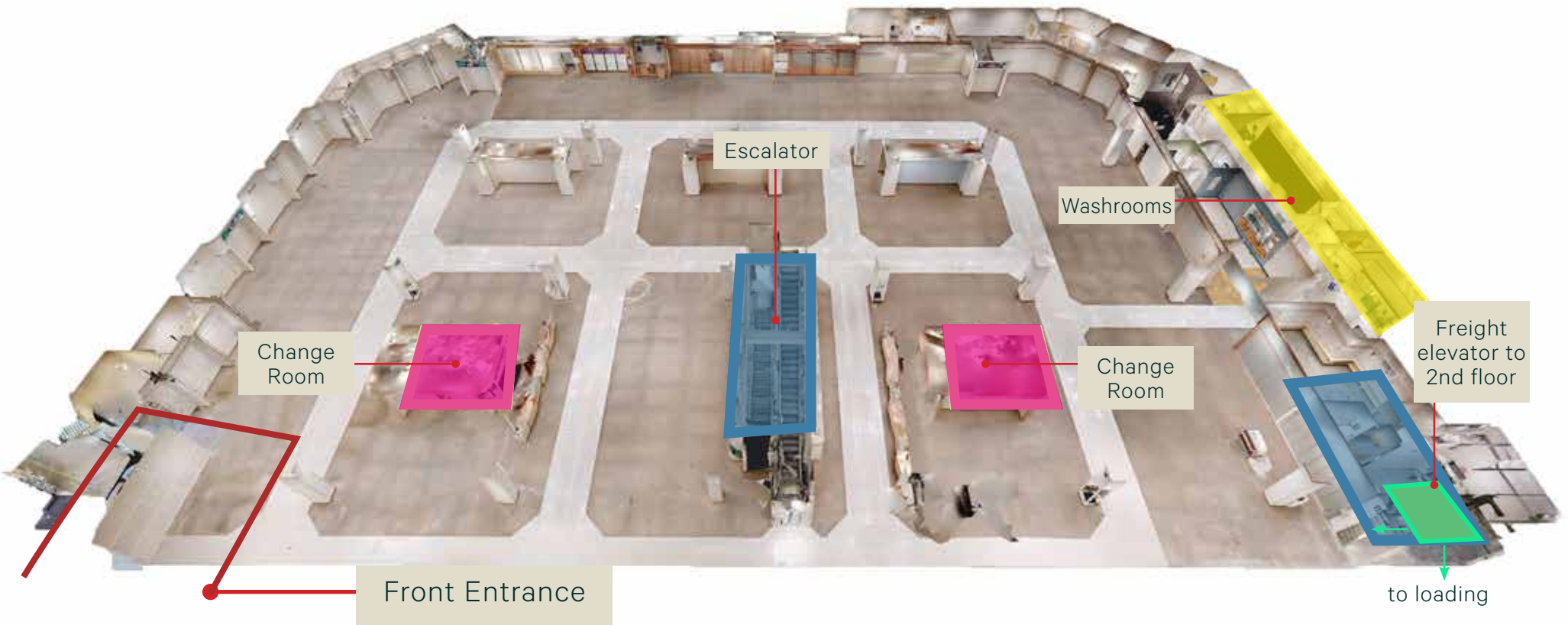

SECOND FLOOR

65,000

SF

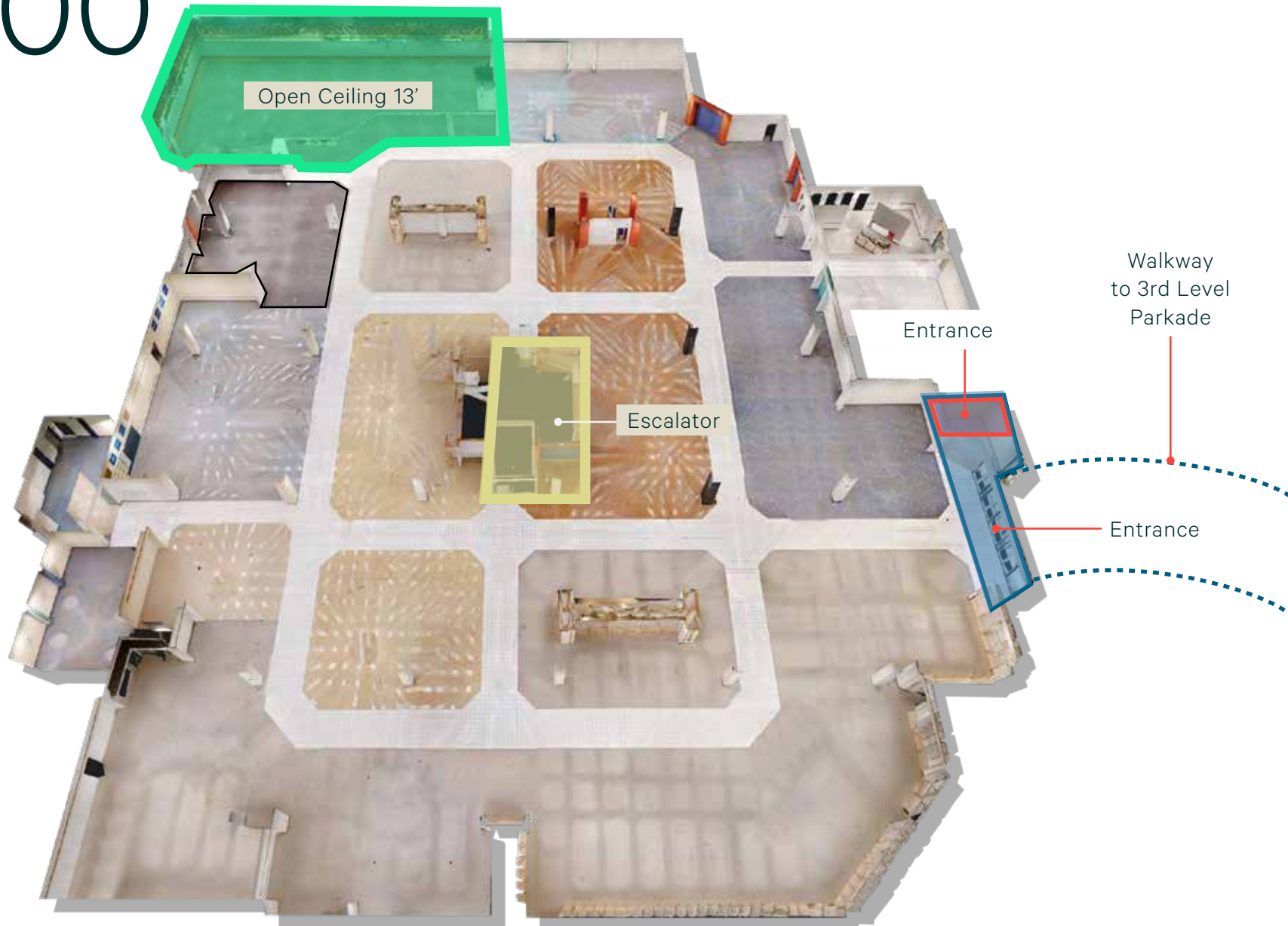

A rare opportunity for large retailers to enter or expand

Highlights

- + Located in a major Regional Mall
- + Serving Abbotsford and the surrounding communities
- + Over 300,000 person trade area
- + Heart of the commercial core next to the Transit Exchange
- + Fully improved space
- + Over 1000 parking stalls surround the building
- + 10-year term and renewables available

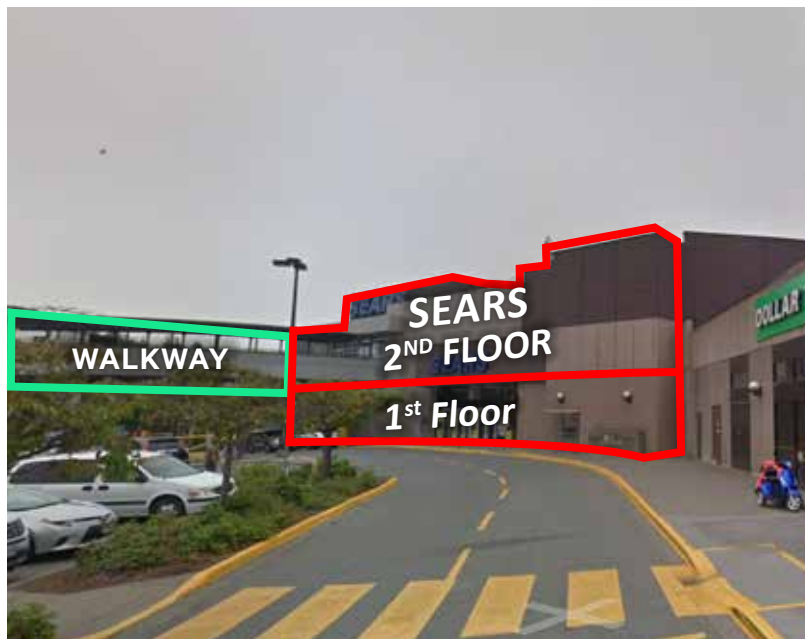

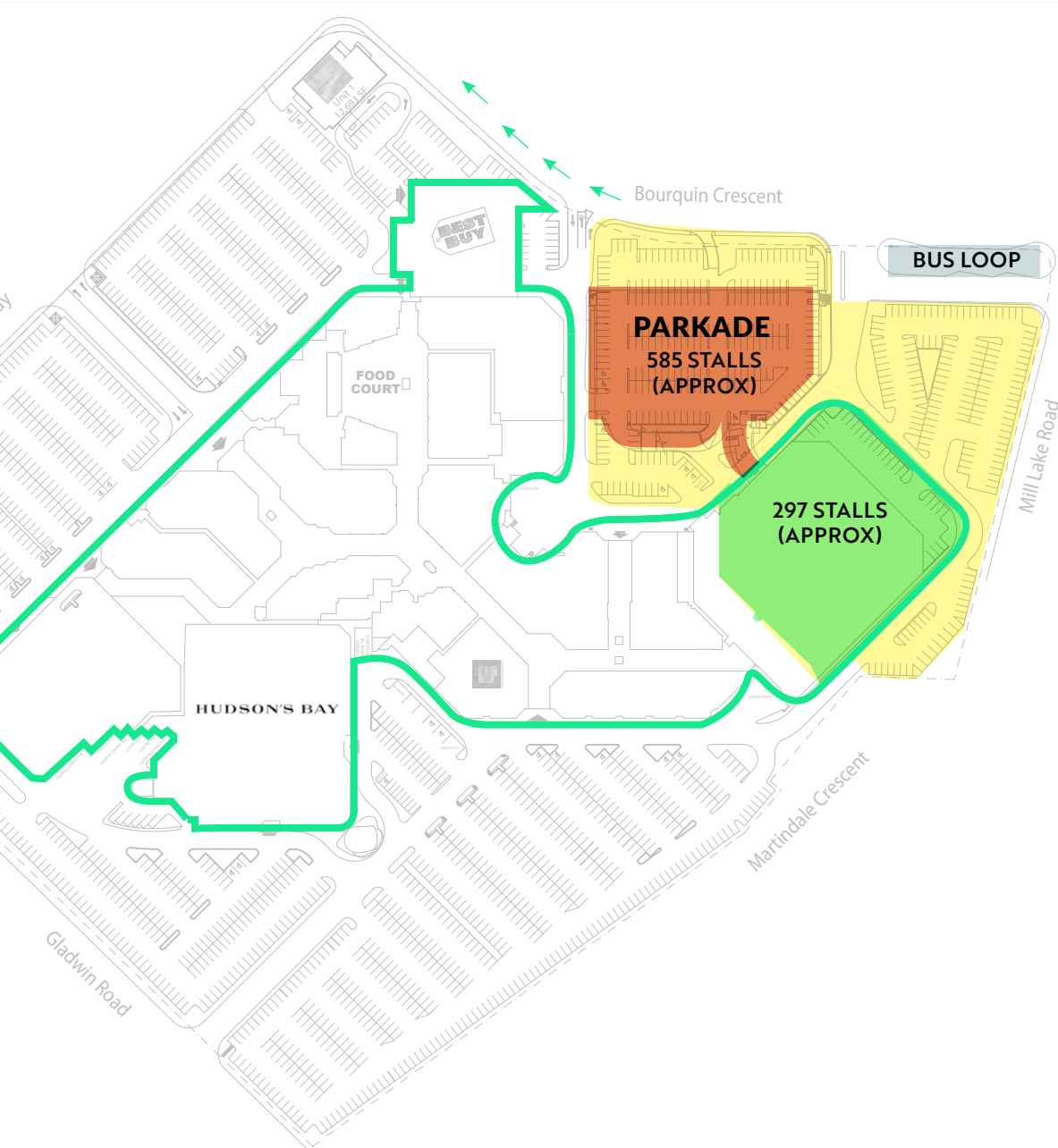

The Commercial Core



Abbotsford: the “HUB” of the Fraser Valley

The Location

Abbotsford is the hub of the entire “eastern Fraser Valley” (Abbotsford, Mission, Chilliwack and Hope), a trade area over 300,000 people. It’s a growing community offering residents affordable housing options and has significant employers and amenities. Statistically, Abbotsford has:

76%

High Home Ownership

7.9%

High Population Growth

\$115,340

Average Household Income as of 2022

4

persons
Average family 2022

- 1 Abbotsford International Airport
Over 1 million passengers a year-3 national airlines
- 2 Tradex Exhibition Centre
120,000 SF centre hosting over 90 events a year
- 3 Abbotsford Auto Mall-15 auto dealers
- 4 XCHANGE Business Park
new 1.4 million SF Business/Industrial Park
- 5 Abbotsford Provincial Law Courts
new \$150 million Supreme Court facility
- 6 Abbotsford Regional Hospital and Cancer Centre
BC’s first LEED hospital
- 7 University of the Fraser Valley
15,000 students, diploma, degree and masters programs
- 8 U.S. Border Crossing
A nearby US border crossing

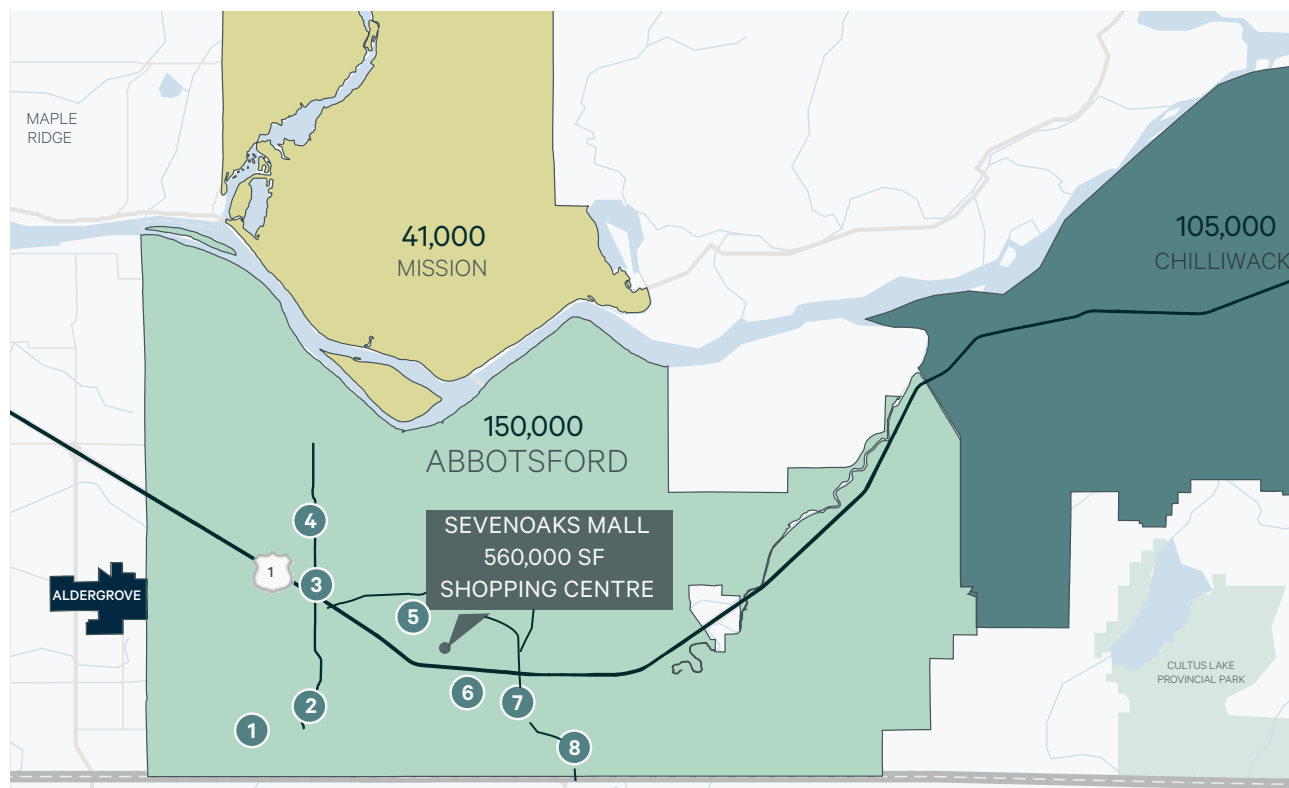



Drive Times

10

Min drive US Border

15

Min Drive to Langley

15

Min Drive to Chilliwack

13

Min Drive to Mission

Contact Agent

Maureen Mounzer
Personal Real Estate Corporation
Associate Vice President
Commercial Sales & Leasing
+1 604 669 1466
maureen.mounzer@cbre.com