

147 S. BEVERLY DRIVE  
BEVERLY HILLS  
**RETAIL / SHOWROOM**



**FOR LEASE**

# DETAILS

## **AVAILABILITIES**

147 S. Beverly Drive: ± 4,800 SF

**RATE:** Call for details

- Adjacent to Chaumont / Chaumont Vegan
- Across from South Beverly Grill
- Rear alley access/loading
- Reserved parking available

**97** WALK SCORE

**90212** ZIP CODE

**Prime  
Beverly Hills**

## LISTING TEAM



### JAKE ZACUTO

Managing Director  
310.469.9012  
jake@zacutogroup.com  
BRE #01377441

### LEOR BINSHTOCK

Executive Vice President  
310.469.9014  
leor@zacutogroup.com  
BRE #01773798

### ANDREW SINASOHN

Executive Vice President  
310.469.9023  
andrew@zacutogroup.com  
BRE #01951740

### BEN KHOUBIAN

Senior Director  
424.254.3160  
ben@zacutogroup.com  
BRE #02197728

# S.BEV DRIVE

*Beverly Hills*

UP & COMING  
RETAIL / ARTS DISTRICT

Poised to be a destination for retail and entertainment of Beverly Hills, this high traffic location is ideal for restaurants, apparel, galleries, coffee shops and experiential uses.



147 S. BEVERLY DRIVE  
BEVERLY HILLS  
RETAIL / SHOWROOM

**OFFICE ALSO AVAILABLE**

Up to 10,000 SF Penthouse+ Private Rooftop

159

153-157

147

145

143

141

139

4,800 SF

WORLD RENOWNED RESTAURANT  
COMING SOON

AVAILABLE

CHAUMONT  
VEGAN

CHAUMONT

TOMOKO SPA

OFFICE

South Beverly Drive

PEDESTRIAN CROSSWALK  
IN PROGRESS

GAGOSIAN

PRADA

ALFRED COFFEE

CHANEL

LOUIS VUITTON



EREWHON  
ORGANIC GROCER & CAFE

Nate n' Al's

e. baldi

il Pastaio  
ristorante • bar

MARU COFFEE

MASTRO'S  
RESTAURANTS

SUGARFISH  
BY SEAN MOSELEY

GUCCI

RALPH LAUREN

NESPRESSO

AVRA  
BEVERLY HILLS  
estiatorio

DANTE  
EST. 1915  
NEW YORK CITY  
Beverly Hills

THE MAYBOURNE  
BEVERLY HILLS

CIPRIANI

RODEO DRIVE

BW  
BEVERLY WILSHIRE  
Beverly Hills  
A FOUR SEASONS HOTEL

EQUINOX

WME

CUT  
WOLFGANG PUCK

147 S. BEVERLY DRIVE  
BEVERLY HILLS

SOUTH BEVERLY GRILL

LEVAIN COOKIES

BLUE BOTTLE COFFEE

PICCOLO PARADISO

MATU



# INTERIOR PHOTOS





REAR ALLEY ACCESS

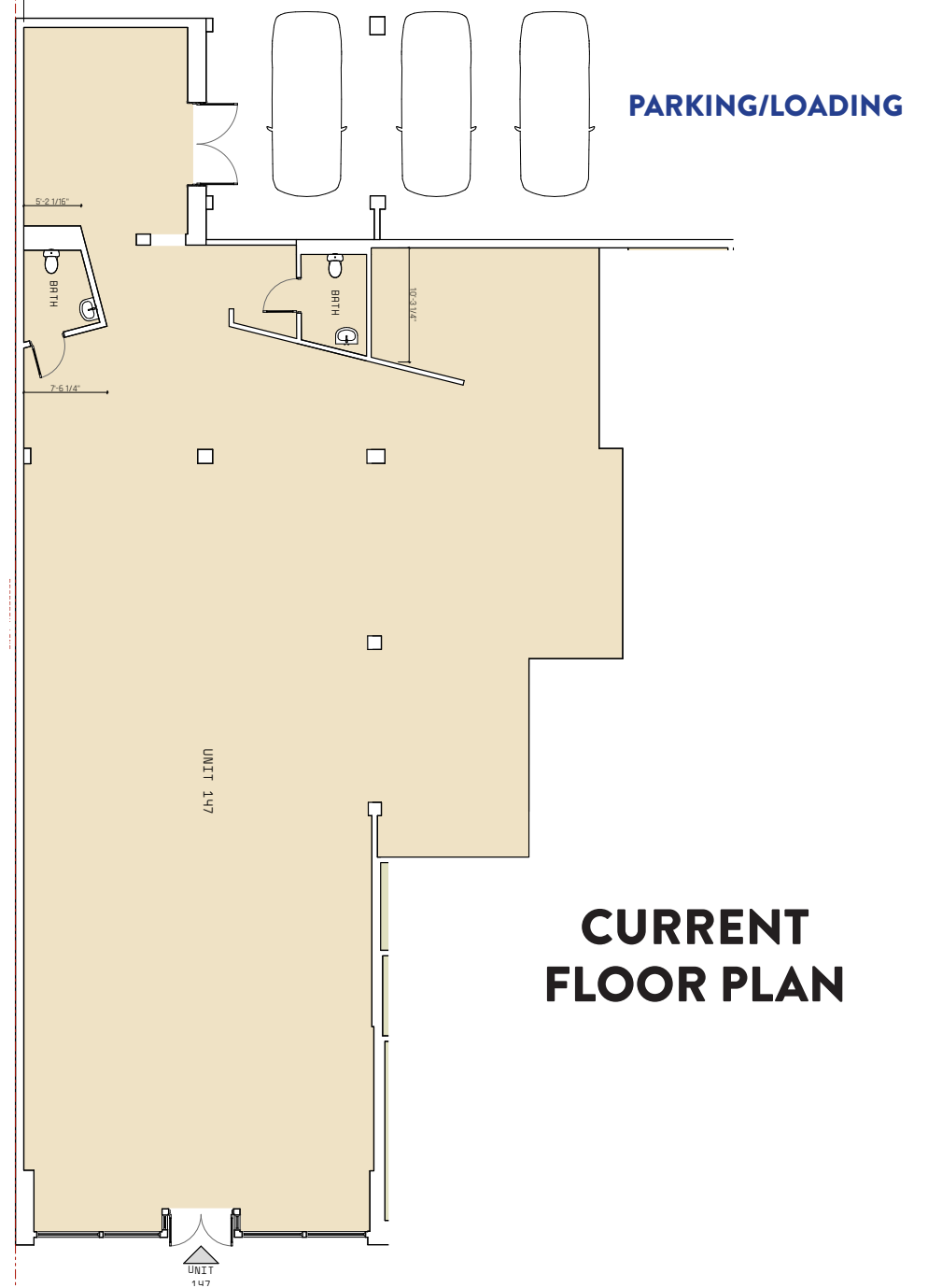

CURRENT FLOOR PLAN

SOUTH BEVERLY DRIVE

# BEVERLY HILLS GOLDEN TRIANGLE

147 S  
BEVERLY  
DRIVE



- ALFRED COFFEE
- FUNKE
- WALLY'S
- PURA VIDA
- NATE N AL'S
- IL PASTAIO
- CARTIER
- NESPRESSO
- E. BALDI
- GRAVITAS
- EREWON
- LULULEMON
- SUGARFISH
- WHOLE FOODS
- GAGOSIAN
- NOVIKOV
- MASTROS
- GUCCI
- LOUIS VUITON
- SPAGO
- EQUINOX
- CIPRIANI
- TIFFANY & CO.
- AVRA
- DANTE
- WME
- RIMOWA
- MARU COFFEE
- MAYBOURNE HOTEL
- 60 HOTEL BH
- FOUR SEASONS HOTEL
- TOMOKO SPA
- SOUTH BEVERLY GRILL
- CHAUMONT BAKERY
- LEVAIN BAKERY
- RENNOWNED RESTAURANT COMING SOON
- AHARON COFFEE ROASTER
- BLUE BOTTLE COFFEE
- LAYLA BAGELS
- PICCOLO PARADISO
- CALIFORNIA PIZZA KITCHEN
- MATU
- FATAMORGANA GELATO
- STARBUCKS
- SWEET LADY JANE
- FRIDA MEXICAN
- PINKBERRY
- URTH CAFFE

# STEPS TO THE BEST OF BEVERLY HILLS



📍 URTH CAFFE



📍 BLUE BOTTLE COFFEE



📍 AVRA



📍 EREWHON MARKET



📍 ALFRED COFFEE



📍 BEVERLY WILSHIRE HOTEL

GUCCI  
OSTERIA  
*da Massimo Bottura*



BY WOLFGANG PUCK



SUGARFISH  
BY SUSHI NOZAWA

*il Pastaio*  
Ristorante • Bar

EST. 1915  
NEW YORK CITY  
DANTE  
*Beverly Hills*

SOUTH BEVERLY GRILL



AVRA  
BEVERLY HILLS  
estiatorio

147 S. BEVERLY DRIVE  
BEVERLY HILLS

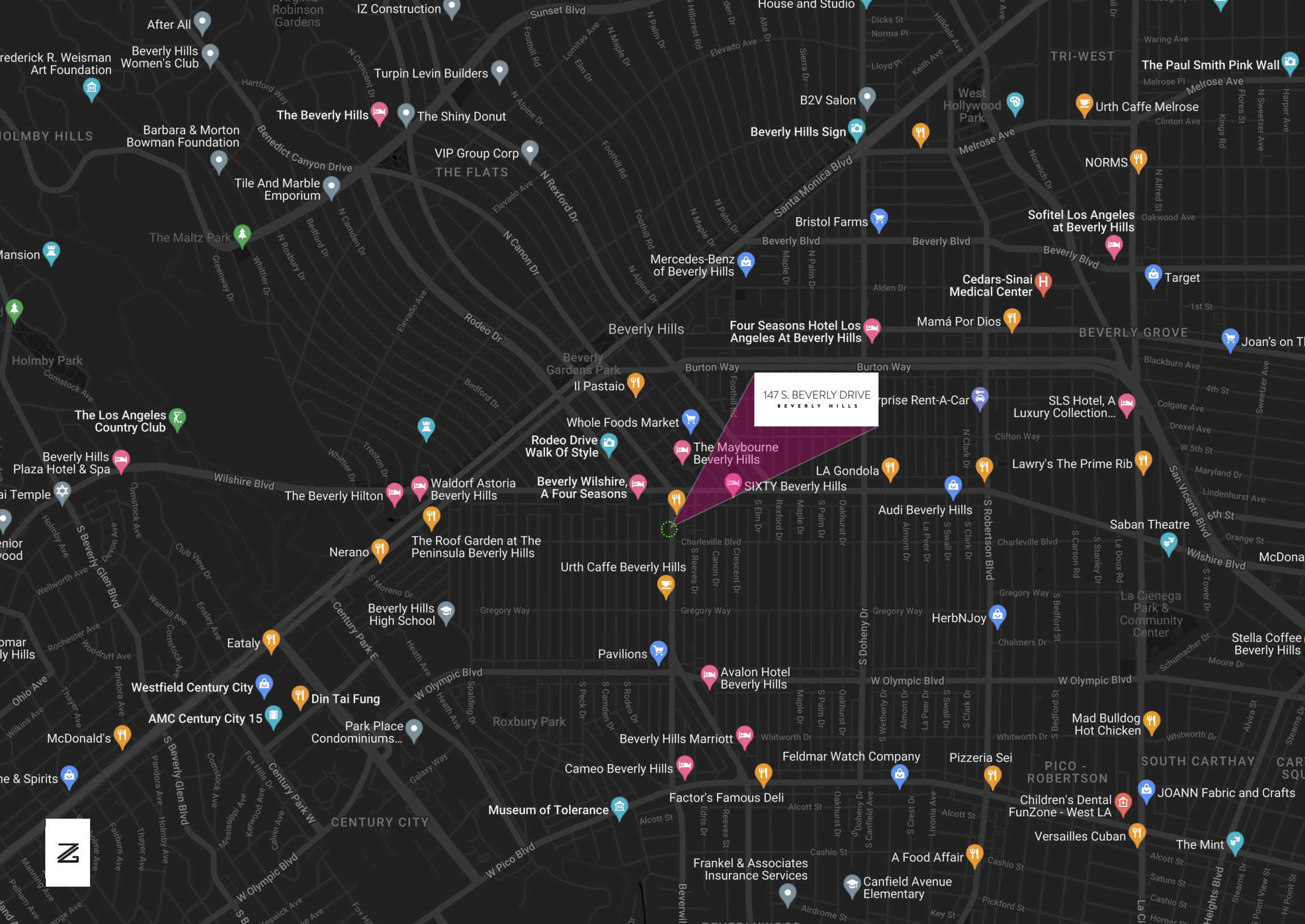

147 S. BEVERLY DRIVE  
B E V E R L Y H I L L S



**JAKE ZACUTO**

*Managing Director*

310.469.9012

[jake@zacutogroup.com](mailto:jake@zacutogroup.com)

BRE #01377441

**LEOR BINSHTOCK**

*Executive Vice President*

310.469.9014

[leor@zacutogroup.com](mailto:leor@zacutogroup.com)

BRE #01773798

**ANDREW SINASOHN**

*Executive Vice President*

310.469.9023

[andrew@zacutogroup.com](mailto:andrew@zacutogroup.com)

BRE #01951740

**BEN KHOUBIAN**

*Senior Director*

424.254.3160

[ben@zacutogroup.com](mailto:ben@zacutogroup.com)

BRE #02197728

*No warranty, express or implied, is made as to the accuracy of the information contained herein. This information is submitted subject to errors, omissions, change of price, rental or other conditions, withdrawal without notice. All parties who receive this material should not rely on it, but should use it as a starting point of analysis, and should independently confirm the accuracy of the information contained herein through a due diligence review of the books, records, files and documents that constitute reliable sources of the information described herein. Logos and images are for identification purposes only and may be trademarks of their respective companies. All terms provided are approximate. Leasee to verify. 4/2025*

**ZACUTOGROUP.COM | 310.469.9300**

