

BELOW 50 UNITS ON THE HARD CORNER OF LINCOLN BLVD & MARCO PL.

# Retail/Restaurant Space For Lease



1816 Lincoln Boulevard, Venice, CA 90291



LEE SHAPIRO • 310.887.6226 • Lee.Shapiro@kwprealestate.com • DRE #00961769

BELOW 50 UNITS ON THE HARD CORNER OF LINCOLN BLVD & MARCO PL.

# Retail/Restaurant Space For Lease



1816 Lincoln Boulevard, Venice, CA 90291

## AVAILABLE

Size: ±1,229 RSF  
Rent: \$8.00 PSF/Mo., NNN

NNN: ±\$1.00 PSF/Mo.  
Available: Q1 2026

## PROPERTY HIGHLIGHTS

- New boutique luxury mixed-use development with 50 apartment units above ground floor retail
- Located directly across from Superba restaurant in the heart of Lincoln's vibrant and rapidly emerging corridor
- Offers exceptional visibility and benefits from strong pedestrian and vehicular traffic
- Versatile use such as fitness studios, curated retail stores, non-hooded culinary experiences
- Strong demographics with an HHI of ±\$206,155 within one mile
- On the incredibly busy street of Lincoln with approximately ±78,309 cars passing per day on Venice Blvd. and Lincoln Blvd.

*\* Prospective tenants are hereby advised that all uses are subject to City approval*

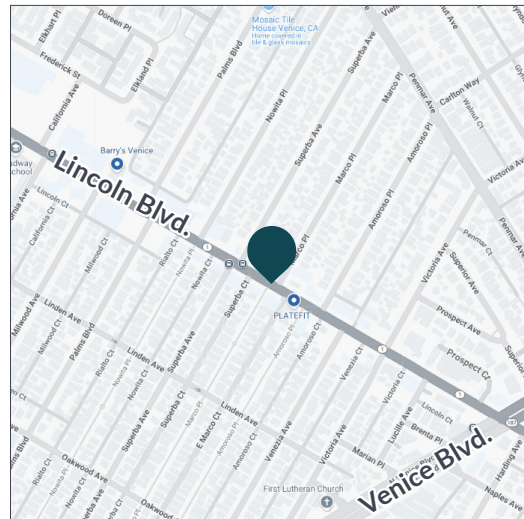

## TRADE AREA



BELOW 50 UNITS ON THE HARD CORNER OF LINCOLN BLVD & MARCO PL.



# Retail/Restaurant Space For Lease

1816 Lincoln Boulevard, Venice, CA 90291

USF: RSF:

Suite 1: ±1,045 USF ±1,229 RSF

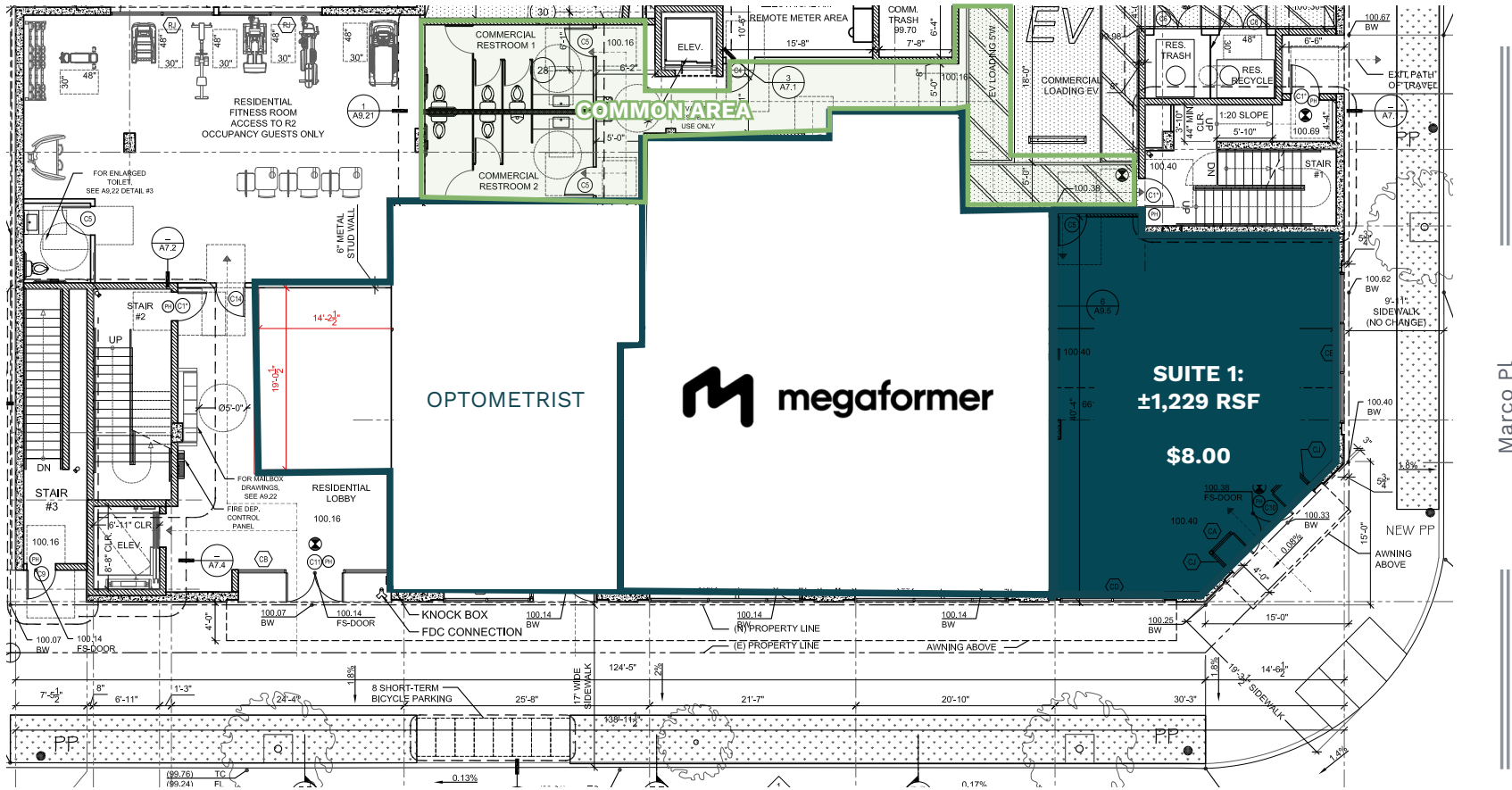

All rates are PSF/Mo., NNN

Lincoln Blvd.



BELOW 50 UNITS ON THE HARD CORNER OF LINCOLN BLVD & MARCO PL.

# Retail/Restaurant Space For Lease



1816 Lincoln Boulevard, Venice, CA 90291

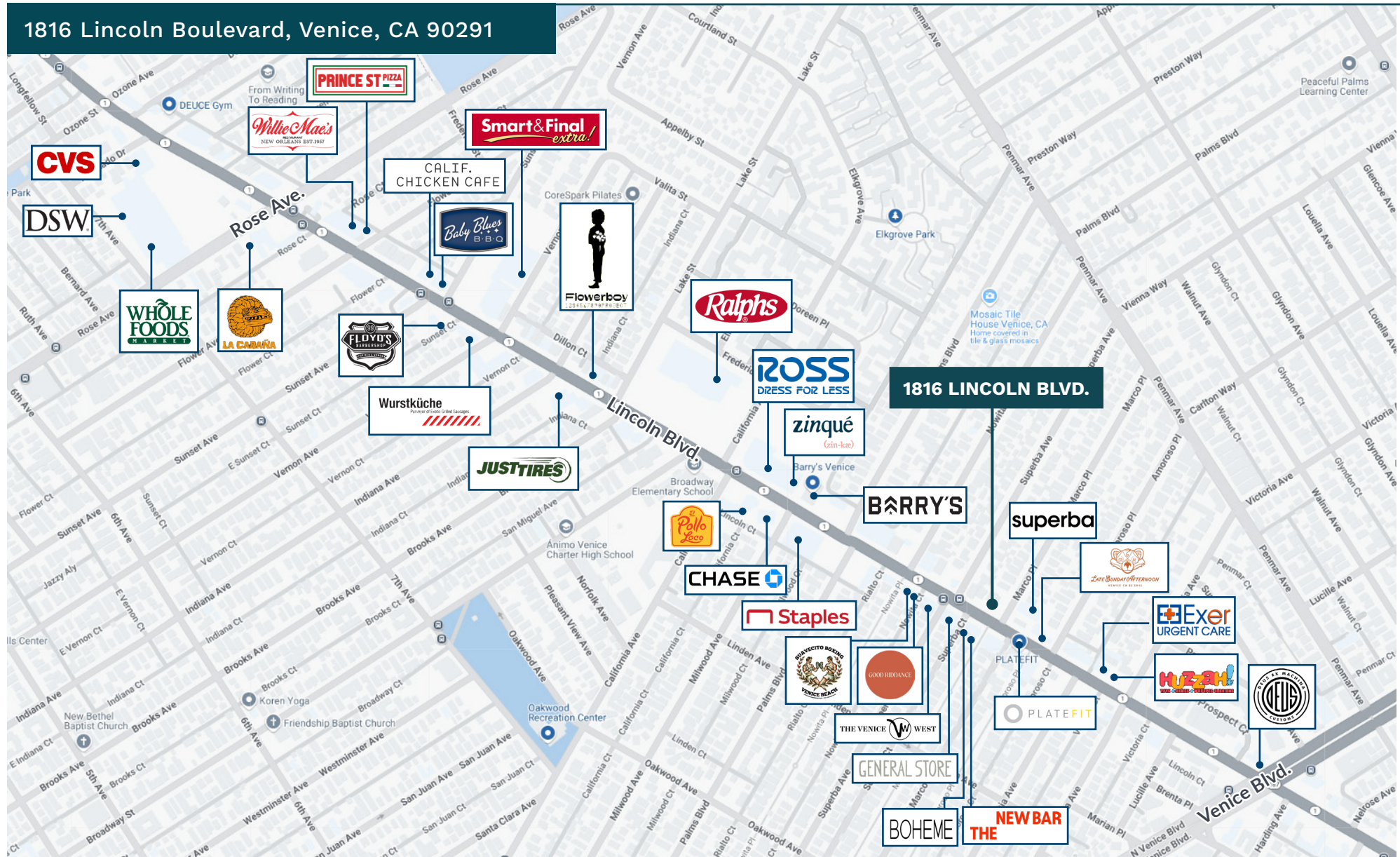

# BELOW 50 UNITS ON THE HARD CORNER OF LINCOLN BLVD & MARCO PL. Retail/Restaurant Space For Lease



1816 Lincoln Boulevard, Venice, CA 90291

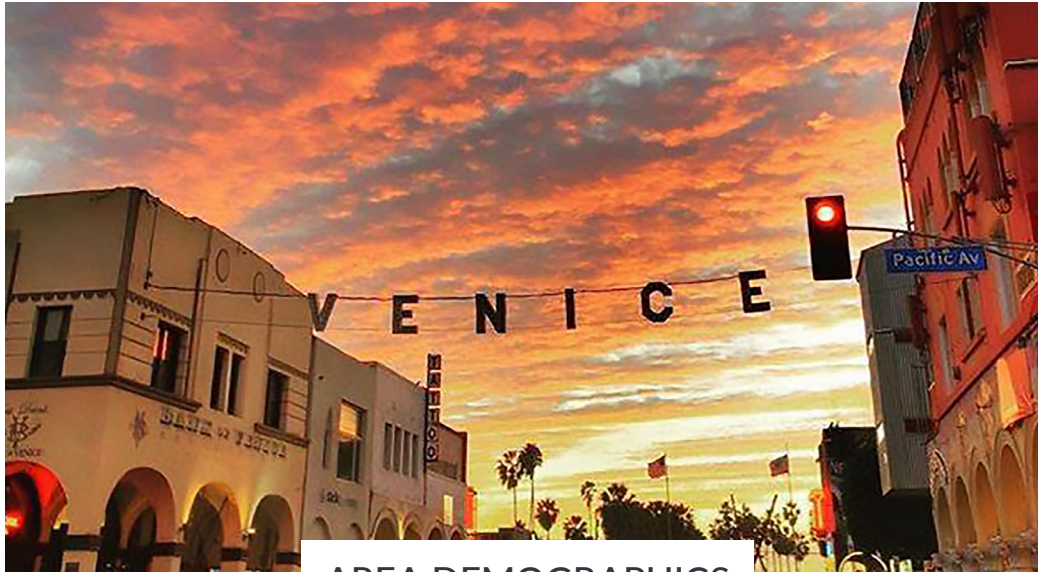

## AREA DEMOGRAPHICS



0.5 Mile      1 Mile      2 Miles

### POPULATION

	0.5 Mile	1 Mile	2 Miles
<b>2024 Estimated Population</b>	<b>8,651</b>	<b>34,997</b>	<b>122,151</b>
2029 Projected Population	8,291	33,218	117,632
2020 Census Population	7,814	34,612	123,314
2010 Census Population	8,203	33,113	117,922
Projected Annual Growth 2024 to 2029	-0.8%	-1.0%	-0.7%
Historical Annual Growth 2010 to 2024	0.4%	0.4%	0.3%
2024 Median Age	39.7	39.5	40.8

### HOUSEHOLDS

2024 Estimated Households	4,193	17,088	61,974
2029 Projected Households	4,072	16,426	60,408
2020 Census Households	3,760	16,990	62,271
2010 Census Households	3,800	15,739	58,983
Projected Annual Growth 2024 to 2029	-0.6%	-0.8%	-0.5%
Historical Annual Growth 2010 to 2024	0.7%	0.6%	0.4%

### RACE & ETHNICITY

2024 Estimated White	67.3%	63.2%	61.2%
2024 Estimated Black or African American	3.5%	5.7%	5.6%
2024 Estimated Asian or Pacific Islander	7.9%	9.7%	11.2%
2024 Estimated American Indian or Native Alaskan	0.7%	0.9%	0.9%
2024 Estimated Other Races	20.6%	20.5%	21.1%
2024 Estimated Hispanic	25.2%	25.1%	25.7%

### INCOME

	0.5 Mile	1 Mile	2 Miles
<b>2024 Estimated Average Household Income</b>	<b>\$220,185</b>	<b>\$206,155</b>	<b>\$188,753</b>
2024 Estimated Median Household Income	\$129,134	\$135,671	\$124,388
2024 Estimated Per Capita Income	\$106,840	\$100,986	\$96,018

### EDUCATION

2024 Estimated High School Graduate	9.6%	9.1%	10.3%
2024 Estimated Some College	13.4%	12.8%	13.5%
2024 Estimated Associates Degree Only	3.3%	4.1%	5.6%
2024 Estimated Bachelors Degree Only	41.0%	41.3%	38.7%
2024 Estimated Graduate Degree	26.9%	26.9%	25.1%

### BUSINESS

2024 Estimated Total Businesses	439	3,151	9,506
<b>2024 Estimated Total Employees</b>	<b>2,348</b>	<b>17,928</b>	<b>59,790</b>
2024 Estimated Employee Population per Business	5.3	5.7	6.3
2024 Estimated Residential Population per Business	19.7	11.1	12.8



REAL ESTATE

**LEE SHAPIRO**

310-887-6226

[Lee.Shapiro@kwprealestate.com](mailto:Lee.Shapiro@kwprealestate.com)

DRE #00961769

KWP Real Estate | 151 S. El Camino Drive, Beverly Hills, CA 90212 | 310-887-6400 | [kwprealestate.com](http://kwprealestate.com)

KWP Real Estate (Responsible Broker Identity, DRE #00659610) makes no warranty or representation as to the accuracy of the information contained herein. Terms of sale or lease and availability of the property are subject to change or withdrawal without notice.