

# FOR LEASE



## MEDICAL OFFICE SPACE IN CENTRAL PASADENA ONE SHORT BLOCK EAST OF LAKE

# 959 E. Walnut St. Pasadena, CA 91106

### PROPERTY HIGHLIGHTS

- Newly renovated, beautiful atrium-style medical office building.
- Space can be customized to tenant's needs.
- All tenant improvements completed by ownership.
- Elevator Served.
- Building features include open air courtyard, common kitchen and secure environment requiring key card access after business hours.
- Two blocks from Lake Avenue Goldline station and one block from retail amenities on Lake Avenue.
- 3 surface lots offering abundant parking.
- Valet Attended Surface Parking. Monthly Parking at \$65/Space unreserved and \$90/space Reserved.

FOR MORE INFORMATION, PLEASE CONTACT:

**Robert Leveen**

213.995.6684

robert.leeven@lee-associates.com

License ID 01476685

Lee & Associates-Pasadena • Corporate ID 02059558  
1055 E. Colorado Blvd., Suite 330 • Pasadena, CA 91106  
lee-pasadena.com

### SUITE INFORMATION

#### MONTHLY RENTAL RATE / SF / FSG

Medical Office

Call Broker

#### AVAILABLE SUITE

212

Available May 1, 2026

#### RSF

±987 SF

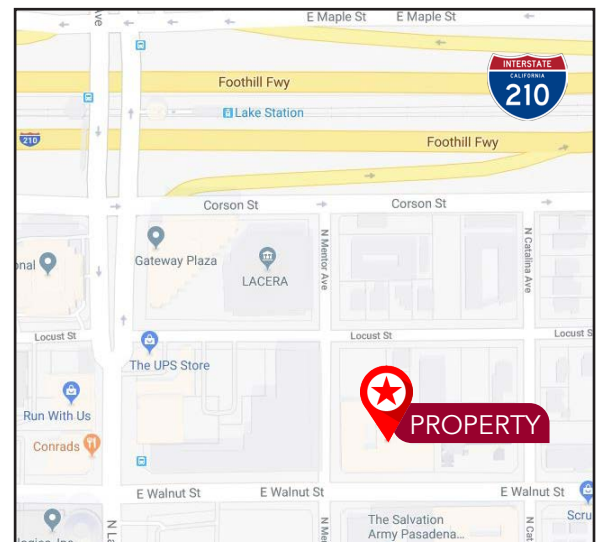



# FLOOR PLAN

## SUITE 212

±987 SF

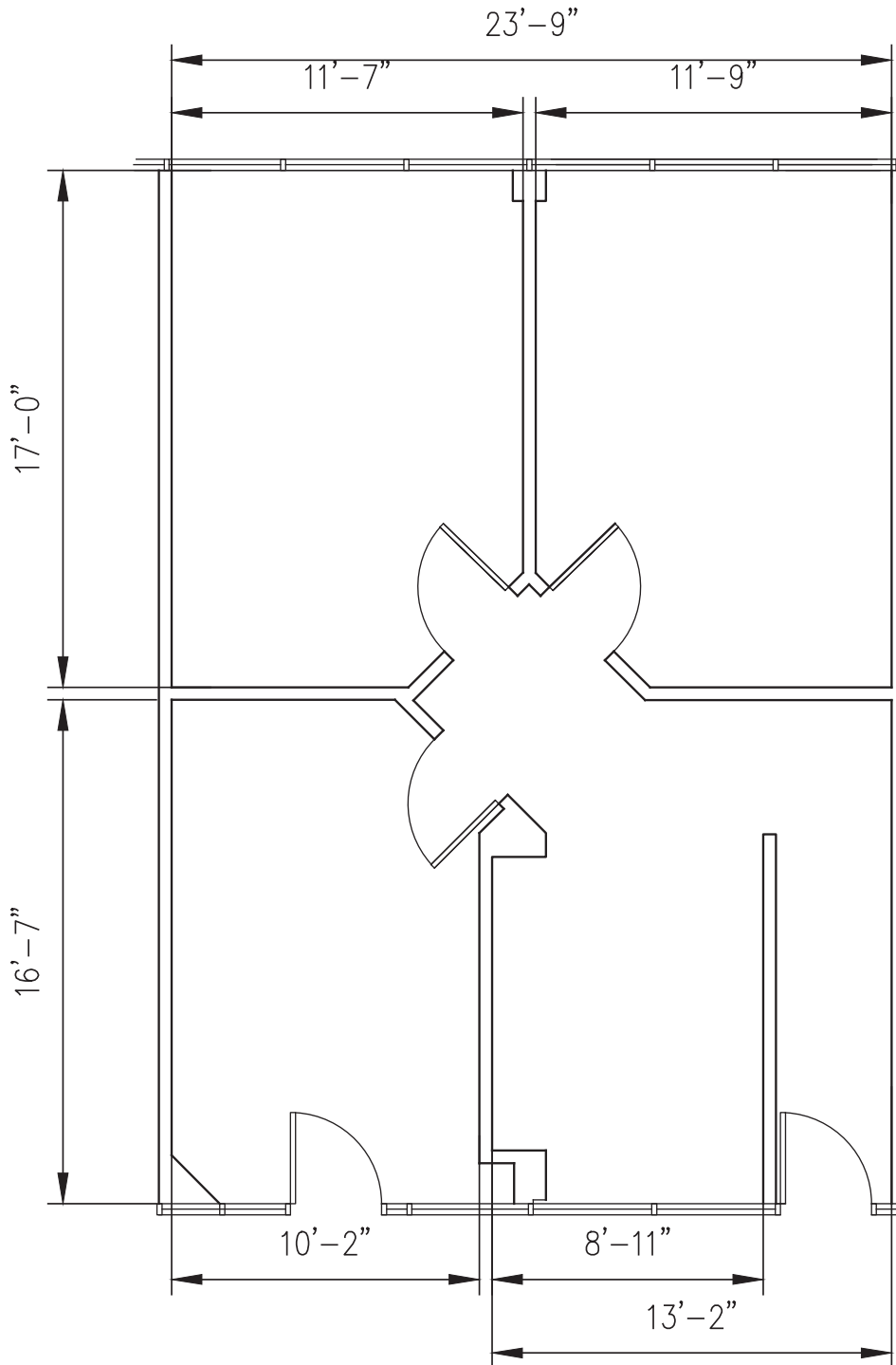

TYPICAL CEILING HEIGHT 8'-6"