

9,354 SF

1724 Park Central Boulevard North
Pompano Beach, FL 33064 USA

Prologis Park Central 300

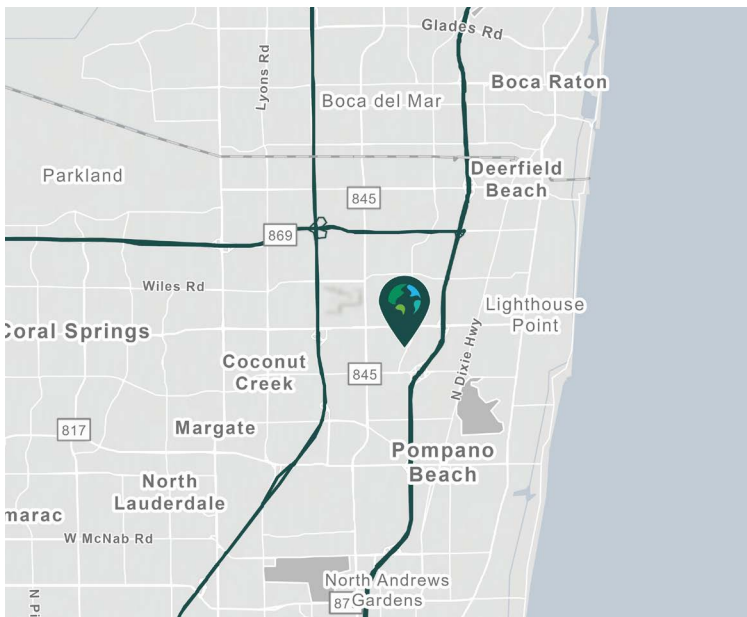

- Industrial distribution facility conveniently located in Pompano Beach area
- Less than 1 mile west of I-95 and 2.5 miles east of Florida's Turnpike
- Close proximity to Pompano Beach Airpark
- Andrews Avenue frontage (31,000 VPD)

Property Features

Available Date	4/1/2026
Available Space (Suite 1724)	9,354 SF
Office/Showroom SF	2,850 SF
Clear Height	25'-3"
Column Spacing	40' x 45'
Dock-High Doors	3 (w/edge levelers)
Ramp	1
Truck Court Depth	81'-3"
Sprinkler	ESFR
Lighting	LED
Power	Heavy 3-phase power
Speed Bay Depth	45'



Unlock the full potential of your warehouse with one strategic, single-source partner.

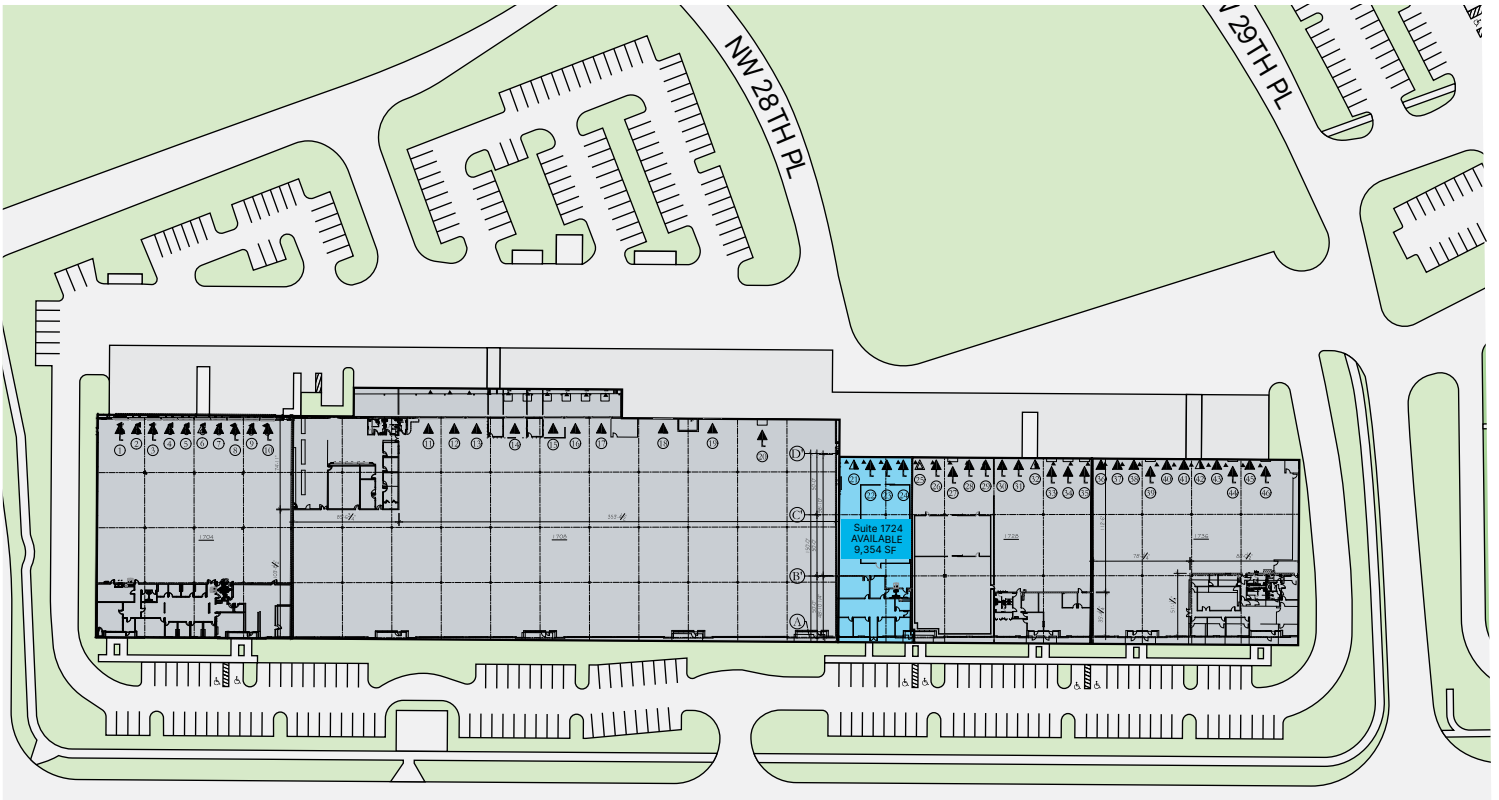

LEGEND

- AVAILABLE
- LEASED
- LAND
- CONCRETE APRON
- DOCK DOOR
- DRIVE-IN DOOR



CBRE

CBRE
Tom O'Loughlin
 tom.oloughlin@cbre.com
 ph +1 954 356 0468

CBRE
Michael Oretsky
 michael.oretzky@cbre.com
 ph +1 954 331 1749

Prologis
Ashley McMullen
 amcmullen@prologis.com
 ph +1 954 316 1778